

## Qty. Description

1 CU 202



Note! Product picture may differ from actual product

Product No.: [92799796](#)

CU 202 is designed for monitoring and controlling SQFlex submersible pumps in solar applications.

The simple user interface and built-in Bluetooth module ensure easy installation and configuration. The Bluetooth connection to the Grundfos GO app offers extensive setup and monitoring options.

CU 202 is pre-configured for tank filling, the most used application, offering a plug-and-pump solution, which saves time on commissioning.

For other applications, the controller provides several control modes, which can be easily selected and set through the Grundfos GO app.

Grundfos GO makes the configuration easier and allows installers to set up high-performing systems.

CU 202 communicates with the pump through the power cable. This communication principle is called mains borne signaling or powerline communication and means that no additional cables are required to the pump.

Grundfos GO offers detailed information and logs that help the installer to find the root cause in failure situations. In addition, the controller can use Wi-Fi, GENIbus, or Modbus to monitor the system remotely either through Grundfos Connect or another SCADA system. Remote monitoring saves time when inspecting installations.

CU 202 is equipped with power and pump connections and offers 2 configurable inputs and outputs. Additionally, a backup battery can be added to the controller to maintain communication and measurements when solar power is insufficient.

The display of the controller shows:

- System status indication
- Alarm and warning indication

The pump can be turned on and off through the display of the controller.

The controller can display a read-out of the application-related data.

It is also possible to adjust the setpoint.

The LEDs on the display of the controller can be set to sleep mode, for example, to avoid attracting wildlife.

The following logs are available through Grundfos GO or remote monitoring:

- User setting log (25 entries)
- Alarms and warnings (50 entries)
- Installation log (filled out by the installer)
- Historic data for different intervals (total, today, and yesterday) for:
  - Operation time
  - Number of starts
  - Energy consumption
  - Volume pumped (provided that a flow meter is connected)

CU 202 indicates warnings and alarms on the display of the controller. Additionally, the Grundfos GO app provides further information on these events including the recommended solutions.



Company name:

Created by:

Phone:

Date:

18/10/2024

Description	Value
<b>General information:</b>	
Product name:	CU 202
Product No:	92799796
EAN number:	5715119769117
Price:	
<b>Technical:</b>	
Approvals:	CE,EAC,RCM,UKCA
Cable gland entry:	2xPG11 + 2xPG21
<b>Materials:</b>	
Cabinet:	Plastic
<b>Installation:</b>	
Range of ambient temperature:	-4 .. 122 °F
Relative humidity:	5-95 %
Cabinet mounting:	Angle plate mounting
Earth connection:	PE
<b>Electrical data:</b>	
Power input P1:	25 W
Rated voltage AC:	1 x 90-240 V
Rated voltage DC:	30-300 V
Maximum current consumption:	12.5 A
Enclosure class (IEC 34-5):	IP55
Back-up fuse required:	16 A
IEC code battery designations:	CR2032
Battery chemistry:	LITHIUM
<b>Others:</b>	
Communication protocol GENIbus (Yes/No):	Y
Communication protocol Modbus (Yes/No):	Y
Communication protocol BACnet (Yes/No):	N
Communication protocol Powerline (Yes/No):	Y
Wireless communication GlowPAN (Yes/No):	N
Wireless communication Wifi:	802.11G
Wireless communication Bluetooth:	BLE 5.0
Net weight:	3.57 lb
Gross weight:	4.3 lb
Shipping volume:	0.21 ft³
Total height:	6.3 in
Total width:	10.3 in
Country of origin:	TH
Custom tariff no.:	8413.70.2004

## 92799796 CU 202

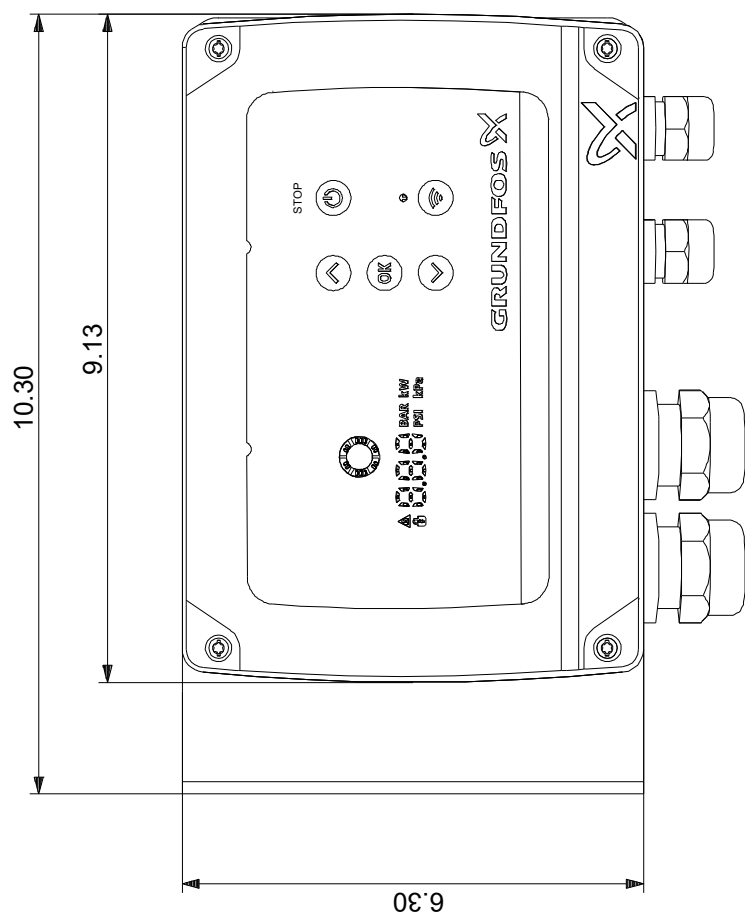
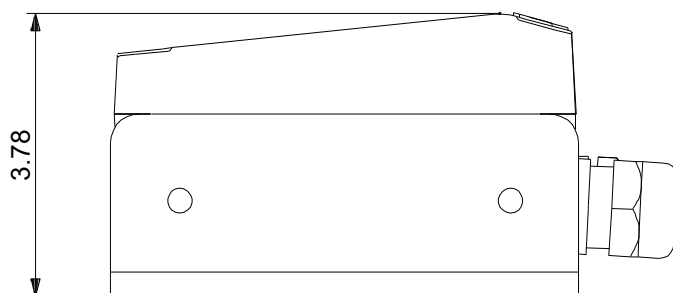

Note! All units are in [in] unless others are stated.

Disclaimer: This simplified dimensional drawing does not show all details.

## 92799796 CU 202

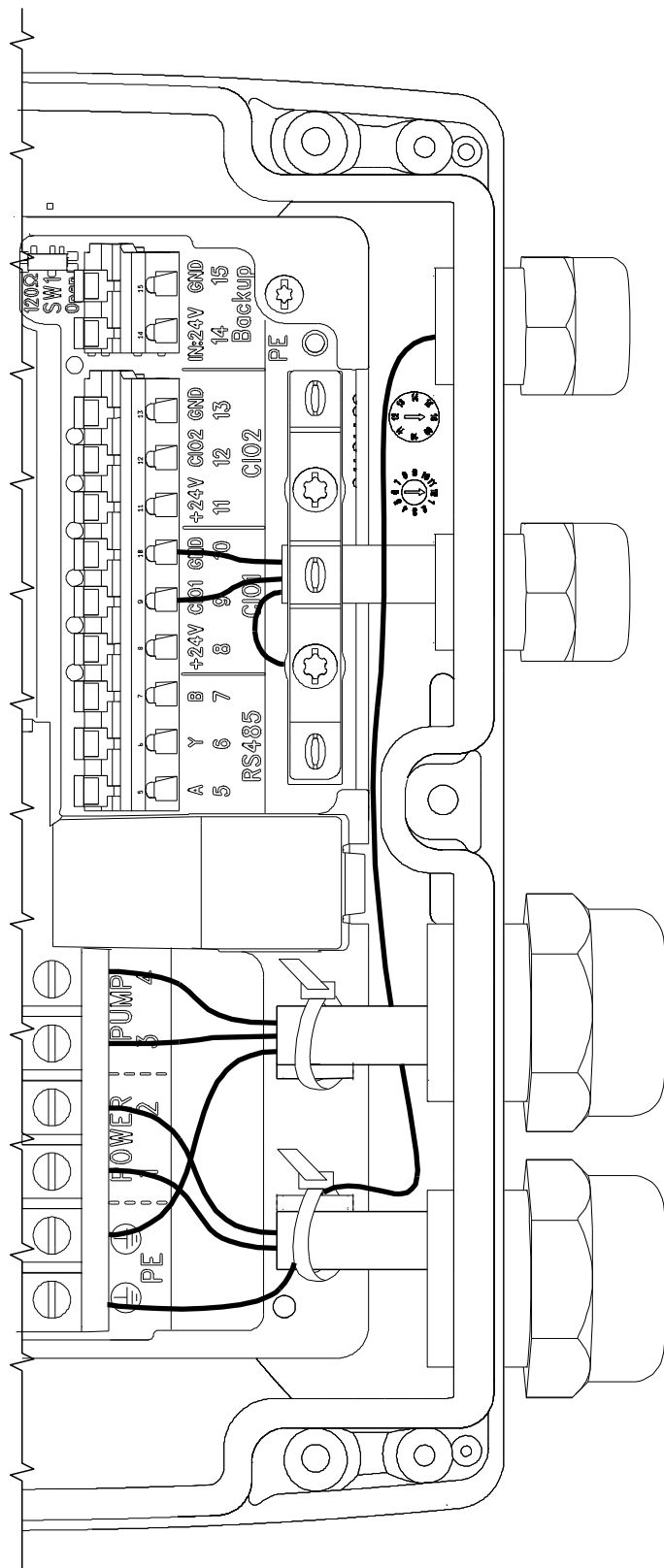

Note! All units are in [in] unless others are stated.