

SHS-P717

USER MANUAL

Samsung **SMART** Doorlock

Convenient Opening
Easy push/pull handle access

Welcome Function
When a user gets close to the door lock, the authorization standby mode will automatically activate.

Silent-Mode Function
When going in or out, the sound of the key entering and door opening will be suspended.

Automatic Card Reading Function
When a card touches the reader, the reader will conveniently recognize the card.

Double Authorization
Requires card & password combination to open

Security Assurance Function
When someone is inside the house, authorization for entry from the outside will be prohibited.

Built-in Fire Detection
Generates alarm in case of a fire

Security Function
Prevents intrusion from the outside

www.sds.samsung.com

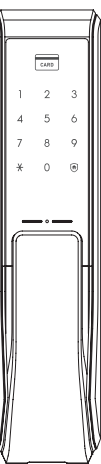

GC68-02023A ED-04

Safety Cautions

Warning This section contains important information to ensure the user's safety and prevent potential damage to property. Please, read this section carefully and use the product accordingly.

- The user shall not install or repair the product without authorization.
- Do not install the product in the place where the gap between the door and the frame is 5mm or more.
- Make sure that no unauthorized person has the access to the password.
- Do not operate the product with wet hands, and keep liquids such as water or drinks away from the product, or the product may malfunction or be damaged.
- Do not use the excessive force or sharp objects to push the lockbuttons, as this can damage the product.
- Make sure that the door is completely closed when going outside. The manufacturer does not assume the responsibility for any harm caused by engagement of the lock on an improperly closed door.
- Please do not hang on the product or pull it.
- Be sure to correctly match the poles (+/-) when installing the batteries. Install the batteries with the correct poles (+/-).
- Replace all batteries immediately after they run out of power, and never mix new batteries with used ones.
- Do not use water, benzene or alcohol when cleaning the product, as these fluids can cause product malfunction.
- Replace the batteries within 1 week after the battery replacement alarm sounds.
- Do not use water, benzene or alcohol when cleaning the product, as these fluids can cause product malfunction.
- Replace the batteries within 1 week after the battery replacement alarm sounds.
- Make sure that the door is completely closed when going outside. The manufacturer does not assume the responsibility for any harm caused by engagement of the lock on an improperly closed door.

Product Components

The product components used may vary depending on the installation environment.

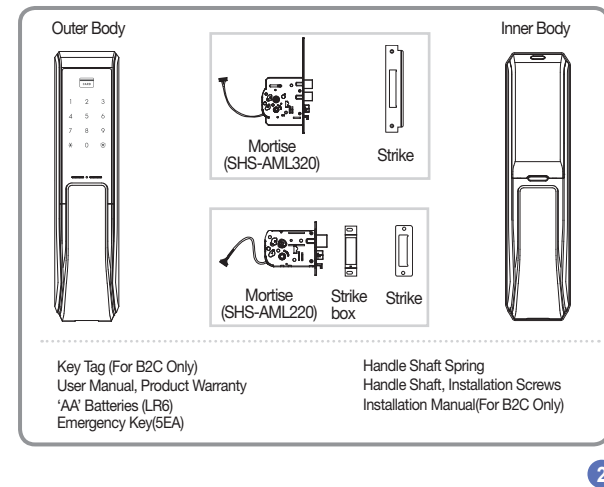

Outer Body Parts

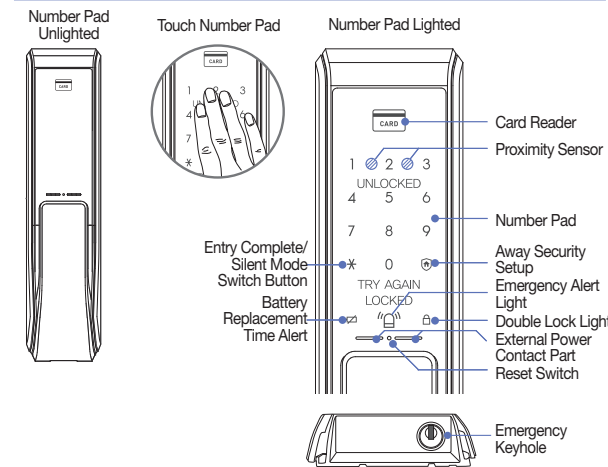

Inner Body Parts

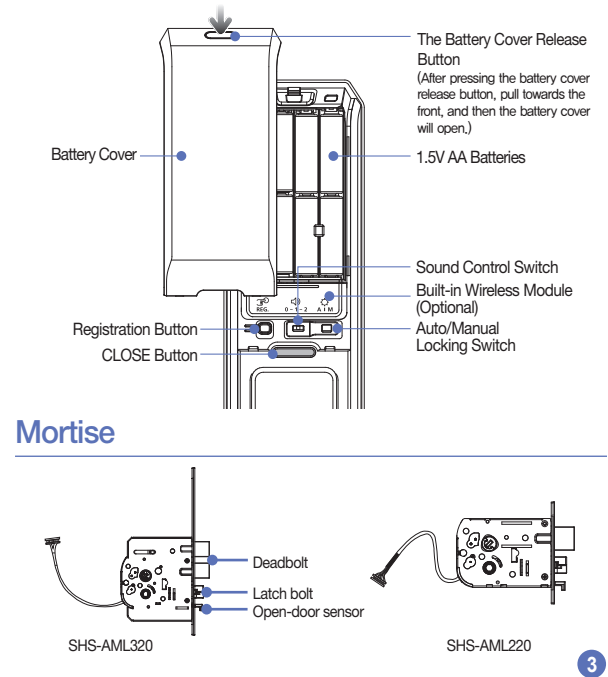

Card and Key Tag Registration

Up to 30 cards, including the key tag and user password, can be registered. (Only ISO14443 A Type is available.)

- Pressing the [Register] Button (from the inside)
- Entering the Password (from the outside)
- Placing the Card or Key Tag on the Card Reader (from the outside)
- Confirming Card or Key Tag Registration (from the outside)

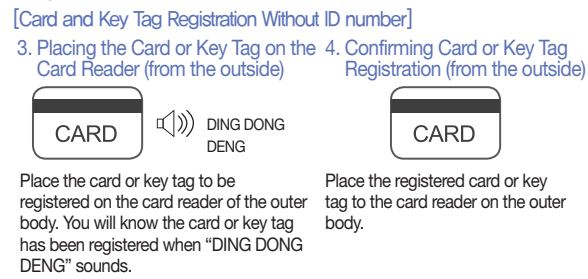

Warning To register multiple cards or key tags, lightly place another card or key tag to the card reader within 20 seconds after registering the previous card or key tag. ID number is given automatically in order of the registration.

- Enter 2 digits ID number
- Enter new user password
- Placing the Card or Key Tag on the Card Reader (from the outside)
- Confirming Card or Key Tag Registration (from the outside)

Warning User password is only for the user, so other functions such as registering cards are not available with this password. One ID has only one password or card.

Deleting Registered Cards

- Pressing the [Register] Button (from the inside)
- Entering the Current Password (from the outside)
- Pressing the [Registration] button for 3 seconds.
- Pressing the [Registration] button for 3 seconds.

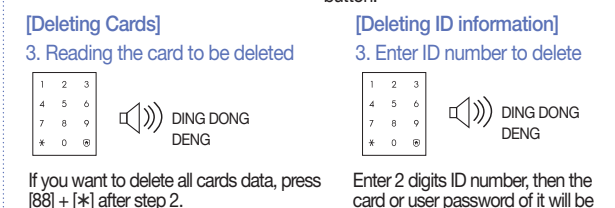

Double Authorization Mode Setting

Double authorization mode requires both card and password to open the door, ensuring more security. To setup the double authorization mode, more than 1 card must be registered.

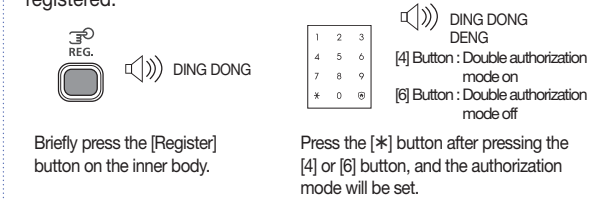

Two-factor Authentication Mode Operation

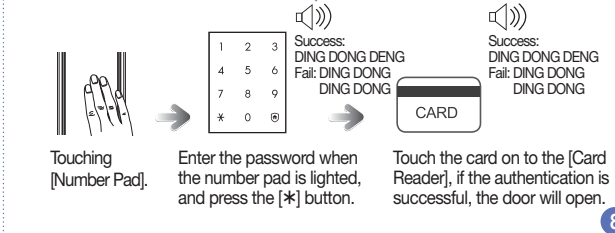

Multi-level Security Code Entry Mode Setting

You can set the security mode suitable for your use when you open the door using a password.

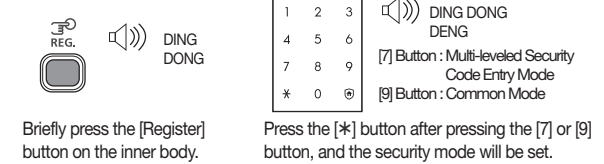

Setting the Security Function

This is a function to prevent any intrusion while you are out. Should the door be opened from the inside while the intrusion prevention function is on, the emergency alert light will flash and the alarm will make "beep beep beep-" sound.

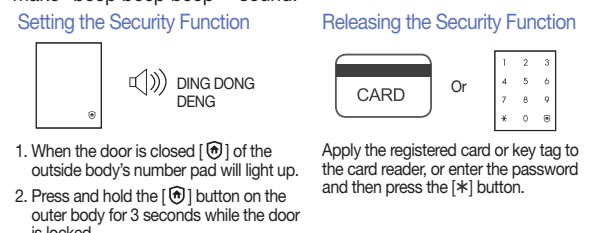

Security Assurance Mode Activation/Deactivation

At-home security mode is to prevent opening of the door from outside while someone is inside.

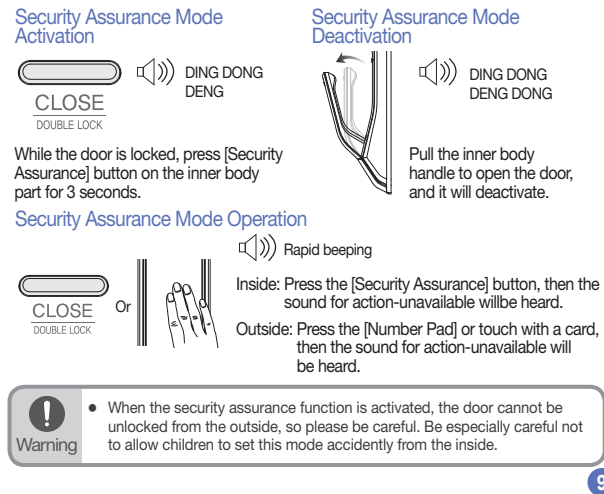

Menu Table

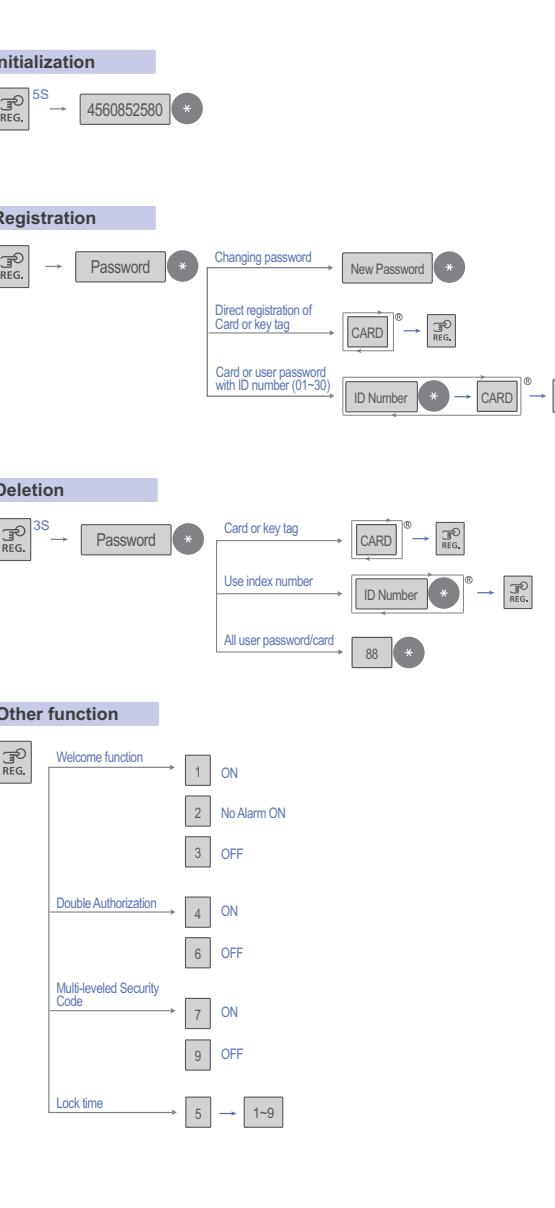

Opening the Door from Outside with a Password

When purchased, the product is set to Multi-level Security Code Entry Mode initially. Please refer to "Multi-level Security Code Entry Mode setting" for Common Mode setting.

- Silent Mode**
Before entering the password, press the [*] button and enter the password, then both the sound of the key entering and the door opening will be suspended. It is a useful function if you do not want to disturb neighbors when you go in and out at night.

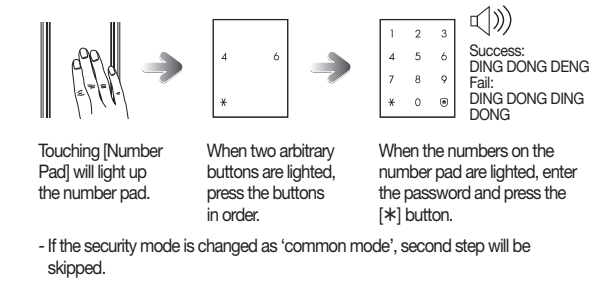

Note Password must be entered after the light is on, and if does not, touch [Number Pad] and re-enter. To cancel, press [0] button and re-enter. If the password is wrong 5 times, "peep" warning alarm will sound 20 times and the system will shut-down for about 3 minutes. When malfunction happens, "beep" will sound every 10 seconds, and stop mode will be turned off automatically after 3 minutes with multiple "beeps".

Opening the Door from Outside with a Card or Key Tag

The door can be opened from outside using a card or key tag. Place the registered card or key tag on the card reader.

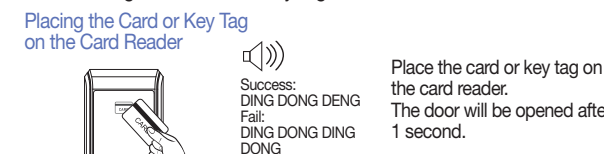

Opening the Door from the Inside

Opening by Pulling the Inner Handle



Closing the Door from the Inside

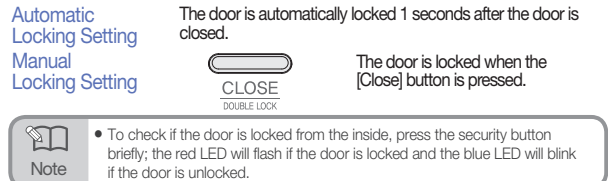

Initialization (Password, Card, Key Tag)

All registered data (password, card, key tag) are deleted. After initialization, the password is set to '1234', and the registered card, key tag data are erased. Please register a new password after initialization.

- Pressing the [Register] Button (from the inside)
- Entering the Numbers for Initialization (from the outside)
- Pressing the [Register] button for 5 seconds.
- Entering the Current Password (from the outside)

Password Change

The password can be 4-12 digits number. Only one password can be registered.

- Pressing the [Register] Button (from the inside)
- Entering the Current Password (from the outside)
- Entering a New Password (from the outside)
- Checking New Password Operation (from the outside)

Sound Setting and Releasing

The sound that is generated when the number buttons are pressed, when the door is locked or when the locked door is unlocked, can be set according to the user's preference. The product is set to generate all sounds at the factory.

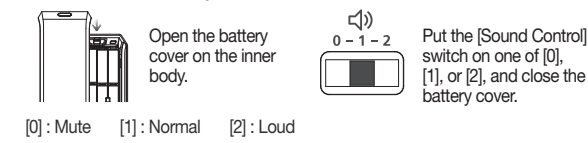

Door Lock Time Setup Function

This function sets the time interval between the moment the door open/closed sensor recognizes the door as closed and the moment deadbolt locks the door. It can be prevented the deadbolt jam problem by adjusting the time.

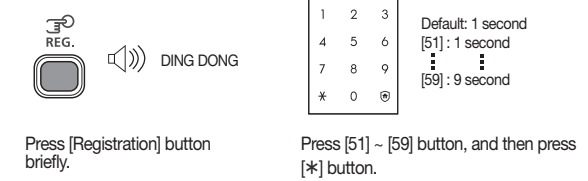

Welcome Function On/Off

The welcome function is a convenient function that automatically activates the authorization standby mode when a user approaches the door, even before touching the number pad.

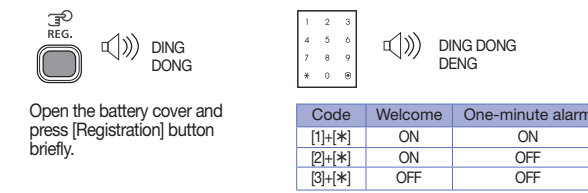

On and Off / Function Description
- Welcome function : The mode will automatically activate the authorization standby mode when a user approaches the door lock.
- One-minute alarm : When someone remains in front of the door lock for more than a minute, this mode will sound the tamper prevention alarm.

Caution The factory defaults are set with the welcome function on and the alarm function off. The working distance of the infrared sensor can differ depending on light conditions and other environments. When the front door is exposed to sun light or constant bright lights it is advised to limit the usage of the sensor as it might sound the alarm.

Automatic/Manual Locking Setting

The Automatic Locking mode allows for automatic locking of the door when it is closed.

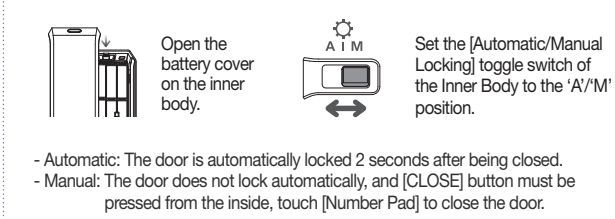

Using the Emergency Battery

If the batteries are not replaced after their replacement time comes, they will be completely discharged and the lock will not operate.

- Opening the Door Using an Emergency Battery**
Purchase an emergency battery (9V) at the nearest store. As the alkaline batteries offer longer life, they are recommended over the manganese batteries or rechargeable ones.

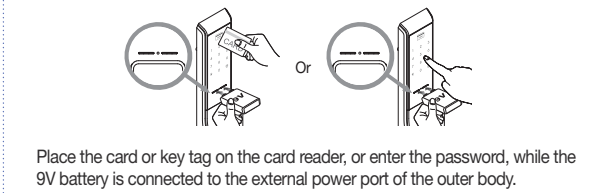

Replacing the Batteries

Battery Replacement Alarm Generation
If the melody of "Blues for Elise" sounds when opening the door with the password or a card (key tag), it is time to replace the batteries. (The low battery indicator is lighted when the melody sounds.)

Replacing the Battery
Replace all 8 batteries within a 1 week of the first alarm sound. The unit will stop operating suddenly if the batteries are not replaced.

Warning Depending on battery manufacturer, date of manufacture and the user environment, the duration of use may vary. (In the case of average use, given as 10 times a day, 8 AA alkaline 1.5V batteries can last for 12 months.) If the poles of the batteries are not placed properly, the lock will not operate normally. Liquid leaks from batteries can damage the product. Check the batteries regularly (every 6 months). After the battery replacement alarm has sounded, password/card information cannot be registered, changed, deleted, initialized or configured until the batteries are replaced.

Intrusion Detection Function

This function generates the alarm sound when an attempt is made to forcefully open the door from the inside or the outside. (This is a basic function of the lock, and cannot be separately set or released.) If the door is forcefully opened while locked, the door opening sensor detects it and generates the alarm sound.

Alarm Sound (Prank Prevention Function)

This function generates an alarm sound and deactivates lock operation when it is improperly handled from the outside. This alarm will sound if an attempt is made to open the door with an invalid card, or if a wrong password is entered five times in a row. The alarm sound is generated, and the lock is deactivated for 3 minutes. While the door is in this inactive mode, a single "DING" sound is generated every 10 seconds and seven consecutive "DINGS" will sound after 3 minutes. Following this, the lock is released from inactive mode.)

- Releasing the Alarm**
Inside Press the [Register] button.
Outside Apply the registered card or key tag to the card reader, or enter the password and then press the [*] button.

Built-in Fire Detection Function

This function generates the alarm sound when fire is detected so that the residence can quickly respond. The built-in fire detection function is a basic function of the lock, and cannot be released by the user. Fire detection function is operational at about 75 °C ± 10 °C; this can vary depending on the installation environment. When fire occurs, the temperature sensor detects it and flashes the [Close] button while generating the alarm sound. The door is automatically opened after the alarm sound has stopped. (The lock resumes normal operation if the inside temperature returns to a normal level.) The built-in fire detection function is activated when the temperature rises around 60°C, which may differ depending on the installation environment.

Item	Specifications
Voltage	AA Alkaline 1.5 Batteries (LR6) 4EA or 8EA (6V)
Emergency Power Source	9V Battery (6LF22) (Separately sold)
Operation Method	Electronic Control Method (Password entry or card or key tag reading)
Weight	3.9 kg (including both inner and outer bodies)
Product Dimensions	Outer Body (including the handle)
	Inner Body (including the handle)

The contents of this user guide are subject to change without prior notice to the user in order to enhance performance of the product.

SHS-P717

USER MANUAL

Samsung
SMART Doorlock

- 便利的开门方式
- 便捷的Push Pull开门方式
- 迎宾功能
- 用户接近门锁时自动转为工作状态
- 礼仪功能
- 输入时可转为静音状态
- 房卡自动识别功能
- 房卡接触实现自动识别, 简单方便
- 双重认证功能
- 卡和密码的双重认证功能
- 室内安心功能
- 用户居家时, 将切断外部识别功能
- 火灾感应功能
- 内装火灾感应器
- 防盗功能
- 外出时启动防盗功能

配件名称	有毒有害物质或元素					
	Pb	Hg	Cd	Cr(VI)	PBB	PBDE
金属配件	0	0	0	X	0	0
印刷电路组件 (Printed Board Assembly)	X	0	0	0	0	0
电缆 (Cable)	0	0	0	0	0	0
塑料配件 (Plastic)	0	0	0	0	0	0
电池	0	0	0	0	0	0

0: 配件中有害物质含量不超过<含量限制标准GB/T 26572>所规定的标准值
X: 配件中有害物质含量超过<含量限制标准GB/T 26572>所规定的标准值
上述表明本产品所含的有害物质含量信息, 配件别有害物质信息是根据合作公司所提供的信息和内部鉴定结果来制成的。部分配件所含的有害物质, 按照现在的技术水准是很难代替, 为了代替这个问题三星SDS (三星数据系统)会竭尽全力去努力的。

www.sds.samsung.com

GC68-02023A ED.04

安全注意事项

Warning 为保证用户安全, 避免给用户带来财产损失及使用不便, 请务必仔细阅读以下内容后正确使用本产品。

- 禁止用户任意安装或修理本产品。
- 禁止用力下坠或用力拉本产品。
- 安装时, 门与门框之间的间距不能超过5mm。
- 请按照电池正负极 (+/-), 正确安装电池。
- 请小心管理密码, 并定期更换密码, 以免他人知道。
- 电池寿命已尽时, 请同时更换所有的电池, 禁止新旧电池混合使用。
- 禁止用湿手操作本产品, 防止水、饮料等液体进入锁体内部。
- 请使用柔软的布清洁锁体, 禁止使用水、茶、酒精擦拭本产品。
- 禁止过度用力或用尖锐的器具按电子锁的按键。
- 产生电池更换报警音后, 请务必在一周之内及时更换新电池。
- 外出时请务必确认门是否完全上锁。

使用前须知

因安装的环境不同, 产品零部件会有差异。

室外侧锁体

迷你卡 (B2C专用)
使用说明书, Product Warranty Warranty
'AA'电池 (LR6)

室内侧锁体

应急钥匙 (5EA)
连接杆扣环, 安装螺丝
安装菜单 (B2C专用)

室外锁体名称

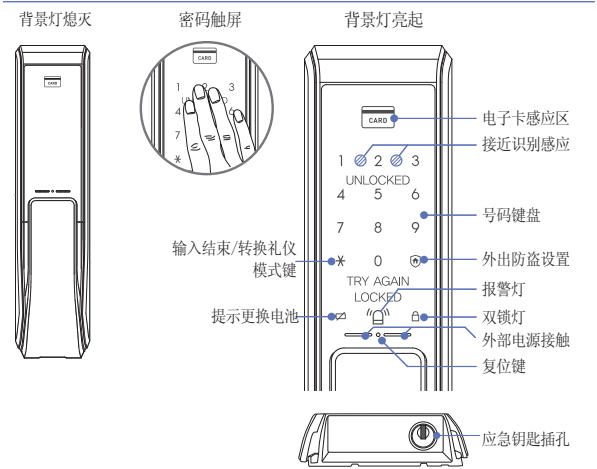

室内侧锁体名称

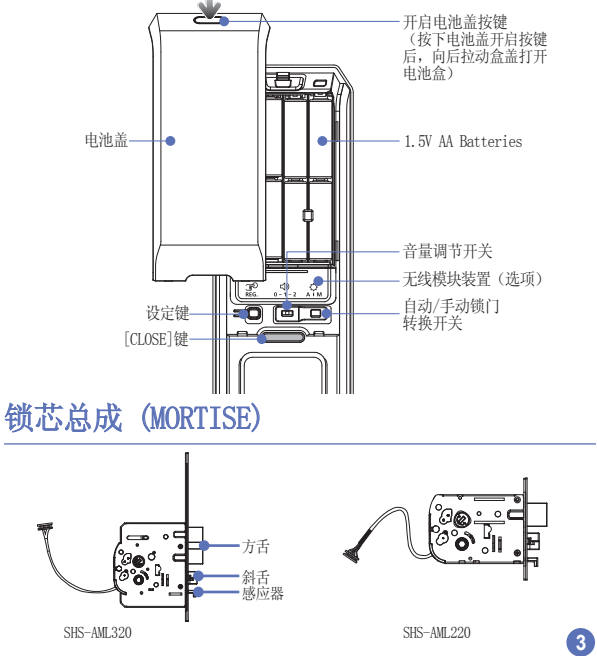

Menu Table

初始化

REG. SS → 4560852580

设定

REG. → Password → 密码变更 → New Password

REG. → Password → 卡/门禁卡登入 → CARD

REG. → Password → 使用ID号码标记的卡/密码登入 → ID Number → CARD

REG. → Password → 使用ID号码进行删除 → ID Number

REG. → Password → 删除所有密码 → 88

删除

REG. SS → Password → 卡/门禁卡 → CARD

REG. SS → Password → 使用ID号码进行删除 → ID Number

REG. SS → Password → 删除所有密码 → 88

其他功能

REG. → 欢迎模式 → 1 ON, 2 No Alarm ON, 3 OFF

REG. → 双重认证模式 → 4 ON, 6 OFF

REG. → 双重安全模式 → 7 ON, 9 OFF

REG. → 设定自动关门时间 → 5 → 1-9

从室外开门(密码)

初始设置为双重安全模式, 如果想设置为一般模式的话, 请参考普通模式设定方法

- ※ **礼仪模式**
- 输密码前, 先按[*]键再输入密码, 门锁将不发出“插入钥匙”, “已开门”等提示音。
- 夜间出入静音功能。

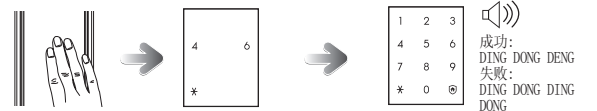

任意2个键的背光灯亮起时, 按顺序按下亮起背光灯的2个数字。

号码键盘的背光灯全部亮起时, 输入密码后按下[*]键即可。

- 设置为“普通模式”时, 只需直接输入密码即可。

从室外开门(电子卡、迷你卡)

- 应在号码键盘背光灯亮起时输入密码: 背光灯熄灭时, 请触摸号码键盘处, 背景灯亮起时重新输入。
- 若输入密码错误须取消时, 应按一下[⏏]键再重新输入。
- 连续5次输错密码时, 锁体会发出20次“Beep”的提示音, 同时电子锁会自动停止工作3分钟。电子锁在停止工作状态下, 每隔10秒钟发出“beep”的声音。3分钟之后电子锁会发出“哔哔哔哔哔哔”的声音并自动恢复工作。

从室内开门(电子卡、迷你卡)

从室外使用电子卡或迷你卡即可开门。请将已设定的电子卡、迷你卡正确地置于电子卡感应区。

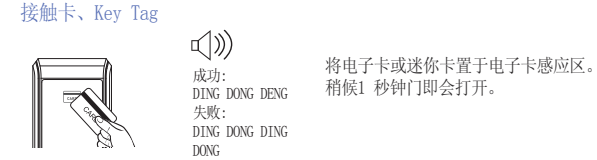

从室内开门



锁芯总成 (MORTISE)

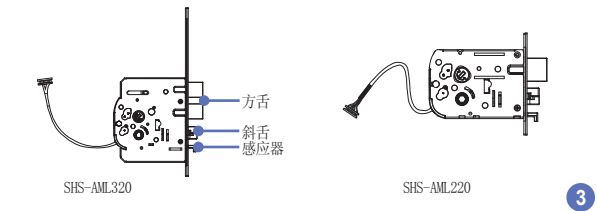

Warning 注意管理密码, 别泄漏给他人, 一组密码不宜使用过长时间。

注册卡、Key Tag

可注册的密码和卡数量达到30个。

- 按[设定]键 (从室内)
- 输入密码 (从室外)
- 接触卡、Key Tag (从室外)
- 接触卡、Key Tag (从室外)

Warning 想注册多张开门卡时, 注册好第一张卡后在20秒内一次将剩余的卡放到感应区, 如操作过程中间隔20秒以上会自动终止。
登入用ID 号码为随机号码

[通过ID号码进行卡和密码的注册]

- 输入 2位数的ID号码
- 输入新用户密码
- 接触卡、Key Tag (从室外)
- 接触卡、Key Tag (从室外)

Warning 使用者密码是仅针对使用者而设定的密码 使用者密码不能用于卡注册或者其他类似的功能。
一个 ID 只能标记一个密码或者卡。

删除门卡

可以个别删除已经或全部登记门卡。

- 按[设定]键 (从室内)
- 输入密码 (从室外)
- 将要删除的卡进行接触
- 输入需要删除的 ID号码

设定双重安全模式

使用密码开门时, 可根据适用性设定认证模式。

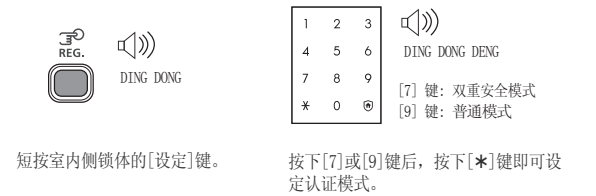

设定双重认证模式

双重认证模式是指开门时, 需同时认证密码和卡的安全强化功能。根据使用需要, 可以设定或解除该模式。

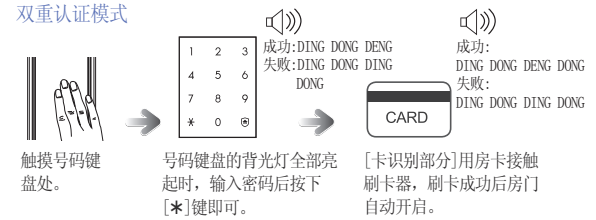
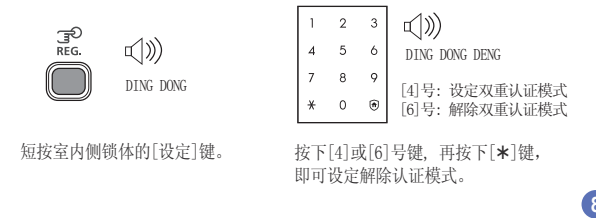

设定防盗功能

在用户外出时防止外部入侵的功能, 室内设置后, 意外情况发生时鸣笛报警。

在设置防盗功能的情况下, 如房门从内部被打开, 警报灯将闪烁, 同时持续5分钟鸣笛报警。

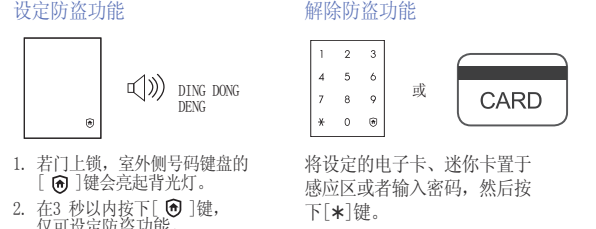

室内安心模式设定/取消

室内安心模式, 户主在家时防止他人从外部开启房门时使用。

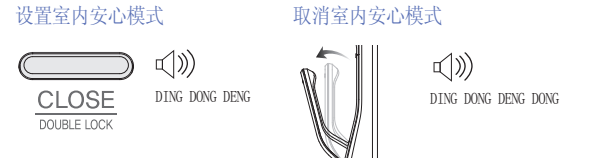

在房门上锁的情况下, 在室内一侧按住[安心]按键持续3秒。

在室内一侧拉动把手打开房门, 安心模式自动解除。

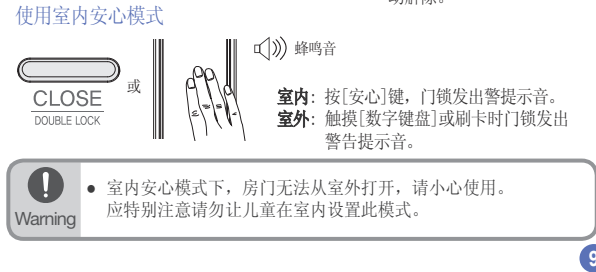

从室内关门

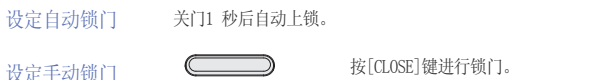

Note 如果在室内检查锁门状态, 轻按放心按钮, 如果门已上锁, 亮红灯提示, 如门未上锁, 亮蓝灯提示。

初始化方法 (密码、电子卡、迷你卡)

初始化会删除已设定的所有信息。设定的信息初始化之后, 密码自动设定为“1234”, 电子卡、迷你卡的信息自动删除。

- 按[设定]键(从室内)
- 输入初始化号码(从室外)

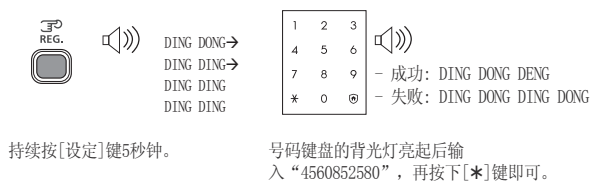

更改密码

密码可注册4-12位的一组, 可注册一个密码, 初始化操作后请重新注册密码。

- 按[设定]键 (从室内)
- 输入密码 (从室外)
- 输入新密码 (从室外)
- 再次输入新密码 (从室外)

设定及解除声音模式

本产品可以设定按号码键盘、开门或关门时的声音。

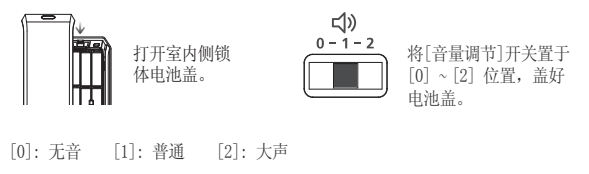

设置关门时间功能

门敞开会, 设置门栓上锁时间的功能。当门徐徐关上时, 门栓易被卡住, 设置门栓弹出时间将可能改善上述不便现象。自动上锁时间可以调整。

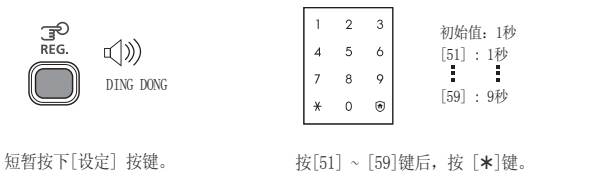

迎宾功能设定/解除

迎宾功能指在用户接近门锁时, 即使未接触到密码触屏, 门锁也会自动转入工作认证形态的一种便利功能。

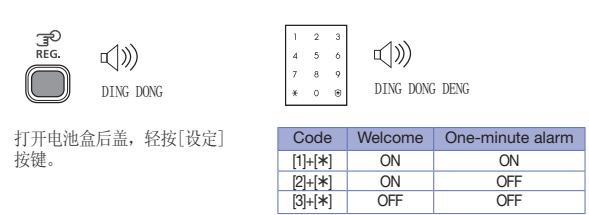

功能设定解除/功能说明

- 欢迎模式:** 当用户接近锁时, 自动进入认证状态。
- 1分钟报警功能:** 感应到有人在电锁前超过1分钟后触发警报。

Warning 出厂设置为迎宾模式, 警报功能解除。
红外线传感器在阳光紫外线作用下可能导致距离功能发生改变。曝光走廊内部及使用长明灯照明情况容易误导警报发生, 切勿使用。

设定自动/手动锁门

本产品可设定关门时自动锁门的功能。

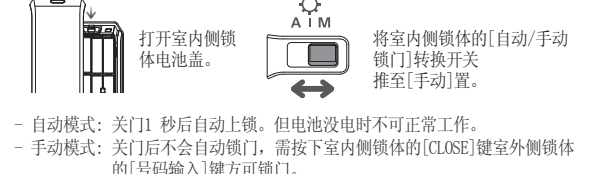

更换电池

更换电池的提示音响起时...
使用密码或电子卡(迷你卡)开门响起“致爱丽丝”旋律时, 开门后需更换电池。(若更换电池的提示音响起, 号码键盘右侧的电池交换提示背光灯会亮起。)

更换电池
从第一次响起更换电池的提示音后, 一周内必须将旧电池全部更换成新电池。

Warning 电池因生产厂家、生产日期、使用环境不同, 使用时间存在差异。(AA型号1.5福电池8只, 按每日开关门10次标准计算, 可使用12个月)
更换电池的警示音响后, 不更换电池继续使用时, 可能会产生电子锁突然停止工作的情况。
电池液体泄漏时会损坏锁体, 请务必定期(约6个月间隔)进行确认。
更换电池的提示音响后, 在更换新电池之前, 无法执行密码/感应钥匙信息的设定、更改、初始化和功能设定等。

应急电池的使用方法

到了电池更换日期不更换继续使用时, 电池会没电导致门锁不能正常工作。

使用备用电池开门
请到附近的便利店或超市购买应急电池(9V)。
- 建议使用比普通电池和充电电池工作寿命长、可长期使用的碱性电池。



发出警报音时 (防恶作剧功能)

在室外操作电子锁不正确时, 电子锁有发出警报音并自动进入断电模式。

使用未设定的卡或密码输入错误超过5次时 (电子锁会发出警报音并会自动停止工作3分钟。电子锁在停止工作状态下, 每隔10秒钟发出“DING”的声音。3分钟之后电子锁会发出“DINGS”的声音并自动恢复工作。)

警报音的解除方法

从室内 按下室内侧锁体的[CLOSE]键或[设定]键, 或者把手向下拉即可解除。

从室外 将设定的电子卡、迷你卡置于感应区或者输入密码, 然后按下[*]键即可解除。

入侵感知功能

在室内或室外, 强制打开门时发出警报音的功能。(此功能为产品基本功能, 不可设定/删除。)
在门上锁的情况下强制开门时, 电子锁的感应器会感知, 电子锁会发出警报音。

火灾感知功能

发生火灾时电子锁会发出警报, 告知住户赶快躲避的功能。(火灾探测功能为基本设定的功能, 用户不可随意解除。)
温度升至75±10℃时自动开启火灾报警功能, 根据环境设置不同可能略有差异。
火灾发生时, 温度探测器会感知, 然后[CLOSE]键不停闪烁, 同时电子锁发出警报音。警报音结束后门会自动打开。(室内温度下降到一定程度后, 电子锁会恢复正常工作。)
火灾感知功能在室内温度达到60℃左右时启动, 安装环境不同会有差异。

产品规格

项目	规格
正常电源	AA型1.5 V 碱性电池(LR6) 8 节 (6 V)
应急电源	9 V 电池(6LF22) 1节 (单独购买)
工作方式	电子控制方式 (输入密码或电子卡、迷你卡)
重量	3.9 kg (包括室内侧和室外侧)
产品大小	室外侧 (包含把手)
	室内侧 (包含把手)

●为提高产品的功能, 生产商可不经用户的同意对使用说明书的内容作出更改。