



BOULT AUDIO

PROBASS POWERBUDS USER MANUAL

For better sound quality experience, suggest use
IOS 8.0/ Android 4.3 or above operating system.

First time start up connection

Once the earbuds take out from the charging case, they will automatically turn on and pair with each other. Turn bluetooth on your phone/listening device. Search for and connect with earbuds shown as "Boult Audio PowerBuds".

Indicator: Blue light will be slowly flashing on the both side. Audio voice will announce "Power on""Pairing""Your Air Bass earbuds are now connected successfully".

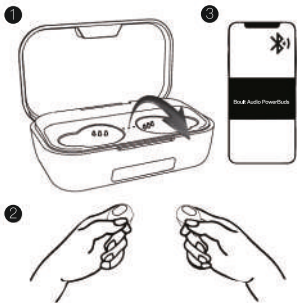

Regular use

Once the first time or initial connection is made with your device, the earbuds will connect automatically when the earbuds take out from case.

Product Introduction

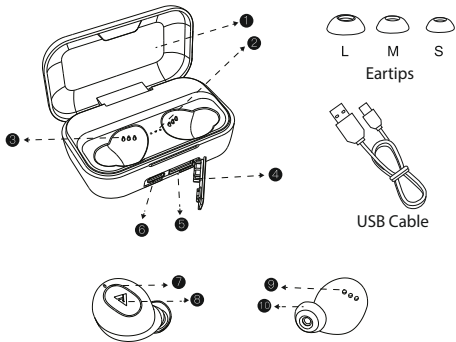

1. Lid
3. Charging pins
5. USB port
7. Earbuds mic
9. Charging contact Point

2. Charging case Indicator
4. Anti Dust plugs
6. Type-C charging port
8. Touch control area
10. Ear tips

Battery Charging

Earbuds Battery Charging







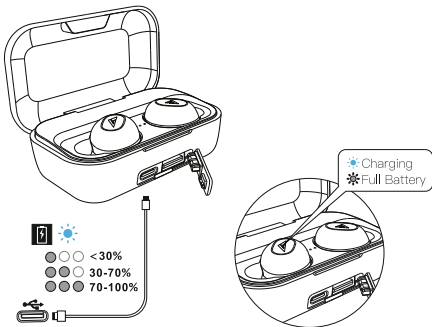









Put the two earbuds into charging case and they will automatically enter in charging mode and power off. Indicator lights on both earbuds will flash white slowly.

Charging Case Battery Charging

We suggest to use the original Type-C cable (included in package) and power supply with 5V/1A supply for optimum charging performance.



Basic Operation

 Play / Pause	 Double-click
 Previous song	 Press 2s (Left earbud)
 Next song	 Press 2s (Right earbud)
 Answer call/Hang up	 Double-click
 Reject call	 Press 1s
 Voice assistant	 Triple-click
 Power on	 a) Take out of the charging case b) Long press earbuds for 2s
 Power off	 a) Put the earbuds in the charging case for charging b) Long press earbud for 5s when disconnected. c) Automatic power off after 3 minutes when disconnected.

Wearing style

Our innovative design feature three sizing options (S,M,L) for great fit and wearing comfort. Please use whatever size option is most comfortable for you and read the steps below.

Make sure the (R)(L) symbol is facing down (indicator light is facing down) then place earbuds into ear. Rotate the earbuds until it fits snugly and is comfortable.

Clear to pairing

Clear the pairing record of earbuds and mobile phones:

Take out the earbuds from the charging case, and touch the left and right earbud 5 times, it will clear the record of the Bluetooth device. then search for the Bluetooth name "Boult Audio PowerBuds" to pair.



- Touch 5 times



- Search the Bluetooth and connect

Resume pairing of left and right earphones:

Put earbuds in the charging case and charging, then take earbuds out of the charging case when they charging a few minutes. They will enter into pairing mode automatically.



- Put in the charging case and charging

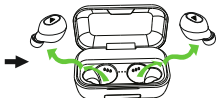

- Take out of charging case

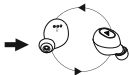

- Pairing automatically

Specification

Bluetooth Standard : Ver. 5.0

Battery of earbud: 45mAH Li-polymer Battery

Battery of charging box: 2200 mAH

Output Voltage of Base: 5V

Working distance: 10-15M

Support System: Android/IOS/Windows

Troubleshooting

Problem type	Reason	Solution
Doesn't charging /Stop working	Charging case out of battery or the earbuds fail to connect the charging with case	Charge the case first Gently swing the earbuds to make it contact with the charging pins in the charging case.
Work individually	Left one and right one doesn't pair	Please refer the reset option and reset them
Sound imbalance	Dust block	Please clean the earbuds first