



TRIBE OVERLAND BASECAMP TRAILER WATER PUMP

Warranty:

One Year (1) from date of purchase and on-line registration

The Surgiflo FL-35 is designed to pump water from the Basecamp holding water tank to your stainless steel sink. The water pump can be switched on from the "water" switch located in the kitchen slide out section. Make sure that you connect the water to the sink before you turn on the pump. The pump is professional connected for you and operates when the battery switch is in the "ON" position.

Features:

- Long life, no leak, quiet operation
- Positive displacement pump
- Can run dry
- Industry standard mount pattern
- Built thermal protector
- Self priming, fully automatic, easy installation
- Special valve for liquid input and output
- 12v,24v DC motors standard(consult factory for other voltages)
- Numerous fittings options for greater mounting flexibility
- High pressure diaphragm pump;
- Small size,Light weight and Stable performance;
- special EPDM valve for liquid input and output;
- Anti vibration pad,easy installation with stable function;
- Self-priming, Automatic Pressure Switch
- Automatic Pressure Protection;
- Low Noise,with excellent resistant to chemical corrosion
- Application :
- Overland Trailer pressurized water system

LOCATION



SURGEFLO



(1/2" DN=12.7mm) (1/2" DN=12.7mm) (1/2" DN=12.7mm) (3/4" DN=20mm)

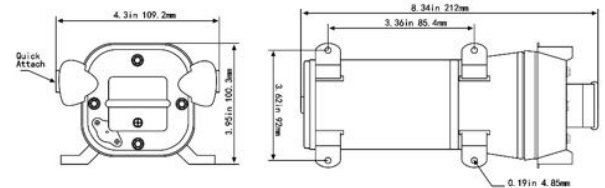

Warning:

- 1: It is need to ensure the smooth water yield when the water pump is working, to avoid the damage of pressure switch due to the pump blocked operation!
- 2: Although the water pump support the dry operating in short time, please not to exceed 15 Minutes!
- 3.It is self-absorption diaphragm pump which with slight waterproof function, please do not put it in to water directly!
- 4.It is clean water pump, please do not pump the sewage with impurities to avoid the block of pump head!

***Inverter models can be changed without notice

