



INSTALLATION INSTRUCTIONS

WIFI MODULE ref.409729

*Works with Mono split air conditioners Ref. 409730-409731-409732,
Bi-split air conditioner Ref.409733*

WIFI MODULE INSTALLATION

All the operations indicated below must be carried out with the power off.

1. Open the front panel of the indoor unit of your air conditioner.

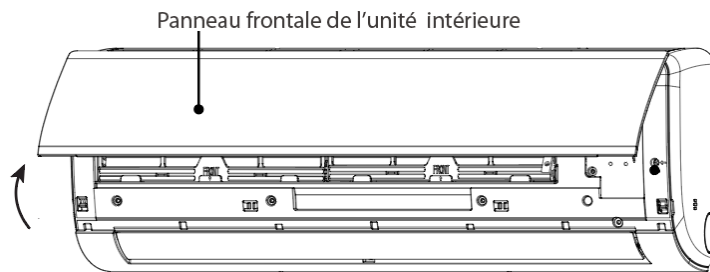

2. Unscrew the retaining screw then remove the cover of the electrical connection box to access the WIFI connection cable.

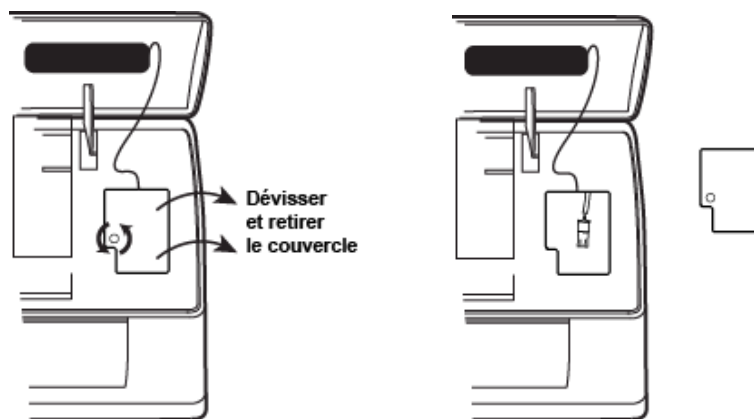

3. Connect the WIFI module connector to the indoor unit WIFI connection cable connector.

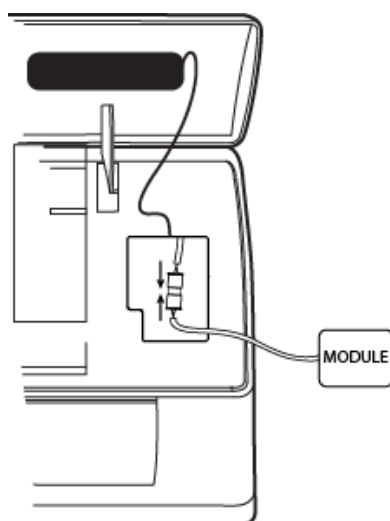

4. Position the module cable upwards. Then close the cover of the electrical connection box using the screw.

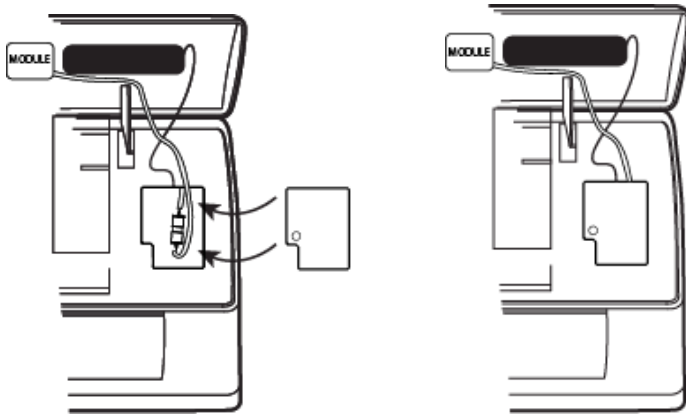

5. Glue the WIFI module to the back of the front panel, next to the black box. An adhesive strip on the back of the module is provided for this purpose.

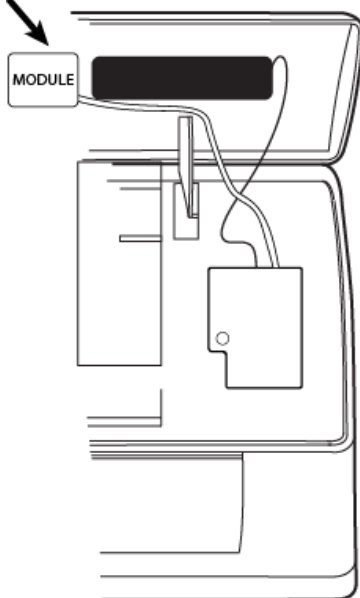

6. Write down the SmartLife code on the WIFI module "SmartLife-XXXXX".

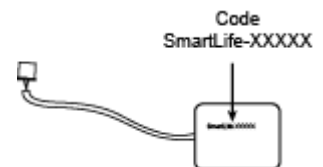

7. Close the front panel of the indoor unit.

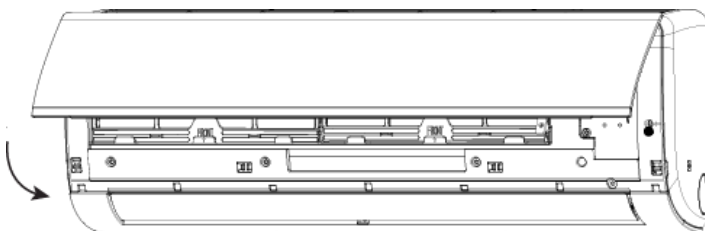

8. For the installation and use of the WIFI application, refer to the WIFI INSTALLATION AND USE GUIDE

DISPOSAL OF WASTE ELECTRICAL AND ELECTRONIC EQUIPMENT FROM
OF END USERS IN THE EUROPEAN UNION"



This symbol on the product or on the container indicates that this product may not be disposed of with general waste. The user is responsible for disposal of this type of waste by throwing it in a "recycling point" specific to electrical and electronic waste. Selective collection and recycling of electrical equipment helps preserve natural resources and ensure recycling of waste to protect the environment and health. To receive further information on the collection and recycling of electrical and electronic waste, contact your town hall, the household waste service or the establishment where the product was purchased.

