

components list

1. silicone tip
2. body
3. filters (3pcs)
4. filter housing
5. silicone tube
6. mouthpiece
7. storage box

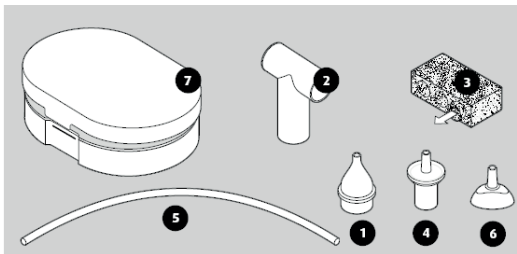

IMPORTANT, RETAIN FOR FUTURE REFERENCE
READ CAREFULLY For your child's safety and health
WARNING!

- This product is designed to support your child when they have a cold and is not a medicinal product. If your child is sick, consult a doctor.
- This product is for adult use only and is NOT a toy - keep all parts away from children.
- Never attach the breathe easy to a machine.

- Before each use, inspect the product. Throw away at the first sign of damage or weakness.
- Only use the breathe easy for nasal aspiration - DO NOT use in ears, throat or other areas of the body.
- DO NOT BLOW into the mouthpiece when the breathe easy is placed in a child's nostril.
- Ensure the product is assembled completely and correctly before use.
- Ensure all parts are completely dry before use.

CLEANING & CARE

Disposable filter is single-use only and should be disposed of after each use. Spare filters are available from our website.

All parts are suitable for top rack dishwasher cleaning (max 65°C) and all methods of sterilisation. Ensure that all parts are dry, assembled according to the assembly instructions and a new filter is inserted before use.

Clean and sterilise before first and after each use.

Any questions? Visit our website [**www.vitalbaby.com**](http://www.vitalbaby.com)

Made in China to Vital Baby® specifications. Vital Innovations Limited, Hatfield, Herts, AL10 9EW, United Kingdom. Vital Baby® is a registered trademark. PROTECT™ is a trademark. Design Rights.

© Vital Innovations Ltd 2023

ASSEMBLY INSTRUCTIONS

Ensure that all parts are cleaned, dry and assembled correctly before use.

1. Insert the silicone tip (1) in to the body (2).
2. Insert a filter (3) in to the filter housing (4), then insert the filter housing in to the assembled body & silicone tip.
3. Slide one end of the silicone tube (5) on to the end of the filter housing.
4. Insert the mouthpiece into the other end of the silicone tube.

INSTRUCTIONS FOR USE

1. Moisten dried snot with a nasal saline solution.
2. Insert a new filter into the filter housing and assemble the breathe easy following the assembly instructions.
3. Insert the silicone tip into baby's nostril and gently suck on the mouthpiece.
4. Clean the breathe easy according to the cleaning and care instructions.



Cotronic Technology Co., Ltd, Floor 4-6,
Block 7, West of ZhouShi Rd, XiXang St, Bao
An Zone, Shenzhen, Guangdong, China



WellKang Limited, Enterprise Hub, NW
Business Complex, 1 Beraghmore Road,
Derry, BT48 8SE, Northern Ireland, UK



Compliant to MDD 93/42/
EEC. 2460 is the notified
body number.

