

CLEANING & CARE

Vital Baby® NURTURE® silicone feed assist bottles and teats are suitable for all types of sterilisers and are top rack dishwasher safe.

Before each use, inspect the bottle and all its components to ensure that they are clean and undamaged.

Immediately after each feed, disassemble all parts of the bottle and rinse the inside and outside of every component. Using diluted liquid detergent and a bottle brush, brush all components thoroughly, inside and out, to remove all traces of milk and rinse with fresh clean water. Do not use abrasive or solvent based cleaning agents as this may cause damage. Store in a dry, covered container, out of direct sunlight, when not in use.

STERILISING

Before sterilising follow assembly steps 1 and 2. Sterilise the bottle and all its components by placing them in boiling water for at least 5 minutes before first use. Sterilise in sterilising solution (ensure that all parts are fully submerged in solution) or by boiling in water for at least 5 minutes or in a microwave or steam steriliser. Always follow manufacturers instructions carefully.

WHAT TEAT FLOW DO YOU NEED?

Check on the chart that you have the correct teat for your baby.*



*these age/flow rate recommendations are a guide only.

HOW TO ASSEMBLE AND STERILISE YOUR NEW VITAL BABY® NURTURE® SILICONE FEED ASSIST BOTTLE

Before sterilising and assembly please ensure that all components are cleaned according to the cleaning and care instructions. The silicone bottle and shoulder unit have been designed to be sterilised whilst assembled. The teat and collar unit can be sterilised separately or assembled to avoid contamination from handling after being sterilised.

Step 1 - Bottle base Insert the silicone bottle into the shoulder, making sure that the silicone neck is fully inserted and the silicone rim is flush fitting to the top of the shoulder.

Step 2 - Teat and screw ring Assemble the silicone teat and the screw ring making sure that the teat is fully inserted with the silicone ridge resting flush over the top edge of the screw ring.

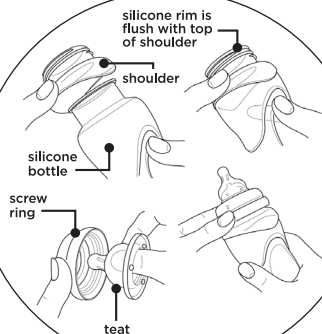

After completing Steps 1 & 2, your Vital Baby® NURTURE® silicone feed assist bottle is now ready for sterilising.

After sterilising, the bottle base and the teat and screw ring units can be assembled. The teat cover can be used to seal the teat and keep it clean when travelling or in between feeds. When travelling with the bottle, insert the sterilised sealing disk included between the teat base and the bottle neck. This will avoid the possibility of the bottle leaking should it get accidentally squashed in your travel bag.

www.vitalbaby.com

IMPORTANT, RETAIN FOR FUTURE REFERENCE: READ CAREFULLY BEFORE USE

For your child's safety and health. **WARNING!**

- If this bottle is being used for medical purposes, please ensure that you consult with your Medical Professional before use.
- INFANTS MUST NOT BE FED WITHOUT ADULT SUPERVISION – Accidents can occur if baby is left alone with a feeding bottle such as baby falling or choking.
- Never use feeding teats as a soother.
- Inspect immediately before and after each use and pull the feeding teat in all directions. Throw away at the first signs of damage or weakness.

- Do not leave a feeding teat in direct sunlight or heat, or leave in sterilising solution for longer than recommended, as this may damage and weaken the teat.
- Always check food temperature before feeding.
- Continuous and prolonged sucking of fluids will cause tooth decay – Tooth decay in young children can occur even when non-sweetened fluids are used. This can occur if baby is allowed to use the bottle for long periods through the day and particularly through the night, when saliva flow is reduced or if it is used as a soother.
- Clean all components as soon as possible after use.
- Make up all feeds according to the manufacturer's instructions, either in the bottle or in a mixing jug.

- Ensure that the self sealing cap is correctly in place when shaking the bottle to mix the feed, and hold the bottle upright.
- Never use a microwave oven to reheat baby's milk – it is difficult to judge the temperature of reheated milk and you may scald your baby.
- Keep all components not in use out of the reach of children.

Conform to EN 14350.

Made in China to Vital Baby® specifications. Vital Innovations Limited, Hatfield, Herts, AL10 9EW, United Kingdom. Vital Baby® and NURTURE® are registered trademarks. Design Rights. © Vital Innovations Ltd 2019.



Carefully designed and made to the highest safety standards to conform to EN 14350.

vital baby®

NURTURE®
silicone feed assist
bottles & teats

**BPA
FREE**