

PRODUCT SIZE: 14 in. X 8.5 in.  
THIS WILL BE THE OUTSIDE FACE OF YOUR PRODUCT

TRIM LINE

### BACK COVER(3.500 in.)

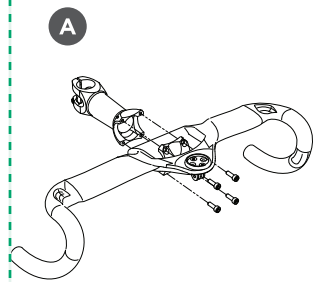

**Step 1:**  
**Inspect your RR handlebar**  
Check the handlebar from end to end for any damage. If there is visible damage, contact your local Coefficient Cycling products dealer or Coefficient Cycling LLC right away. Do not install a visibly damaged handlebar.

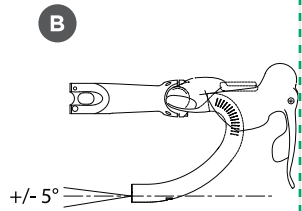

**Step 2:**  
**Remove stem faceplate**  
Insert the Coefficient RR Handlebar and reattach stem faceplate (Figures A & E). Verify that both the stem and faceplate fit properly on the handlebar and can easily be 100% fully seated. If the handlebar can not be fully seated with no effort, replace the stem with one that will not damage the handlebar.  
Insert the handlebar so that it is perfectly centered in the stem, using the handlebar's imprinted guidelines. While holding the handlebar in position, reattach the faceplate, then tighten the bolts in a cross pattern (Figure E) so that the handlebar does not slip while testing for position fit. You may need to temporarily rotate the handlebar up or down to easily install the stem bolts. Do not exceed the torque specs shared in STEP 5. Make sure the tips of drops are parallel to the ground (Figure B). This position optimizes the RR's ergonomics and offers the ideal balance of comfort and safety, where brake levers are easily reached — even from the drops.

**Step 3:**  
**Install brake/shifter levers to your preferred position (Figure B).**  
Loosen the brake/shifter lever clamp so that the levers easily slide up the drops until they reach the clearly marked clamping zone.

To optimize ergonomics, comfort and performance — position the brake levers so the top of the brake hood continues the slightly upward slope of the handlebar.

Have the rider straddle their bike and grasp the levers. Then carefully move the levers slightly inboard or outboard, up or down, until the rider locates the position that feels most comfortable. Next, have the rider place their hands in the drops. If the rider would prefer the levers a bit closer or farther away, then slightly rotate the handlebar either up or down — making sure that the drop tips remain within a 5° angle of the ground and the brake lever tips are above the bottom of the drop.

*Note: Many brake/shifter levers offer the ability to adjust "throw". Throw is the distance between the brake lever and the handlebar drop, and if available should be used instead of adjusting the ergonomics of the handlebar.*

**Step 4: Mechanical & electronic cable routing (Figures C & D)**  
**IMPORTANT:** Compared to a conventional drop handlebar, the Coefficient RR requires 3-4 cm longer cables, especially when routing inside the handlebar. If you do not have additional cable length on your current set-up, you will need to purchase new cables.

### INSIDE PANEL(3.500 in.)

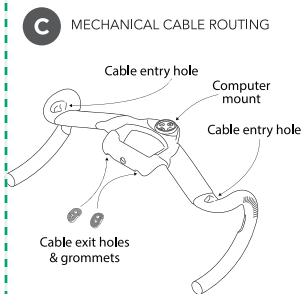

**Internal & external options**  
The RR handlebar includes internal cable routing holes for both mechanical and electronic brake and shifter cables. There are four (4) larger holes for mechanical brake and shift cables (Figure C). The two exit holes near the stem include slotted rubber grommets to help retain the cables. There are five (5) smaller exit holes to accommodate electronic shifting wires (Figure D). The two (2) under the tops are for remote shift buttons. There are 2 rubber grommets provided for these wiring holes; poke a small hole in the grommet to accommodate the wire when positioning a remote sensor near the center of the handlebar.

Should you prefer to externally route brake and shifter cables, we recommend taping cables to the underside of the handlebar.

**Step 5: Properly tighten stem & brake/shifter Levers (Figure E).**  
Now that the RR handlebar's brake/shifter levers are properly positioned, use a torque wrench to tighten all bolts to manufacturers' specifications. Using the cross method mentioned in Step 2, secure the handlebar by tightening the stem's faceplate, making sure the gap between stem and faceplate is equal on both the top and bottom.

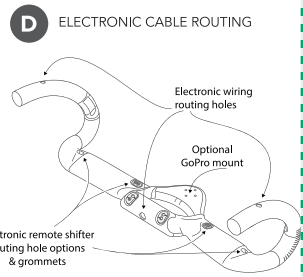

Each faceplate bolt must be tightened to the exact Nm recommended by the stem manufacturer. Be certain never to exceed the Coefficient RR Handlebar's stem face-plate maximum torque setting of 6Nm.  
Now tighten brake/shift lever clamp bolts to the exact Nm instructed by the lever manufacturer. Be certain never to exceed the RR handlebar's brake lever maximum torque setting of 8Nm.

**Step 6: Taping handlebar**  
**Once you have correctly positioned and properly tightened handlebar; stem and levers—** the last step before riding is wrapping the RR handlebar with bar tape. Some riders prefer to wrap tape all the way to the stem, while others terminate tape closer to the levers. The RR handlebar includes a guideline bump near the tops-to-drops bend to assist with 'less is more' bar taping. If taping the full length, be sure to pull/stretch your bar tape a bit to cover the entirety of the RR handlebar.

### INSIDE PANEL(3.500 in.)

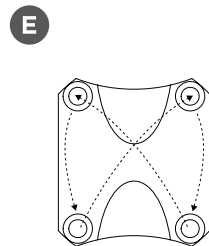

**Step 7:**  
**Integrated cycling computer mount (Figures C & D)**  
Your RR handlebar includes an integrated cycling computer mount. Coefficient offers a variety of mounts should you need a replacement or change computer brands. There is a location on bottom of the RR computer bridge for a GoPro camera mount, which can be ordered from Coefficient Cycling.

The RR handlebar is compatible with Bar Fly Bike computer mounts.  
Once you've carefully completed Steps 1 through 7, you're ready to ride the Coefficient RR Handlebar!



**COEFFICIENT**  
Cycling

For additional technical information, visit [www.coefficientcycling.com](http://www.coefficientcycling.com)  
[info@coefficientcycling.com](mailto:info@coefficientcycling.com)  
+1 415.815.8802  
311 Arlington Road  
Redwood City, CA 94062  
© 2022 Coefficient Cycling LLC  
U.S. Patent No. 11,505,275



### FRONT COVER(3.500 in.)



Getting Your SWOPE™ On  
COEFFICIENT™ RR HANDLEBAR  
INSTALLATION INSTRUCTIONS & WARRANTY



## Read thoroughly before you ride

Thank you for the purchasing a Coefficient RR Handlebar. Please read these installation instructions carefully. Our safety warnings are especially important before you ride the Coefficient RR. An improperly installed handlebar can damage the product (nullifying its warranty) or damage your bike. It could also result in loss of control of your bike, resulting in serious injury or death.

These instructions are intended for a qualified bike mechanic, as we recommend that only a

qualified bike mechanic install this handlebar. The handlebar is responsible for your ability to steer and control your bike, so it is of utmost importance to ensure that both the handlebar is in perfect condition and its installation is absolutely correct.

*DO NOT install clip-on handlebar extensions on the Coefficient RR Handlebar as it is not compatible with handlebar extensions typically used by time trialists and triathletes.*

## COEFFICIENT RR WARRANTY

Coefficient Cycling LLC warrants each new Coefficient RR Handlebar against defects in workmanship and materials for a period of two full years from date of purchase. This warranty is strictly limited to the replacement of a defective handlebar. This warranty applies only to the handlebar's original owner and cannot be transferred. Warranty claims must be made through authorized Coefficient Cycling dealers or directly with Coefficient Cycling LLC. Before submitting a warranty claim, please register your Coefficient RR Handlebar at [www.coefficientcycling.com/registration](http://www.coefficientcycling.com/registration). You will need your proof of purchase to complete registration. Warranty does not cover normal wear-and-tear, incorrect assembly, or any damage caused by the partnering with incompatible components or attachment of accessories. Warranty does not apply to damage or failure due to accident, abuse, misuse or neglect. In case of handlebar replacement, labor costs for switching handlebars are not covered by the warranty.

### REGULAR INSPECTION

Always carefully inspect your Coefficient RR Handlebar after any crash. We recommend regular inspection of your bicycle, including your Coefficient handlebar, for signs of damage or fatigue including, but not limited to: cracks, dents, deformation, discoloration, deep scratches, or audible creaking. Discontinue use and replace any parts that show signs of damage or fatigue.

SAFE ZONE

SAFE ZONE

SAFE ZONE

SAFE ZONE

PRODUCT SIZE: 14 in. X 8.5 in.  
THIS WILL BE THE INSIDE FACE OF YOUR PRODUCT

TRIM LINE

INSIDE FRONT COVER(3.500 in.)



Getting Your SWOPE™ On

COEFFICIENT™ AR HANDLEBAR

INSTALLATION INSTRUCTIONS & WARRANTY



Read thoroughly before you ride

A BIG CONGRATS on the purchase of your Coefficient AR Handlebar. Get ready to experience more comfortable and efficient riding! Please read these installation instructions carefully. Our safety warnings are especially key before you ride the AR. An improperly installed handlebar can lead to damage to the product (nullifying its warranty) or damage to your bike. It could also result in loss of control of your bike, resulting in serious injury or death.

These instructions are intended for a qualified bike mechanic,

as we recommend that only a qualified bike mechanic install this handlebar. The handlebar is primarily responsible for your ability to steer and control your bike, so it is of utmost importance to ensure that both the handlebar is in perfect condition and its installation is absolutely correct.

DO NOT install clip-on handlebar extensions on the AR handlebar as it is not compatible with handlebar extensions typically used by time trialists and triathletes.

SAFE ZONE

INSIDE PANEL(3.500 in.)

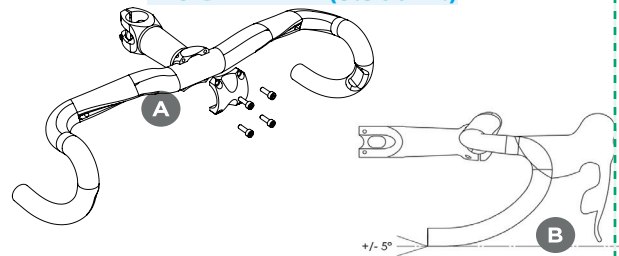

Step 1: Inspect Your AR Handlebar

Check the handlebar from end to end for any damage. If there is visible damage, please contact your local AR dealer or Coefficient Cycling LLC right away. Do not install a visibly damaged handlebar.

Step 2: Remove stem faceplate Insert AR handlebar and reattach stem faceplate (Figures A & D)

Remove the stem's faceplate. Verify that both the stem and faceplate fit properly on the handlebar and can easily be 100% fully seated. If the handlebar can not be fully seated with no effort, replace the stem with one that will not damage the handlebar.

Insert the handlebar so that it is perfectly centered in the stem, using the AR's imprinted guidelines. While holding the handlebar in position, reattach the face-plate, then tighten the bolts in a cross pattern (Figure D) so that the handlebar does not slip while testing for position fit. Do not exceed the torque specs shared in STEP 5. Then make sure the tips of drops are (close to or) parallel to the ground (Figure B). This position offers the ideal balance of comfort and safety, where brake levers are easily reached – even from the drops.

Step 3: Install brake/shifter levers to your preferred position (Figure B)

Loosen the brake/shifter lever clamp so that the levers easily slide up the drops until they reach the clearly marked clamping zone. For correct setup, be sure that the bottom tip of the brake lever is level with or slightly above the bottom of the drops.

Have the rider straddle their bike and grasp the levers. Then carefully move the levers slightly inbound or outbound, up or down, until the rider locates the position that feels most comfortable. Next, have the rider place their hands in the drops. If the rider would prefer the levers a bit closer or farther away, then slightly rotate the handlebar either up or down – making sure that the drop tips remain within a 5° angle of the ground and the brake lever tips are above the bottom of the drop.

Note: Many brake/shift levers offer the ability to adjust "throw". Throw is the distance between the brake lever and the handlebar drop.

SAFE ZONE

INSIDE PANEL(3.500 in.)

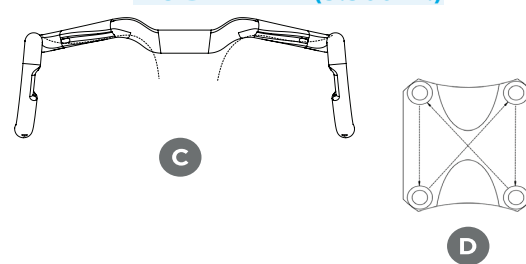

Step 4: Cable routing Internal & external options(Figure C)

The AR handlebar is designed for external cable routing of mechanical and hydraulic lines. There are access ports for internal routing of Di2 electronic wires only, if you choose not to route them externally. There is also a small exit hole at the center-rear of the handlebar for electronic wiring. Should you prefer to externally route brake and shifter cables, we recommend taping the cables to the underside of the handlebar.

Step 5: Properly tighten stem & brake/shift levers (Figure D)

Now that the AR handlebar, the brake/shifter levers are properly positioned, use a torque wrench to tighten all bolts to manufacturers' specifications. Using the cross method mentioned in Step 2, secure the handlebar by tightening the stem's faceplate, making sure the gap between stem and faceplate is equal on both the top and bottom. Each faceplate bolt must be tightened to the exact Nm recommended by the stem manufacturer.

Be certain never to exceed the AR handlebar's stem faceplate maximum torque setting of 6Nm. Now tighten brake/shift lever clamp bolts to the exact Nm instructed by the lever manufacturer. Be certain never to exceed the AR handlebar's brake lever maximum torque setting of 8Nm.

Step 6: Taping handlebar

Once you have correctly positioned and properly tightened the handlebar, stem and levers - the last item before riding is wrapping the AR with handlebar tape. Note that due to the ergonomic shape of the handlebar, it requires longer bar tape than average. Verify your preferred tape is long enough, or purchase extra-long Coefficient bar tape.

Once you've carefully completed Steps 1 through 6, you're ready to ride the AR!



SAFE ZONE

INSIDE BACK COVER(3.500 in.) AR WARRANTY

Coefficient Cycling LLC warrants each new AR handlebar against defects in workmanship and materials for a period of two full years from date of purchase. This warranty is strictly limited to the replacement of a defective handlebar. This warranty applies only to the AR's original owner and cannot be transferred. Warranty claims must be made through authorized AR dealers or directly with Coefficient Cycling LLC. Before submitting a warranty claim, please register your AR at www.coefficientcycling.com/registration. You will need your proof of purchase to complete registration.

Warranty does not cover normal wear-and-tear, incorrect assembly, or any damage caused by the partnering with incompatible components or attach-ment of accessories. Warranty does not apply to damage or failure due to accident, abuse, misuse or neglect. In case of handlebar replacement, labor costs for switching handlebars are not covered by the warranty.

REGULAR INSPECTION

Always carefully inspect your AR handlebar after each crash. We recommend regular inspection of your bicycle, including your AR handlebar, for signs of damage or fatigue including, but not limited to: cracks, dents, deformation, discoloration, deep scratches, or audible creaking. Discontinue use and replace any parts that show signs of damage or fatigue.



COEFFICIENT™ Cycling

www.coefficientcycling.com  
info@coefficientcycling.com  
1.415.815.8802  
311 Arlington Road  
Redwood City, CA 94062  
© 2022 Coefficient Cycling LLC  
U.S. Patent No. 11,505,275

SAFE ZONE