

Product Manual

Model: STE-2H-STI2HEM



Dear customers:

Thank you for buying our new generation of **steam sauna cabin**.

For the purpose of helping you to better know and properly use this **steam sauna cabin**, please carefully read and properly keep this manual, which is applicable to the new generation of steam sauna cabin.

A. Introduction

A.1 Overview

Particular care was devoted to the health promotion, moral self-cultivation, conformity with nature, and mental tranquility in the ancient Chinese culture. Spirit refers to the mentation of human beings. Wet steaming will realize the mental tranquility of “harmony between man and nature”, and steam bath is an indispensable part of health promotion in the traditional Chinese culture. For this purpose, this steam sauna cabin produces a brand new world for steam sauna by virtue of integrating the modern technology with the ancient steam therapy.

A.2 Working environment

A.2.1 Temperature: 5 °C-40 °C

A.2.2 Humidity: \cong 85%

A.2.3 Atmospheric pressure: 700-1060 hpa

A.2.4 Power source: AC 220V; 50HZ \pm 1





/AC 110V; 60HZ \pm 1

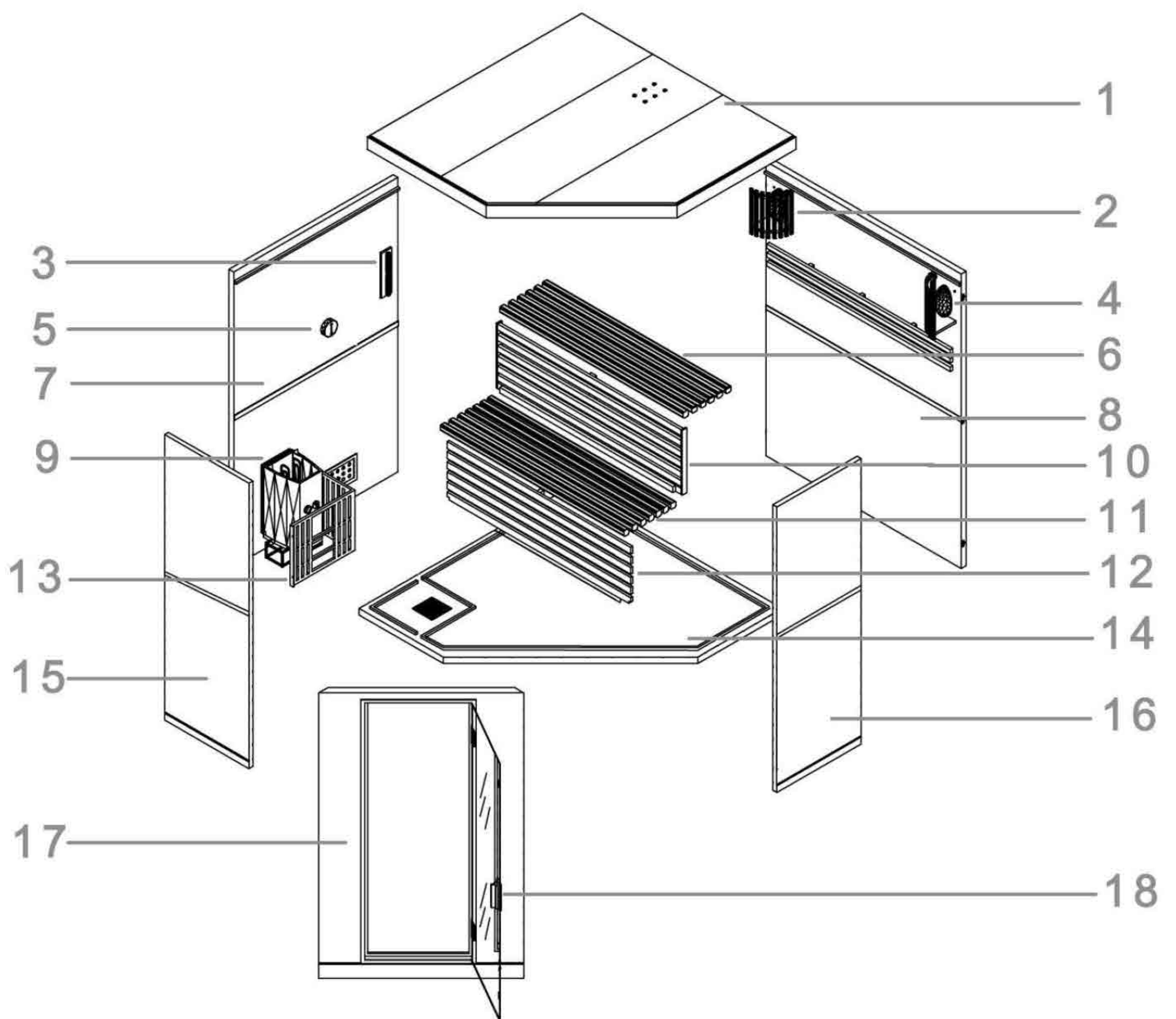



A.2.5 The sauna cabin must be 12.7mm away from the wall at the least.

A.3 Pentagonal structure

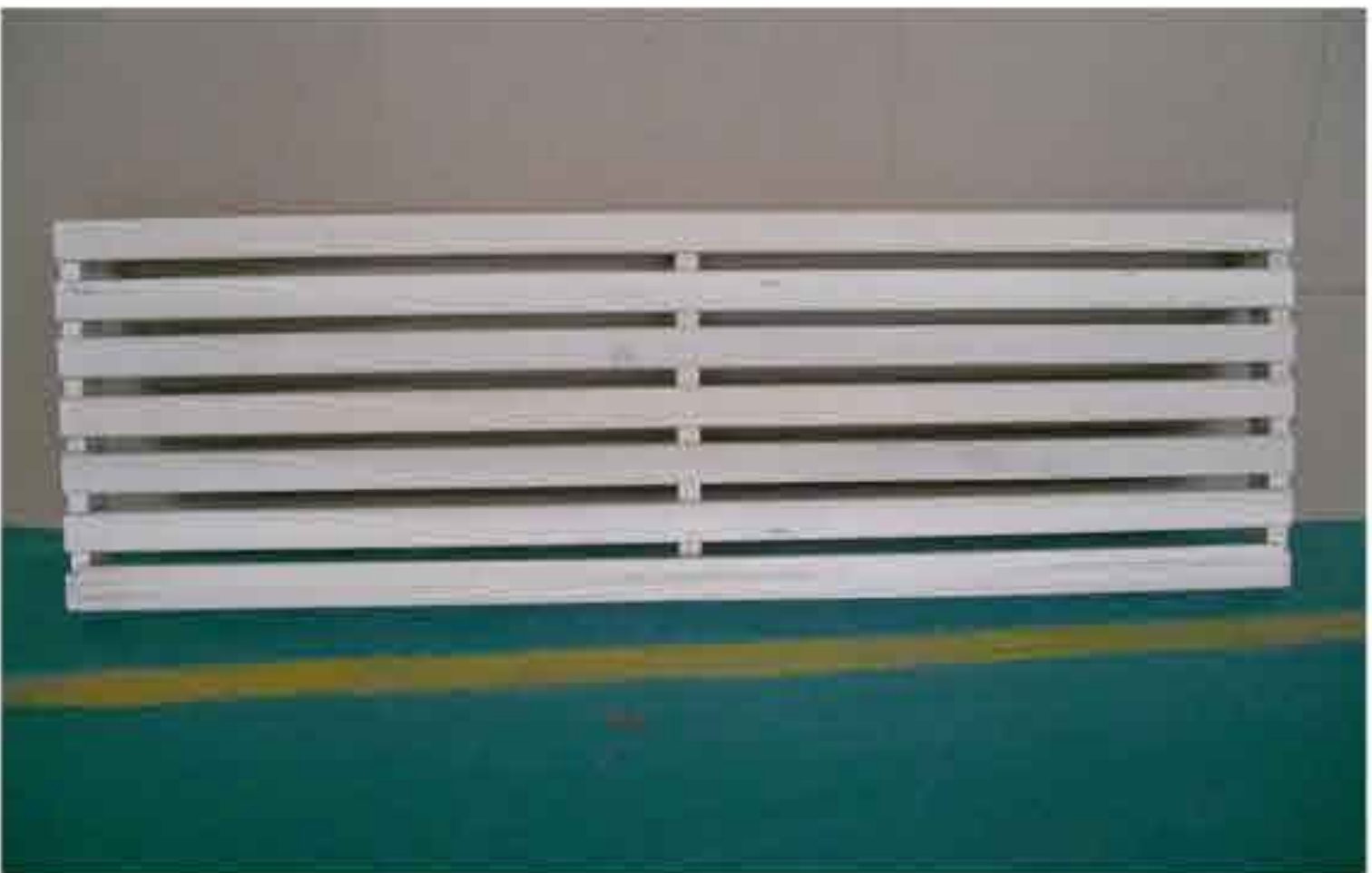

No.	Description	Picture	Qty.
1	Top		1
2	Sauna lamp shade		2
3	Sandglass		1
4	Sauna lamp		2
5	Thermometer		1

<p>6</p>	<p>Upper seat</p>		<p>1</p>
<p>7</p>	<p>Left gable</p>		<p>1</p>
<p>8</p>	<p>Back</p>		<p>1</p>
<p>9</p>	<p>sauna heater</p>		<p>1</p>
<p>10</p>	<p>Upper façade</p>		<p>1</p>

<p>11</p>	<p>Lower seat</p>		<p>1</p>
<p>12</p>	<p>Lower façade</p>		<p>1</p>
<p>13</p>	<p>Heater security fence</p>		<p>1</p>
<p>14</p>	<p>Base</p>		<p>1</p>

B. Installation Instructions

B.1.1 Schematic diagram for installation of 3-person sauna cabin:

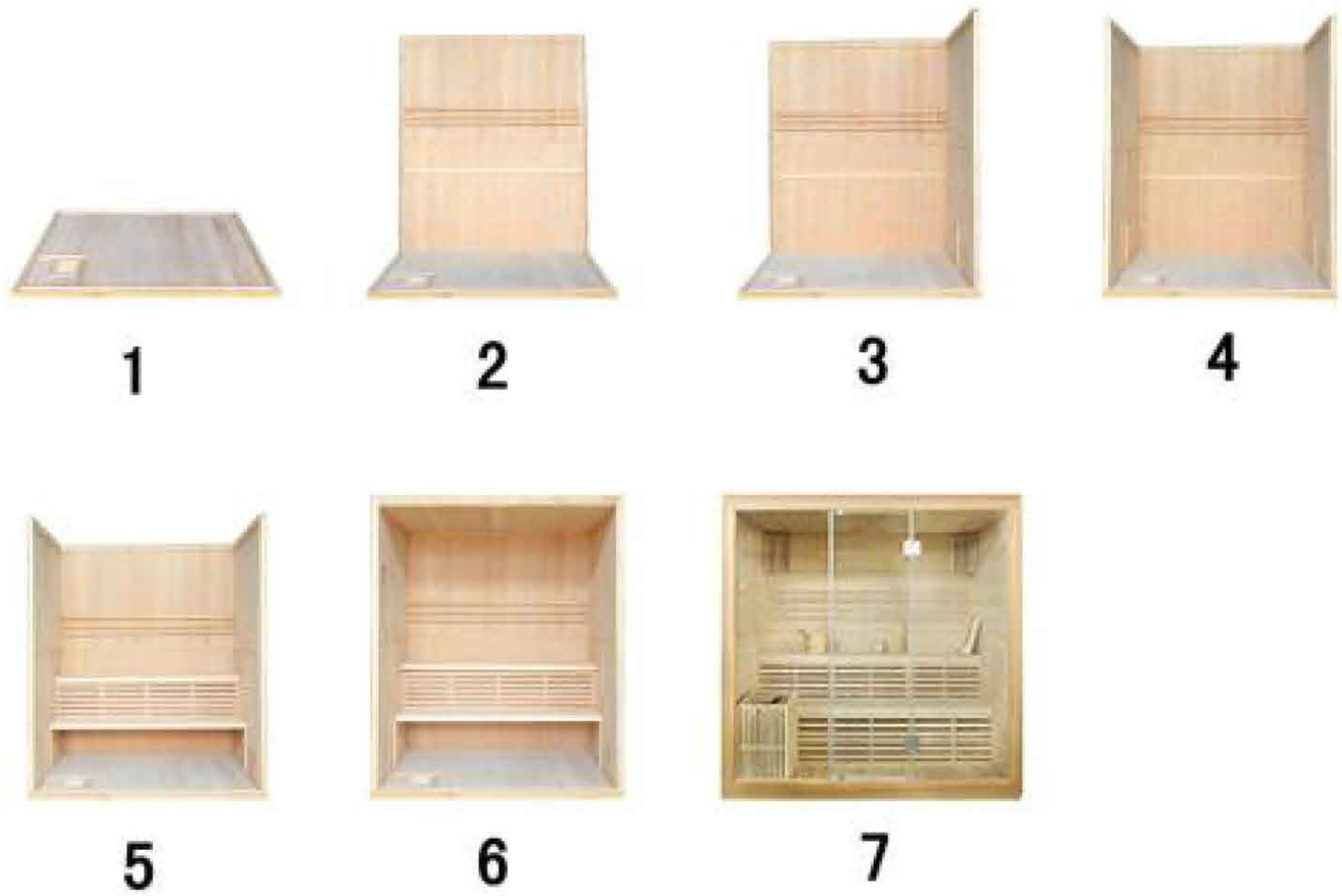

B.1.2 Schematic diagram for installation of pentagonal sauna cabin:



B.1.3 Schematic diagram for installation of octagonal steam cabin:



B.2: details

Note: before installation, place the base on the level ground and keep the right side up, as follows:



B.2.1 Fasten the sauna plate with hasp, as follows:

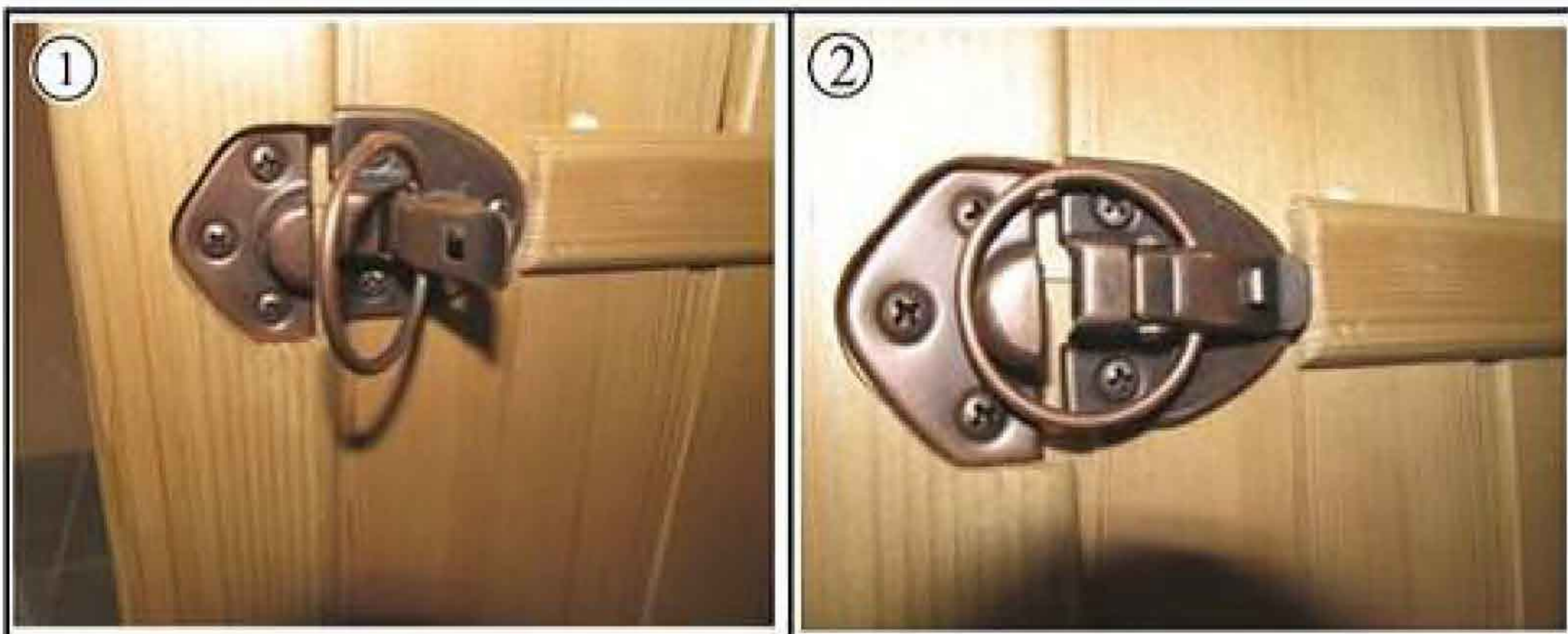

B.2.2 Installation of sauna heater:

Heater A:



Heater B:



Sauna stone:

Put the stones into the heater and place the greatest at the bottom, without too much crowding. Please keep a certain space for ventilation.

1) Stones must be replaced at the time of peeling, to protect the sauna heater

against damage.

2) Diameter of the stones is generally 3~8cm.

3) Firstly wash the stones and then place them into the sauna heater.

4) When connect three wire lines to sauna stove, the three lines must through the bottom two holes of sauna stove, the red line connected to L1, the black line connected to L2, then connected the last one

B.2.3 Installation of sandglass and thermometric



B.2.4 Installation of sauna lamp and security fence

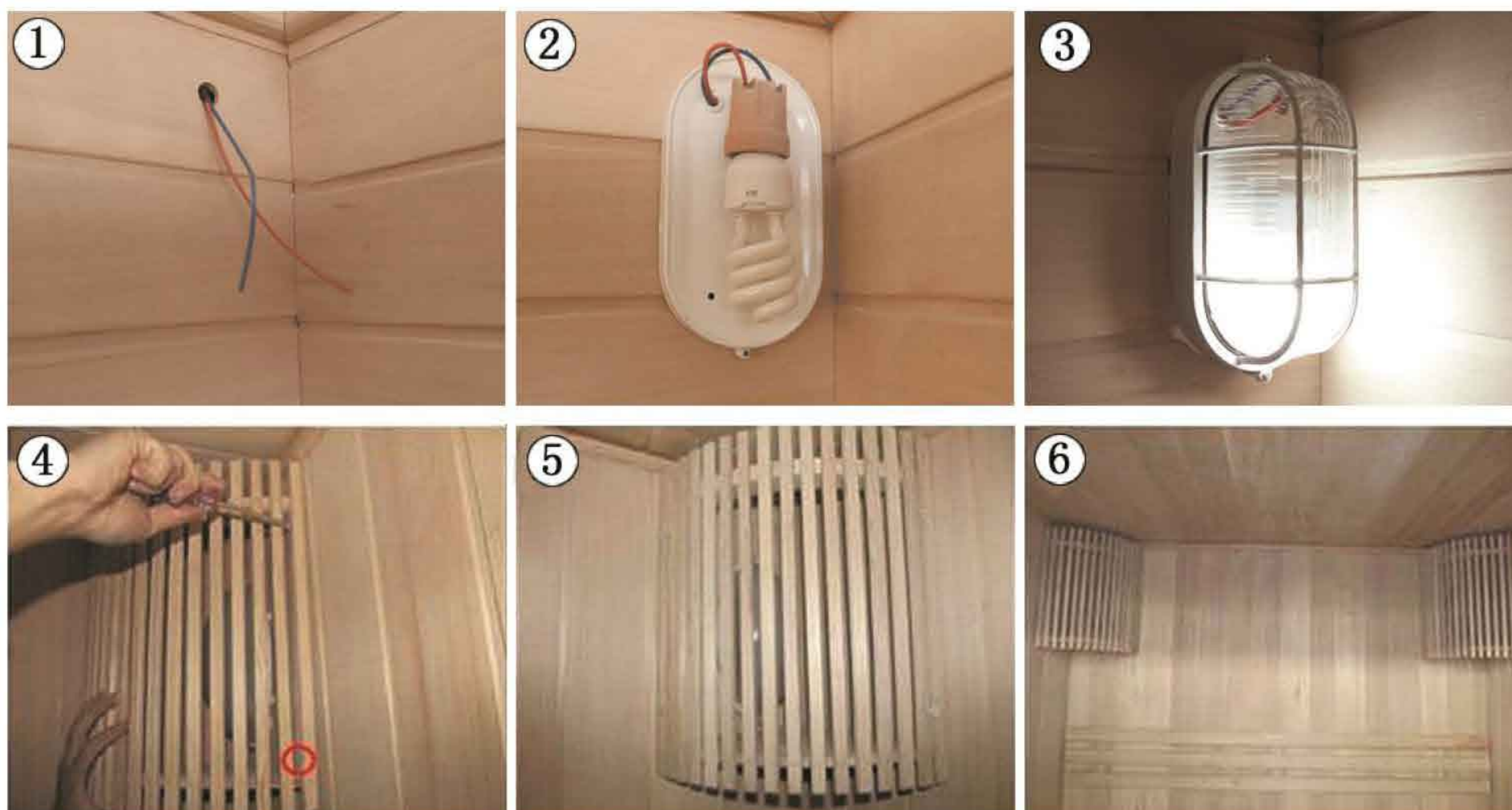

B.2.5 Wire connection

Use rubber insulated cable to connect the main power supply of the heater.



Connection of power line must be completed by professional electrician!

C. Safety cautions:

C.1 Attentions

C1.1 Attention: it is prohibited to install the gate lock for sauna cabin.

C1.2 Attention: the sauna cabin must be well ventilated.

C.2 Safety precautions

C.2.1 DO NOT touch the steam stove with your fingers or any metal tool.

C.2.2 DO NOT touch the sauna lamp by hand.

C.2.3 DO NOT use the sauna cabin under any of the following circumstances:

- 1) Those with unhealed wound, eye disease or serious burn;
- 2) The aged, valetudinarian and especially patients. Pregnant women and babies are prohibited. Children older than age 6 are only allowed to use this product in the company of the adult.
- 3) Patients with hyperthermalgesia, obesity, heart disease, hypertension, circulatory system disease or diabetes must consult the doctor before using this product.

C.2.4 DO NOT bring pets into the sauna cabin.

C.2.5 DO NOT use this product after overdrinking.

D. Tips

D.1 It is recommended to keep the temperature within the range of 60--75°C.

D.2 Sweating is generally started 15~20 minutes after using a sauna. It is recommended that every sauna shall be no longer than 30 minutes.

D.3 Open the vent hole during usage, to keep ventilation in the cabin.

D.4 Drink more water before and after the sauna, to replenish the body moisture.

D.5 Take a bath before using a sauna, to facilitate the perspiration.

D.6 Apply some essential oil on your body, hair or other parts when using a sauna, to facilitate the skin absorption; and clean it after sauna.

D.7 Partial massage can be done when using a sauna, to more favorably alleviate pains.

D.8 Your skin will be very smooth after using a sauna.

D.9 It is recommended to use a sauna one hour after a meal or on an empty stomach.

DO NOT use a sauna immediately after strenuous exercise.

D.10 Increasing the frequency of sauna can help to improve the immunity and inhibit bacteria growth when catching a cold or flu.

D.11 Stay in the sauna cabin for a while after completing the sauna, to sufficiently perspire. Then take a hot bath and it is recommended to finally take a cold bath to cool down the whole body.

D.12 Please consult your doctor for other cautions.

E. Maintenance & Repair

E.1 Clean the box with wet cloth. DO NOT use gasoline, alcohol, benzene or any related chemical to clean the box.

E.2 Ultrasonic can be used to sterilize the sauna cabin in hospital or public places.

F. Transport & Storage of Instruments

F.1 Avoid rain, snow and violent collision during the transportation.

F.2 DO NOT store it in damp conditions.

G. Warranty period

Our quality warranty for equipment and technology of this sauna cabin:

1) Heater: 18 months

2) Technology: 18 months

This quality warranty is only effective for retailers and its validity will be terminated upon the transfer of ownership. The freights shall be borne by the Buyer, including the expenses for replacement of fittings & accessories.

This quality warranty is inappropriate for the change, misuse or abuse of the sauna cabin. Those misuses include nonconformity with the operation & maintenance specified in the operation instruction.

This quality warranty is only valid with regard to the defects of the manufacturer's products, exclusive of any guarantee against loss arising from the user's misoperation.

Our Company shall be not responsible for the loss caused by use of the sauna cabin as well as a series of incidental losses. Furthermore, our Company or related personnel shall assume no liability for any personal injury or property damage. The abovementioned content is possibly inapplicable since the exemption of additional responsibility and the limited liability are denied in some districts. This quality warranty provides the legal rights in details and other different rights would possibly be exercised in different districts.