

Renaissance Cooking Systems



REFR6

Installation Instructions and Owners Manual



Double Tap Outdoor Kegerator

*PLEASE READ THE MANUAL THOROUGHLY PRIOR
TO INSTALLATION, OPERATION, AND MAINTENANCE.*

This owner's manual was updated **November 2021**

www.RCSGasGrills.com



Renaissance

Cooking Systems

TABLE OF CONTENTS

Safety and Installation	1
General Safety	2
Before Operating	3
Troubleshooting	4
Operating Your Appliance	5
Installation	6-7
Warranty	8

SAFETY AND INSTALLATION INSTRUCTIONS

WARNING!

Before the appliance is used, it must be properly positioned and installed as described in this manual, so read the manual carefully. To reduce the risk of fire, electrical shock or injury when using the appliance, follow basic precautions, including the following:

- Plug into a grounded 3 prong outlet, do not remove prong, do not use an adapter and do not use an extension cord.
- Replace all panels before operating
- It is recommended that a separate circuit serving only your appliance be provided. Use receptacles that cannot be turned off by a switch or pull chain.
- Never clean appliance parts with flammable fluids. These fumes can create a fire hazard or explosion.
- Do not store or use gasolines or other flammable vapors and liquids in the vicinity of this or any other appliance. The fumes can create a fire hazard or explosion.
- Do not connect or disconnect the electric plug when your hands are wet.
- Unplug the appliance or disconnect power before cleaning or servicing. Failure to do so can result in electrical shock or death.
- Do not attempt to repair or replace any part or your appliance unless it is specifically recommended in this manual. All other servicing should be referred to a qualified technician.

WARNING!

RISK OF CHILD ENTRAPMENT

1. Child entrapment and suffocation are not problems of the past. Junked or abandoned appliances are still dangerous, even if they will “just sit for a few days.”
2. Before discarding your old refrigerator: Take off the door.

CAUTION!

1. Stainless steel models exposed to chlorine gas and moisture such as areas with spas or swimming pools, may have some discolorations of the stainless steel. Discoloration from chlorine gas is normal.
2. **NEVER USE CHLORIDE TO CLEAN STAINLESS STEEL.**

POWER FAILURE

Most power failures are corrected within a few hours and should not affect temperature of your appliance if you minimize the number of times the door is opened. If the power is going to be off for a longer period of time, you need to take the proper steps to protect the contents.

VACATION TIME

Short Vacations: Leave the appliance operating during vacations of less than three weeks.

Long Vacations: If the appliance will not be used for several months, remove all items and turn off the appliance. Clean and dry the interior thoroughly. To prevent odor and mold growth, leave the door open slightly, blocking it open if necessary.

MOVING YOUR APPLIANCE

- Remove all items.
- Securely tape down all loose items inside your appliance.
- Turn the adjustable legs up to the base to avoid damage.
- Tape the doors shut.
- Be sure the appliance stays secure in the upright position during transportation. Also protect the outside of the appliance with a blanket or similar item.

GENERAL SAFETY REQUIREMENTS

ENERGY SAVING TIPS

- The appliance should be located in the coolest area of the room or outdoor location, away from heat producing appliances and out of direct sunlight.
- Do not overload the beer dispenser as it forces the compressor to run longer.
- Position items so that air can circulate freely around them.
- Do not leave door open for longer than required.
- Make sure items do not touch the back wall of the storage compartment.
- Do not set the thermostat to exceedingly cold temperatures.



WARNING!

FOLLOW WARNING CALL OUTS BELOW ONLY WHEN APPLICABLE TO YOUR MODEL

- Use two or more people to move and install appliance. Failure to do so can result in back or other injury.
- To ensure proper ventilation for your appliance, the front of the unit must be completely unobstructed.
- Choose a well-ventilated area with temperatures above 50°F (10°C) and below 109.4°F (43°C).
- The appliance should not be located next to ovens, grills or other sources of high heat.
- The appliance must be installed with all electrical, water and drain connections in accordance with state and local codes. A standard electrical supply (115 V AC only, 60HZ), properly grounded in accordance with the National Electrical Code and local codes and ordinances is required.
- Do not kink or pinch the power supply cord of the appliance.

- The size of the fuse (or circuit breaker) should be 1.3 amperes.
- It is important that the appliance be leveled in order to work properly. You may need to make several adjustments to level it.
- All installations must be in accordance with local plumbing code requirements.
- Never allow children to operate, play with or crawl inside the appliance.
- Do not use solvent-based cleaning agents or abrasives on the interior. These cleaners may damage or discolor the interior.
- Use this appliance only for its intended purposes as described in this instruction manual.
- Keep fingers out of the "pinch point" areas. Clearances between the door and cabinet are necessarily small. Be careful closing door when children are in the area.

BEFORE OPERATING

SHIPMENT ARRIVING DAMAGED:

VISIBLE DAMAGE

If your shipment arrives with visible damage to the box/carton, be sure the damage is noted on the bill of freight or express receipt and signed by the person making the delivery. File claim for damages immediately, regardless of the extent of damage.

CONCEALED DAMAGES

If damages are unnoticed until the refrigerator is unpacked, notify the transportation company or carrier immediately and file a concealed damage claim with them. This should be done within (5) days of the delivery date. Be sure to hold on to the box/carton for inspection. We cannot assume responsibility for damage or loss incurred in transit.

IMPORTANT NOTES:

CONSTRUCTION ZONES

Keep all stainless steel products away from construction zones. Construction debris such as (but not limited to) stone dust, stucco, and lime dust could damage or permanently discolor stainless steel products. Keep all caustic chemicals including chlorine and pool cleaning products away from stainless steel at all times.



WARNING!

ELECTRICAL PARTS AND COMPONENTS

Disconnect all power supplies and batteries before servicing

INTERIOR LIGHT

This unit is equipped with an interior LED light which will be turned ON when the door is open and the interior fan is stopped at the same time. You can press ∇ to manually turn on or turn off the light.

DEFROSTING

The unit defrosts automatically in normal operating conditions. The evaporator behind the rear wall of the unit defrosts automatically. The condensation collects in the drainage channel behind the rear wall of the unit and flows through the drainage hole into the drip tray by the compressor where it evaporates.

However, frost may accumulate on the evaporator if the unit is repeatedly opened in a high heat or high humidity location. If this frost pattern does

not clear within 24 hours, your unit will require manual defrosting.

Press Δ and hold for 6 seconds, the unit will be defrosted.

To stop defrost, please repeat the same interaction.

TEMPERATURE ALARM

An audible alarm sounds if the storage temperature is not cold enough. The temperature display flashes at the same time.

The cause of the temperature being too high may be:

- Too much warm ambient air flowed in when rearranging and removing stored items.
- Power failure for some time.
- The appliance is faulty.

The audible alarm is automatically silenced and the temperature display stops flashing when the temperature is sufficiently cold again.

CLEANING AND MAINTENANCE

Periodic cleaning and proper maintenance will ensure efficiency, top performance and long life.

The maintenance intervals listed are based on normal conditions. You may want to shorten the intervals if you have pets or other special considerations.

Exterior cleaning for your stainless steel model.

- Turn off the power, unplug the appliance, and remove all items including the dispense kit.
- Wash the inside surfaces with warm water and baking soda solution. The solution should be about 2 tablespoons of baking soda to a quart of water.
- Wring excess water out of the sponge or cloth when cleaning area of the controls, or any electrical parts.
- Wash the outside cabinet with warm water and mild liquid detergent. Rinse and wipe dry with a clean soft cloth.
- Do not use steel wool or a steel brush on the stainless steel. These will contaminate the stainless steel with steel particles and rusting may occur.
- Dust the front grill and back of the unit twice yearly, make sure the power is off before cleaning.
- It is recommended to clean the unit completely inside and out yearly to maximize the longevity of the product.

TROUBLESHOOTING

You can solve many common problems easily, saving you the cost of a possible service call. Try the suggestions below to see if you can solve the problem before calling the servicer.

PROBLEM	SOLUTION	PROBLEM	SOLUTION
Kegerator does not operate	Not plugged in or the appliance is turned off. The circuit breaker tripped or a fuse has blown out.	Vibrations	Check to assure that the kegerator is on a level surface.
Kegerator is not cold enough	Check the temperature control setting. External environment may require a higher setting. The door is opened too often. The door is not closed completely. The door gasket is not sealing properly.	The kegerator seems to make too much noise.	A faint humming noise may come from the flow of the refrigerant, which is normal. As each cycle ends, you may hear gurgling sounds caused by the flow of the refrigerant in your kegerator. Contraction and expansion of the inside walls may cause popping and crackling noises. During the defrosting process you may hear a water flowing sound caused by water flowing through the drain trough. The kegerator is not on a level surface.
Kegerator is turning on and off frequently	The room temperature is hotter than normal. The door is opened too often. The door is not closed completely. The temperature control is not set correctly. The door gasket does not seal properly.	The door will not close properly	The kegerator is not on a level surface. The gasket is dirty. The shelves are out of position.
The light does not work	Not plugged in. The circuit breaker tripped or a fuse has blown. The light bulb has burned out. The light button is "OFF"	Smell/Odor	Check for leaks on inside surface or around the keg coupler.
		Outer surface of appliance is wet	Condensation has formed and can be wiped dry.
		External surface is warm	Compressor is working to transfer heat from inside the cabinet.

BEFORE USE:

- Before connecting the unit to the power source, let it stand for approximately 24 hours. This will reduce the possibility of malfunction in the cooling system from handling during transportation.
1. Position the unit on a flat, level surface capable of supporting the entire weight of the unit. Remember the unit will be significantly heavier once it is fully loaded.
 2. Connect the unit to a Ground Fault Interrupter (GFI).
 3. The unit must be installed according to your local codes and ordinances.
 4. **ELECTROCUTION HAZARD!**
 - Electrical Grounding Required - This appliance is equipped with a three prong (grounding) polarized plug for your protection against possible shock hazards.
 - NEVER remove the round grounding prong from the plug.
 - NEVER use a two prong grounding adapter.
 5. Remove the exterior and interior packaging, but do not remove any foam insulation surrounding the pipes at the back.
 - Clean the interior surface with lukewarm water using a soft cloth.
 - Place the unit on a flat, solid floor that is strong enough to support it when it is fully loaded. To level the appliance, adjust the rolling casters at the bottom of the unit.
 - When moving your kegerator, please do not incline it more than 45 degrees.
 - Locate the appliance away from direct sunlight and sources of heat (stove, heater, radiator, etc.). Direct sunlight may affect the acrylic coating and heat sources may increase electrical consumption. Extreme cold ambient temperatures may also cause the unit to perform improperly. The optimal ambient temperature range is 50°F - 109.4°F. Do not mount the draft tower remotely, as the exposed beer line will not be refrigerated, causing foam.
- Avoid locating the unit in damp areas.
 - Unwind the power cord to its full length and inspect for damage before plugging into the outlet.
 - Plug the kegerator into an exclusive, properly installed and grounded wall outlet.
 - Do not under any circumstances cut or remove the third (ground) prong from the power cord. Any questions concerning power and/or electrical grounding should be directed to a certified electrician or authorized products service center.
 - After plugging the appliance into a wall outlet, allow the unit to cool down for 3 to 4 hours before installing a keg in the appliance.
- It is recommended that you install the appliance in a place where the ambient temperature is between 50°F and 109.4°F (10°C-43°C). If the ambient temperature is above or below recommended temperatures, the performance of the unit may be affected. For example, placing your unit in extremely cold or hot conditions may cause interior temperatures to fluctuate. The operating temperature range may not be reached.

OPERATING YOUR APPLIANCE

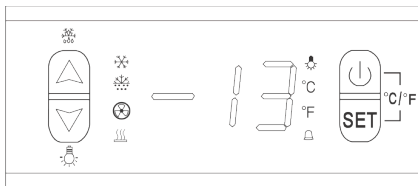

CONTROL PANEL



ON/OFF Power

To turn the appliance ON or OFF, press and hold the POWER key  for 5 seconds.

UP and DOWN

Press  first, then press  or  button to increase (warm) or decrease (cool) the set temperature by 1°C/1°F.

Press  again the temperature is selected and shows the actual temperature. If no other further operation in 6 seconds, display will show actual temperature in the cooler

°F/°C SELECTOR

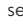
Selects the temperature display setting in Fahrenheit or Celsius degrees. To change the temperature from Fahrenheit to Celsius or from Celsius to Fahrenheit, press  and  at the same time, then hold for 6 seconds.

SETTING THE TEMPERATURE CONTROL

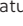
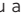
The temperature you are setting will increase by one degree each time you press the  key and will decrease by one degree each time you press the  key.

The range of temperature control is from 32°F to 50°F.

To view the set temperature at any time, press the  key. The set temperature will flash in the display window for 6 seconds. After 6 seconds, the temperature inside the unit will reappear in the display window.

(The temperature preset at the factory is 36°F)

BEFORE USING YOUR APPLIANCE

Remove the exterior and interior packing.

Before connecting the appliance to the power source, let it stand upright for approximately 24 hours. This will reduce the possibility of a malfunction in the cooling system from handling during transportation.

Clean the interior surface with lukewarm water using a soft cloth.

Install the handle on the door if not already attached.

OPERATION INSTRUCTION

The Kegerator is able to maintain the proper dispensing temperature for beer, provided it is installed correctly in the proper environment. For best results, mount the draft tower as close to the top of the kegerator as possible and seal any openings to prevent heat transfer. Avoid opening and closing the door of the kegerator too often to ensure a consistent temperature inside the unit. Factory preset temperature is 36 degrees Fahrenheit.

The Kegerator should be placed in an area where the ambient temperature range is between 50-109.4 degrees Fahrenheit (10-43 degrees Celsius). If the ambient temperature is above or below this range, the performance of the unit may be affected. For example, placing your unit in extreme cold or hot conditions may cause interior temperatures to fluctuate. Please be aware that the desired temperatures may fluctuate depending on the ambient temperature and the orientation of the keg.

ELECTRICAL CONNECTION

Put the screws on top of the door where the handle is to be installed. Align the handle with screws, tighten the screws using the screwdrivers.



WARNING!

Improper use of the grounded plug can result in the risk of electrical shock. If the power cord is damaged, have it replaced by a qualified or an authorized service dealer.

INSTALLATION

STEP 1

Unpackage your kegerator and lay out the kegerator parts on a flat surface, ensuring you have the following:

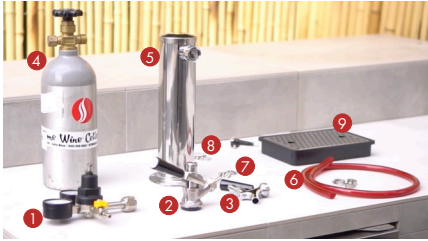

1. CO2 Regulator
2. Keg Coupler
3. Keg Tap & Handle
4. CO2 Tank
5. Keg Tower w/Hose
6. Red Hose w/ 2 Fasteners
7. 4 Short Bolts & 4 Metal Washers
8. 4 Long Bolts, 4 nuts & 2 Rubber Washers
9. Tap Tray
10. Keys

STEP 2

Then, guide the translucent hose through the kegerator opening, or if you have an island, as shown, guide it through both openings. If mounting to a counter-top, secure your tower using the four long bolts & nuts, and 2 rubber washers. If mounting directly onto your kegerator, use the 4 short bolts and metal washers.

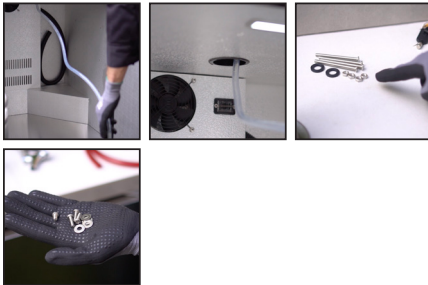

STEP 3

Now, screw the tap handle onto the keg tap, and fasten the keg tap to the tower by rotating counterclockwise.



STEP 4

Locate the translucent hose connected to the Keg Tower, and attach it to the Keg Coupler. Then, connect the Keg Coupler to your keg by pushing down and twisting clockwise to lock it in.

DO NOT PUSH DOWN THE BLACK LEVER ON KEG COUPLER



STEP 5

Then, attach the regulator to the CO2 tank, using an adjustable wrench to avoid leakage. Place a metal fastener around the neck of the red hose, and attach the hose to the nozzle of the regulator. Tighten the fastener using a flathead screwdriver. Place another metal fastener around the other end of the red hose, and attach to the nozzle on the Keg Coupler. Tighten the metal fastener. Twist counterclockwise to open the CO2 tank. Unscrew the pressure valve until loose, and then re-screw until the pressure gauge reads "12"

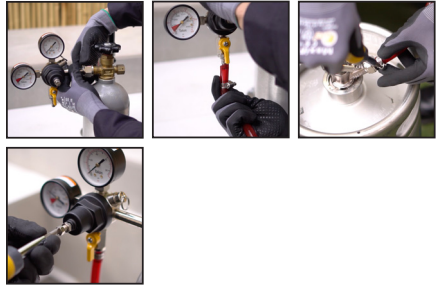

STEP 6

Place your CO2 tank onto the shelf, and then lift the keg into the kegerator. Tap your keg by pulling out the black lever of your keg coupler, pushing down, and releasing. Make sure your keg completely cools before use. Place the Tap Tray below the tap.

POUR AND ENJOY!

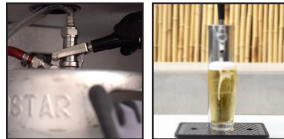

INSTALLATION

ELECTRICAL CONNECTION CONTINUED

This appliance should be properly grounded for your safety. The power cord of this appliance is equipped with a three-prong plug which mates with a standard three-prong wall outlet to minimize the possibility of electrical shock.

Do not under any circumstance cut or remove the third (ground) prong from the power cord supplied. For personal safety, this appliance must be properly grounded. Any questions concerning power and/or grounding should be directed toward a certified electrician or an authorized service center.

The appliance requires a standard 115/220 Volt AC-60HZ three-prong grounded electrical outlet. Have the wall outlet and circuit checked by a qualified electrician to make sure they outlet is properly grounded. When a standard 2-prong wall outlet is encountered, it is your responsibility and obligation to have it replaced with a properly grounded 3-prong wall outlet.

To prevent accidental injury, the cord should be secured behind the appliance and not left exposed dangling.

The appliance should always be plugged into its own individual electrical outlet which has a voltage rating that matches the rating label on the appliance. This provides the best performance and also prevents overloading house wiring circuits that could cause a fire hazard from over heating. Never unplug the appliance by pulling on the power cord, always grip the plug firmly and pull straight out from the receptacle. Repair or replace immediately all power cords that have become frayed or otherwise damaged. Do not use a cord that shows cracks or abrasion damage along its length or at either end. When moving the appliance, be careful not to damage the power cord.

EXTENSION CORD

Because of potential safety hazards under certain conditions, it is strongly recommended that you do not use an extension cord with this appliance. However, if you must use an extension cord it is absolutely necessary that it be a UL/CUL-Listed, 3-wire grounding type appliance extension cord having a ground type plug and outlet and that the electrical rating of the cord be 115 volts and at least 1.3 amperes.

INSTALLING THE STAINLESS STEEL HANDLE

This appliance includes a stainless-steel handle that is not required to operate this unit. To install the handle please follow the below instructions:

1. Pull away the door gasket in the area where the handle is to be installed as shown in illustration. The gasket is easily displaced by hand, no tools are necessary.
2. Locate the screws included in the bag with the user's guide. Insert the screws into the holes as shown.
3. Align the handle with the screws installed. Tighten the screws using a Phillips head screwdriver until the handle sets both flush and secured tightly against the door frame. (DO NOT over tighten as this will cause damage to the handle assembly).
4. Replace the door gasket to its original Position.

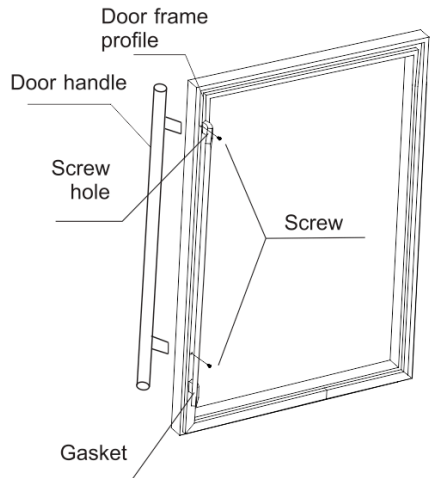



Renaissance

Cooking Systems

Renaissance Cooking Systems Product Warranty

RCS is proud to provide the industries most comprehensive warranty program.

All RCS refrigeration and sink products are warranted to be free from manufacturer defects for 5 years to the original owner.

For service assistance, please reach out to us at the email address below. You may also check our website for lots of great information on using, servicing, or cooking on your new RCS grill.

This warranty excludes normal surface corrosion, discoloration, surface scratches and surface rust which may occur. Improper maintenance, salt spray, chemicals, pesticides will affect the look and integrity of the components of this grill. RCS will not be responsible for any damage caused as a result of not following owner's manual instructions. This non-transferrable warranty is limited to the replacement of original (one-time) defective parts, does not include shipping and labor to remove or install replacement parts, if necessary. The owner must retain and submit their original receipt with any warranty claim to receive warranty parts. The warranty applies to the original owner only. Coverage is for residential use only, no commercial applications apply. No registration required.

For more information, questions or assistance please contact us at:
RCSGasGrills.com ~ CustomerService@RCSGasGrills.com