

In-Use Screen

After a Massage program is selected, In-use screen displays all settings to that program.

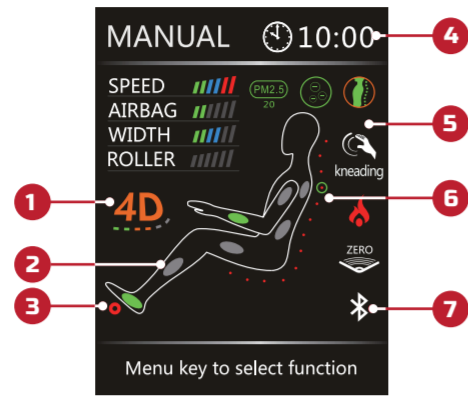

- 1 4D intensity level
- 2 Active airbags
- 3 Active rollers
- 4 Time remaining
- 5 Indicators
- 6 Back-roller position & direction
- 7 Bluetooth connected

Chromotherapy

Your massage chair has chromotherapy lights located on the outside of the chair body. These lights will come on automatically once an auto program is selected and will fade from one color to another.

Air Ionizer

Press the **MENU** button on your remote control to bring up the home display. Select **AIR IONIZER** from Home display, press right button, then press up or down button to select your desired air ionizer setting: On, or Off. Press **OK** button to select the setting.

My Memory

Your chair has the ability to save your favorite customized massage programs to memory. To do this, **create a manual message program** (see User Manual for instructions) with all of your desired air, heat, speed, and intensity settings.

Storing a memory program:

After creating your custom massage in manual mode, select **AUTO** from the Home display and scroll to the bottom of the page. Here you will see **Memory A** and **Memory B**. Press **OK** button to select either A or B then select "Save". If you save over the top of an existing memory program, the existing program will be erased and replaced by the most recent save.

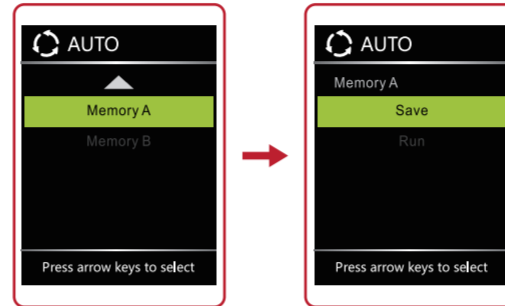

Loading a memory program

Select **AUTO** from the Home display and scroll to the bottom of the page. Select **Memory A** or **Memory B** and then select "Run". The chair will now run the program you created.

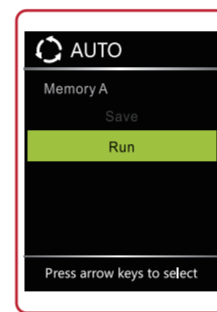

KYOTA®

Quick Start Guide

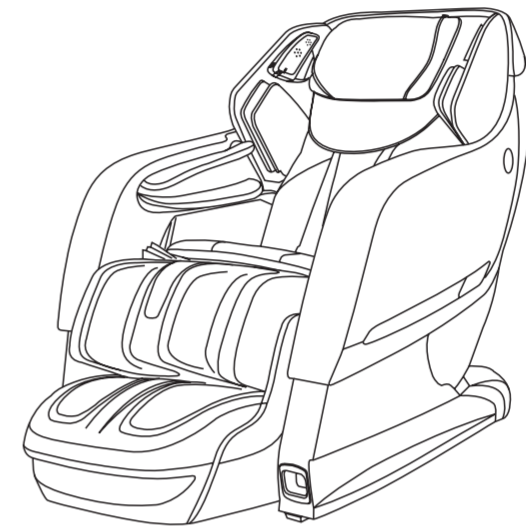

M868 Yosei 4D Massage Chair

KYOTA | The World's Most Advanced Massage Chairs®
72 Stard Road, Seabrook, NH 03874 | (800) 242-0761
www.kyotamassagechairs.com
Version 1.0

KYOTA®

Multi-Functional Screen - Use the directional buttons below to navigate these menu screens. Then press OK to select.

On/Off - Powers up the remote or returns the chair to the exit position and powers down remote.

Menu - Shortcut to the home page of all menu screens.

OK - After navigating to the command desired on the display, push OK to select.

During the massage, press OK button to switch to zero gravity.

Feet Adjust - Press and hold up arrow to bring foot rest up, press and hold down arrow to bring foot rest down.

Feet Extend - Press and hold to extend the footrest and increase the leg length.

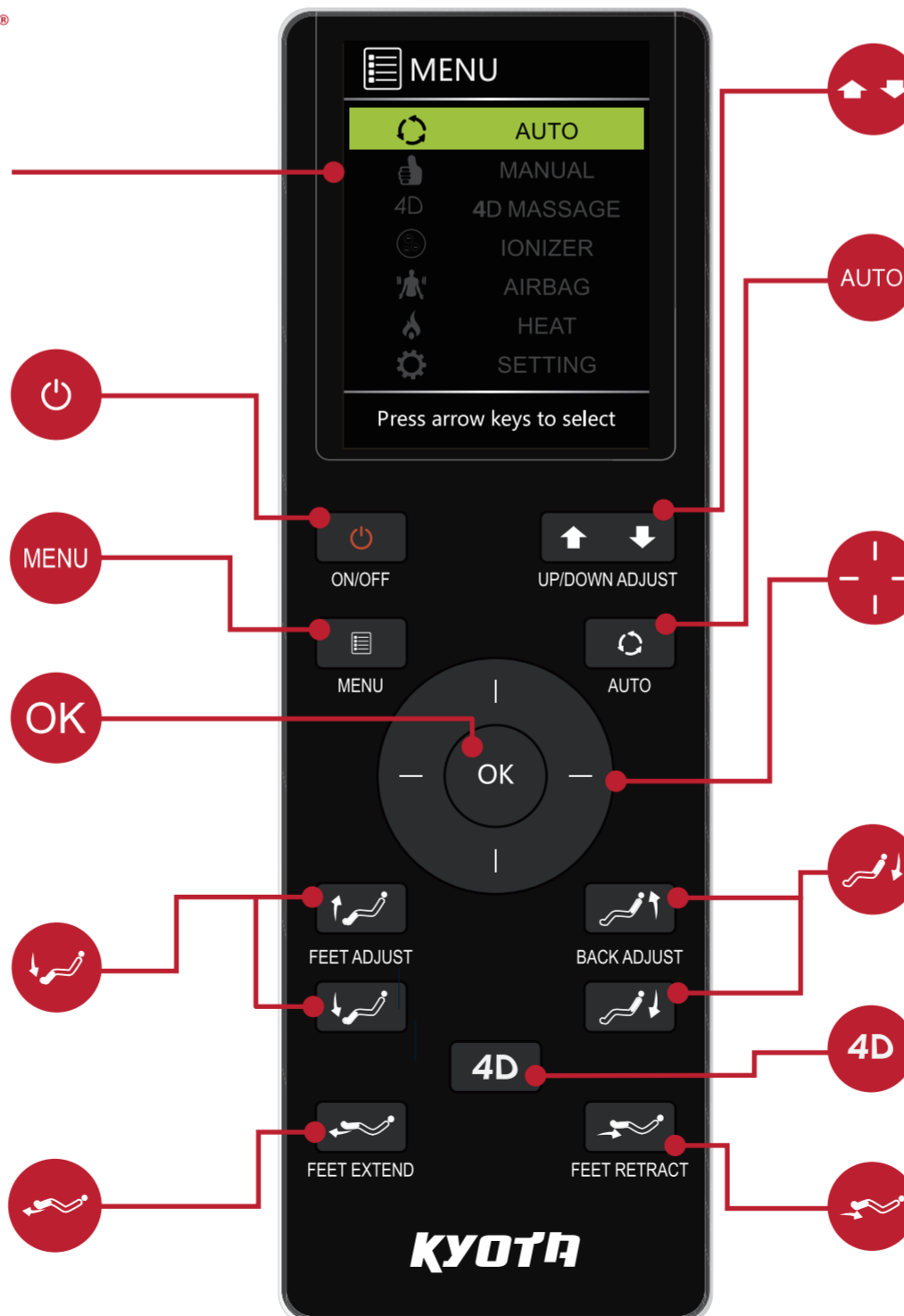

Back Adjustment - Back mechanism position adjustment; press and hold up to raise, press and hold down to lower. Use during initial body scan fine tuning or in manual point zone mode.

Auto - Select from seven pre-set massage programs:

- Sports Refresh
- Extension
- Rest & Sleep
- Working & Relief
- Neck & Shoulder
- Waist & Spine

Directional Button - Press up, down, left or right to navigate the display screen.

During the massage, press up or down button to adjust mechanism speed. Press left or right button to adjust airbag force.

Seat Back Adjust - Press and hold down arrow to recline the seat back, press and hold the up arrow to upright the seat back.

4D - Press to increase or decrease 4D intensity of back mechanism. In-use screen displays intensity dial.

Feet Retract - Press and hold to retract the footrest and decrease the leg length.