

INSTRUCTIONS FOR USE

2023

TABLE OF CONTENTS

01	IMPORTANT INFORMATION	1
02	PRODUCT INFORMATION	2
03	WHAT'S IN THE BOX?	3
04	WHICH FUEL TO USE?	3
05	GENERAL INFORMATION	4
	BEFORE FIRST USE	
	FIRE	
	CARBON MONOXIDE	
06	GAS SAFETY	5
07	CONNECTING THE GAS PART	7
08	GAS LEAK	9
09	FIRST FIRING	10
	Firing with lighter	
	Firing with piezo	
10	PRE-BAKING	11
11	CARE INSTRUCTIONS	12
	Where should I store the oven?	
	How do I clean the oven?	
	How do I clean the cooking stone?	
	How do I turn off the Glöwen Dragon?	

TABLE OF CONTENTS

12	CLEANING & MAINTENANCE	12
13	STORAGE	12
	Where do I store Glowen Dragon?	
14	TROUBLESHOOTING	13
	I notice a change in colour on the oven	
	The oven temperature is too high	
	The oven temperature is too low	
	The cooking stone cracked	
15	SAFE USE	14
16	WARRANTY	15
	What does the warranty cover?	
	What does the warranty not cover?	
	Warranty Claims	
17	EU DECLARATION OF CONFORMITY	16
18	OVEN DIMENSIONS	17

IMPORTANT INFORMATION**IMPORTANT**

Your safety is most important, therefore read the attached instructions carefully and save them for later use.



Glowlan Dragon is designed for outdoor use, therefore do not use it indoors.



Never use the oven without supervision.



Do not use the oven in strong wind.



Always use heat-resistant gloves when using the oven.



Do not put hands and other limbs inside the oven.



Do not touch the exterior of the oven while using it.





Blowing into the oven is strictly forbidden.



Keep children and animals away from the oven while using it.

PRODUCT INFORMATION

Glow Seven d. o. o. Ljutomerska cesta 22, 2270 Ormož, Slovenia				
Appliance Name:		Glowen Dragon Gas Oven		
Model/Type No.:		GDGO 1.1		
Trade Name:		Glowen Dragon		
Total nominal heat input:		7 kW (506 g/h) for I _{3B/P(30)} , I _{3*(28-30/37)} 7,9 kW (566 g/h) for I _{3B/P(50)}		
Injector Size:	1,4 mm	1,4 mm	1,4 mm	1,4 mm
Gas Category:	I _{3*(28-30/37)}		I _{3B/P(30)}	I _{3B/P(50)}
Gas Type:	Butane	Propane	Butane, propane or their mixture	Butane, propane or their mixture
Gas Pressure:	28-30 mbar	37 mbar	28-30 mbar	50 mbar
Destination Countries:	BE, FR, IT, LU, IE, GB, GR, PT, ES, CY, CZ, LT, SK, CH, SI, LV		LU, NL, DK, FI, SE, CY, CZ, EE, LT, MT, SK, SI, BG, IS, NO, TR, HR, RO, IT, HU, LV	AT, DE, SK, CH, LU
Pin code:	 <p>Use outdoors only. Read the instructions before using the appliance. WARNING! Do not use spirit or petrol for lighting or re-lighting. WARNING! Accessible parts may be very hot. Keep young children away.</p>			

WHAT'S IN THE BOX?

1. Oven

The fully insulated main chamber retains all the necessary heat. Integrated non-slip feet ensure that the oven stands firmly and safely.

2. Cooking stone

Clay stone that retains the necessary heat.

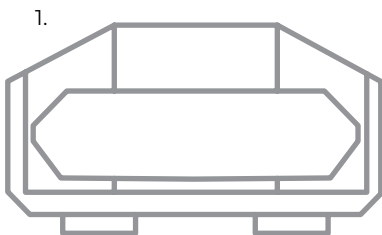

WHICH FUEL TO USE?

GLOWEN DRAGON is designed for use with gas burner. The oven heats up super-fast and retains heat. The air circulation is the same as in real, masonry wood-burning ovens.

The highest temperature is at the top of the chamber, the lowest where air enters the oven. Burn slowly and observe, and measure the temperature if necessary.

Before you start cooking again, clean the oven.

GENERAL INFORMATION



BEFORE FIRST USE

Before starting with your culinary creations with the new Glowen Dragon oven, carefully read the instructions to familiarize yourself with the oven's features and save them for any questions you may have later.



WARNING:

This appliance will become very hot, do not move it during operation.

FIRE

Most fires are caused by a grease buildup or an improper gas connection. Ensure all people and pets are kept as far away as possible.

If you are able, turn the gas off at the cylinder or the on/off valve. Use a fire extinguisher if possible.

If water is the only fire retardant available, thoroughly soak the area around the appliance.

When spraying water on the Dragon itself, do not use a strong jet of water, as this may cause splashing of burning grease.

CARBON MONOXIDE

Carbon monoxide is a colorless, flammable, and highly toxic odorless gas. It is the main product of incomplete combustion of carbon and carbon-containing compounds.

May cause symptoms such as headache, dizziness, weakness, nausea, vomiting...

Therefore, please note that the oven is intended for OUTDOOR USE and should never be used indoors.

GAS SAFETY

Check the oven before use.

If the device shuts down, reduce the gas supply to the regulator and turn off the gas valve, wait 5 minutes and try again.

The warranty does not cover damage caused by fat.

If a fat fire occurs, immediately shut off the gas supply to the valve and remove all food from the oven.

Before use, check the valve for leaks.

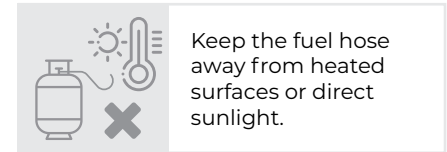
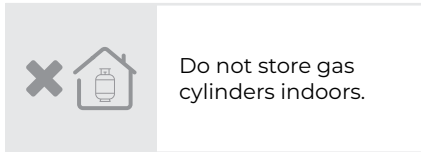
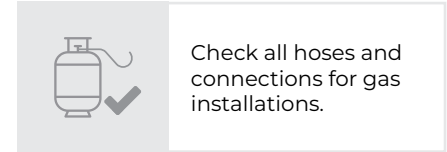
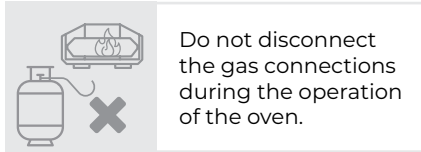



Do not use any additional flammable substance while operating with gas.



A regulator which complies with EN16129 must be fit between the gas cylinder and the oven.



Maximum length of hose cannot exceed 1.5m. In Finland, hose length cannot exceed 1.2m.



Do not touch! The Dragon can get extremely hot when in operation. Wear protective gloves.



Do not position the gas cylinder under the oven.



National requirements state how often to replace the hose. Please review this for your area.



Keep the gas cylinder out doors in it's up right position.



Never use a naked flame to check for gas leaks.



Never fill the cylinder beyond 80 percent full.



Do not connect multiple gas cylinders to Dragon. Store a spare with in the same vicinity.



Do not use natural gas! It can damage the oven.



Make sure the flexible hose is not twisting when the oven is in operation.

CONNECTING THE GAS PART

1. Please make sure you have the suitable gas and gas regulator for your country. 

2. Please make sure you turn the valve in clockwise direction until it stops.



3. Push the hose on the valve.

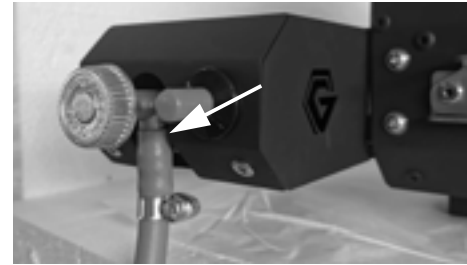

4. Please make sure you put the hose to the end.

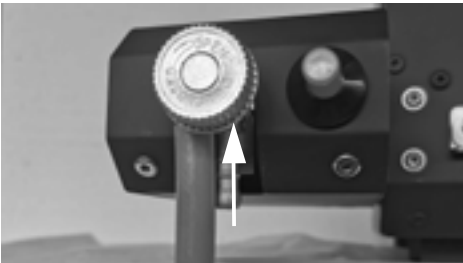

5. Tighten the clamp in clockwise direction.



6. Push the hose on the gas regulator.



7. Make sure you push the hose to the end.

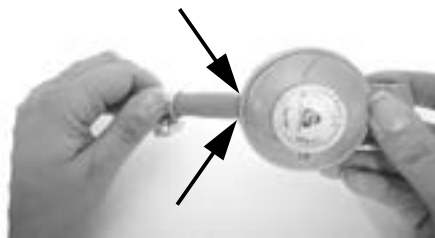

8. Tighten the clamp in clockwise direction.



9. Screw thread gas regulator to gas cylinder.



Ensure the gas is turned off on the gas cylinder by twisting the handle anticlockwise.

Whilst aligning the regulator with the gas cylinder twist the handle and ensure a tight fit has been made.

10. When all connections are made and tested with a mixture of soap and water you can open the valve on the gas cylinder.



11. When the gas is open test for the leaks.

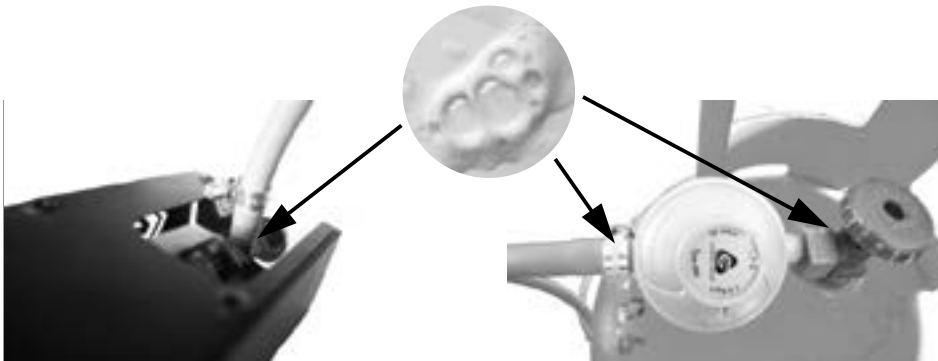

GAS LEAK

Use a mixture of soap and water to test for gas leaks. Apply the mixture to all joints and areas where any cracks appear. If no bubbles appear on the joints, the joints are well sealed. If bubbles appear, the tightness is poor and you need to fit them better.

Each time you disconnect and reconnect the gas connection, you must check all gas connections. Do not ignite the oven when checking for leaks.

Do not use an open flame to check for leaks. Replacement of the gas cylinder must be carried out away from any ignition sources.

Recheck for leaks with soap and water mixture. If leakage persists after retightening, turn off the gas and **DO NOT USE THE OVEN.**

FIRST FIRING

Firing with lighter

1. Light the lighter outside the oven.
2. Push the lighter in the hole on the oven.
3. Make sure the lighter is burning. Then twist the valve anticlockwise.

Firing with piezo

1. Twist the valve anticlockwise and push the piezo lighter button.

If the oven won't fire, push the piezo lighter button again till it fires. If it won't fire in 5 seconds, turn the gas off and wait a few minutes before firing again or fire it with lighter.

TIP: For the first firing after purchasing we highly recommend firing the oven at its lowest temperature for 30 minutes before setting it to high flame this will help cure the oven.

PRE-BAKING

Before the first use, fire up the oven and let it heat up at the highest temperature for at least 45 minutes. The process is called pre-baking.

After that, allow the oven to cool down and wipe the inside with a dry cloth. This disinfection process will burn oils and coatings left over from the manufacturing process. In this step, it smokes harder from the oven, since it is necessary for the paint coatings to burn completely onto the oven. Now the oven is ready for cooking.

The first step to delicious food is high quality fuel. When burning gas, always check the gas connections, tank, hoses and regulator to prevent any gas leaks.

Place the oven on a solid enough base to hold the oven and the necessary ingredients. We recommend metal or stone surfaces, but we do not recommend using glass or plastic surfaces.

If you need a lower temperature or just a little rest, you can simply reduce the gas supply with the gas valve. It is recommended to clean and move the oven when it has cooled down (approximately 2 hours after the end of cooking).

It is essential to store the cold oven in a dry and airy place. Never use water to cool the oven.

CARE INSTRUCTIONS

Where should I store the oven?

We recommend that you store the GLOWEN DRAGON in a dry and closed place when not in use to protect the oven from various weather conditions.

How do I clean the oven?

Always wait for the oven to cool completely before cleaning. If necessary, clean the inside with a dry cloth. The outer surfaces can be wiped with a damp cloth and dried completely before storing the oven.

How do I clean the cooking stone?

Clean the cooking stone by firing the GLOWEN DRAGON oven at the highest temperatures. If you need to remove heavier food debris, use a brush. Make pizzas and dough-based dishes directly on the stone, other dishes in cast iron pans.

How do I turn off the Glowen Dragon?

Just turn off the gas supply! Cooling also depends on the ambient temperature. Do not use water to cool the oven.

CLEANING & MAINTENANCE

We recommend cleaning and inspecting before each use for the oven to operate optimally. Clean the cooled oven's burner with a brush and blow it out with the help of compressed air.

No chemicals. No abrasive methods. No fuss.

Protect the Dragon from adverse weather, including rain and high winds.

General cleaning: Make sure the holes on the gas burner are always clean from food and other things.

STORAGE

Glowen Dragon provides an outstanding modern baking experience for you, your family, and your friends. Handle the oven with all the love and tenderness because only then will it last forever.

Where do I store Glowen Dragon?

Glowen Dragon is stored in a dry and closed place to protect against weather conditions. Glowen Dragon must be completely dry and cooled before storage. Suppose you are near the sea or store saltwater, Glowen Dragon indoors / sheds, so sea salt does not damage the oven.

TROUBLESHOOTING

On the first pre-baking, the oven will smoke slightly differently due to the additional baking of the paint on the surface. After prebaking, it will burn with minimal smoke during use.

I notice a change in colour on the oven

Glowen Dragon is made of high quality painted stainless steel. You can notice some colour changes - patina - on the steel after repeated heating cycles, but these do not affect the quality of the oven. Remember to store the oven in a dry and closed place.

The oven temperature is too high

Correcting with fuel is the easiest way to cool the oven. If it is too hot in the oven, simply reduce the flame with the gas valve and wait for it to cool to a suitable temperature.

The oven temperature is too low

The Glowen Dragon needs to be heated for about 15 minutes. If the temperature is too low, increase the flame with the gas valve.

Note: Heating may take longer if your oven has been exposed to rain or extreme cold.

The cooking stone cracked

The cooking stones are made of natural material and crack when exposed to a too high temperature too quickly. Prebaking should be moderate. The stones are consumables and are not covered by the warranty.



If you have any questions or comments, email us at info@glowen.si

SAFE USE

- Glowen Dragon should only be used outdoors or in a well-ventilated area.
- Do not use the oven in a tent.
- Do not use the Glowen Dragon on enclosed balconies.
- Glowen Dragon is not suitable for use in vehicles or trunks.
- Place the oven on a flat, non-combustible surface with no residual combustible materials.
- Do not try to use the burner with other ovens.
- Do not use burners that are not part of the Glowen Dragon or unapproved third-party burners in the Glowen Dragon oven.
- Do not remove the burner during use.
- Before use, ensure the burner is securely and correctly installed.
- Do not store flammable materials near the Glowen Dragon.
- Do not attempt to add flammable liquids into the oven during use.
- Always use heat-resistant gloves when using the Glowen Dragon oven.
- Before using, check all components for damage.
- Tighten all gas fittings with a wrench and do not overtighten.
- Before using the oven, check the joints for leaks with soap. Never check for leaks with a free flame.
- Before use, ensure the burner is securely and correctly installed.
- Never try to disconnect the gas regulator during use.
- Do not smoke near the oven and gas supply.
- It is always necessary to use a gas regulator for gas supply.
- Do not store gas cylinders indoors.
- Always keep gas cylinders upright.
- Do not use more than one cylinder for gas supply.
- Do not use natural gas, only propane or butane.
- Do not use additional flammable substances.
- Make sure that the gas hose is not twisted during operation.

WARRANTY

What does the warranty cover?

The warranty applies to the Glowen Dragon oven.

This warranty is not transferable and only applies to the original purchaser. An original invoice is required to enforce the warranty.

Glow seven d.o.o. guarantees that the products (hereinafter the product) will not have defects in workmanship and materials.

The warranty is valid for 2 years from the date of purchase. If Glow seven d.o.o finds irregularities, the product or spare part will be replaced free of charge.

We ensure the product's maintenance and provision of spare parts within the statutory period (Article 18 of the Slovenian Consumer Protection Act).

What does the warranty not cover?

The warranty does not apply in cases where the customer has not complied with the enclosed instructions.

The warranty does not cover damage or defects resulting from normal wear and tear of the product, misuse, negligence, improper maintenance, accident or discoloration of the product. The warranty does not cover damage to the product due to use for purposes other than intended. It also does not apply if an unauthorized or unprofessional person has tampered with the product.

The warranty does not cover damage to products purchased at unauthorized points of sale, including third parties and retailers from Bolha, Amazon, E-bay websites.

The warranty does not apply to clay stones.

Warranty Claims

All warranty claims must be submitted directly to Glow seven d.o.o, namely to info@glowen.si with the subject "Warranty claim during the warranty period" with the original invoice attached and an explanation of the defect on the product. Incomplete returns will not be accepted. When Glow seven d.o.o. receives your warranty claim, it confirms or rebuts it (usually 7-10 business days).

After confirming the complaint, you can return the damaged product through registered mail at the company's expense. You are responsible for the customs duties and taxes that arise.

Glow seven d.o.o. is not responsible for products lost during transport.

EU DECLARATION OF CONFORMITY

Manufacturer's Name: Glow Seven d.o.o.

Manufacturer's Address: Ljutomerska cesta 22, 2270 Ormož, Slovenia

Here with declare that this product

Product: **Glowen Dragon Gas Oven**

Model(s)/Type(s): **GDGO 1.1**

Tradename: **Glowen Dragon**

Is in conformity with the following harmonized standards have been applied: **EN498:2012**

OVEN DIMENSIONS

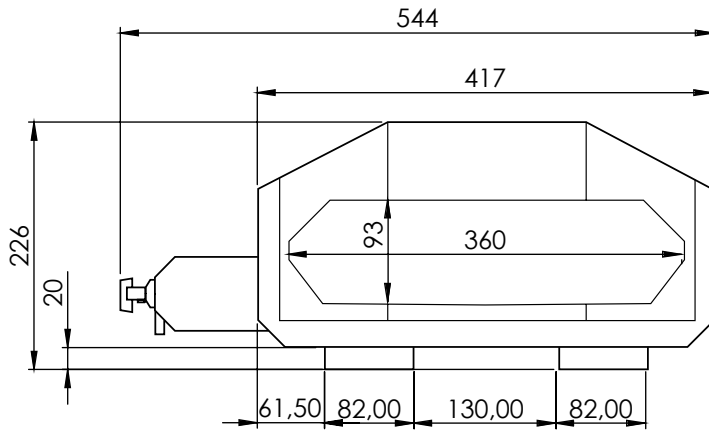

Front view

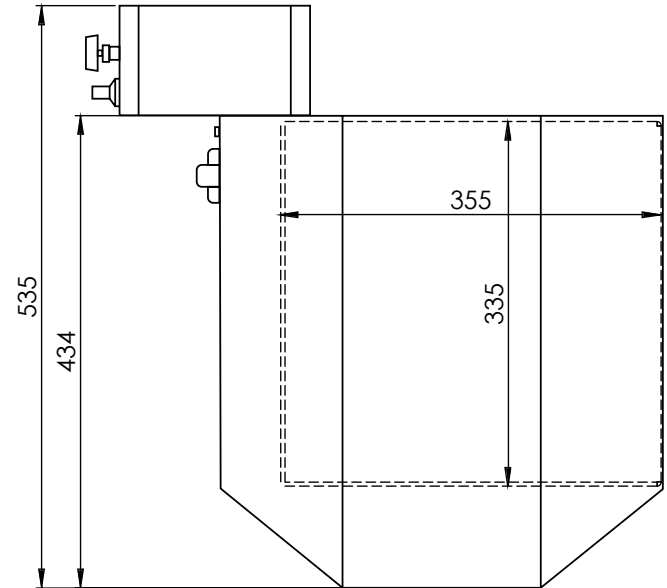

Top view



STAY WITH US!

We love to see what you create in our ovens, therefore feel free to tag us when posting your photos with **#glowen #glowenoven**

Follow us on our social networks



If you have any questions or comments, email us at **info@glowen.si**

www.glowen.si

