

46111100XXXX

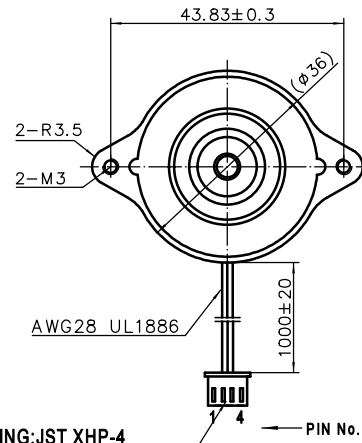
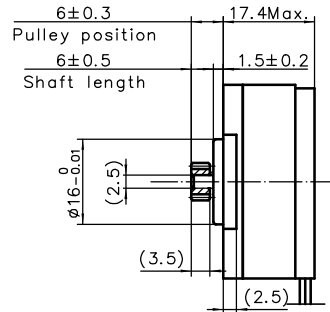
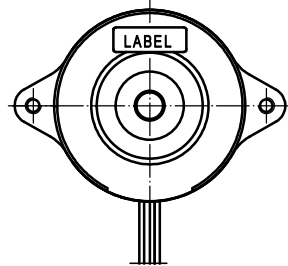

HOUSING:JST XHP-4
TERMINAL:JST SXH-002T-P0.6

接线图

Wiring Diagram

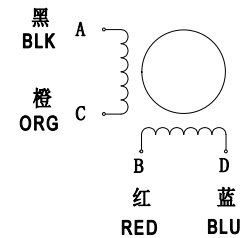

Pin No. vs. Lead Wire Colour

PIN No.	颜色 Colour
1	蓝 BLU
2	红 RED
3	橙 ORG
4	黑 BLK

励磁顺序 vs. 旋转方向

Exciting Sequence vs. Direction of Rotation

STEP	A	B	C	D	
1	+	+	-	-	CW ↑
2	-	+	+	-	
3	-	-	+	+	
4	+	-	-	+	

从安装面看为顺时针方向

Clockwise view from mounting side

规格 Specifications

1. 相数 Number of Phase	2
2. 步距角 Step Angle	1.8°
3. 额定电压 Rated Voltage	1.9V DC
4. 额定电流 Rated Current	1A
5. 保持力矩 Holding Torque	100mNm Typ. (Two phases on rated current)
6. 相电阻 Phase Resistance	1.9Ω ±10% (20°C)
7. 相电感 Phase Inductance	1.41mH±20% (1kHz 1V rms)
8. 转子惯量 Rotor Inertia	9gcm ²
9. 电机重量 Motor Weight	85g
10. 绝缘等级 Insulation Class	B(130°C)

齿轮规格 Gear Specification

齿型 Profile	渐开线 Involute
模数 Module	m=0.5
齿数 Number of Teeth	Z=10
压力角 Pressure Angle	a=20°
齿顶圆直径 Outside DIA	da=6
分度圆直径 Pitch DIA	d=5
材料 Material	SUS303

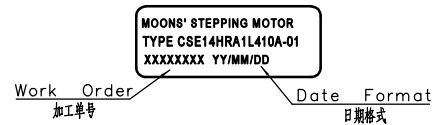

Unit: mm

第一角画法
FIRST ANGLE METHOD

未注线性与角度尺寸公差
Tolerances for linear and angular dimensions without individual tolerance indications

GB/T 1804-m eqv ISO 2768-1 : m

未注形状与位置尺寸公差
Geometrical tolerance for features without individual tolerance indications

GB/T 1184-K eqv ISO 2768-2 : K

批准 Approve

标准化 Standard

工艺 Technology

审核 Check

设计 Design

施赛赛

2021.5.17

MOONS'

Hybrid Stepping Motor

Shanghai Moons' Electric Co., Ltd.

This document is released for information only. Its reproduction in whole or in part or its dissemination to third parties is prohibited. All trademarks and registered trademarks appearing on this document are the property of their respective owners.

REV.	版本记录 REVISION RECORD	DATE	UNLESS OTHERWISE SPECIFIED	NAMES	SIGNATURE	DATE	Type: CSE14HRA1L410A-01	Rev.A0	SCALE 1:1	Sheet 1 of 1
------	----------------------	------	----------------------------	-------	-----------	------	-------------------------	--------	-----------	--------------