



WPT45

Walkie Pallet Truck

LOW COST MOTORIZED PALLET TRUCK, IDEAL FOR CROWDED LOADING DOCKS, WORK CELLS AND CONGESTED AISLES.

CAPACITY

2000kg

BATTERY

Compartment: 670mm x 231mm x open
Anderson 175 Gray—A-11 Minimum

SPEED

Variable 0 to 5.6 km/h empty
Variable 0 to 5.5 km/h loaded

WEIGHT

304 kg Chassis Only

TIRES

DRIVE

230x75 polyurethane

LOAD

85x70 / 83x115 polyurethane

TILLER ARM CONTROLS

Travel, lift, and lower functions are located in the ergonomic operator handle. All operator controls are accessible without having to lift the hand from the handle.

Angle grips are designed to allow easy operation with either hand. Wrap around guard, reversing switch, thumb control, and horn are standard. Low mounted tiller arm offers excellent operator comfort and minimum steering effort. Gas assisted spring handle gently returns handle to vertical position.

Crawl speed function with steer handle at 5° back-tilt from vertical allows for ease of use in tight areas.

ELECTRICAL

24-Volt ZAPI travel controller with matching drive motor provide high performance throughout the entire speed range. Travel speed remains constant relative to throttle position regardless of load -neutral braking. Separately fused power control circuits, quick disconnect EPD power cut off, hour meter / battery discharge indicator combination gauge and lift lock-out complete the system.



Power configurations and diagnostic features are displayed with a ZAPI handheld console.

HYDRAULICS

Lift cylinder has hard chrome plated rods. Pump unit including motor, solenoid, gear pump, and pressure compensated lowering valve are mounted high in the power compartment for ease of service.

DRIVE UNIT

Vertically mounted drive motor is direct mounted to gear housing. Oil bathed bevel gear drive train with tapered roller bearings transfers power to axle. State of the art optimized gear technology supplies advantages such as minimal envelope circle, zero maintenance, low noise level, high efficiency and high performance.

Electromagnetic brake is mounted on motor armature shaft multiplying the braking power through the transmission. Brake is applied when control arm is in the vertical or horizontal handle position. System features anti-roll back and neutral braking.

FORK ASSEMBLY

Boxed rail fork construction with pallet entry slide allows easy pallet entry by lifting the fork up and over bottom board.

Eight easily accessed grease zerks for ease of maintenance.

ACCESSIBILITY

Removal of two piece power head cover exposes major components for inspection and maintenance.

OPTIONAL EQUIPMENT

- Cold Conditioning
- Rubber Lug Drive Tire
- Poly Traction Tire
- Fork Entry Rollers
- Load Back Rest - 1220mm
- Stability Casters
- 210AH Lithium battery 100A charger
- 206mm Battery Compartment

Model - WPT45S only available with 685mm x 1220mm fork dimension



**OUR METER BDI
AND KEY STANDARD**

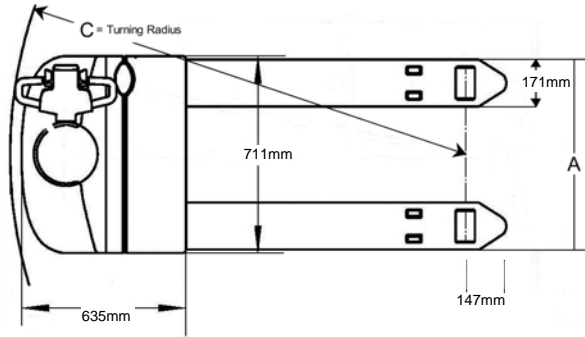

ERGONOMIC OPERATOR'S HANDLE

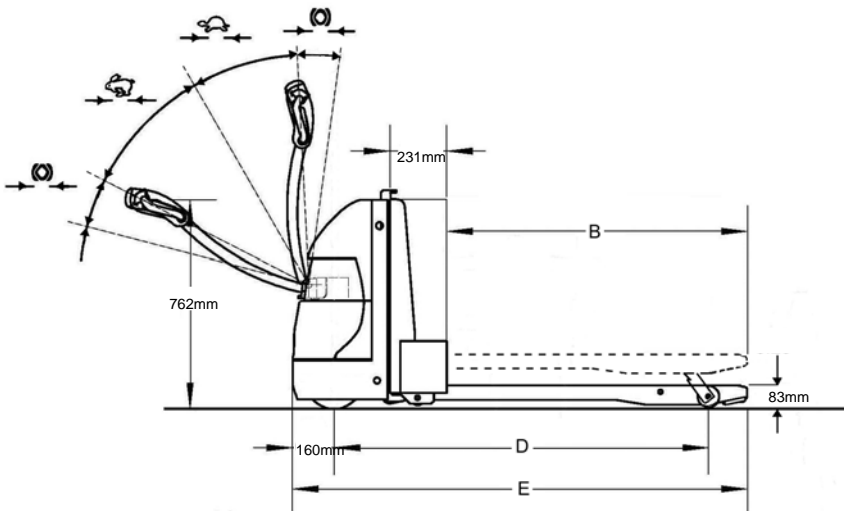

Gradeability	
Without Load	10%
With Load.....	6%
Travel - Variable	
Empty:	0 to 5.6 km/h
Loaded:	0 to 5.5 km/h
Forks	
Lowered Height:	83mm
Extended Height:	203mm
Note: WPT45 560mm wide fork units include stability casters as standard equipment	

Truck Model	Forks	Actual Fork Width	Actual Fork Length	Turning Radius	Wheelbase	Overall Length	Weight (kg)
		A	B	C	D	E	
Fork Dimension: 685mm Wide							
WPT 45	685x 915	685	851	1382	1179	1487	397
WPT 45	685x 1220	685	1156	1679	1483	1792	401
Fork Dimension: 560mm Wide							
WPT 45	560x 915	540	851	1367	1179	1485	397
WPT 45	560 x 1220	540	1156	1666	1483	1790	399

Dimensions listed above are based on 231mm battery compartment. Stability casters standard on 559mm wide models ³ Estimated shipping weight without battery