



L15

Sit-Down Counterbalanced



CAPACITY

L-15 1500kg at 600mm load center

PERFORMANCE

48 volt lithium batteries with 150 Ah capacity ZAPI AC travel control.

TRAVEL Speed

9 km/h

LIFT

Up to 0.4m/s empty
Up to 0.3m/s loaded

LOWERING

Up to 0.4m/s empty
Up to 0.4m/s loaded

TIRES

FRONT DRIVE x 2
6.5-10 solid pneumatic
DUAL STEER TIRE
5.00-8 solid pneumatic

OPERATOR COMPARTMENT

Ergonomic roomy cab, wide view mast, hydrostatic power steering with spinner knob, adjustable steering column and adjustable suspension seat ensures comfortable working position. Hydraulic controls: lift/lower, tilt, and load side-shift within easy reach of operator.

Large "wide view" reversing mirror increases operation efficiency. Side hand rail aids operator comfort in reverse driving position.

HYDRAULICS

Powerful hydraulic lift motor provides smooth high torque lifting and lowering. Hydraulic lift and drive components are sealed against dirt and water protecting them from contamination.

ELECTRICAL

AC technology fitted to heavy-duty applications. Electrical current is optimized and AC motors are brushless, which minimizes servicing. "neutral braking" eliminates truck roll-back and allow higher travel speeds. Diagnostic display with thirty performance travel and lift parameters can be adjusted to suit all types of loads, working condition's area and operator driving skill.

On-board charger provides opportunity charging

Due to the usage of Li-Ion technology in combination with an onboard charger, the L15 is the most versatile truck you can find on the market. Plug it into any standard power outlet and the battery will be opportunity charged. No need for any external charging device. Just Plug&Play.

FRAME AND MAST

High stability chassis with long wheel-base, wide tires and low center of gravity. "See Thru" integral side-shift with load back rest (LBR). Wide view mast, low scuttle and high seating position gives the operator an excellent view, reducing load damage and accidents. Fully enclosed chassis weldment house the dual drive motors.

SERVICEABILITY

The state-of-the-art controller can be easily accessed at waist height, reducing service time.

STANDARD EQUIPMENT

- Headlights and Brake Lights
- Yellow Flashing Light
- Solid Pneumatic Tires
- Dual Steer Tire
- Ergonomic Operators Compartment



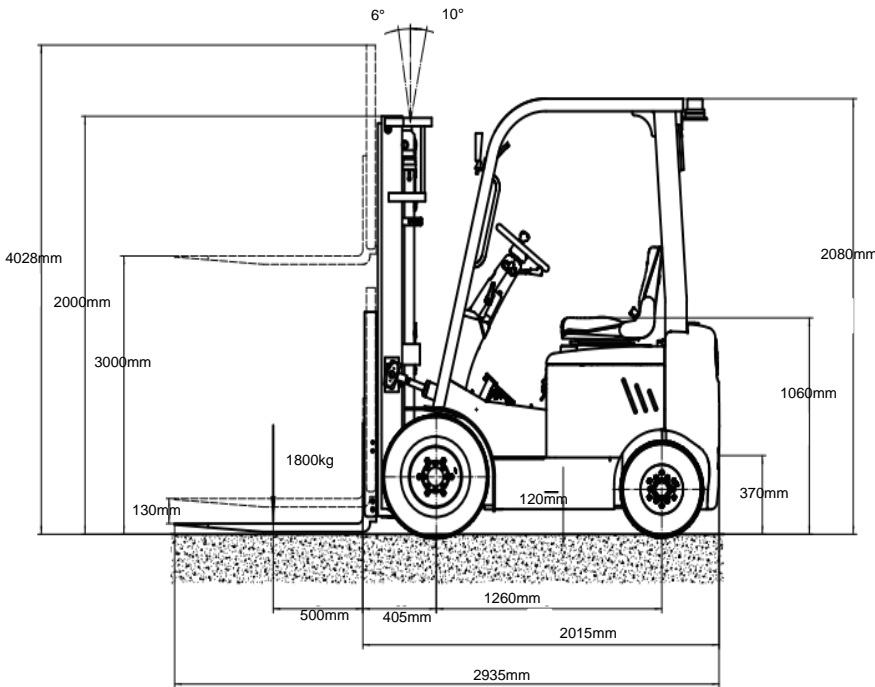

L-15 RATED CAPACITY
 1500kg to 3000mm @ 600mm LC
 1120kg to 4800mm @ 600mm LC

Gradeability: 10.5% Loaded
 14.5% Unloaded

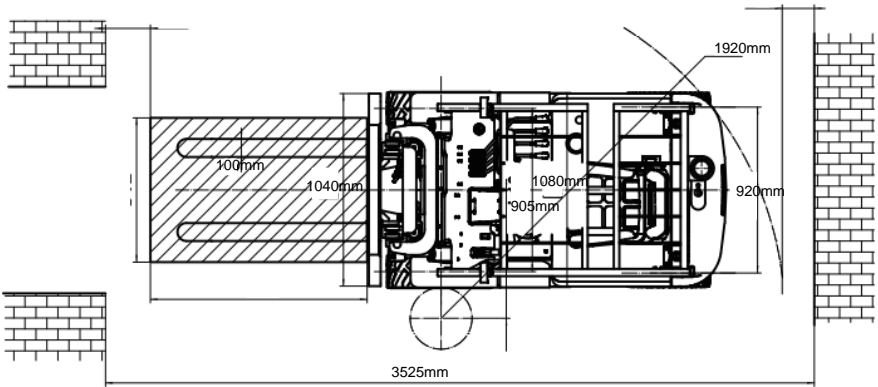

Model #	Mast	Lift Height	Col Height	Free Lift		Extended Height		Weight (kg)
				Without Backrest	With Backrest	Without Backrest	With Backrest	
1500kg Capacity @ 600mm Load Center								
	A	B	C	D				
L15	3000	3000	1995	130	130	3485	4028	3030
L15	4800	4800	2150	1656	1122	5294	5828	3220

³Estimated shipping weight without battery

