



# J2 Joey

## Low Level Order Picker

Patents Pending

### CAPACITY

- 680kg @ 610mm LC on forks
- 136kg operators compartment
- 91kg rear work platform

### BATTERY INFORMATION

Compartment: 739mm x 279mm x 762mm  
Anderson 175 Gray A-22  
Minimum battery weight 318kg

### PERFORMANCE

#### MAXIMUM LIFT HEIGHTS

1219mm operator PLATFORM, 1829mm forks

#### Maximum Speeds

Travel: Variable from 0 to 7.2 km/h

LIFT: Up to 0.2 m/s

### WHEELS / TIRES

- (1) 230 x 75 polyurethane drive tire
- (2) 74 x 48 polyurethane stability casters
- (2) 150 x 90 polyurethane load wheels

### ELECTRICAL

24-Volt travel controller.

LCD dash board displays hour meter, battery state of charge, travel speed, drive wheel directional indicator, and fault codes.

AC drive motor provides high torque throughout the entire drive range. The brushless design of the AC motors drastically reduces maintenance costs while extending duty cycle. Travel speed remains constant relative to throttle position regardless of the load on truck.

(4) selectable travel speed settings and a global turtle travel speed setting can be used to tailor equipment performance to the experience level of the operator and use.

### MAST

Heavy duty I-beam design provides operator with excellent stability at height. Steel mast channels and side mounted lift cylinders increase total vehicle capacity and service life.

### CHASSIS

Three point chassis design with along with 180° drive motor steering arc provides exceptional maneuverability. Powerhead mounted stability casters add additional truck stability and operator confidence at working heights.

### OPERATOR COMPARTMENT

Ergonomic fingertip control for travel, lift, and lower functions provide the operator with logical intuitive drive characteristics while traveling at elevation or lowered.

The operator compartment is designed for comfort and features an ergonomic floormat and features a forward and backrest cushion. Retractable compartment side-rails allow for easy egress from either side of the vehicle.

### REGENERATIVE BRAKES

Regenerative braking is applied when the operator removes their hand from travel control or when plugging occurs. An electromagnetic parking brake is applied after the truck is stopped.

### STANDARD FEATURES

- 915 mm long forks
- Non-marking tires
- Rear flashing light
- Battery compartment rollers
- Hydraulic front mini mast with independent controls
- Low 229mm step height compartment

### OPTIONAL EQUIPMENT

- 12 volt accessory power supply
- 224 AH Maintenance Free Battery Pack w/240V Plug-In
- 24 volt Industrial battery
- 24 volt external charger
- Forward controls with no side rails
- Walk along order picking controls

### STANDARD OPERATOR CONTROLS

Left Hand

Right Hand



360°

Tiller Steering



Travel, Lift, Lower, Key Switch and EPD Controls

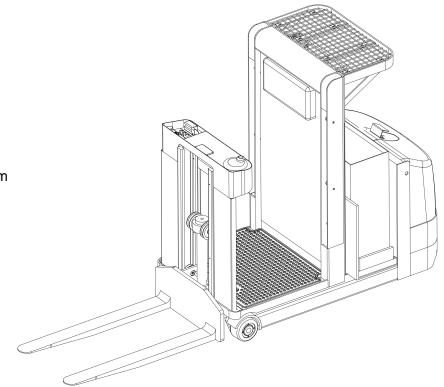
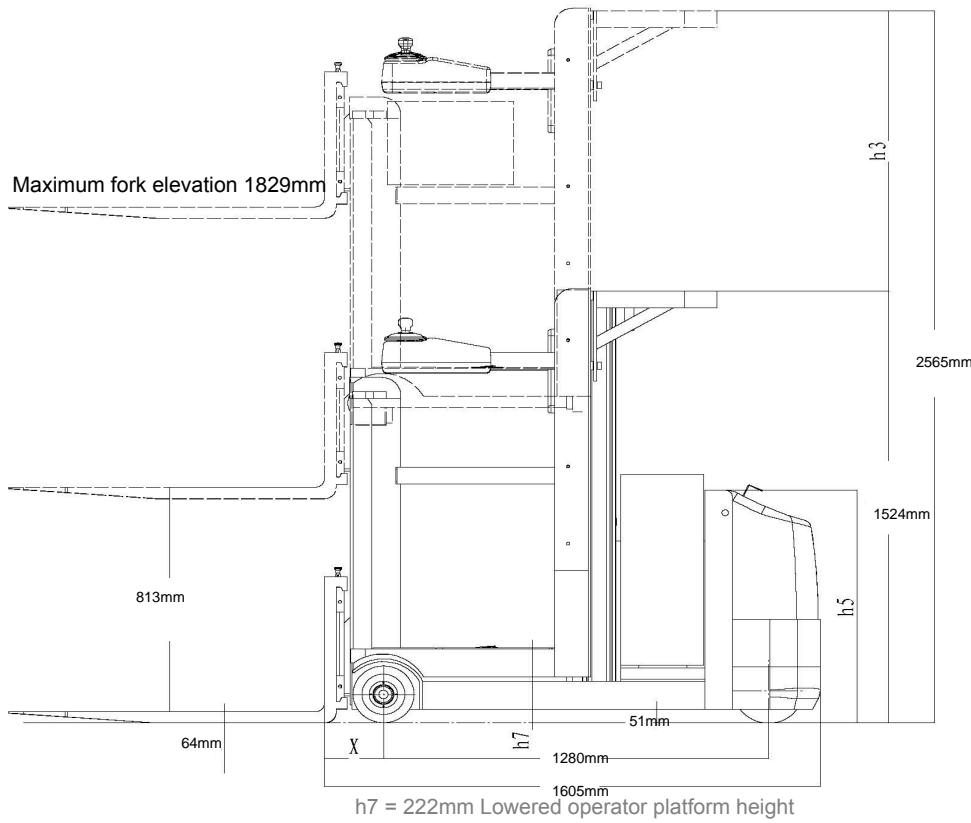

J2 -72 shown with optional front operator controls

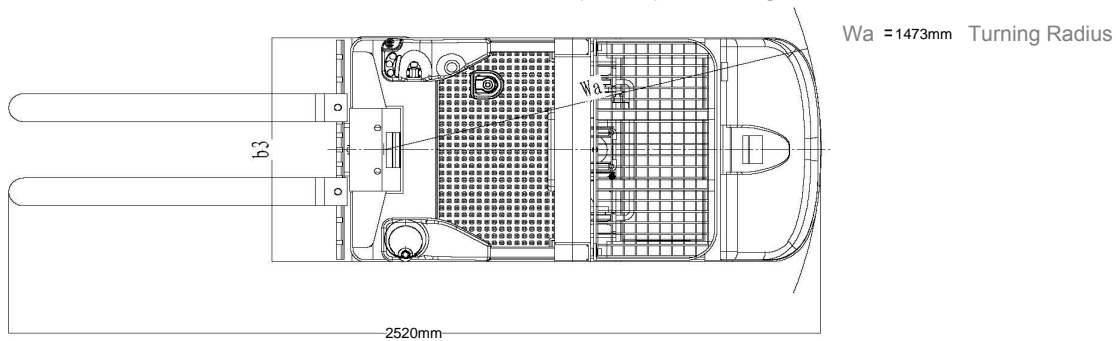

Model #	Mast	Lift Height	Col Height	Extended Height	Overall Width	Overall Length	<sup>3</sup> Weight Chassis Only
		h2+h3	h1	h4	b3 / b1	L1	

All measurements in standard "millimeter" units, for additional specifications or performance details consult factory

J2-72	Single Stage	1829	1524	2565	800	2520	1315kg
-------	--------------	------	------	------	-----	------	--------

<sup>3</sup> Estimated shipping weight without battery