

# RENNWAGEN

## REAR SPATS [VW (MK7) GTI]

### INSTALLATION INSTRUCTIONS:

#### INCLUDED IN YOUR KIT:

QTY	DESCRIPTION
2	Rennwagen Rear Spats
8	Stainless Steel Screws
8	Stainless Steel Washers

#### THE FOLLOWING TOOLS WILL BE NEEDED:

- Phillips Head Screwdriver
- 1/8" Drill Bit
- Drill
- Marker or Pen

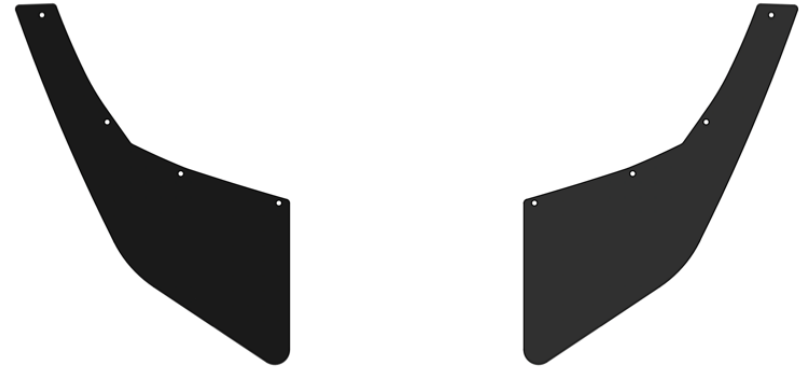

#### BEFORE YOU BEGIN:

- Read through the installation instructions entirely prior to installing this product.
- Check to make sure nothing is missing from your order.
- Do NOT use power tools on hardware!
- Do NOT overtighten hardware!

**NOTE:** Professional installation is recommended. Rennwagen, LLC is not responsible for damage to you or your vehicle while installing Rennwagen products.

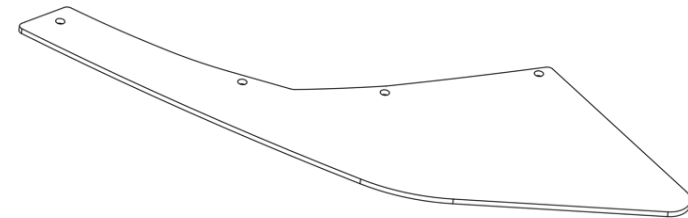

RELEASE DATE: 1/22/2022

## **STEP 1 - CLEAN**

Clean the OEM rear valance on your car and ensure it is free of any dirt or road grime.

## **STEP 2 - TEST FIT**

Line up and test fit the Rear Spats with the OEM valance. There is a small plastic lip on the OEM valance that the Rear Spat will locate against.

## **STEP 3 - MARK HOLE LOCATIONS**

Starting on one side, hold the Rear Spat in place and use a Marker or Pen to mark the hole centers on the OEM valance. Repeat this step for the opposite side.

✓ You can use a strip of masking tape to avoid marking on your OEM valance if you wish.

## **STEP 4 - DRILL MOUNTING HOLES**

Remove the Rear Spats and set them aside. Using a Drill and an 1/8" Drill bit, drill a pilot hole at the CENTER of each of your marked holes. (It is critical that the hole is centered).

✓ If your car is lowered, you may need to lift your car up in order to fit your drill underneath the OEM valance.

## **STEP 5 - MOUNT REAR SPATS**

Starting on one side of the car, hold the Rear Spat in place and verify that the holes you just drilled line up with the holes in the Rear Spat. Then, using a Phillips Head Screwdriver, thread the supplied Stainless Steel Screws into the holes that you drilled in the previous step. Make sure you use a Washer between the Rear Spat and each Screw.



**DRILLED MOUNTING HOLES**



**MOUNTED WITH SCREWS AND WASHERS**



**REAR SPAT INSTALLED**

**YOU'RE ALL SET! ENJOY YOUR NEW RENNWAGEN REAR SPATS! TAKE SOME PICS, TAG AND FOLLOW US ON INSTAGRAM @RENNWAGEN\_USA!**