

11/28/2017

## **COMFORT SLEEPER (Ver.8)**

### **DISASSEMBLY & REASSEMBLY INSTRUCTIONS**

The logo for American Leather, featuring a large, stylized white letter 'A' on the left, followed by the words 'AMERICAN LEATHER' in a smaller, white, all-caps sans-serif font. A registered trademark symbol (®) is located at the end of the word 'LEATHER'. The entire logo is set against a solid black rectangular background.

**A AMERICAN LEATHER®**

## DISASSEMBLY



Tools: 1/2" & 7/16" sockets, 7/16" wrench, wood block 5" tall, or mallet plus wood block = 5" (Impact driver optional)

High Leg Sleeper with "Ear" that extends over the arm



Open bed as shown



Tilt sofa forward onto its Front Arms

Low Leg Sleeper without "Ear"

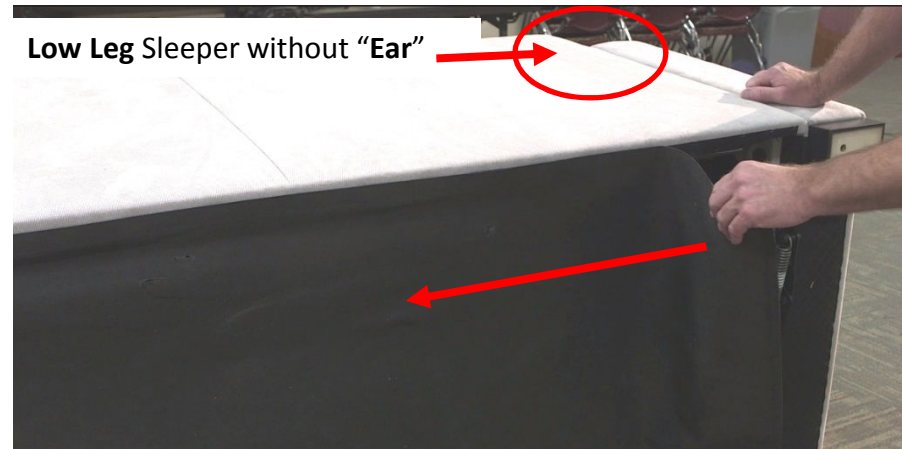

Unhook Velcro holding Dust Cover to back edge of sofa  
(Low leg sleepers only)

## DISASSEMBLY

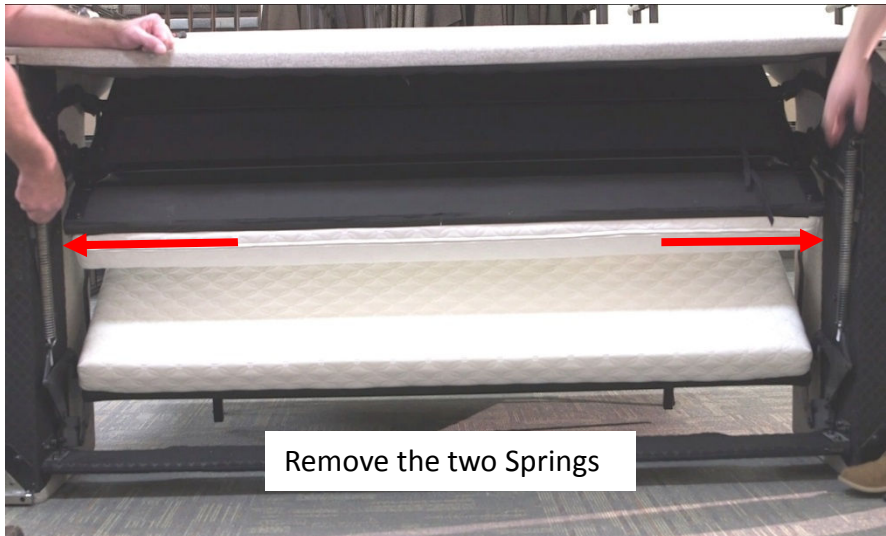
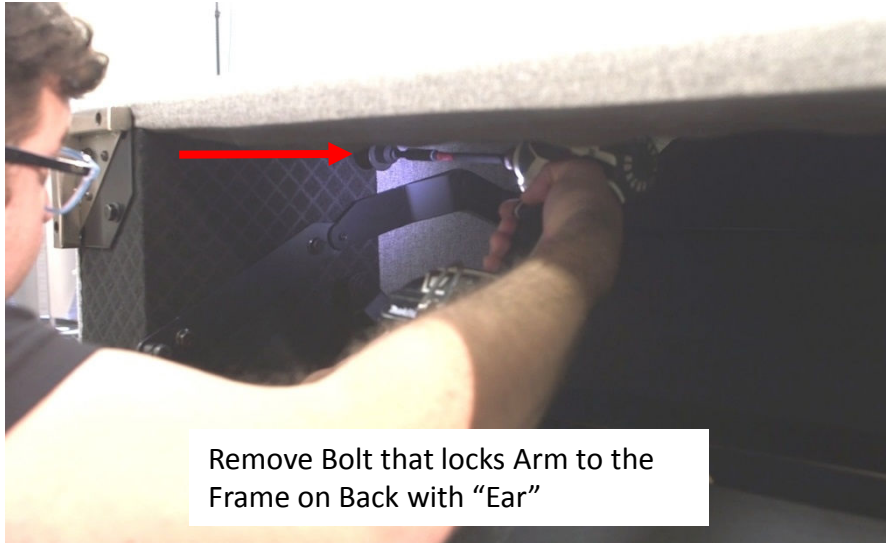

Place a 5" Block under the Back, near the Arm, and press down on the top of the Arm as shown to release the Back from the Arm on both sides of the sofa

## DISASSEMBLY

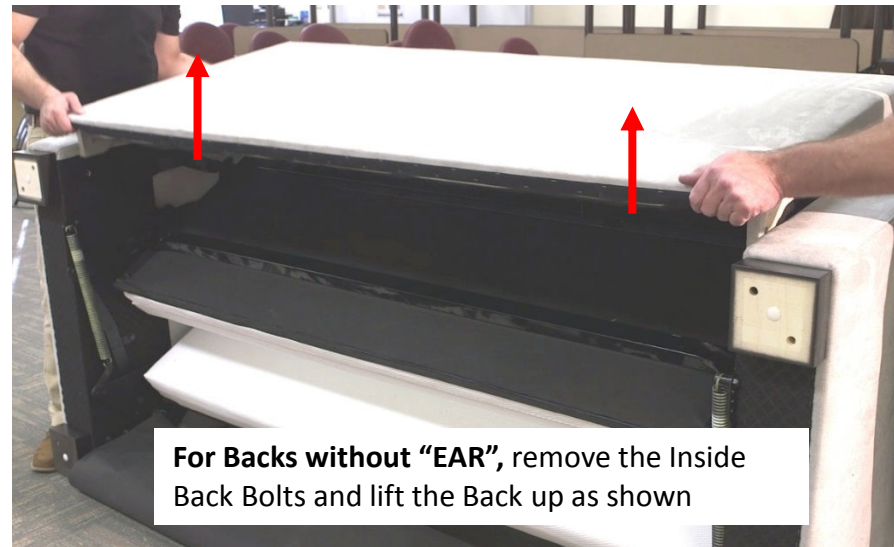

## DISASSEMBLY



Return the sofa back onto its legs.  
Remove Two Bolts from each side of the Middle  
Mattress Section.

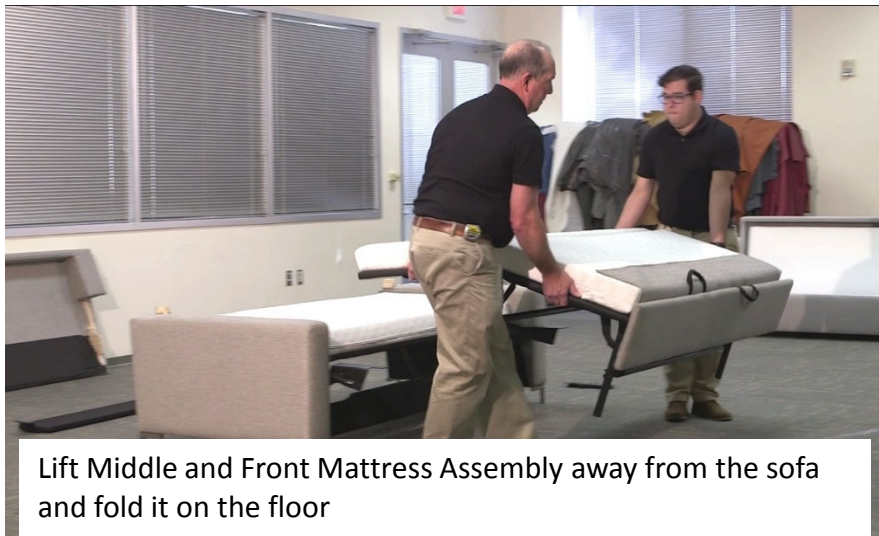
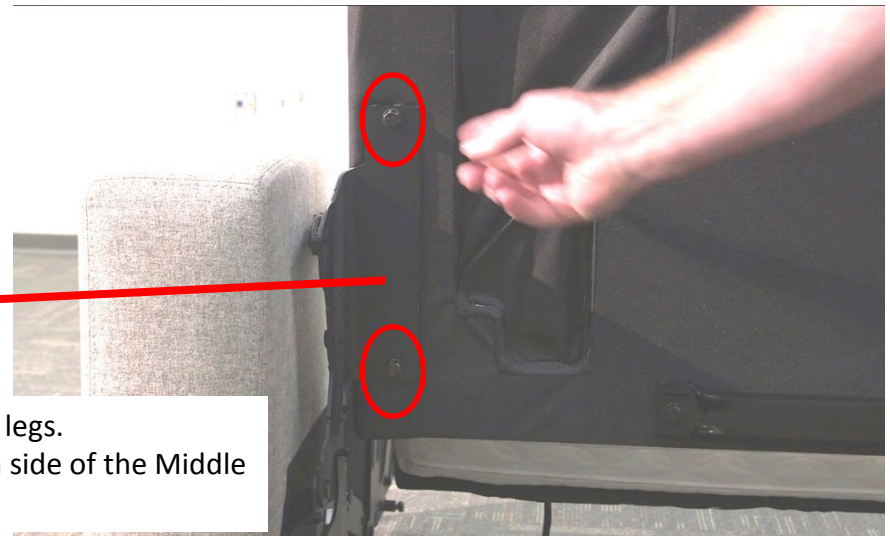

Lift Middle and Front Mattress Assembly away from the sofa  
and fold it on the floor



Close the Mechanism from both sides

## DISASSEMBLY

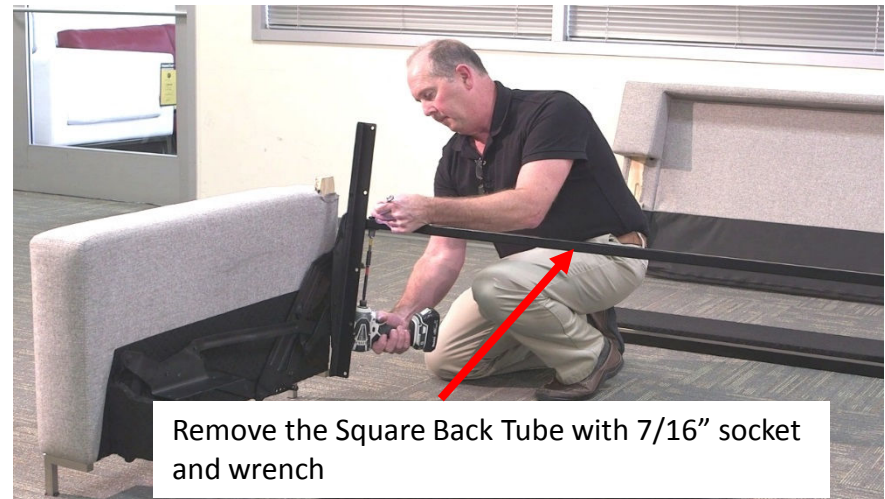
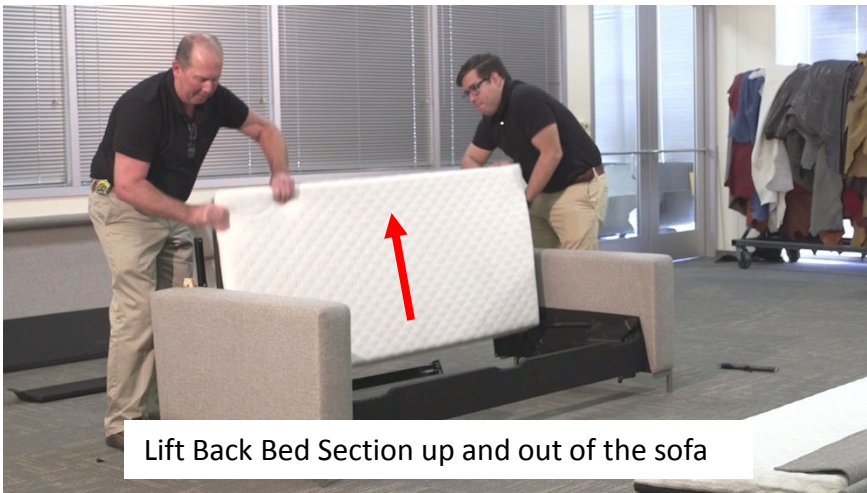
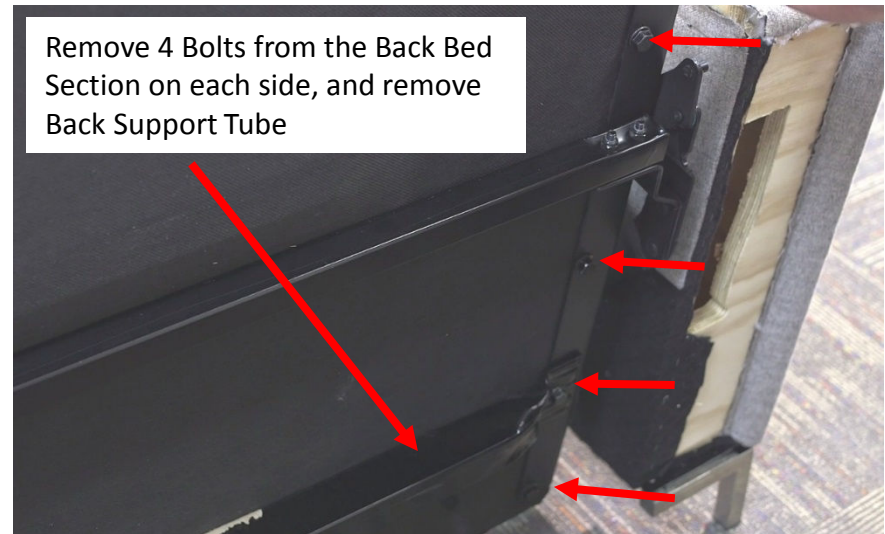
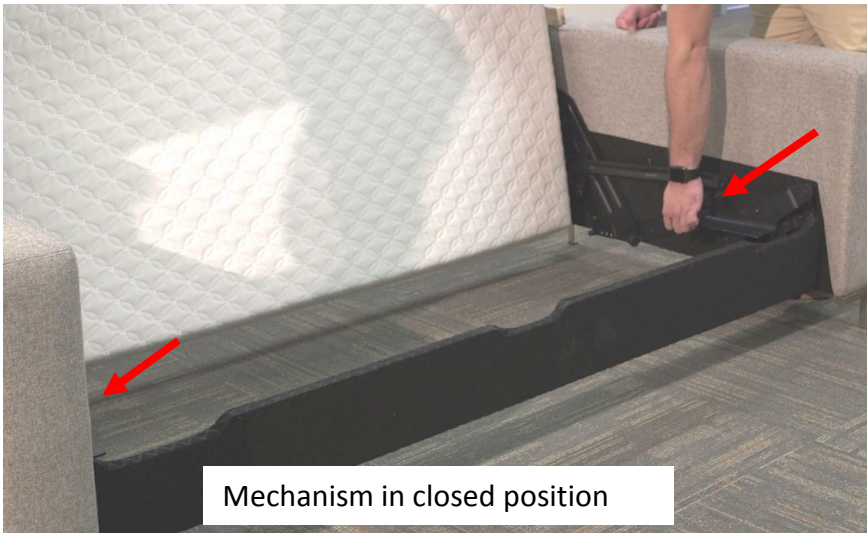

## DISASSEMBLY

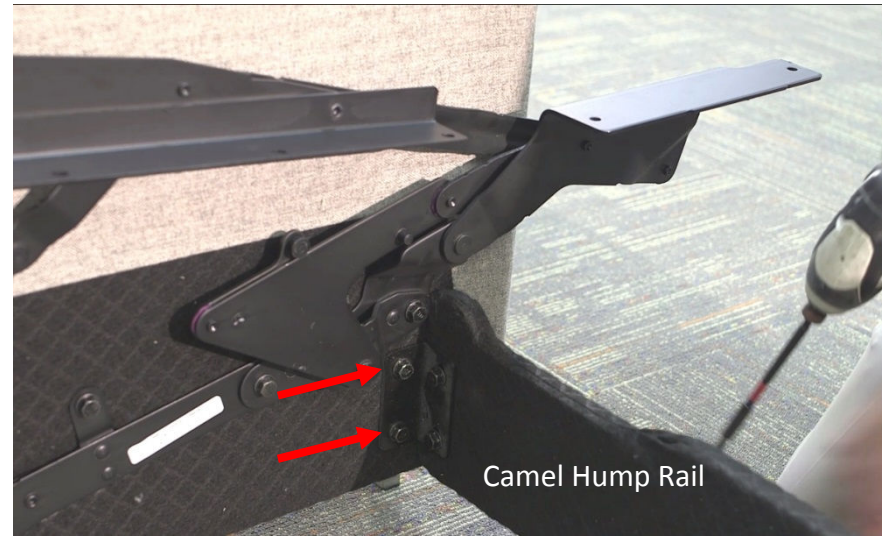
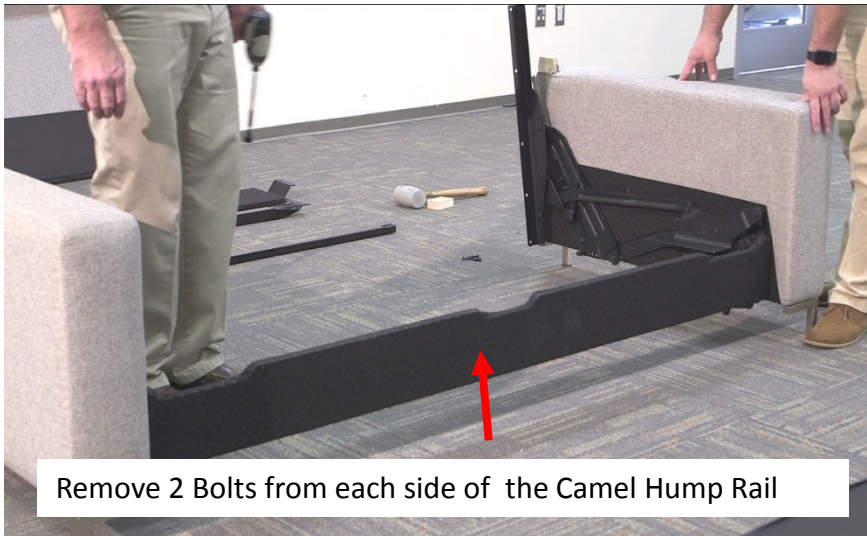

## RESASSEMBLY



Install 2 Bolts on each side of the Camel Hump Rail

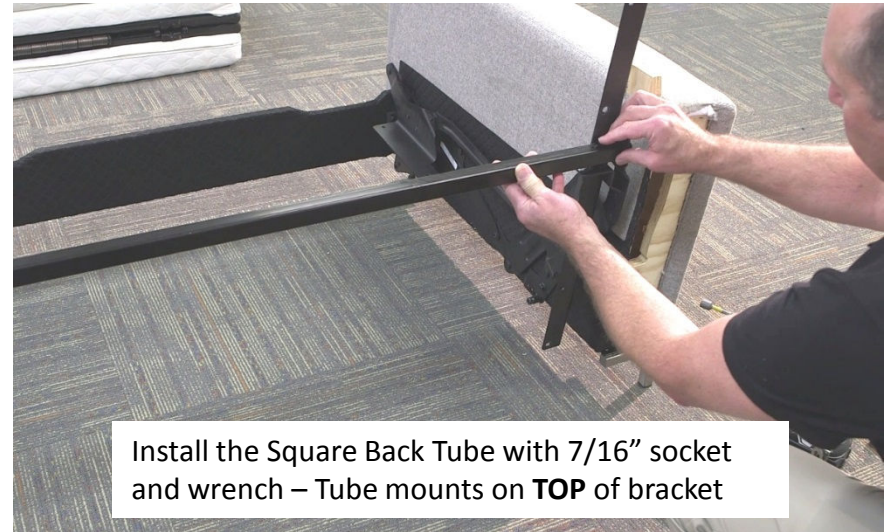

Install the Square Back Tube with 7/16" socket and wrench – Tube mounts on **TOP** of bracket

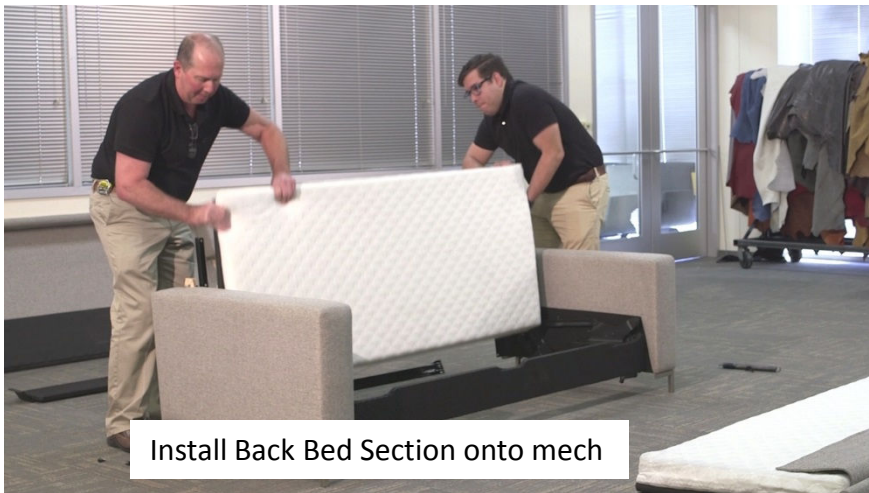

Install Back Bed Section onto mech

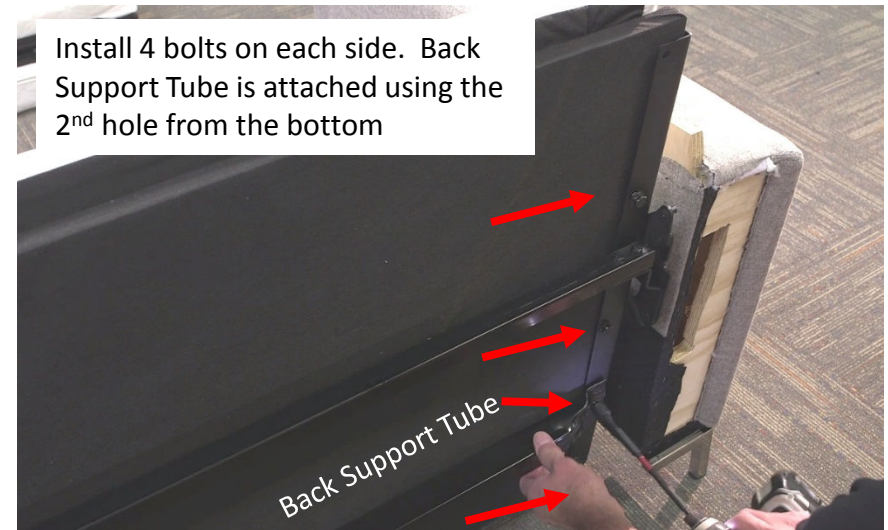

Install 4 bolts on each side. Back Support Tube is attached using the 2<sup>nd</sup> hole from the bottom

Back Support Tube



## RESASSEMBLY



Open the Mech and Place Middle and Front Mattress Assembly onto Mech Brackets



Install 2 Bolts through the Bracket on each side

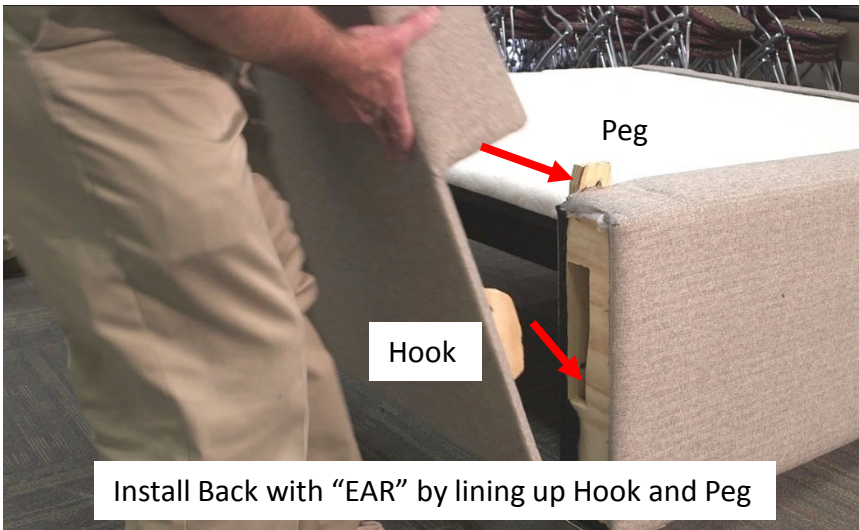

Install Back with "EAR" by lining up Hook and Peg

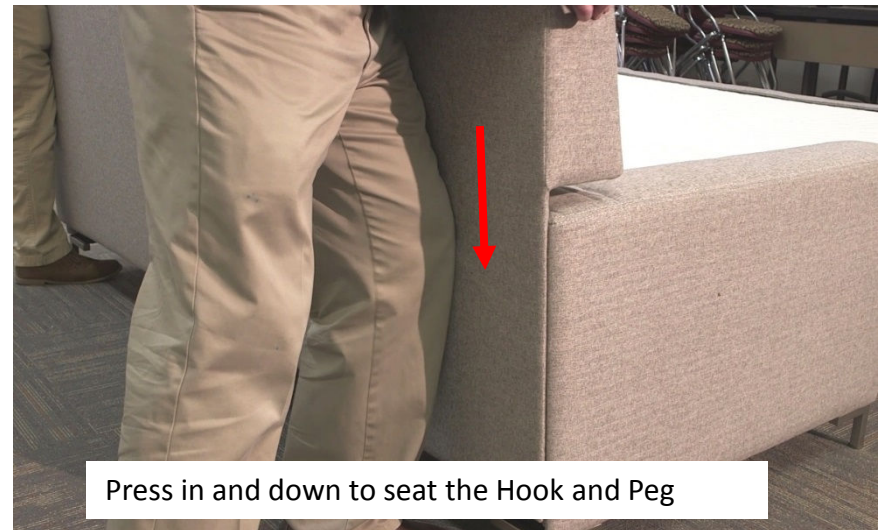

Press in and down to seat the Hook and Peg

## RESASSEMBLY

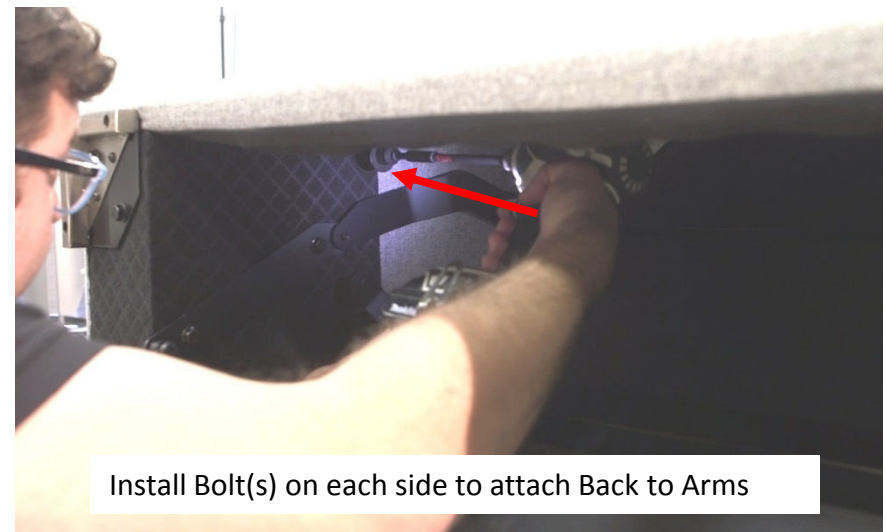
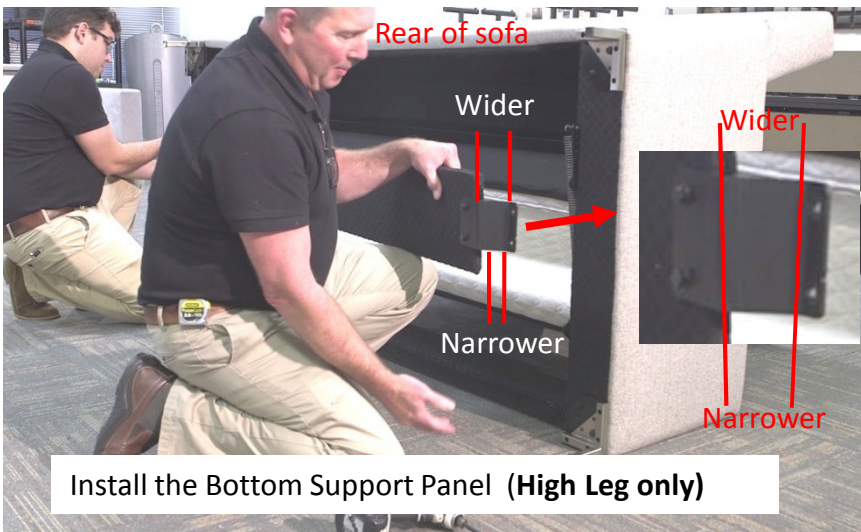

## RESASSEMBLY



Roll the assembled Sleeper to the upright position as shown. Close and open the sleeper to test it.