

## LIMITED WARRANTY

The Little Tikes Company makes fun, high quality toys. We warrant to the original purchaser that this product is free of defects in materials or workmanship for one year \* from the date of purchase (dated sales receipt is required for proof of purchase). At the sole election of The Little Tikes Company, the only remedies available under this warranty will be the replacement of the defective part or replacement of the product. This warranty is valid only if the product has been assembled and maintained per the instructions. This warranty does not cover abuse, accident, cosmetic issues such as fading or scratches from normal wear, or any other cause not arising from defects in material and workmanship. \*The warranty period is three (3) months for daycare or commercial purchasers. **U.S.A and Canada:** For warranty service or replacement part information, please visit our website at [www.littletikes.com](http://www.littletikes.com), call 1-800-321-0183 or write to: Consumer Service, The Little Tikes Company, 2180 Barlow Road, Hudson OH 44236, U.S.A. Some replacement parts may be available for purchase after warranty expires—contact us for details. **Outside U.S.A and Canada:** Contact place of purchase for warranty service. This warranty gives you specific legal rights, and you may also have other rights, which vary from country/state to country/state. Some countries/states do not allow the exclusion or limitation of incidental or consequential damages, so the above limitation or exclusion may not apply to you.



'Let's care for the environment!'

The wheelie bin symbol indicates that the product and its batteries must not be disposed of with other household waste. Please use designated collection points or recycling facilities when disposing of the item.

Please keep this manual as it contains important information.  
Illustrations are for reference only. Styles may vary from actual contents.

© The Little Tikes Company, an MGA Entertainment company. LITTLE TIKES® is a trademark of Little Tikes in the U.S. and other countries. All logos, names, characters, likenesses, images, slogans, and packaging appearance are the property of Little Tikes.

Printed in China

### US/CA - Little Tikes Consumer Service

2180 Barlow Road, Hudson, Ohio 44236 U.S.A.

Phone: 1-800-321-0183

E-mail: [service@littletikescare.com](mailto:service@littletikescare.com)

### UK - MGA Entertainment UK Ltd.

50 Presley Way, Crownhill, Milton Keynes, MK8 0ES, Bucks, UK.

Little Tikes Consumer Services

P.O. Box 2040 Hockley, Essex, S55 4BF

Phone: 0 800 521 558

E-mail: [support@littletikesstore.co.uk](mailto:support@littletikesstore.co.uk)

### EU - MGA Entertainment (Netherlands) B.V. Baronie 68-70,

2404XG, Alphen a/d Rijn, The Netherlands

Tel: +31-172-758-010

Email: [klantenservice@mgae.com](mailto:klantenservice@mgae.com)

### AU/NZ - Imported by MGA Entertainment Australia Pty Ltd.

Suite 5.05, 32 Delhi Road,

Macquarie Park NSW 2113. AU.

Tel: 1 300 059 676

Email: [au-sales@mgae.com](mailto:au-sales@mgae.com)



0323-0-E/INT



[www.littletikes.com](http://www.littletikes.com)  
[www.littletikes.co.uk](http://www.littletikes.co.uk)  
[www.littletikes.com.au](http://www.littletikes.com.au)



# MINING TRUCK

SKU: 663284  
AGES 3+ YEARS

ADULT SUPERVISION RECOMMENDED  
ADULT ASSEMBLY AND BATTERY INSTALLATION REQUIRED

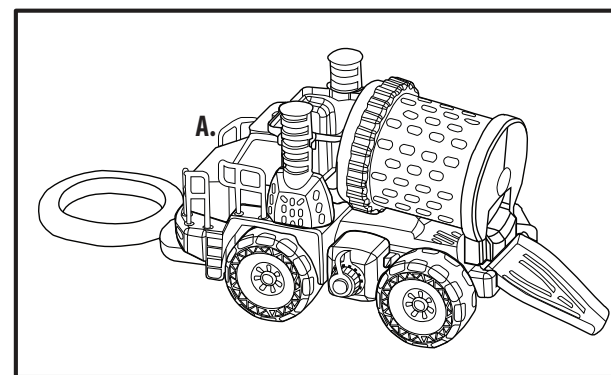

## CONTENTS

- A. 1 Mining Truck
- B. 2 Shovels
- C. 1 Metal Detector
- D. 1 Water Tank

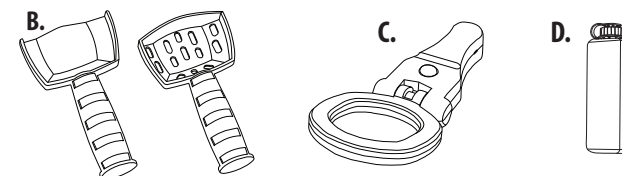

## BATTERY INSTALLATION

**Battery installation must be completed by an adult.**

### To install batteries:

1. Turn the metal detector over and locate the battery door.
2. Using a Phillips screwdriver (not included) remove the screws and battery compartment cover.
3. Install one (1) 9V alkaline battery (not included) making sure the (+) and (-) ends face the proper direction as indicated inside the battery compartment (illus. 2).
4. Replace the compartment cover and tighten the screw.

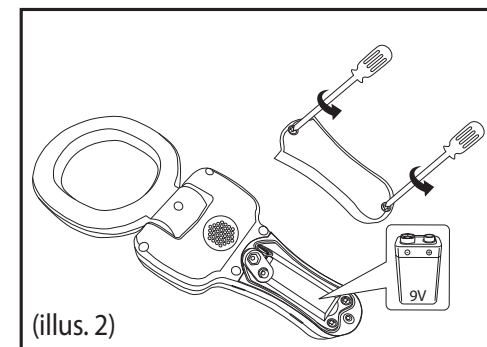

## Many Ways to Play!

### 1. SEARCH FOR TREASURE!

Detach the metal detector from the front of the mining truck to use on the go!

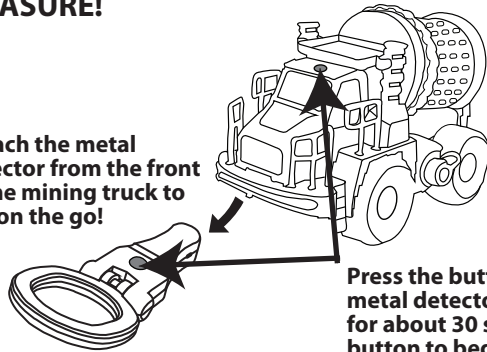

Press the button to activate the metal detector; it will be active for about 30 seconds. Press the button to begin again. Press the button to turn off the detector.

### 2. DIG DEEPER!

Use the shovels to dig and scoop up findings beneath dirt and sand!

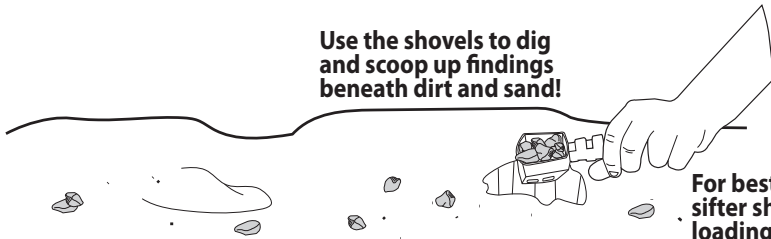

For best results use sifter shovel when loading hopper.

### 3. WASH AND DISCOVER!

Pour water into the top opening of the truck to clean your findings!

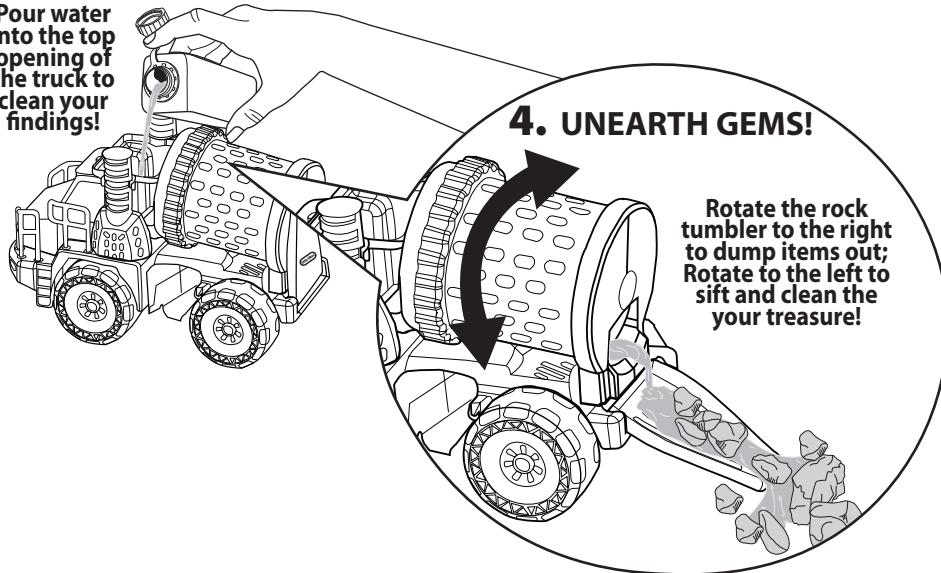

### 4. UNEARTH GEMS!

Rotate the rock tumbler to the right to dump items out; Rotate to the left to sift and clean your treasure!

## **! WARNING:**

- CHOKING HAZARD - Small parts may be released. Not for children under 3 years.

## IMPORTANT INFORMATION

- BATTERY INSTALLATION REQUIRED.
- Only dig with an adult's permission.
- Only use the shovels with sand or soft dirt. Avoid areas where there are large rocks, broken glass or other harmful objects.
- Always empty the rock tumbler when you are done playing.
- This toy can be cleaned with a damp (not wet) cloth, please ensure that no moisture enters the electronics or battery compartment.
- Do not submerge the metal detector in water.

## BATTERY SAFETY INFORMATION

- Use only size "9V" alkaline battery (1 required).
- Insert batteries with the correct polarity (+ and -).
- Charging of rechargeable batteries should only be done under adult supervision.
- Always remove exhausted or dead batteries from the product.
- Dispose of dead batteries properly: do not burn or bury them.
- Do not attempt to recharge non-rechargeable batteries.
- Do not short-circuit the supply terminals.
- Remove battery before placing the unit into storage for a prolonged period of time.

## FCC COMPLIANCE

NOTE: This equipment has been tested and found to comply with the limits for a Class B digital device, pursuant to Part 15 of the FCC Rules. These limits are designed to provide reasonable protection against harmful interference in a residential installation. This equipment generates, uses and can radiate radio frequency energy and, if not installed and used in accordance with the instructions, may cause harmful interference to radio communications. However, there is no guarantee that interference will not occur in a particular installation. If this equipment does cause harmful interference to radio or television reception, which can be determined by turning the equipment off and on, the user is encouraged to try to correct the interference by one or more of the following measures:

- Reorient or relocate the receiving antenna.
- Increase the separation between the equipment and receiver.
- Connect the equipment into an outlet on a circuit different from that to which the receiver is connected.
- Consult the dealer or an experienced radio/TV technician for help.

This device complies with Part 15 of the FCC Rules. Operation is subject to the following two conditions: (1) This device may not cause harmful interference, and (2) this device must accept any interference received, including interference that may cause undesired operation.

Caution: Modifications not authorized by the manufacturer may void users authority to operate this device.

CAN ICES-3 (B) / NMB-3 (B).