



Cozy Train Scoot™

1-5
Years

SKU: 660962C3

ADULT ASSEMBLY REQUIRED

ASSEMBLY INSTRUCTIONS

FOR ASSEMBLY VIDEO:

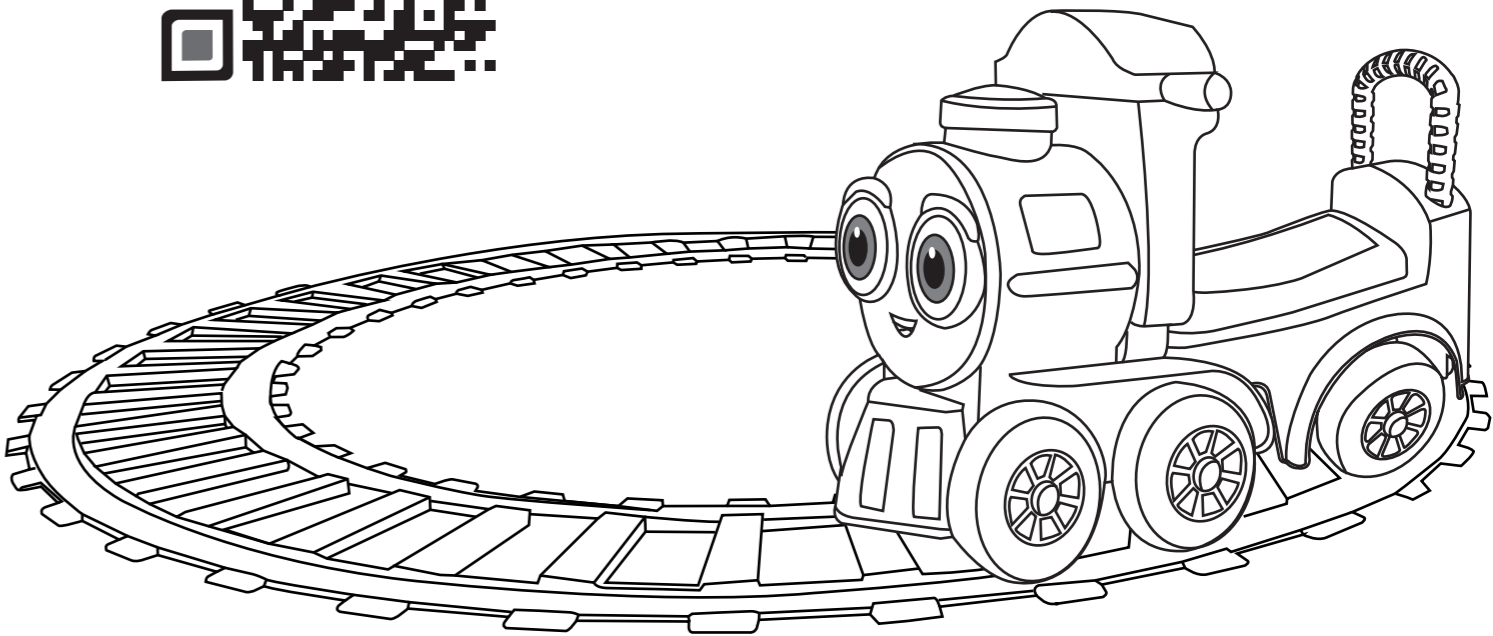

Thank you for choosing the Little Tikes® Cozy Train Scoot™.
We strive to provide a durable, easy-to-assemble toy that is made to last,
giving your child years of imaginative, engaging fun!



PLEASE READ INSTRUCTIONS
BEFORE ASSEMBLING AND OPERATING.

Please save sales receipt for proof of purchase.

⚠ WARNING: ADULT ASSEMBLY REQUIRED.

- Read entire instructions carefully before assembling this product.
- Keep these instructions for future reference.
- Ensure working area is free of danger. Always dispose of packaging material in such a way that it may not cause any harm. Plastic bags can be dangerous. To avoid suffocation, keep plastic bags away from babies and children.
- To prevent serious injury, children must not use the equipment until completely assembled.
- This product is intended for indoor and outdoor domestic family use only.
- This product is for private, residential use only (no commercial or public use).

ASSEMBLY HINT

Assemble all parts together loosely at first. Check that assembly is correct, then snap parts together.

⚠ WARNING: TO AVOID SERIOUS INJURY:

- Continuous adult supervision required.
- Never use near motor vehicles.
- Never use near streets, swimming pools, hills, steps, or sloped driveways.
- Always wear closed shoes when using the Cozy Train.
- Never allow more than one rider on the Cozy Train.
- Instruct children on proper use of this product before allowing them to ride.
- This product is not to be used in a manner other than for which it is intended.
- It is recommended that rider always wear a properly fitted helmet that complies with U. S. Consumer Product Safety Commission (CPSC) standard 16 CFR 1203.
- Ride-on toys should be used with caution since skill is required in order to avoid falls or collisions which may cause injury to the user or third parties.

⚠ WARNING! Not to be used by children over the age of five (5) years due to size limitation.

- Intended for children 1 to 5 years.
- Maximum child's weight: 50 lbs. (23 kg).

MAINTENANCE & CLEANING

- Check all hardware during usage period and tighten as required. It is particularly important that this procedure be followed at the beginning of each season. If these checks are not carried out, the toy could overturn or otherwise become a hazard.
- Do not attempt to modify or repair this product. For help contact Little Tikes Consumer Service.
- Clean Cozy Train with a slightly damp cloth (cold water) and mild soap. Never use a corrosive or abrasive substance to clean the product.

DISPOSAL

- Disassemble and dispose of equipment in such a manner that no hazardous conditions, such as but not limited to, small parts and sharp edges, exist at the time equipment is discarded.

5

Place Cozy Train on the Tracks

Place Cozy Train on the tracks by placing the wheels on the rails.

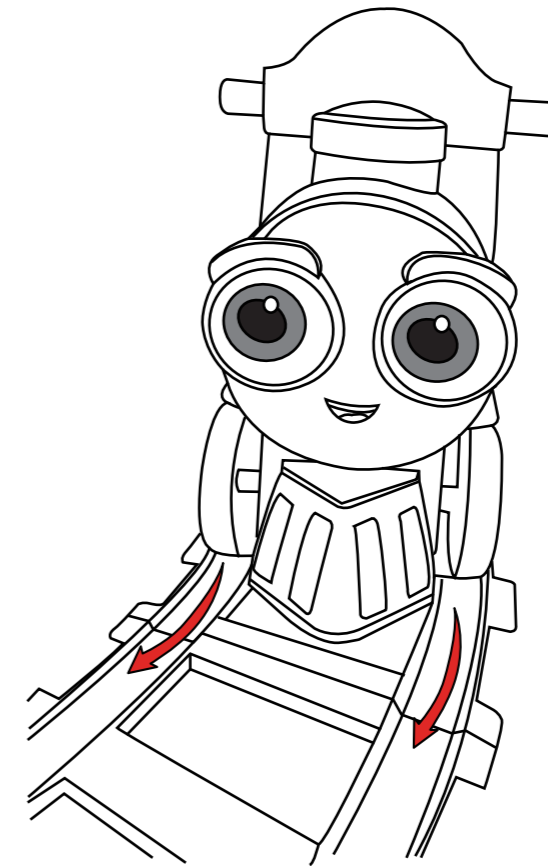

Features!

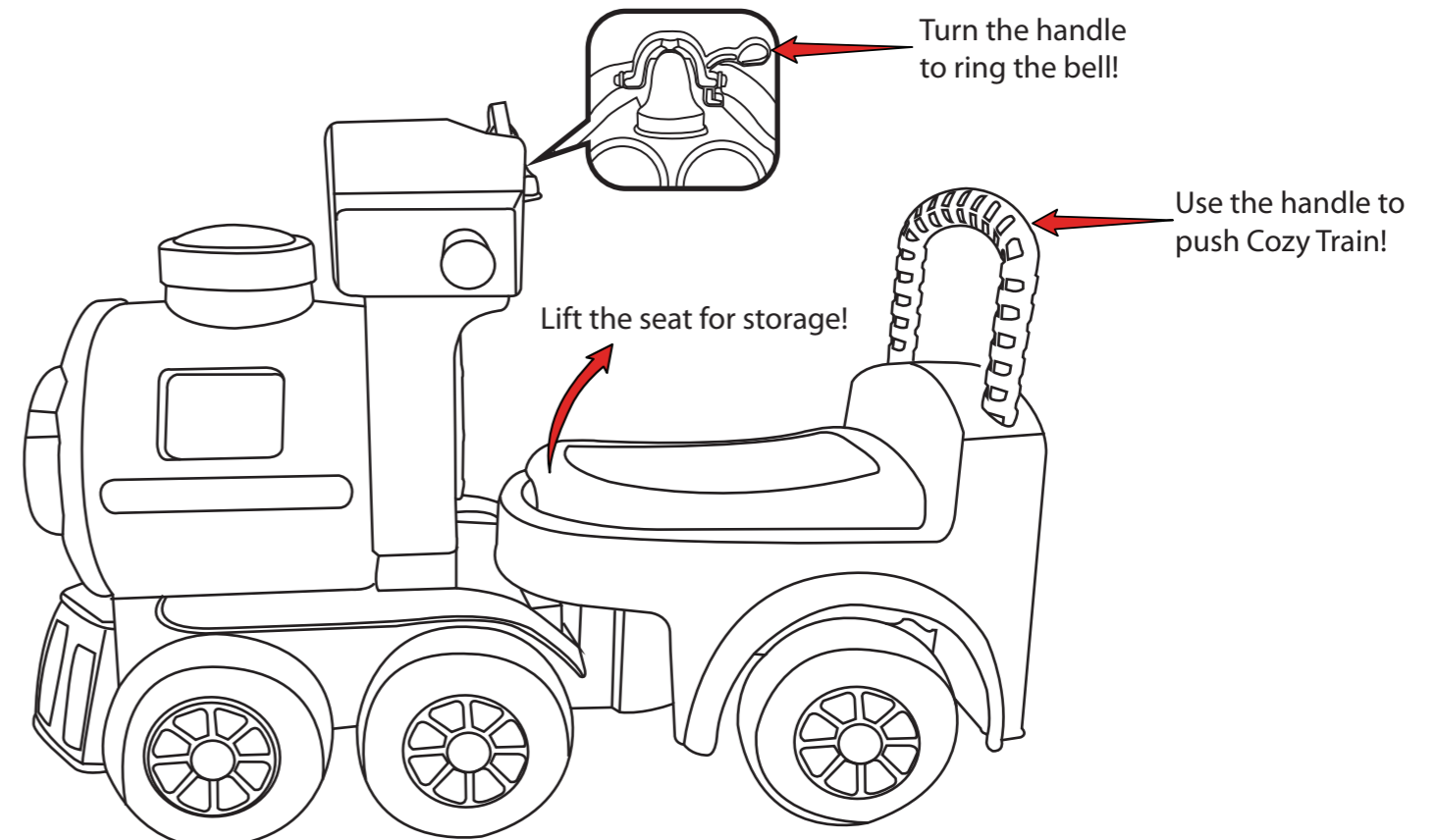

3 Insert the Engine

At an angle, insert the engine (B) into hooks on the wall of the Cozy Train (A). Then, snap the bottom into the openings on the Cozy Train.

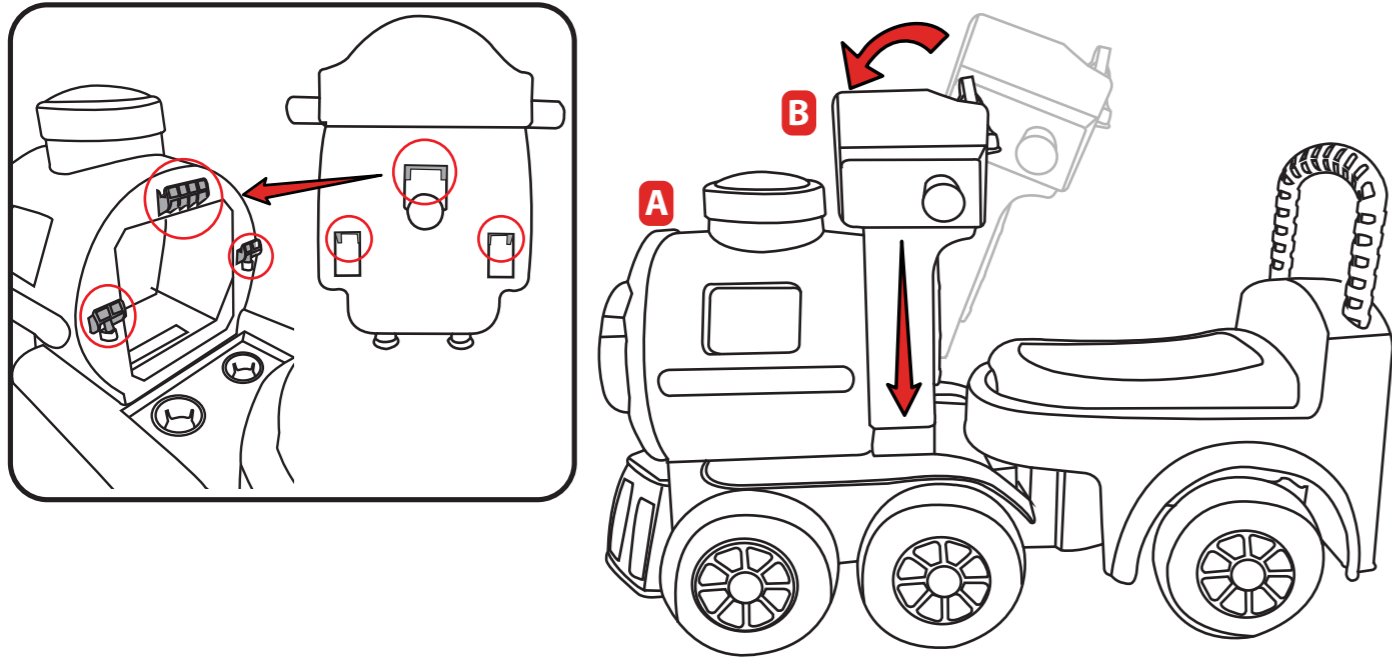

4 Assemble the Tracks

On a flat, level surface, connect the eight tracks together, making sure the tabs under the tracks are inserted into the slots on top of the tracks.

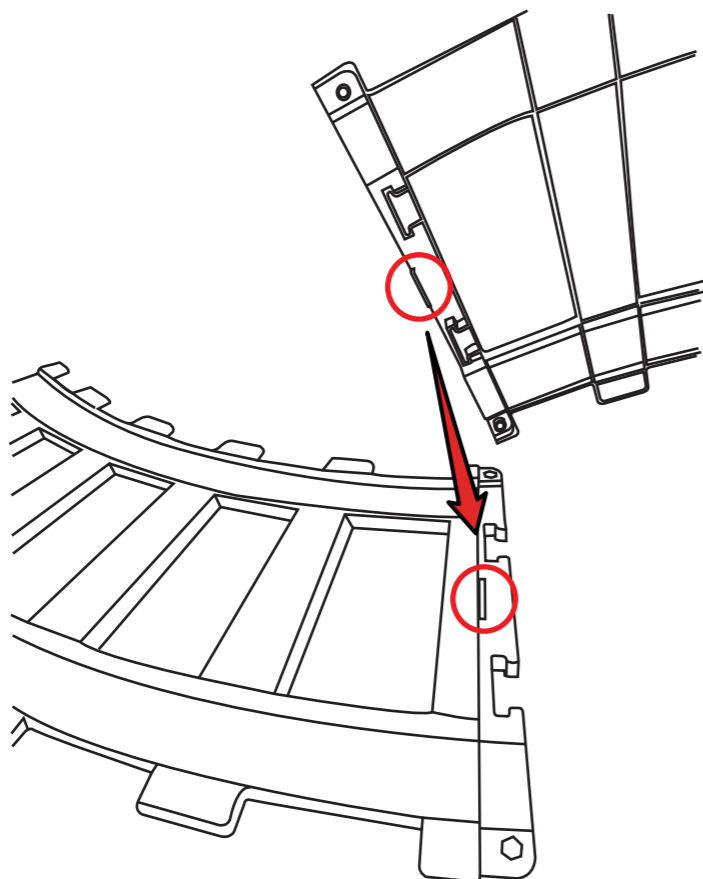

IMPORTANT INFORMATION YOU SHOULD KNOW!

- Read through all the instructions first.
- Clear a flat surface to lay out all the materials so that everything is close at hand.
- Illustrations are for reference only. Styles may vary from actual contents.
- Please remove all packaging including tags, ties & tacking stitches before giving this product to a child.
- **Make sure you have all contents before assembling. If anything is missing or if you have questions, we're here to help. Give our consumer service team a call at 1-800-321-0183.**

Let's be careful!

⚠ WARNING!

- ADULT ASSEMBLY REQUIRED.
- Adult supervision required. Do not leave children unattended.
- Please keep this manual as it contains important information.
- Ride-on toys should not be used near swimming pools, on or near steps, hills, roadways, or inclines.
- Shoes must be worn at all times.
- Only one rider at a time.
- Maximum weight limit: 50 lbs. (23 Kg)
- This product is intended for use by children ages 1 to 5 years.
- Not to be used by children over 5 years due to size limitations.
- This product is intended for indoor and outdoor family use only.
- Ride-on toys should be used with caution since skill is required to avoid falls or collisions which may cause injury to the user or third parties.
- Keep long hair and loose apparel away from the moving wheels.

© The Little Tikes Company, an MGA Entertainment company. LITTLE TIKES® is a trademark of Little Tikes in the U.S. and other countries. All logos, names, characters, likenesses, images, slogans, and packaging appearance are the property of Little Tikes.

Printed in China · 0222-0-C3

CONSUMER SERVICE

Little Tikes Consumer Service
www.littletikes.com
 2180 Barlow Road
 Hudson, Ohio 44236 U.S.A.
 1-800-321-0183

MGA Entertainment UK Ltd.
www.littletikes.co.uk
 50 Presley Way, Crownhill, Milton
 Keynes, MK8 0ES, Bucks, UK
 support@LittleTikesStore.co.uk
 Tel: +0 800 521 558

MGA Entertainment (Netherlands) B.V.
 Baronie 68-70
 2404 XG Alphen a/d Rijn
 The Netherlands
 Tel: +31 (0) 172 758038

**Imported by MGA Entertainment
 Australia Pty Ltd**
www.littletikes.com.au
 Suite 2.02, 32 Delhi Road
 Macquarie Park NSW 2113
 1300 059 676



LIMITED WARRANTY

The Little Tikes Company makes fun, high quality toys. We warrant to the original purchaser that this product is free of defects in materials or workmanship for one year * from the date of purchase (dated sales receipt is required for proof of purchase). At the sole election of The Little Tikes Company, the only remedies available under this warranty will be the replacement of the defective part or replacement of the product. This warranty is valid only if the product has been assembled and maintained per the instructions. This warranty does not cover abuse, accident, cosmetic issues such as fading or scratches from normal wear, or any other cause not arising from defects in material and workmanship. *The warranty period is three (3) months for daycare or commercial purchasers.
U.S.A and Canada: For warranty service or replacement part information, please visit our website at www.littletikes.com, call 1-800-321-0183 or write to: Consumer Service, The Little Tikes Company, 2180 Barlow Road, Hudson OH 44236, U.S.A. Some replacement parts may be available for purchase after warranty expires—contact us for details.
Outside U.S.A and Canada: Contact place of purchase for warranty service. This warranty gives you specific legal rights, and you may also have other rights, which vary from country/state to country/state. Some countries/states do not allow the exclusion or limitation of incidental or consequential damages, so the above limitation or exclusion may not apply to you.

A Few Things Before You Start!

BEFORE you begin assembly, make sure you have all the parts listed below.
Questions? We're here to help. Little Tikes® Consumer Service: 1-800-321-0183

Train Parts

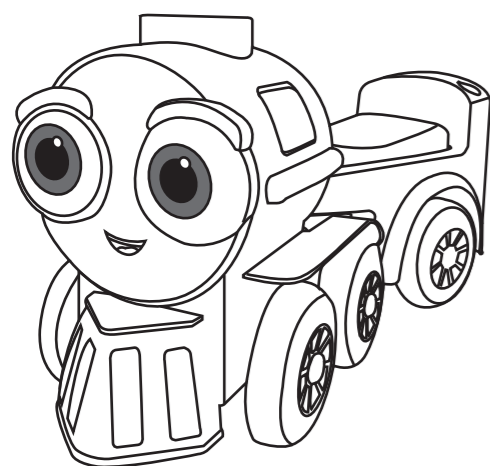

A Cozy Train (1)

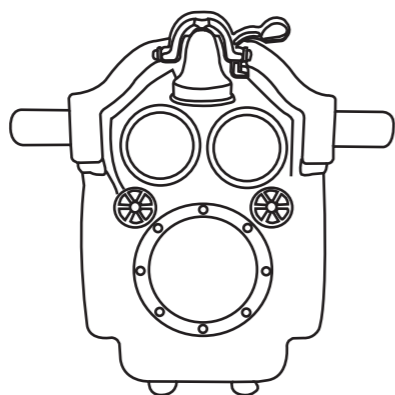

B Engine (1)



C Smokestack (1)

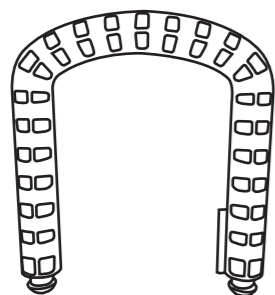

D Handle (1)

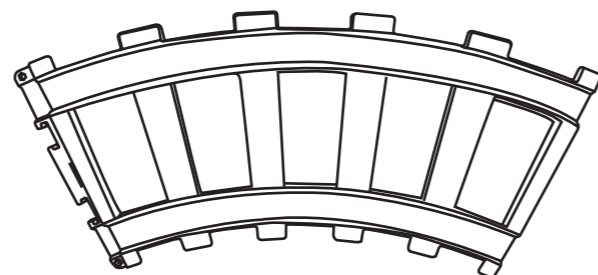

E Tracks (8)



IMPORTANT NOTE: Assembly is one-time snap.
Make sure parts are in the correct orientation before attaching.

1 Attach the Handle to the Cozy Train

Attach the handle (D) to the back of the Cozy Train (A). The handle is designed to only fit one way. Make sure the rib on the handle slides into the slot on the Cozy Train.

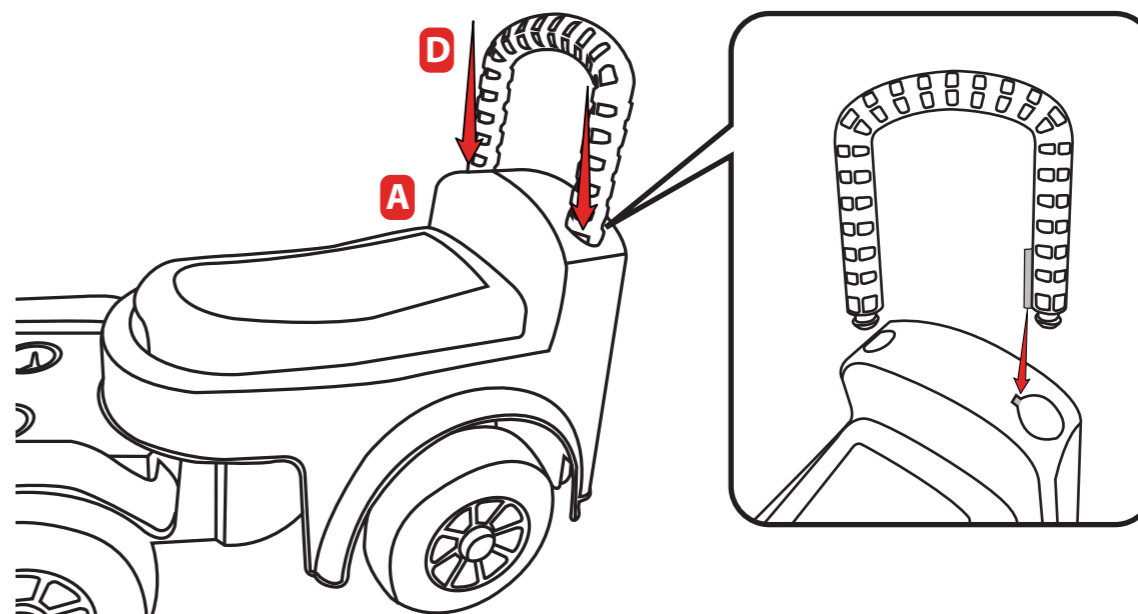

2 Add the Smokestack

Snap the smokestack (C) to the front of the Cozy Train (A).

