

LIMITED WARRANTY

The Little Tikes Company makes fun, high quality toys. We warrant to the original purchaser that this product is free of defects in materials or workmanship for one year * from the date of purchase (dated sales receipt is required for proof of purchase). At the sole election of The Little Tikes Company, the only remedies available under this warranty will be the replacement of the defective part or replacement of the product. This warranty is valid only if the product has been assembled and maintained per the instructions. This warranty does not cover abuse, accident, cosmetic issues such as fading or scratches from normal wear, or any other cause not arising from defects in material and workmanship. *The warranty period is three (3) months for daycare or commercial purchasers.

U.S.A and Canada: For warranty service or replacement part information, please visit our website at www.littletikes.com, call 1-800-321-0183 or write to: Consumer Service, The Little Tikes Company, 2180 Barlow Road, Hudson OH 44236, U.S.A. Some replacement parts may be available for purchase after warranty expires—contact us for details.

Outside U.S.A and Canada: Contact place of purchase for warranty service. This warranty gives you specific legal rights, and you may also have other rights, which vary from country/state to country/state. Some countries/states do not allow the exclusion or limitation of incidental or consequential damages, so the above limitation or exclusion may not apply to you.



SKUs: 657375 / 657351 / 657368

AGES 18 - 36 MONTHS
ADULT ASSEMBLY AND SUPERVISION REQUIRED

CONTENTS

- A. Pillow on Base
- B. Steering Handle with Handle Nut
- C. 4 Wheels

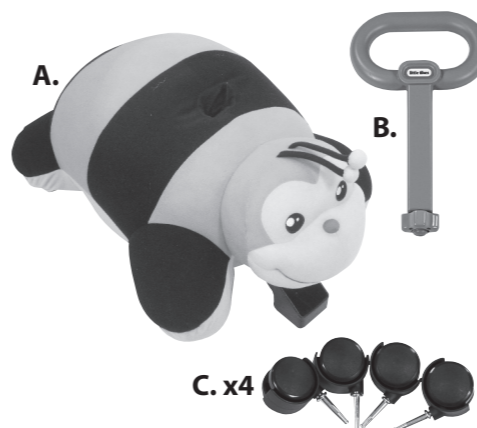

BEE
(657375)

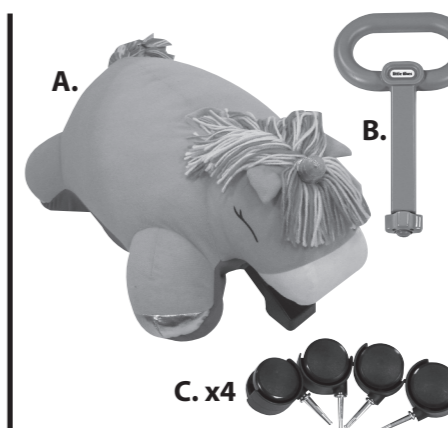

UNICORN
(657351)

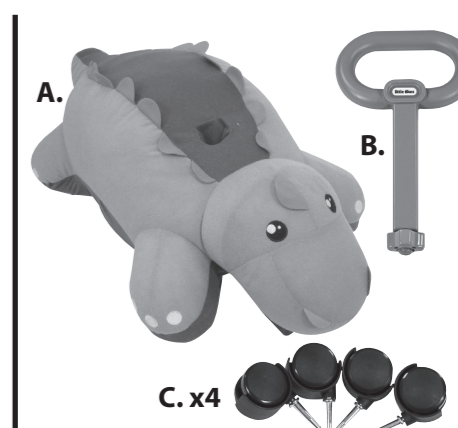

DINO
(657368)

EACH SOLD SEPARATELY

Illustrations are for reference only. Styles may vary from actual contents.
Please remove all packaging including tags, ties & tacking stitches before giving this product to a child.

⚠ WARNING

ADULT ASSEMBLY REQUIRED.

- Keep these instructions for future reference.
- Prior to assembly, this package contains small parts: hardware which is a choking hazard and may contain sharp edges and sharp points. Keep away from children until assembled.
- Adult supervision required. Do not leave children unattended.
- Ride-on toys should not be used near swimming pools, on or near steps, hills, roadways, or inclines.
- Ride-on toy should be used with caution since skill is required to avoid falls or collisions causing injury to the child or third parties.
- Shoes must be worn at all times.
- Only one rider at a time.
- Maximum weight: 50 lbs. (23 kg) per child.
- Not to be used by children over 36 months due to size limitations.

CARE INSTRUCTIONS

- Hand wash the pillow body only.

Please keep this manual as it contains important information.



© The Little Tikes Company, an MGA Entertainment company. LITTLE TIKES® is a trademark of Little Tikes in the U.S. and other countries. All logos, names, characters, likenesses, images, slogans, and packaging appearance are the property of Little Tikes.

Printed in China • 0820-0-E/INT



www.littletikes.com
www.littletikes.co.uk
www.littletikes.com.au

Little Tikes Consumer Service
2180 Barlow Road
Hudson, Ohio 44236 U.S.A.
1-800-321-0183

MGA Entertainment UK Ltd.
50 Presley Way, Crownhill, Milton
Keynes, MK8 0ES, Bucks, UK
support@LittleTikesStore.co.uk
Tel: +0 800 521 558

MGA Entertainment (Netherlands) B.V.
Baronie 68-70, 2404 XG
Alphen a/d Rijn, The Netherlands
Tel: +31 (0) 172 758038
E-mail: klantenservice@mgae.com

Imported by MGA Entertainment Australia Pty Ltd
Suite 2.02, 32 Delhi Road
Macquarie Park NSW 2113
1300 059 676

ASSEMBLY

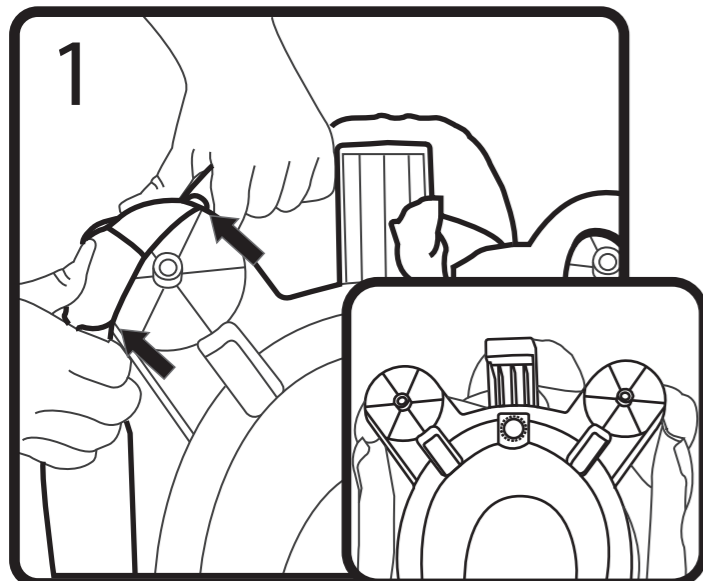

1 First, open the hook and loop fasteners under the base and remove pillow body from both front and rear wheel extensions and anti-tip bar on base.

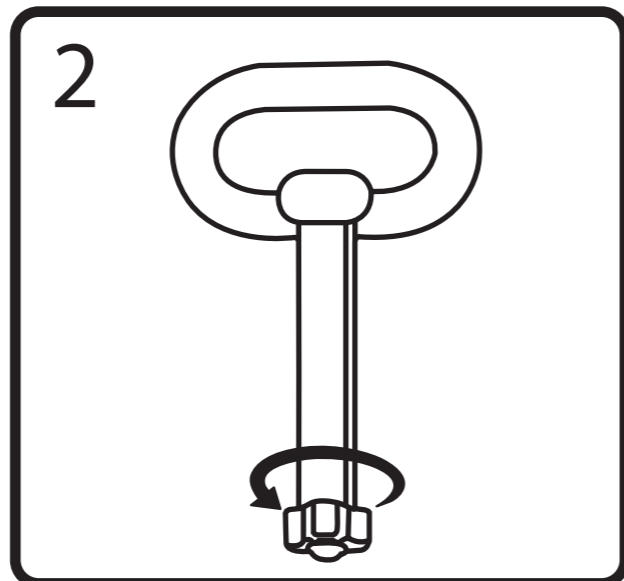

2 Unscrew steering handle's nut from handle and remove.

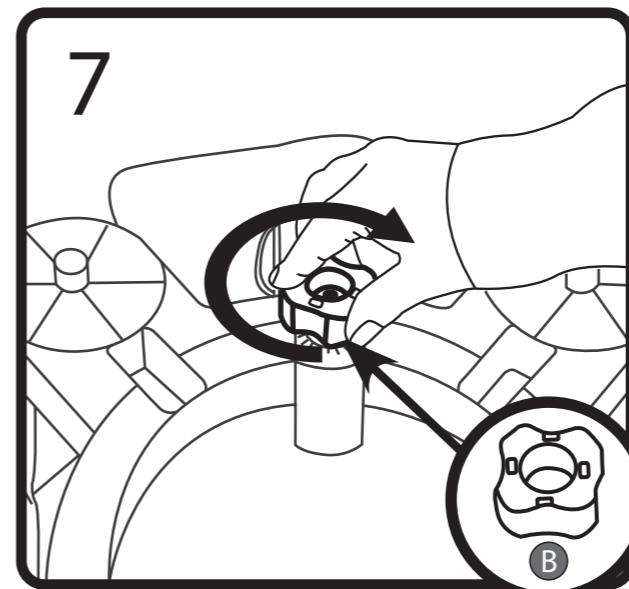

7 Secure using steering handle's nut (B) as shown.

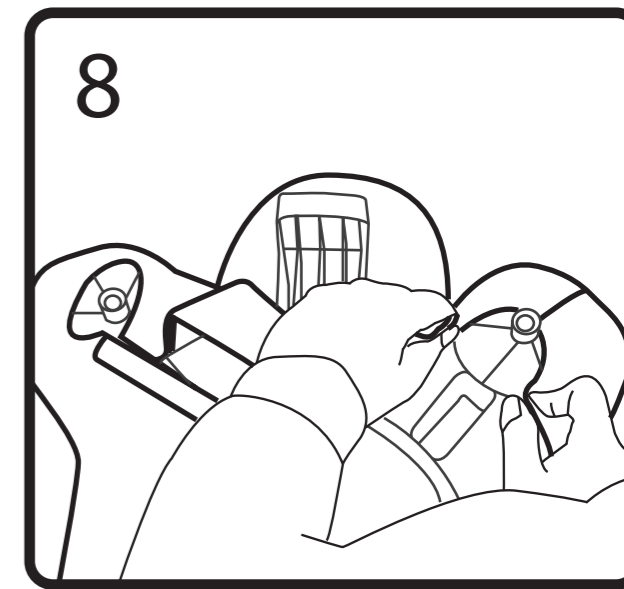

8 Pull pillow body back over both front and rear wheel extensions.

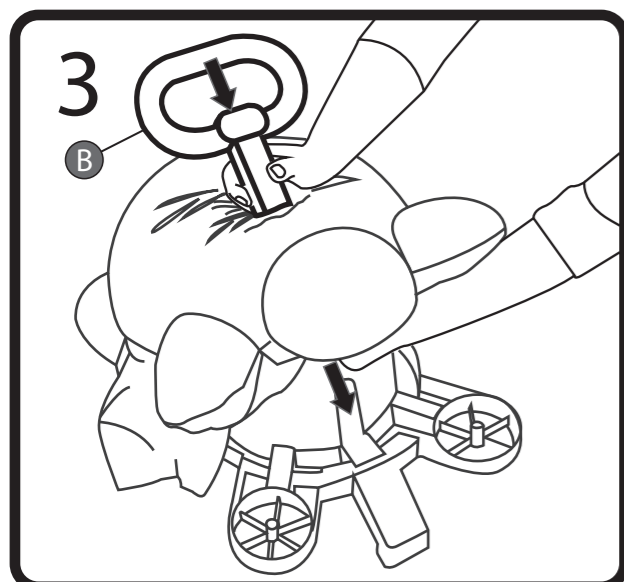

3 Thread steering handle (B) through opening located on the top of the pillow as shown. For correct placement, make sure the logo on the handle is facing the front.

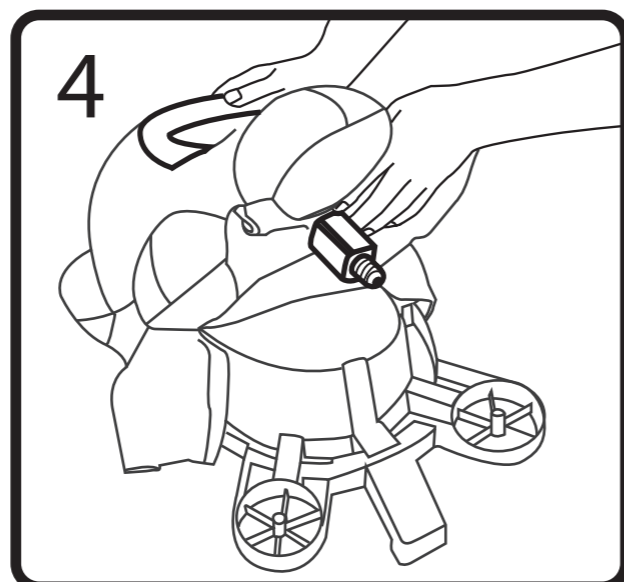

4 Be sure steering handle is completely through opening.

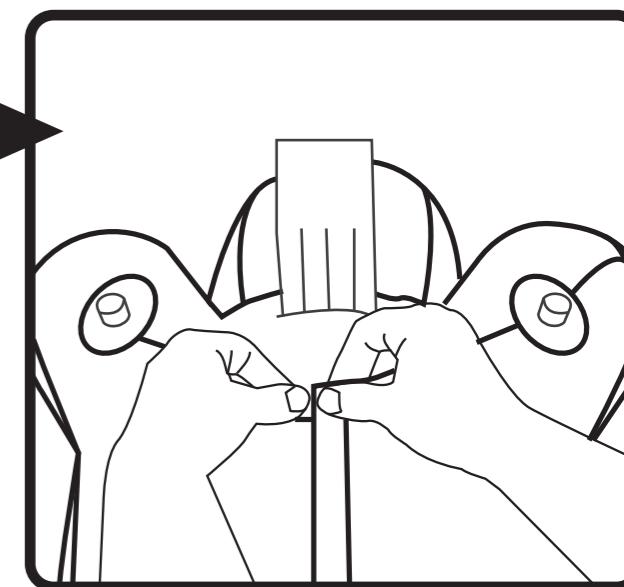
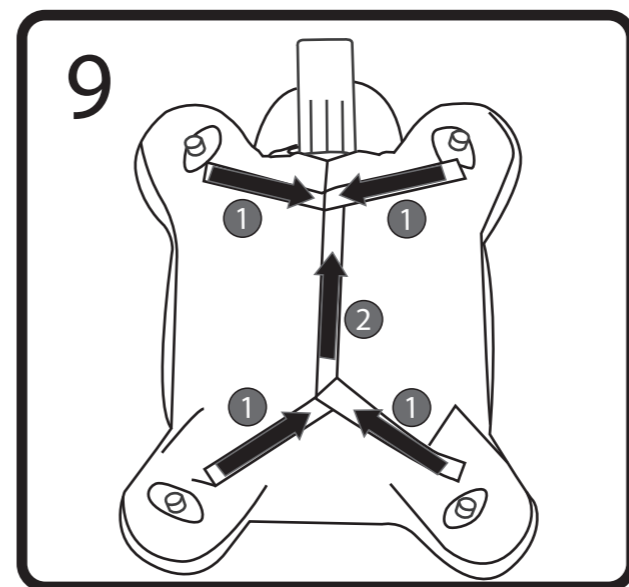

9
1. Pull cloth together at the LEGS and close the hook and loop fastener.
2. Pull the cloth together at the CENTER and close the hook and loop fasteners.

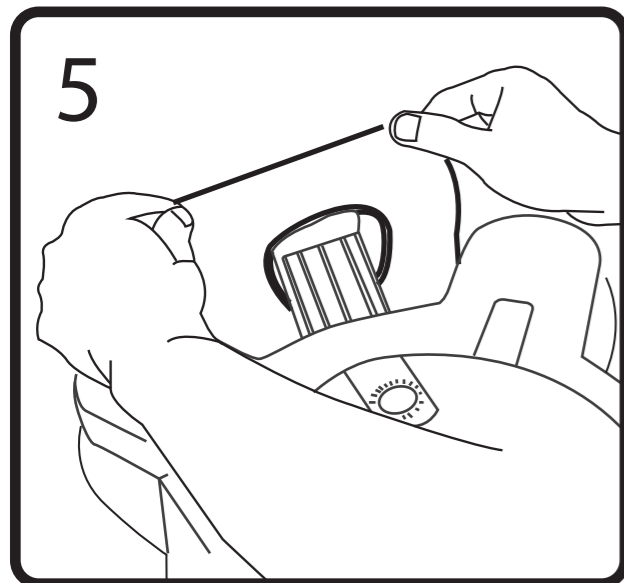

5 Pull pillow body over front anti-tip bar.

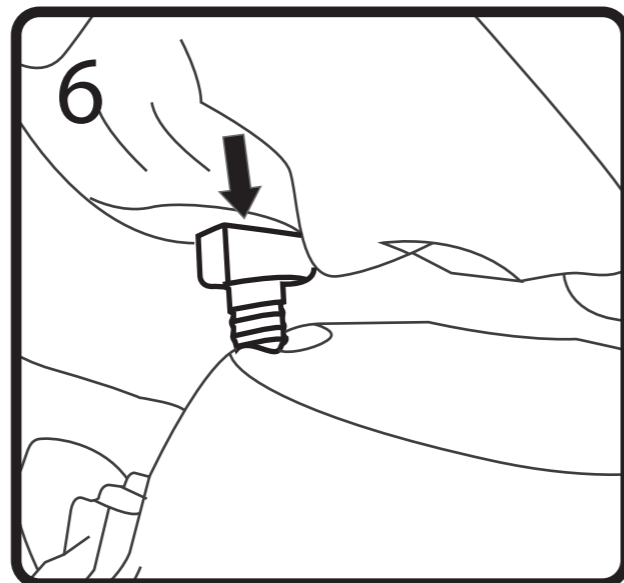

6 Insert steering handle through hole in base of the body as shown.

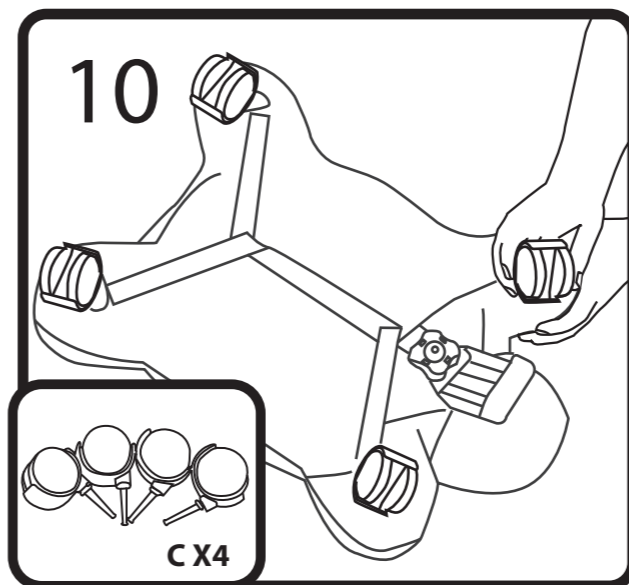

10 Push wheel (C) x4 into base until it snaps in place.