

SEISMIC BRACING SYSTEMS

Rod Stiffeners

PIPE ROD STIFFENER

- For use with Schedule 40 or Schedule 10 pipe
- Secures pipe to threaded rod for stiffening



Material: Steel
Finish: Electrogalvanized

Part #	Description
CSBRS1	1" Brace Pipe, 3/8", 1/2", 5/8" Rod

NVENT CADDY QUICK CLIP ROD STIFFENER

- Secures strut channel to threaded rod for stiffening
- One hand, snap-in place installation
- No tools or bolt tightening required



Material: Stainless Steel 316 (EN 1.4401)

Part #	Description
CSBRS2	3/8" Rod; Strut Type A (1 5/8" x 1 5/8")
CSBRS3	1/2" Rod; Strut Type A (1 5/8" x 1 5/8")
CSBRS4	5/8" Rod; Strut Type A (1 5/8" x 1 5/8")
CSBRS5	3/4" Rod; Strut Type A (1 5/8" x 1 5/8")
CSBRS6	7/8" Rod; Strut Type A (1 5/8" x 1 5/8")

STRUT ROD STIFFENER

- Secures strut channel to threaded rod for stiffening



Material: Steel
Finish: Electrogalvanized

Part #	Description
CSBRS37EG	3/8", 1/2", 5/8", 3/4" Rod;; Strut Type A (1 5/8" x 1 5/8")

SEISMIC BRACING SYSTEMS

Rigid Bracing

STEEL FLANGE ADAPTER

- Meets requirements of the Buy American Act
- Installs on top or bottom flange of I-beams
- Low profile easily fits between metal deck and steel structure
- Thumb spring retainer allows for ease of positioning
- Available pre-assembled to the Universal Structural Bracket, eliminating field assembly
- Snap-off bolt head helps enable easy installation and inspection of seismic sway braces
- Meets NFPA® 13 as pre-qualified for seismic applications



Material: Steel
Finish: Electrogalvanized



Part #	Description
CSBS1	EG, 1/4"–3/4" Flange
CSBS2	EG, 3/4"–1 1/4" Flange

UL Loads			
Part Number	Flange Thickness	Perpendicular to Structure	Parallel to Structure
CSBS1xx	1/4" - 3/8"	3,000 lb	2,200 lb
	3/8" - 3/4"	3,000 lb	2,765 lb
CSBS2xx	3/4" - 1 1/4"	3,000 lb	2,500 lb

FM Loads								
Part Number	Horizontal Capacity per Installation Angle from Vertical							
	Perpendicular to Structure				Parallel to Structure			
	30° - 44°	45° - 59°	60° - 74°	75° - 90°	30° - 44°	45° - 59°	60° - 74°	75° - 90°
CSBS1xx	850 lb	1,780 lb	2,770 lb	2,840 lb	880 lb	1,430 lb	2,020 lb	2,410 lb
CSBS2xx	1,220 lb	2,140 lb	2,580 lb	2,870 lb	1,100 lb	1,820 lb	2,190 lb	2,680 lb



SEISMIC BRACING SYSTEMS

Rigid Bracing

STEEL FLANGE ADAPTER ASSEMBLY

- Meets requirements of the Buy American Act
- Steel Flange Adapter and Universal Structural Bracket are preassembled, limiting work required in the field
- Installs on top or bottom flange of I-beams
- Low profile easily fits between metal deck and steel structure
- Thumb spring retainer allows for ease of positioning
- Integrated angle gauge easily displays brace member angle of installation
- Snap-off bolt head helps enable easy installation and inspection of seismic sway braces
- Works with 1" through 2" brace pipes to reduce inventory
- Meets NFPA® 13 as pre-qualified for seismic applications



Material: Steel
Finish: Electrogalvanized



Part #	Description
CSBS1A	EG, 1/4"-3/4" Flange

UL Loads			
Part Number	Flange Thickness	Perpendicular to Structure	Parallel to Structure
CSBS1A	1/4" - 3/8"	3,000 lb	2,200 lb
	3/8" - 3/4"	3,000 lb	2,765 lb

FM Loads								
Part Number	Horizontal Capacity per Installation Angle from Vertical							
	Perpendicular to Structure				Parallel to Structure			
	30° - 44°	45° - 59°	60° - 74°	75° - 90°	30° - 44°	45° - 59°	60° - 74°	75° - 90°
CSBS1A	850 lb	1,780 lb	2,770 lb	2,840 lb	880 lb	1,430 lb	2,020 lb	2,410 lb

SEISMIC BRACING SYSTEMS

Rigid Bracing

ADJUSTABLE I-BEAM ADAPTER

- Meets requirements of the Buy American Act
- No loose parts
- No assembly required
- Snap-off bolt head helps enable easy installation and inspection of seismic sway braces
- Meets NFPA®-13 requirements for seismic sway bracing



Material: Steel
Finish: Electrogalvanized



OSHPD

Part #	Description
CSBS3	EG, 1/4"–3/4" Flange, 4"–8 1/2"
CSBS4	EG, 1/4"–3/4" Flange, 4"–14 1/2"
CSBS5	EG, 3/4"–1 1/4" Flange, 4"–18"

UL Loads			
Part Number	Flange Thickness	Perpendicular to Structure	Parallel to Structure
CSBS3	1/4" - 3/8"	3,000 lb	2,200 lb
	3/8" - 3/4"	3,000 lb	2,765 lb
CSBS4	1/4" - 3/8"	3,000 lb	2,200 lb
	3/8" - 3/4"	3,000 lb	2,765 lb
CSBS5	3/4" - 1 1/4"	3,000 lb	2,500 lb

FM Loads								
Part Number	Horizontal Capacity per Installation Angle from Vertical							
	Perpendicular to Structure				Parallel to Structure			
	30° - 44°	45° - 59°	60° - 74°	75° - 90°	30° - 44°	45° - 59°	60° - 74°	75° - 90°
CSBS3xx	1,180 lb	2,210 lb	2,830 lb	2,940 lb	820 lb	1,380 lb	2,080 lb	3,010 lb
CSBS4xx	1,180 lb	2,210 lb	2,830 lb	2,940 lb	820 lb	1,380 lb	2,080 lb	3,010 lb
CSBS5xx	1,220 lb	2,140 lb	2,580 lb	2,870 lb	1,100 lb	1,820 lb	2,190 lb	2,680 lb



SEISMIC BRACING SYSTEMS

Rigid Bracing

MULTI ATTACHMENT

- Disperses load over two anchors
- Minimizes the number of installed braces needed for concrete and wood structures
- Ideal for deck installations
- Use for both lateral and longitudinal sway brace applications
- Meets NFPA®-13 requirements for seismic sway bracing



Material: Steel
Finish: Electrogalvanized



Part #	Description
CSBMA050050EG	9/16" Hole 1, 9/16" Hole 2
CSBMA050075EG	13/16" Hole 1, 9/16" Hole 2

Mount to structure using holes indicated in HS1.

UL Loads		
Part Number	Service Pipe Size	Rating
CSBMA050050EG	1" - 12"	3,740 lb
CSBMA050075EG	1" - 12"	3,740 lb

FM Loads				
Part Number	Horizontal Capacity per Installation Angle from Vertical			
	30° - 44°	45° - 59°	60° - 74°	75° - 90°
CSBMA050050EG	3,290 lb	4,520 lb	5,540 lb	6,200 lb
CSBMA050075EG	3,290 lb	4,520 lb	5,540 lb	6,200 lb



SEISMIC BRACING SYSTEMS

Rigid Bracing

UNIVERSAL STRUCTURAL BRACKET

- Meets requirements of the Buy American Act
- Universal design allows one product to attach directly to concrete, wood, bar joist or I-beam adapters
- Integrated angle gauge easily displays brace member angle of installation
- Snap-off bolt head helps enable easy installation and inspection of seismic sway braces
- Works with 1" through 2" brace pipes to reduce inventory
- Low profile minimizes prying effect on concrete fasteners
- Meets NFPA® 13 as pre-qualified for seismic applications



Material: Steel
Finish: Electrogalvanized



Part #	Description
CSBU1	EG, 9/16" Hole
CSBU2	EG, 13/16" Hole

FM Loads				
Part Number	Horizontal Capacity per Installation Angle from Vertical			
	30° - 44°	45° - 59°	60° - 74°	75° - 90°
CSBU1xx	1,690 lb	2,210 lb	2,660 lb	3,090 lb
CSBU2xx	1,480 lb	2,290 lb	2,860 lb	3,090 lb



SEISMIC BRACING SYSTEMS

Rigid Bracing

UNIVERSAL STRUCTURAL BRACKET, STRUT BRACE

- Meets requirements of the Buy American Act
- For installations where strut brace is perpendicular to structure
- Works with brace members of 12 gauge strut type A
- One wrench size fits all required hardware, eliminating the need to change tools
- Shear-off head helps ensure correct torque and simplifies inspection



Material: Steel
Finish: Electrogalvanized

Part #	Description
CSBUS1	9/16" Hole Size
CSBUS2	13/16" Hole Size

FM Loads — Brace Member: 12 GA Strut Channel				
Part Number	Horizontal Capacity per Installation Angle from Vertical			
	30° - 44°	45° - 59°	60° - 74°	75° - 90°
CSBUS1	2,010 lb	2,840 lb	3,420 lb	3,810 lb
CSBUS2	2,010 lb	2,840 lb	3,420 lb	3,810 lb



SEISMIC BRACING SYSTEMS

Rigid Bracing

STRUT SEISMIC HINGE BRACKET ASSEMBLY

- For installations where strut brace is parallel to structure
- Works with brace members of 12 gauge strut type A
- One wrench size fits all required hardware, eliminating the need to change tools
- Shear-off head helps ensure correct torque and simplifies inspection



Material: Steel
Finish: Electrogalvanized

Part #	Description
CSBUS1PA	9/16" Hole Size
CSBUS2PA	13/16" Hole Size

FM Loads — Brace Member: 12 GA Strut Channel				
Part Number	Horizontal Capacity per Installation Angle from Vertical			
	30° - 44°	45° - 59°	60° - 74°	75° - 90°
CSBU1PA	1,690 lb	2,210 lb	2,660 lb	3,090 lb
CSBU2PA	1,480 lb	2,290 lb	2,860 lb	3,090 lb



SEISMIC BRACING SYSTEMS

Rigid Bracing

TRAPEZE SWAY BRACE, STRUT

- Meets requirements of the Buy American Act
- Seismically braces trapeze hangers
- Retrofit ability allows for the brace to be installed after the trapeze assembly is installed
- Works with brace members of 12 gauge strut type A
- One wrench size fits all required hardware, eliminating the need to change tools
- Shear-off head helps ensure correct torque and simplifies inspection
- FM® Specification Tested



Material: Steel
Finish: Electrogalvanized

Part #	Description
CSBR2	3/8", 1/2", 5/8", 3/4" Rod Size

FM Loads — Brace Member: 12 GA Strut Channel				
Part Number	Horizontal Capacity per Installation Angle from Vertical			
	30° - 44°	45° - 59°	60° - 74°	75° - 90°
CSBR2	1,031 lb	1,812 lb	2,000 lb	2,231 lb



SEISMIC BRACING SYSTEMS

Rigid Bracing

TRAPEZE SWAY BRACE, PIPE

- Meets requirements of the Buy American Act
- Seismically braces trapeze hangers
- Retrofit ability allows for the brace to be installed after the trapeze assembly is installed
- Works with brace members of schedule 40 pipe, EMT conduit, and rigid conduit
- One wrench size fits all required hardware, eliminating the need to change tools
- Shear-off head helps ensure correct torque and simplifies inspection
- FM® Specification Tested



Material: Steel
Finish: Electrogalvanized

Part #	Description
CSBR1	3/8", 1/2", 5/8", 3/4" Rod Size

FM Loads					
Part Number	Brace Member	Horizontal Capacity per Installation Angle from Vertical			
		30° - 44°	45° - 59°	60° - 74°	75° - 90°
CSBR1	1" EMT Conduit	623 lb	881 lb	1,148 lb	1,148 lb
	1" Rigid Conduit	755 lb	1,109 lb	1,738 lb	1,738 lb
	1" Schedule 40 Pipe	755 lb	1,109 lb	1,738 lb	1,738 lb

STRUT SEISMIC HINGE

- Complete hinge assembly
- Ideal for attaching sway bracing to MEP system supports
- Attaches to strut trapezes and to structure



Material: Steel
Finish: Electrogalvanized

Part #	Description
CSBSH00375EG	9/16" Hole 1, 7/16" Hole 2
CSBSH00500EG	9/16" Hole 1, 9/16" Hole 2
CSBSH00625EG	9/16" Hole 1, 11/16" Hole 2
CSBSH00750EG	9/16" Hole 1, 13/16" Hole 2

SEISMIC BRACING SYSTEMS

Rigid Bracing



Seismic Lighting Fixture Clip – see page 313.

- Secures fluorescent light fixtures to the ceiling frame members
- Requires no additional chains, cables or slack wires attached to the fixture
- Helps strengthen integrity of the T-Grid system
- Holds in place against the force of standard fire-hose pressure
- Meets U.S. building code and electrical code specifications
- Also satisfies NEC® 410.16(C) positive attachment for secure fastening of luminaires (fixtures) complying with Building Code Reference AC184

CLEVIS BOLT SPACER

- Seismically braces the 401 Clevis Hanger series for lateral load
- Retrofit ability allows the spacer to be installed after the clevis and pipe are installed
- Ears easily pinch closed around the clevis hanger cross bolt with pliers
- FM® Specification Tested



Material: Steel
Finish: ElectroGalvanized

Part #	Pipe Size
CSBCS0100	1"
CSBCS0125	1 1/4"
CSBCS0150	1 1/2"
CSBCS0200	2"
CSBCS0250	2 1/2"
CSBCS0300	3"
CSBCS0350	3 1/2"
CSBCS0400	4"
CSBCS0500	5"
CSBCS0600	6"
CSBCS0800	8"
CSBCS1000	10"
CSBCS1200	12"

SEISMIC BRACING SYSTEMS

Rigid Bracing

RIVET HEAD SHEAR BOLT

- One wrench size fits all required hardware, eliminating the need to change tools



Part #	Product
CSBSB50EG	Steel Flange Adapter, Steel Flange Adapter Assembly, Adjustable I-Beam Adapter
CSBUB62EG	Strut Seismic Hinge Bracket Assembly, Trapeze Sway Brace, Strut, Universal Structural Bracket, Strut Brace
Material: Steel – Finish: Electrogalvanized	
CSBSBR50EG	Trapeze Sway Brace, Pipe, Universal Structural Bracket, Universal Sway Brace

SHEAR NUT

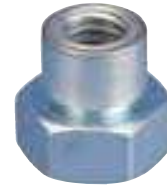

Material: Steel
Finish: Electrogalvanized

Part #	Product
CSBHN50EG	Universal Sway Brace
CSBLN50EG	Universal Sway Brace
CSBSN37EG	Adjustable I-Beam Adapter, Trapeze Sway Brace, Pipe, Trapeze Sway Brace, Strut



Reference



REFERENCE
Convenient Sizing Information

RIGID STEEL CONDUIT (Heavy-, or thick-Wall Conduit)

Nominal Conduit Size	Outside Diameter	Nominal Inside Diameter	Minimum Wt. Per 100 Ft. With Couplings Attached	Weight Of Conduit & Conductors Per 100 Ft.
3/8"	0.675 in.	0.493 in.	51.5 lbs.	65.1 lbs.
1/2"	0.840 in.	0.632 in.	79.0 lbs.	101.1 lbs.
3/4"	1.050 in.	0.836 in.	105.0 lbs.	145.8 lbs.
1"	1.315 in.	1.063 in.	153.0 lbs.	219.3 lbs.
1 1/4"	1.660 in.	1.394 in.	201.0 lbs.	318.3 lbs.
1 1/2"	1.900 in.	1.624 in.	249.0 lbs.	408.8 lbs.
2"	2.375 in.	2.083 in.	332.0 lbs.	593.8 lbs.
2 1/2"	2.875 in.	2.489 in.	527.0 lbs.	901.0 lbs.
3"	3.500 in.	3.090 in.	682.6 lbs.	1259.0 lbs.
3 1/2"	4.000 in.	3.570 in.	831.0 lbs.	1604.0 lbs.
4"	4.500 in.	4.050 in.	972.3 lbs.	1967.0 lbs.

INTERMEDIATE METAL CONDUIT

Nominal Conduit Size	Outside Diameter	Nominal Inside Diameter	Minimum Wt. Per 100 Ft. With Couplings Attached	Weight Of Conduit & Conductors Per 100 Ft.
1/2"	0.815 in.	0.745 in.	60.0 lbs.	82.1 lbs.
3/4"	1.029 in.	0.954 in.	82.0 lbs.	122.8 lbs.
1"	1.290 in.	1.205 in.	116.0 lbs.	182.3 lbs.
1 1/4"	1.638 in.	1.553 in.	150.0 lbs.	267.3 lbs.
1 1/2"	1.883 in.	1.793 in.	182.0 lbs.	341.8 lbs.
2"	2.360 in.	2.266 in.	242.0 lbs.	503.8 lbs.
2 1/2"	2.857 in.	2.727 in.	401.0 lbs.	775.0 lbs.
3"	3.476 in.	3.346 in.	493.0 lbs.	1069.0 lbs.
3 1/2"	3.971 in.	3.841 in.	573.0 lbs.	1346.0 lbs.
4"	4.466 in.	4.336 in.	638.0 lbs.	1632.0 lbs.

ELECTRICAL METALLIC TUBING (EMT) – (Thin-Wall Conduit)

Nominal Conduit Size	Outside Diameter	Nominal Inside Diameter	Minimum Wt. Per 100 Ft. With Couplings Attached	Weight Of Conduit & Conductors Per 100 Ft.
3/8"	0.577 in.	0.493 in.	23.0 lbs.	36.6 lbs.
1/2"	0.706 in.	0.622 in.	28.5 lbs.	50.6 lbs.
3/4"	0.922 in.	0.824 in.	43.5 lbs.	84.3 lbs.
1"	1.163 in.	1.049 in.	64.0 lbs.	130.3 lbs.
1 1/4"	1.510 in.	1.380 in.	95.0 lbs.	212.3 lbs.
1 1/2"	1.740 in.	1.610 in.	110.0 lbs.	269.8 lbs.
2"	2.197 in.	2.067 in.	140.0 lbs.	401.8 lbs.
2 1/2"	2.875 in.	2.731 in.	205.0 lbs.	579.0 lbs.
3"	3.500 in.	3.356 in.	250.0 lbs.	826.3 lbs.
3 1/2"	4.000 in.	3.834 in.	325.0 lbs.	1098.0 lbs.
4"	4.500 in.	4.334 in.	370.0 lbs.	1364.0 lbs.

Dimensions taken from ANSI™ C80.3-1977.

Conduit plus weight of heaviest conductor combination as specified by the National Electrical Code. ANSI is a trademark of American National Standards Institute, Inc.

REFERENCE

Convenient Sizing Information

RIGID ALUMINUM CONDUIT

Nominal Conduit Size	Outside Diameter	Nominal Inside Diameter	Minimum Wt. Per 100 Ft. With Couplings Attached	Weight Of Conduit & Conductors Per 100 Ft.
1/2"	0.840 in.	0.632 in.	27.4 lbs.	49.5 lbs.
3/4"	1.050 in.	0.836 in.	36.4 lbs.	77.2 lbs.
1"	1.315 in.	1.063 in.	53.0 lbs.	119.3 lbs.
1 1/4"	1.660 in.	1.394 in.	69.6 lbs.	186.9 lbs.
1 1/2"	1.900 in.	1.624 in.	82.2 lbs.	242.0 lbs.
2"	2.375 in.	2.083 in.	115.7 lbs.	377.5 lbs.
2 1/2"	2.875 in.	2.489 in.	182.5 lbs.	556.5 lbs.
3"	3.500 in.	3.090 in.	238.9 lbs.	815.2 lbs.
3 1/2"	4.000 in.	3.570 in.	287.7 lbs.	1061.0 lbs.
4"	4.500 in.	4.050 in.	340.0 lbs.	1334.0 lbs.
5"	5.563 in.	5.073 in.	465.4 lbs.	2028.0 lbs.
6"	6.625 in.	6.093 in.	612.5 lbs.	2870.0 lbs.

Dimensions taken from ANSI™ C80.5-1977. Conduit plus weight of heaviest conductor combination as specified by the National Electrical Code.

SCHEDULE 40 PVC PLASTIC PIPE

Nominal Pipe Size	Outside Diameter	Wall Thickness	Weight Of Pipe	Weight Of Water
1/8"	.405 in.	.068 in.	.04 lbs./ft.	.02 lbs./ft.
1/4"	.540 in.	.088 in.	.07 lbs./ft.	.04 lbs./ft.
3/8"	.675 in.	.091 in.	.10 lbs./ft.	.08 lbs./ft.
1/2"	.840 in.	.109 in.	.15 lbs./ft.	.1 lbs./ft.
3/4"	1.050 in.	.113 in.	.2 lbs./ft.	.2 lbs./ft.
1"	1.315 in.	.133 in.	.3 lbs./ft.	.4 lbs./ft.
1 1/4"	1.660 in.	.140 in.	.4 lbs./ft.	.6 lbs./ft.
1 1/2"	1.900 in.	.145 in.	.5 lbs./ft.	.9 lbs./ft.
2"	2.375 in.	.154 in.	.6 lbs./ft.	1.4 lbs./ft.
2 1/2"	2.875 in.	.203 in.	1.0 lbs./ft.	2.1 lbs./ft.
3"	3.500 in.	.216 in.	1.3 lbs./ft.	3.2 lbs./ft.
3 1/2"	4.000 in.	.226 in.	1.6 lbs./ft.	4.3 lbs./ft.
4"	4.500 in.	.237 in.	1.9 lbs./ft.	5.5 lbs./ft.

ANSI is a trademark of American National Standards Institute, Inc.



REFERENCE

Convenient Sizing Information

ALL THREADED ROD (ATR)

Nominal Size and Thread	Root Area		Design Load (SF = 5)	
1/4" - 20	0.027 in. ²	0.174 cm ²	240 lbs.	1.07 kN
5/16" - 18	0.045 in. ²	0.290 cm ²	400 lbs.	1.78 kN
3/8" - 16	0.068 in. ²	0.438 cm ²	610 lbs.	2.71 kN

Dimensions taken from ANSI™ B1.1-1982 Unified Inch Screw Threads.

All threads are UNCR series.

Tabulated loads are based on an allowable tensile stress of 12000 psi (82.7 MPa) reduced by 25% resulting in 9000 psi (62 MPa). From ANSI®/MSS SP-58, Table 3.

ANSI is a trademark of American National Standards Institute, Inc.

MC CABLE

AWG Size	Nominal Outer Diameter in Inches	
	Insulated Ground	Bare Ground
14-2 Solid	.450	.430
14-3 Solid	.480	.435
14-4 Solid	.510	.485
12-2 Solid	.495	.465
12-3 Solid	.530	.500
12-4 Solid	.565	.560
10-2 Solid	.560	.520
10-3 Solid	.600	.550
10-4 Solid	.645	.615
8-2 Strd.	.710	.675
8-3 Strd.	.770	.710
8-4 Strd.	.835	.770
6-2 Strd.	.795	.755
6-3 Strd.	.865	.800
6-4 Strd.	.945	.865
4-2 Strd.	.945	.895
4-3 Strd.	1.035	.945
4-4 Strd.	1.135	1.035
2-2 Strd.	1.075	1.015
2-3 Strd.	1.180	1.075
2-4 Strd.	1.295	1.180



REFERENCE

Convenient Sizing Information

AC CABLE

Type Of Armored Cable	Type Of Circuit Conductor	AWG Size Of Circuit Conductors	Minimum External Diameter of Armor (Inches)							
			Cable with Two Circuit Conductors and No Grounding Conductor	Cable with Two Circuit Conductors and No Grounding Conductor and Cable Grounding Conductor	Cable with Three Circuit Conductors and No Grounding Conductor and Cable Grounding Conductor	Cable with Four Circuit Conductors and No Grounding Conductor and Cable Grounding Conductor and a Grounding Conductor	Cable with Four Circuit Conductors and a Grounding Conductor	Cable with Four Circuit Conductors and a Grounding Conductor and a Grounding Conductor		
			Solid	Stranded	Solid	Stranded	Solid	Stranded	Solid	Stranded
		14	0.433	0.453	0.486	0.522				
		12	0.467	0.489	0.520	0.545				
		10	0.476	0.500	0.541	0.587				
		8	0.570	0.601	0.654	0.714	0.637	0.695	0.759	0.882
		6					0.739	0.807		
ACTMM	THHN	4					0.885	0.970	1.066	1.228
		2					1.014	1.115		

REFERENCE

The nVent CADDY Fastener Story

QUALITY CONTROL

Fasteners, manufactured by nVent CADDY, are produced from spring steel, galvanized steel, plastic, as well as other materials. We are known in the industry as a leader in the design and production of Spring Steel Fasteners. The following is the story of how we manufacture these quality Spring Steel Fasteners.

MANUFACTURING

The steel for Fasteners is procured in mill lots to AISI and nVent Standards; other materials are equally controlled.

LOAD RATING

Fasteners are designed with two load limits:

- 1) Static load limit is a rated stationary load limit for a fastener. nVent Standards require that test samples with stand a load equal to three times this catalog rating.
- 2) The ultimate static load limit is the rated stationary load limit which, if exceeded, may cause failure of the fastener. nVent Standards require that test samples with stand this catalog rating. Some Fasteners also are designed with an undefined rating and are to be used for positioning only with no loading on them.
- 3) Applications and load ratings may change without notice. Refer to instruction sheet in box or contact nVent for current load and application information.

Static load limit and ultimate static load limit values specify maximum allowable installed loads for user applications. These values are for loads applied VERTICALLY to the normal fastener installation except as may be diagrammed otherwise. Where the load rating of the Fastener exceeds that of the structural member, the lowest rated item must set the load limit.

NOTE: Fasteners are intended for support of electrical components at stationary loads. Not to be used for dynamic loads such as fluid and gas distribution components, etc.

IMPORTANT

Fasteners used with wire, rod, or threaded rod are designed for use with coarse round wire, hot rolled carbon steel bar, cold rolled carbon steel bar and threaded rod all meeting AISI specifications and tolerances.



REFERENCE

The nVent CADDY Fastener Story

QUALITY ASSURANCE

Incoming steel is sampled and inspected for conformance to AISI specifications and nVent Standards. Test fixtures and procedures for development and quality control are designed to simulate normal field applications. Fasteners are tested, on a sample basis, to nVent Standards by certified inspectors. Testing of specific quantities of Fasteners to destruction in special statistical audits ensures a continuous high level of quality.

HEAT TREATING

nVent CADDY Spring Steel Fasteners are heat treated in modern shaker hearth furnaces. Precision controls maintain heat treat operations within the established limits developed by nVent for Fasteners. nVent Standards incorporate consideration of fastener material and application.

Fasteners are conveyed directly from the high temperature furnace to the quench tank, through a cleaning cycle and into the tempering furnace. The complete heat treat cycle is automatically controlled.

PRODUCTION PRESSES

Fasteners are produced with modern presses and precision tooling. Presses and tools are designed for close tolerance stamping.

RESEARCH AND DEVELOPMENT

nVent Research and Development department is constantly working on new Fasteners and, at the same time, improving the present line. Starting with six basic Fasteners, the line now has several hundred basic types. The majority of the Fastener line is the result of nVent development of Fasteners to provide a solution for a customer's problem.

NOTE: Special applications not specified MUST be submitted to nVent for engineering approval and load rating.

All cULus Listed Fasteners meet the requirements of one of the following UL standards: UL1565, UL2239 or UL514B.



MATERIALS – METALS

Steel

Steel is an alloy of iron and other elements, the most common being Carbon. Varying the amount of alloying elements and the form of their presence in the steel controls qualities such as the hardness, ductility, tensile strength and corrosion resistance of the resulting steel.

Stainless Steel

Stainless Steel is an alloy of iron and carbon that is more resistant to rust, staining and corrosion than regular steel.

Stainless Steel 304 (1.4301)

The most familiar stainless steel is Type 304, containing 18-20% chromium and 8-10% nickel.

- Also referred to as 'A2'

Stainless Steel 316 (1.4401)

The second most common stainless steel is 316, also called marine grade stainless, used primarily for its increased resistance to corrosion.

- Also referred to as 'A4'

Spring Steel

Spring steel is an alloy of iron and Carbon. Spring steel alloys can be easily formed into complex shapes, and then heat-treated to greatly increase strength.

*Note: Spring steel Fasteners are for indoor use in non-corrosive environments. Mild steel Fasteners can be used outdoors in humid or mildly corrosive environments. Not to be used in certain areas such as over indoor pools, etc.

Stainless Spring Steel 301

A highly ductile steel used on formed products that hardens rapidly during mechanical working. Stainless 301 has better wear resistance and fatigue strength than Stainless 304 or standard Spring Steel.

Cast Iron

Cast Iron is a commercial alloy of iron, carbon and silicon that is cast in a mold. This results in a product that is hard, brittle, non-malleable and incapable of being hammer-welded but more easily fusible than steel.



MATERIALS – PLASTICS AND RUBBERS

Plastics versus thermosets

- Thermoplastics will melt and flow when heated.
- Thermosets have undergone an irreversible chemical reaction and additional heat will not melt them further.

Polyethylene (PE)

Polyethylene is a tough, light, flexible synthetic resin and is the most common thermoplastic. Many different grades exist with a broad range of physical properties.

Polypropylene (PP)

Polypropylene is a thermoplastic that is light, rugged and resistant to many chemical solvents, bases and acids. It is typically tough and flexible.

Polyvinyl Chloride (PVC)

Polyvinyl chloride (abbreviated PVC), is a thermoplastic made from a tough, chemically resistant synthetic resin. Unplasticized PVC is stiff and strong, but can be made softer and more flexible by the addition of plasticizers.

EPDM Rubber

EPDM (Ethylene Propylene Diene Monomer) is a thermoset elastomer that is inherently resistant to ozone, water and weather, and characterized by a wide range of applications.

SBR Rubber

SBR (Styrene Butadiene Rubber) is the most common type of synthetic rubber. This thermoset has good abrasion resistance, flexibility, and aging stability when protected by additives.

Nylon

Nylon is part of a family of thermoplastics known generically as polyamides. It is generally characterized by its durability, high elongation and excellent abrasion resistance.

Polyamide

See nylon

Xenoy

Xenoy is a thermoplastic blend that offers good chemical resistance, great impact resistance (even at low temperatures), and some heat resistance in conditions that require a high degree of toughness.

Polyisocyanurate

Polyisocyanurate (also called PIR, polyiso, or ISO) is a cellular, thermoset that is typically produced as a foam and used in rigid thermal insulation. As a result of its excellent thermal insulating efficiency, polyiso foam has become the standard for low temperature insulation applications.

Hydrous Calcium Silicate

Hydrous calcium silicate is an asbestos-free insulating material that can be molded into rigid shapes and forms for applications where precise temperature control, personnel protection and energy savings are required.



FINISHES

Painted

Paint is any liquid composition, which after application to a surface in a thin layer, is converted to a solid film. It is most commonly used to protect, color or provide texture to objects.

nVent CADDY ARMOUR

The Armour coating system features bi-metallic corrosion protection with an inorganic basecoat for sacrificial protection and an organic topcoat for barrier protection. The nVent standard for Armour includes at least 1,000 hours resistance against red rust when tested per the ASTM B117 and DIN 50021 salt spray tests. Armour is RoHS compliant.

Electro-galvanized (EG)

ASTM B633

This corrosion protective coating is applied after the fabrication of steel or malleable iron parts and uses an electrolytic plating process that deposits zinc. A second passivation coating of chromate is then applied for additional protection. Zinc electroplate products are recommended for indoor and mildly corrosive applications.

Pre-galvanized Zinc (PG)

ASTM A653/A653M

Pre-galvanized zinc is produced by continuously rolling steel coils or sheets through molten zinc at the mills. The coils or sheets are slit to size and fabricated by forming, shearing or punching to produce the finished product. During fabrication cut edges are not generally zinc coated; however, the zinc near the uncoated metal

becomes a sacrificial anode to protect the bare areas.

Pre-galvanized zinc products are generally recommended for indoor use on mildly corrosive environments.

Hot Dip Galvanized Zinc (HDG)

ASTM A123

After a product has finished its fabrication process, it is dipped into a bath of molten zinc. The zinc completely coats all edges and surfaces. Zinc thickness is controlled by the time the part is immersed in the molten zinc bath. Hot dip galvanized zinc products are recommended for indoor, outdoor and mildly corrosive environments.

Black Oxide

ASTM D769

Black oxide or blackening is a conversion coating for ferrous materials, copper and copper based alloys, zinc, powdered metals, and silver solder. It is used to add mild corrosion resistance and for appearance.

Copper Electro-Plated

Copper plating is the process in which a thin layer of copper is deposited on an item via an electric current.

Epoxy Powder Coated

Epoxy powder coating is applied electrostatically as a free-flowing, dry powder and finished by curing under heat to form a "skin". It is typically used to create a durable, hard wearing finish that is tougher than conventional paint.

Index

Part No.	Page	Part No.	Page	Part No.	Page
0070050EG	342	0350087PL	149	0506210EG	146
0070075EG	342	035RS0600EG	112	0506210PL	147
0070100EG	342	035RS0800EG	112	0506212EG	146
0070125EG	342	035RS1000EG	112	0506212PL	147
0070150EG	342	035RS1200EG	112	0507506EG	146
0070200EG	342	035RS1400EG	112	0507506PL	147
0100025EG	155	035RS1600EG	112	0507510EG	146
0100025PL	155	035RS1800EG	112	0507510PL	147
0100037EG	155	0370037EG	127	0507512EG	146
0100037PL	155	0370050EG	127	0507512PL	147
0100050EG	155	0380037EG	128	0508706EG	146
0100050PL	155	0403706PL	157	0508706PL	147
0100062EG	155	0403708PL	157	0508710EG	146
0100062PL	155	0413704PL	152	0508710PL	147
0100075EG	155	0413706PL	152	0508712EG	146
0100075PL	155	0413708PL	152	0508712PL	147
0100087EG	155	0413710PL	152	0513702PL	147
0100087PL	155	0415004PL	152	0513703PL	147
010H0037EG	156	0415006PL	152	0513704PL	147
010H0037PL	156	0415008PL	152	0513705PL	147
010H0050EG	156	0415010PL	152	0513706PL	147
010H0050PL	156	0422515EG	153	080750450PL	157
010H0062EG	156	0422520EG	153	122	115
010H0075EG	156	0423710EG	153	123	116
010H0075PL	156	0423715EG	153	350	188
010H0087EG	156	0423720EG	153	449	193
0110025EG	156	0423725EG	153	459	203
0110025PL	156	0423730EG	153	512	325
0110037EG	156	0423740EG	153	515	310
0110037PL	156	0425015EG	153	520	312
0110050EG	156	0425020EG	153	528	313
0110050PL	156	0425025EG	153	708	138
0110062EG	156	0425030EG	153	740	158
0110062PL	156	0425040EG	153	766	182
0110075EG	156	0431602EG	153	770	319
0110075PL	156	0470025PL	150	771	319
0110087EG	156	0470037PL	150	781	205
0120025EG	157	0470050PL	150	51212	325
0120037EG	157	0470062PL	150	51220	325
0120050EG	157	0470075PL	150	51230	325
0250025EG	148	0470087PL	150	70824	121
0250037EG	148	0501010EG	146	70858	121
0250050EG	148	0501010PL	147	122708	122
0250062EG	148	0502506EG	146	389001	339
0250075EG	148	0502506PL	147	389002	339
0250087EG	148	0502510EG	146	389003	339
025R3725EG	148	0502510PL	147	389004	339
025R5037EG	148	0502512EG	146	389005	339
025R6250EG	148	0502512PL	147	389006	339
0260037PL	149	0503706EG	146	389007	339
0260050PL	149	0503706PL	147	389008	339
0260062PL	149	0503710EG	146	389009	339
0260075PL	149	0503710PL	147	389011	339
0260087PL	149	0503712EG	146	389012	339
034SL0600EG	112	0503712PL	147	389013	339
034SL0800EG	112	0505006EG	146	389014	339
034SL1000EG	112	0505006PL	147	389015	339
034SL1200EG	112	0505010EG	146	389016	340
034SL1400EG	112	0505010PL	147	389017	339
0350037PL	149	0505012EG	146	389018	339
0350050PL	149	0505012PL	147	389069	340
0350062PL	149	0506206EG	146	389071	340
0350075PL	149	0506206PL	147	708912	121

Index

Part No.	Page	Part No.	Page	Part No.	Page
1224TI	122	16P	84	3000075PL	102
1226A	121	16P16P	87	3000087EG	102
1226T	122	16P24	46	3000087PL	102
1226TI	122	16P24SM	46	300C3706EG	110
12312P	73	16P4I	84	300C3708EG	110
12316M	72	16P58	46	300C3710EG	110
12316P	73	16P58SM	46	300C3712EG	110
12320M	72	16P912	46	300C3714EG	110
1236M	72	16P912SM	46	300C3716EG	110
123812M	72	16PATA	318	300C3718EG	110
1238P	73	16PATS	318	300C5008EG	110
12D15L	323	16PF	195	300C5010EG	110
12P	84	16PSF	61	300C5012EG	110
12P12P	87	16PZSF	62	300C5014EG	110
12P16P	87	2000037EG	108	300C5016EG	110
12P24	46	2000037PL	108	300C6206EG	110
12P24SM	46	200RS375	109	300C6208EG	110
12P4I	84	200RS500	109	300C6210EG	110
12P58	46	20D15L	323	300C6212EG	110
12P58SM	46	20M	85	300C6214EG	110
12P912	46	20M24	48	300C7506EG	110
12P912SM	46	20M24SM	49	300C7508EG	110
12PATA	318	20M4I	85	300C7510EG	110
12PATS	318	20M58	48	300C7514EG	110
12PF	195	20M58SM	49	300C8706EG	110
12PSF	61	20M912	48	300C8708EG	110
12PZSF	62	20M912SM	49	300C8714EG	110
1450037EG	166	20MCPNAM	66	304B2	198
1450050EG	166	20MF	194	3050037S4	104
1616M	87	20MTDH	65	3050050S4	104
1620M	87	24M	85	3100037EG	103
1624M	87	24M24	48	3100037PL	103
1632M	87	24M24SM	49	3100050EG	103
166M	87	24M4I	85	3100050PL	103
16812M	87	24M58	48	3150037EG	115
16D15L	323	24M58SM	49	3150037PL	115
16M	85	24M912	48	320W0037PL	128
16M24	48	24M912SM	49	320W0050PL	128
16M24SM	49	24MCPNAM	66	320W0062PL	128
16M4I	85	24MTDH	65	320W0075PL	128
16M58	48	2B15LS	324	320W0087PL	128
16M58SM	49	2BR12	264	320W0100PL	128
16M912	48	2BR20	264	3250037EG	125
16M912SM	49	2BR32	264	3250037PL	125
16MATA	317	2BR8	264	3250050EG	125
16MATS	317	2BRT12	263	3250050PL	125
16MB18	95	2BRT20	263	3250062EG	125
16MB1824	93	2BRT32	263	3250062PL	125
16MB1824CO	94	2BRT8	263	3250075EG	125
16MB1858	93	2EBN	151	3250075PL	125
16MB1858CO	94	2FMP28	264	3250087EG	125
16MB186	95	2G9	332	3250087PL	125
16MB186CO	96	2G9S10	332	3270037EG	126
16MB18A	91	2G9S10WB	332	3270037PL	126
16MB18ACO	92	2G9WB	332	3270050EG	126
16MB18CO	96	2H4	119	3270050PL	126
16MB18CPNAM	97	3000037EG	102	3280037EG	126
16MB18TDH	98	3000037PL	102	3280037PL	126
16MCPNAM	66	3000050EG	102	3280050PL	126
16MF	194	3000050PL	102	3290037EG	127
16MSF	59	3000062EG	102	32M	85
16MTDH	65	3000062PL	102	32M24	48
16MZSF	60	3000075EG	102	32M24SM	49

Index

Part No.	Page	Part No.	Page	Part No.	Page
32M4I	85	4H912SS	119	6M3B18ACO	93
32M58	48	4J2438	125	6M3B18CO	96
32M58SM	49	4J2438S	125	6M4I	85
32M912	48	4LCB	324	6M58	48
32M912SM	49	4NJ2438	125	6M58SM	49
35012P	194	4TGS	334	6M912	48
35016M	193	4TI	140	6M912SM	49
35016P	194	4TI24	119	6MATA	317
350812M	193	4TI58	119	6MATS	317
3508P	194	4TI912	119	6MB18	95
3520100PL	133	4TIAFAB3	142	6MB1824	93
3520200PL	133	4TIB	141	6MB1824CO	94
3520300PL	133	4TIBSF	141	6MB1858	93
3600037PL	113	4TIO	142	6MB1858CO	94
3600050PL	113	4TW	152	6MB186	95
3600062PL	113	4WN	334	6MB186CO	96
3600075PL	113	4Z34	145	6MB18A	91
3600087PL	113	4Z3412P	78	6MB18ACO	92
3650037CP	132	4Z3416M	78	6MB18CO	96
3650037EG	132	4Z3416P	78	6MB18CPNAM	97
3650037PL	132	4Z346M	78	6MB18TDH	98
365M0037CP	133	4Z34812M	78	6MCPNAM	66
365M0037EG	133	4Z348P	78	6MF	194
365M0037PL	133	4Z34BP	145	6MSF	59
365M0050CP	133	4Z4S	145	6MTDH	65
365M0050EG	133	510HD	328	6MZSF	60
365M0050PL	133	510HDTC	328	6NJ2438	125
4ACS	314	51220A	326	6T	140
4B15L	323	512A	326	6TA24	119
4B15LS	324	512ATC	326	6TA58	119
4B2LS	324	512HD	326	6TA912	119
4BRT20	263	512HDBP	326	6TAFAB3	142
4BRT20WS	263	512HDBPTC	326	6TB	141
4BRT32	263	512HDEEP	326	6TI	140
4BRT32WS	263	512HDEEPTC	326	6TI24	119
4BRT64	263	512HDFM35	320	6TI58	119
4EBN	151	512HDFM70	320	6TI912	119
4G16	330	512HDTC	326	6TIAFAB3	142
4G161	330	512HDXT	328	6TIB	141
4G1615	330	512TC	325	6TIBSF	141
4G162	330	515A	310	6TIO	142
4G162WH	330	515AWHA	310	6TO	142
4G16H	330	517A	311	6W	152
4G16HWH	330	517B	311	6Z34	145
4G16LN	329	517C	311	6Z3412P	78
4G16LS	329	517FCA	311	6Z3416M	78
4G16WH	330	517FCB	311	6Z3416P	78
4G24	331	517FCC	311	6Z346M	78
4G8	332	52812P	314	6Z34812M	78
4G8S7	332	52816P	314	6Z348P	78
4G8S7WH	332	5288P	314	6Z34VF14	99
4G8WB	332	6A	136	6Z4S	145
4G8WH	332	6A24	120	708AB	139
4G8WHWB	332	6A58	120	708AFAB3	140
4G9	331	6A912	120	708AO	140
4G9LS	331	6AB	137	708SF	139
4H1318	119	6AFAB3	138	766A	183
4H24	119	6AO	137	766PM	183
4H2477036	319	6ASF	136	766PMD	183
4H24SS	119	6EBN	151	812M	85
4H58	119	6M	85	812M1318	48
4H58SS	119	6M24	48	812M24	48
4H912	119	6M24SM	49	812M24SM	49

Index

Part No.	Page	Part No.	Page	Part No.	Page
812M4I	85	A14H2000PG	369	A1SF1G	168
812M58	48	A1B1624	176	A1SF1GBUSP250	168
812M58SM	49	A1B1624SP250	176	A1SF1GS	168
812M6MB18CO	96	A1BD0N	174	A1SF1GSBUSP250	168
812M912	48	A1BF0G	174	A1SF1GSP250	168
812M912SM	49	A1BF0G40N	175	A1SF2G	168
812MATA	317	A1BF0G40NAO	175	A1SF2GS	168
812MATS	317	A1BF0GD0N	175	A1SF3G	168
812MB18	95	A1BF0GD0NS	175	A1SF4G	168
812MB1824	93	A1BF0GD0NTC	175	A1SFV1G	169
812MB1824CO	94	A1BF0GS	174	A1SFV1GS	169
812MB1858	93	A1BF0GTC	174	A1SFV2G	169
812MB1858CO	94	A1BF1G	171	A1SFV2GS	169
812MB186	95	A1BF1G41N	172	A3308AP100	154
812MB186CO	96	A1BF1G41NAO	172	AB	144
812MB188Z	95	A1BF1G51N	172	AB375	144
812MB18A	91	A1BF1GD1N	172	ABSF	143
812MB18ACO	92	A1BF1GD1NS	172	ABTSF	143
812MB18CO	96	A1BF1GF1N	172	ADK421	373
812MB18CPNAM	97	A1BF1GS	171	ADK421GN	373
812MB18S	91	A1BF2G	171	ADK421GY	373
812MB18SCO	92	A1BF2G41N	172	ADK421RD	373
812MB18TDH	98	A1BF2G41NAO	172	AF14	116
812MCPNAM	66	A1BF2G51N	172	AF144TI	123
812MF	194	A1BF2GD1N	172	AF146A	122
812MSF	59	A1BF2GD1NS	172	AF146T	123
812MTDH	65	A1BF2GS	171	AF146TI	123
812MZSF	60	A1BF3G	171	AF14708	123
8D15L	323	A1BF3G43N	172	AFAB3	144
8P	84	A1BF3G43NAO	172	AFAB4	144
8P12P	87	A1BF3G53N	172	AFAB6	144
8P16P	87	A1BF3GF3N	172	AMR1024DG	179
8P24	46	A1BF4G	171	AMR1224SG	179
8P24SM	46	A1BFV1G	173	AO	145
8P4I	84	A1BFV1GDV1N	173	AOL12P	68
8P58	46	A1BFV1GDV1NS	173	AOL16P	68
8P58SM	46	A1BFV1GS	173	AOL812M	67
8P8P	87	A1F1218	178	AOL8P	68
8P912	46	A1FF0G	178	AR812	203
8P912SM	46	A1FF0GS	178	ATA4I	315
8PATA	318	A1FF0GTC	178	ATS4I	315
8PATS	318	A1FF1G	177	B18SBT18	92
8PF	195	A1FF1GS	177	B18SBT184Z	95
8PSF	61	A1FF2G	177	B18SBT18CPNAM	98
8PZSF	62	A1FF2GS	177	B18SBT18TDH	99
8Z34	145	A1FF3G	177	BC	105
8Z34812M	78	A1FF4G	177	BC090900EG	113
8Z4S	145	A1FFV1G	176	BC091200EG	113
A12AH200GN	370	A1FFV2G	176	BC091500EG	113
A12AH200PG	370	A1SD0G	170	BC100000EG	106
A12H0200HD	369	A1SD0N	170	BC101500EG	106
A12H0400HD	369	A1SD0NS	170	BC110000EG	107
A12H0500HD	369	A1SD0NTC	170	BC120000EG	107
A12H0600HD	369	A1SD1N	168	BC12P	47
A12H1000GN	369	A1SD1NS	168	BC12PSM	47
A12H1000HD	369	A1SF0G	170	BC130025EG	107
A12H1000PG	369	A1SF0GBUSP250	170	BC130037EG	107
A12H1000S4	369	A1SF0GS	170	BC130050EG	107
A12H2000GN	369	A1SF0GSBUSP250	170	BC130062EG	107
A12H2000PG	369	A1SF0GSP250	170	BC140037EG	108
A14H1000GN	369	A1SF0GTC	170	BC140050EG	108
A14H1000PG	369	A1SF0N	170	BC140062EG	108
A14H2000GN	369	A1SF0NS	170	BC16A000EG	386

Index

Part No.	Page	Part No.	Page	Part No.	Page
BC16M	51	CAT1224SM	251	CAT21HP912	221
BC16MSM	51	CAT124Z34	253	CAT21HP912SM	220
BC16P	47	CAT1258	251	CAT21HPAB	229
BC16PSM	47	CAT1258SM	251	CAT21HPAF14	224
BC17A000EG	385	CAT126Z34	253	CAT21HPAFAB3	230
BC17D000EG	385	CAT128Z34	253	CAT21HPAFAB4	230
BC180037EG	387	CAT12912	251	CAT21HPAFAB6	230
BC180050EG	387	CAT12912SM	251	CAT21HPBA	212
BC200	105	CAT12AB	255	CAT21HPBC	217
BC200000EG	386	CAT12AF14	252	CAT21HPBC200	214
BC200CD0B	44	CAT12AFAB3	255	CAT21HPBC200B	215
BC200CD1B	44	CAT12BC	249	CAT21HPBC26	219
BC200CD2.5B	44	CAT12BC200	250	CAT21HPBCB	218
BC200CD2B	44	CAT12BC200B	250	CAT21HPBU	213
BC200CD3B	44	CAT12BCB	250	CAT21HPCD1B	231
BC200CD4B	44	CAT12CD1B	252	CAT21HPD1BC2	216
BC200CD5B	44	CAT12SF	254	CAT21HPD1M24	222
BC20M	51	CAT12TS	253	CAT21HPESC	232
BC20MSM	51	CAT12VF14	252	CAT21HPGR	213
BC210000EG	388	CAT16HP	212	CAT21HPOR	213
BC23A000EG	388	CAT16HP123	225	CAT21HPRD	213
BC24M	51	CAT16HP24	221	CAT21HPSF	227
BC24MSM	51	CAT16HP24SM	220	CAT21HPVF14	223
BC260025EG	103	CAT16HP4Z34	226	CAT21HPWH	213
BC32M	51	CAT16HP58	221	CAT21HPWH4Z34	226
BC32MSM	51	CAT16HP58SM	220	CAT21HPYL	213
BC400	105	CAT16HP6Z34	226	CAT300CM	257
BC812M	51	CAT16HP8Z34	226	CAT300CMLN	256
BC812MSM	51	CAT16HP912	221	CAT3224	251
BC8P	47	CAT16HP912SM	220	CAT32HP	212
BC8PSM	47	CAT16HPAB	229	CAT32HP123	225
BCBP	105	CAT16HPAF14	224	CAT32HP24	221
BHC	327	CAT16HPAFAB3	230	CAT32HP24SM	220
C12H1000GN	370	CAT16HPBA	212	CAT32HP4Z34	226
C12H1000PG	370	CAT16HPBC	217	CAT32HP58	221
C12H2000GN	370	CAT16HPBC200	214	CAT32HP58SM	220
C12H2000PG	370	CAT16HPBC200B	215	CAT32HP6Z34	226
C14H1000GN	370	CAT16HPBC26	219	CAT32HP8Z34	226
C14H1000PG	370	CAT16HPBCB	218	CAT32HP912	221
C14H1000S4	370	CAT16HPBU	213	CAT32HP912SM	220
C14H2000GN	370	CAT16HPCD1B	231	CAT32HPAB	229
C14H2000PG	370	CAT16HPESC	232	CAT32HPAF14	224
C23	187	CAT16HPGR	213	CAT32HPAFAB3	230
C2416SM	50	CAT16HPOR	213	CAT32HPAFAB4	230
C24812SM	50	CAT16HPRD	213	CAT32HPAFAB6	230
C4	187	CAT16HPSF	227	CAT32HPBA	212
C4TI24	120	CAT16HPTS	233	CAT32HPBA4Z34	226
C4TI58	120	CAT16HPVF14	223	CAT32HPBC	217
C4TI912	120	CAT16HPWH	213	CAT32HPBC200	214
C5816SM	50	CAT16HPYL	213	CAT32HPBC200B	215
C58812SM	50	CAT200CM	257	CAT32HPBC26	219
C6	187	CAT200CMLN	256	CAT32HPBCB	218
C6TI24	120	CAT21AB	255	CAT32HPBU	213
C6TI58	120	CAT21BC	249	CAT32HPCD1B	231
C6TI912	120	CAT21HP	212	CAT32HPD1BC2	216
C91216SM	50	CAT21HP123	225	CAT32HPD1M24	222
C912812SM	50	CAT21HP24	221	CAT32HPDCM2	234
CA0025EG	159	CAT21HP24SM	220	CAT32HPDCM3	234
CA0037EG	159	CAT21HP4Z34	226	CAT32HPDCM4	234
CA0050EG	159	CAT21HP58	221	CAT32HPDFM2	235
CAT100CM	257	CAT21HP58SM	220	CAT32HPDFM3	235
CAT12	249	CAT21HP6Z34	226	CAT32HPDFM4	235
CAT1224	251	CAT21HP8Z34	226	CAT32HPESC	232

Index



Part No.	Page	Part No.	Page	Part No.	Page
CAT32HPGR	213	CAT600WM	271	CATHP912SM	239
CAT32HPOR	213	CAT64HP	212	CATHPA4	246
CAT32HPRD	213	CAT64HP123	225	CATHPA6	246
CAT32HPSCM2	234	CAT64HP24	221	CATHPABSF	245
CAT32HPSCM3	234	CAT64HP24SM	220	CATHPAF14	241
CAT32HPSCM4	234	CAT64HP4Z34	226	CATHPAN	246
CAT32HPSF	227	CAT64HP58	221	CATHPBC	238
CAT32HPSFM2	235	CAT64HP58SM	220	CATHPBC200	237
CAT32HPSFM3	235	CAT64HP6Z34	226	CATHPBC200B	237
CAT32HPSFM4	235	CAT64HP8Z34	226	CATHPBC26	239
CAT32HPSWM2	236	CAT64HP912	221	CATHPBCB	238
CAT32HPSWM3	236	CAT64HP912SM	220	CATHPCD0B	244
CAT32HPSWM4	236	CAT64HPAB	229	CATHPCD1B	244
CAT32HPVF14	223	CAT64HPAF14	224	CATHPCD2.5B	244
CAT32HPWH	213	CAT64HPAFAB3	230	CATHPCD2B	244
CAT32HPWH4Z34	226	CAT64HPAFAB4	230	CATHPCD3B	244
CAT32HPYL	213	CAT64HPAFAB6	230	CATHPESC	243
CAT425	259	CAT64HPBA	212	CATHPLLR	247
CAT42524SM	261	CAT64HPBC	217	CATHPS4	246
CAT42558SM	261	CAT64HPBC200	214	CATHPTM	247
CAT425912SM	261	CAT64HPBC200B	215	CATHPVF14	241
CAT425A6	259	CAT64HPBC26	219	CATMTH	269
CAT425AF14	262	CAT64HPBCB	218	CATMTLS	269
CAT425BC	260	CAT64HPBU	213	CATMTP	269
CAT425BC200	261	CAT64HPCD1B	231	CATRL200CM	258
CAT425VF14	262	CAT64HPD1BC2	216	CATRL300CM	258
CAT425WM	260	CAT64HPD1M24	222	CATRT200CM	258
CAT425WMD1B	263	CAT64HPDCM2	234	CATRT300CM	258
CAT48HP	212	CAT64HPDCM3	234	CATTBCM	258
CAT48HP123	225	CAT64HPDCM4	234	CATTS	254
CAT48HP24	221	CAT64HPDFM2	235	CATWMCM	259
CAT48HP24SM	220	CAT64HPDFM3	235	CCS812	201
CAT48HP4Z34	226	CAT64HPDFM4	235	CD0B	86
CAT48HP58	221	CAT64HPGR	213	CD0B37	86
CAT48HP58SM	220	CAT64HPOR	213	CD0BBP	86
CAT48HP6Z34	226	CAT64HPRD	213	CD0BCPNAM	67
CAT48HP8Z34	226	CAT64HPSCM2	234	CD0BSF	63
CAT48HP912	221	CAT64HPSCM3	234	CD0BSS	86
CAT48HP912SM	220	CAT64HPSCM4	234	CD0BTDH	65
CAT48HPAB	229	CAT64HPSF	227	CD0BZSF	64
CAT48HPAF14	224	CAT64HPSFM2	235	CD1B	86
CAT48HPAFAB3	230	CAT64HPSFM3	235	CD1B37	86
CAT48HPAFAB4	230	CAT64HPSFM4	235	CD1BCPNAM	67
CAT48HPAFAB6	230	CAT64HPSWM2	236	CD1BSF	63
CAT48HPBA	212	CAT64HPSWM3	236	CD1BSS	86
CAT48HPBC	217	CAT64HPSWM4	236	CD1BTDH	65
CAT48HPBC200	214	CAT64HPVF14	223	CD1BZSF	64
CAT48HPBC200B	215	CAT64HPWH	213	CD2.5B	86
CAT48HPBC26	219	CAT64HPYL	213	CD2.5B37	86
CAT48HPBCB	218	CATCR50	268	CD2.5BCPNAM	67
CAT48HPBU	213	CATHBA	248	CD2.5BSS	86
CAT48HPCD1B	231	CATHBA3	248	CD2.5BTDH	65
CAT48HPD1BC2	216	CATHBA6	248	CD2B	86
CAT48HPD1M24	222	CATHBA8	248	CD2B37	86
CAT48HPGR	213	CATHP123	242	CD2BCPNAM	67
CAT48HPOR	213	CATHP24	240	CD2BSF	63
CAT48HPRD	213	CATHP24SM	239	CD2BSS	86
CAT48HPSF	227	CATHP4Z34	242	CD2BTDH	65
CAT48HPVF14	223	CATHP58	240	CD2BZSF	64
CAT48HPWH	213	CATHP58SM	239	CD3B	86
CAT48HPYL	213	CATHP6Z34	242	CD3B37	86
CAT600R	271	CATHP8Z34	242	CD3BSS	86
CAT600RKIT	270	CATHP912	240	CD4B	86

Index

Part No.	Page	Part No.	Page	Part No.	Page
CD4B37.....	86	CRLP237L50.....	280	CSBCAS040050EG..	159
CD4BSS.....	86	CRLP250L14.....	280	CSBCAS040062EG..	159
CD5B.....	86	CRLP250L18.....	280	CSBCAS050050EG..	159
CD5B37.....	86	CRLP250L22.....	280	CSBCAS050062EG..	159
CD5BSS.....	86	CRLP250L26.....	280	CSBCAS050075EG..	159
CD6B.....	86	CRLP250L38.....	280	CSBCASDB060037..	161
CD6BSS.....	86	CRLP250L50.....	280	CSBCASDB060050..	161
CD7B.....	86	CRLS37EG.....	282	CSBCASDB080062..	161
CD7BSS.....	86	CRLSL37EG.....	282	CSBCASDB080075..	161
CD8B.....	86	CRLW37EG.....	276	CSBCASDB100050..	161
CD8BSS.....	86	CRLW50EG.....	276	CSBCASDB120062..	161
CD9B.....	86	CS16.....	191	CSBCS0100.....	411
CD9BSS.....	86	CS812.....	191	CSBCS0125.....	411
CER4.....	189	CS812D.....	191	CSBCS0150.....	411
CFEB05.....	307	CSB12CBL.....	396	CSBCS0200.....	411
CG4.....	196	CSB12CBLSS.....	396	CSBCS0250.....	411
CHB.....	327	CSB12SBHS.....	397	CSBCS0300.....	411
CHBTC.....	327	CSB12SLVB.....	397	CSBCS0350.....	411
CJ6.....	190	CSB12SLVBSS.....	397	CSBCS0400.....	411
CJ6IN.....	190	CSB18CBL.....	396	CSBCS0500.....	411
CJ6S.....	190	CSB18CBLSS.....	396	CSBCS0600.....	411
CL100000EG.....	374	CSB18SLVB.....	397	CSBCS0800.....	411
CL100000PS.....	374	CSB18SLVBSS.....	397	CSBCS1000.....	411
CM2416M.....	50	CSB2W12URC12L10	400	CSBCS1200.....	411
CM24812M.....	50	CSB2W12URC12L20	400	CSBHN50EG.....	412
CM24S.....	118	CSB2W12URC38L10	400	CSBLN50EG.....	412
CM5816M.....	50	CSB2W12URC38L20	400	CSBMA050050EG..	405
CM58812M.....	50	CSB2W18URC12L10	400	CSBMA050050EG..	405
CM58S.....	118	CSB2W18URC12L20	400	CSBMA050050EG..	405
CM91216M.....	50	CSB2W18URC38L10	400	CSBMA050075EG..	405
CM912812M.....	50	CSB2W18URC38L20	400	CSBMA050075EG..	405
CM912S.....	118	CSB2W36URC12L10	400	CSBMA050075EG..	405
CNB12P.....	69	CSB2W36URC12L20	400	CSBNPC12.....	398
CNB812M.....	68	CSB2W36URC58L10	400	CSBNPC34.....	398
CNB8P.....	69	CSB2W36URC58L20	400	CSBNPC38.....	398
CONB122000PG....	372	CSB2W48URC12L10	400	CSBNPC58.....	398
CPNAM.....	132	CSB2W48URC12L20	400	CSBR1.....	410
CPR25.....	205	CSB2W48URC58L10	400	CSBR1.....	410
CRLA37EG.....	275	CSB2W48URC58L20	400	CSBR2.....	409
CRLB37EG.....	274	CSB3346SB.....	397	CSBR2.....	409
CRLB50EG.....	274	CSB36CBL.....	396	CSBRS1.....	401
CRLC37EG.....	277	CSB36CBLSS.....	396	CSBRS2.....	401
CRLC37L1.....	278	CSB36SLVB.....	397	CSBRS3.....	401
CRLJ37EG.....	275	CSB36SLVBSS.....	397	CSBRS37EG.....	401
CRLJ37EG.....	277	CSB48.....	397	CSBRS4.....	401
CRLM37EG.....	276	CSB48CBL.....	396	CSBRS5.....	401
CRLM50EG.....	276	CSB48CBLSS.....	396	CSBRS6.....	401
CRLN37EG.....	283	CSB48SLVB.....	397	CSBS1.....	402
CRLP137L14.....	280	CSB48SLVBSS.....	397	CSBS1A.....	403
CRLP137L18.....	280	CSBBS121836.....	398	CSBS1A.....	403
CRLP137L22.....	280	CSBC48.....	396	CSBS1A.....	403
CRLP137L26.....	280	CSBCAB030037EG..	158	CSBS2.....	402
CRLP137L38.....	280	CSBCAB037550EG..	158	CSBS3.....	404
CRLP150L14.....	280	CSBCAB045050EG..	158	CSBS3.....	404
CRLP150L18.....	280	CSBCAB047562EG..	158	CSBS4.....	404
CRLP150L22.....	280	CSBCAB055050EG..	158	CSBS4.....	404
CRLP150L26.....	280	CSBCAB055075EG..	158	CSBS5.....	404
CRLP150L38.....	280	CSBCAB060062EG..	158	CSBS5.....	404
CRLP237L14.....	280	CSBCAB062575EG..	158	CSBSB50EG.....	412
CRLP237L18.....	280	CSBCAB070075EG..	158	CSBSBR50EG.....	412
CRLP237L22.....	280	CSBCAB085075EG..	158	CSBSH00375EG...	410
CRLP237L26.....	280	CSBCAS025037EG..	159	CSBSH00500EG...	410
CRLP237L38.....	280	CSBCAS030050EG..	159	CSBSH00625EG...	410



Index



Part No.	Page	Part No.	Page	Part No.	Page
CSBSH00750EG	410	DR4TSF12	135	FXC20	191
CSBSN37EG	412	DR4TSF24	135	H23	187
CSBU1	406	DR4TSF36	135	H4	187
CSBU1PA	408	DR4TSF40	135	H6	187
CSBU2	406	DR4TSF48	135	HFRMHDW	350
CSBU2PA	408	DR4TSF60	135	HMZE215	164
CSBUB62EG	412	DR4TSF72	135	HMZE220	165
CSBURC1	399	DSI2A	199	HMZE240	165
CSBURC12	399	E12H1000PG	371	HMZE340	165
CSBURC12SS	399	E12H2000GN	371	HMZE350	166
CSBURC14	399	E12H2000PG	371	HMZE380	166
CSBURC14SS	399	EC311	320	HMZG160	161
CSBURC1SS	399	EC3114Z34	321	HMZG315	163
CSBURC34	399	EC3116Z34	321	HMZG365	164
CSBURC34SS	399	EC311P	321	HMZG470	161
CSBURC38	399	ENDCA120EG	373	HMZG471	162
CSBURC38SS	399	EPS0050EG	88	HMZG650	163
CSBURC4812	399	EPS0075EG	88	HMZG730	164
CSBURC4812SS	399	EPS0100EG	88	HMZH455	162
CSBURC4834	399	EPS0125EG	88	HMZH475	162
CSBURC4834SS	399	EPS0150EG	88	HMZH476	163
CSBURC4858	399	EPS0200EG	88	HMZH665	164
CSBURC4858SS	399	ESC12P	81	HSCR3707EG	155
CSBURC4878SS	399	ESC4	392	HSCR3710EG	155
CSBURC58	399	ESC4TI	393	HSCR3712EG	155
CSBURC58SS	399	ESC6M	81	HSCR3715EG	155
CSBURC78	399	ESC6TI	393	HSCR3720EG	155
CSBURC78SS	399	ESC812M	81	HSCR5010EG	155
CSBURCR12	400	ESG1	204	HSCR5012EG	155
CSBURCR38	400	ESG1M	204	HSCR5015EG	155
CSBURCR58	400	ESGFP	204	HSCR5020EG	155
CSBUS1	407	ESGP	204	IDS	322
CSBUS1	407	ET0050HD	45	IDS15	322
CSBUS1PA	408	ET0075HD	45	IDS2	322
CSBUS2	407	ET0100HD	45	IDS9	322
CSBUS2	407	ET0125HD	45	IDS915	322
CSBUS2PA	408	ET0150HD	45	IDS95	322
D12H1000GN	371	ET0200HD	45	IDS95LN	322
D12H1000PG	371	ET0250HD	45	IDS95T	322
D12H2000GN	371	ET0300HD	45	IDS95TWB	322
D12H2000PG	371	F090000EG	379	IDS9LN	322
DB12SFCAT32HP	228	F130000EG	379	IDS9T	322
DB15SFCAT64HP	228	F140000EG	379	IDS9TWB	322
DB18SFCAT32HP	228	F150000EG	379	IDSLN	322
DB21SFCAT64HP	228	F160000EG	379	IDST	322
DB24SFCAT32HP	228	F170000EG	379	IDSTWB	322
DB27SFCAT64HP	228	F180000EG	379	INC8T5	388
DB30SFCAT32HP	228	F200000EG	380	ISSP375	390
DB33SFCAT64HP	228	F220000EG	379	ISSPK	391
DB36SFCAT32HP	228	F230000EG	380	J1A35	182
DB39SFCAT64HP	228	F250000EG	381	K12	77
DB48SFCAT32HP	228	F360000EG	380	K16	77
DB51SFCAT64HP	228	F370000EG	381	K20	77
DH2	131	FB12P	206	K8	77
DH4TI	131	FB6M	206	KA25H0150EG	378
DH6TI	131	FB812M	206	KA25H0300EG	378
DR4SF12	134	FB8P	206	KA25H0450EG	378
DR4SF24	134	FBS12	197	KA25H0600EG	378
DR4SF36	134	FBS16	197	KBT	99
DR4SF40	134	FBS18	197	KX	77
DR4SF48	134	FMBS18	198	L100000EG	381
DR4SF60	134	FMBS1824	197	L110000EG	381
DR4SF72	134	FMSBC1	328	L110000S4	381

Index

Part No.	Page	Part No.	Page	Part No.	Page
L120300EG	382	MCS101VF14	74	PAR0350HD	45
L180000EG	383	MCS50	89	PAR0400HD	45
L190000EG	383	MCS5024	54	PBU10	361
L200000EG	383	MCS504Z	79	PBU16	361
L220000EG	383	MCS5058	54	PBU6	361
L23U0000EG	384	MCS506Z	79	PCB36	358
L441200EG	384	MCS50912	54	PCB36H20	358
L441600EG	384	MCS50AF14	75	PCB36H30	358
L460450EG	382	MCS50B18	97	PCB36H40	358
L470450EG	382	MCS50B18A	94	PCB36H50	358
LA0025EG	160	MCS50BC	55	PCB36H60	358
LA0037EG	160	MCS50BC200	55	PCGK	359
LA0050EG	160	MCS50VF14	74	PCL50S2	355
LCSB12	325	MEB1	186	PCL50S3	355
LFC	312	MF250	189	PCL50S4	355
LFC90	312	MF375	189	PCL50S5	355
LTGH	324	MF500	189	PCL50S6	355
M1318	117	MF625	189	PCL90S2	356
M1318S	118	MF750	189	PCL90S3	356
M24	117	MFA4I	378	PCL90S4	356
M24S	118	MFA625	378	PCL90S5	356
M58	117	MFI	195	PCL90S6	356
M58S	118	MFO	189	PCP36	359
M912	117	MFS	188	PCS1	76
M912S	118	MP1	267	PCS2	76
MAC2	192	MP1P	267	PCT20	357
MAC2123	74	MP1S	266	PCT30	357
MAC21318	53	MP1SCB	265	PCT40	357
MAC224	53	MP2	267	PCT50	357
MAC224SM	53	MP2S	266	PCT60	357
MAC24Z34	79	MP2SCB	265	PEB	354
MAC258	53	MP34P	267	PEC	355
MAC258SM	53	MPAL2	267	PEH31	354
MAC26Z34	79	MPCB1220	265	PEK4B	351
MAC2912	53	MPLS	266	PEK6B	352
MAC2912SM	53	MPLS2	266	PEKEF	353
MAC2ATA	316	MPVTI	268	PH4	114
MAC2BC	54	MSF	188	PH6	114
MAC2SF	70	MSP20	205	PH6FP	114
MAC2T	192	NUT0025EG	375	PHB	349
MAC2VF14	73	NUT0025xx	375	PHBR	349
MCS100	89	NUT0025xx	375	PHK	350
MCS10024	54	NUT0025xx	375	PHKR	350
MCS1004Z	79	NUT0025xx	375	PHSW4	114
MCS10058	54	NUT0025xx	375	PHSW6	114
MCS1006Z	79	NUT0037EG	375	PHSW6FP	114
MCS1008Z	79	NUT0037S6	375	PKM10H3	270
MCS100912	54	NUT0050EG	375	PKM10H6	270
MCS100AF14	75	NUT0050HD	375	PKM16H3	270
MCS100B18	97	NUT0050S6	375	PKM16H6	270
MCS100BC	55	NUT0062EG	375	PPRPS25H4	364
MCS100BC200	55	NUT0075EG	375	PPRPS25H6	364
MCS100SF	70	P110000EG	389	PRA3H12	348
MCS100VF14	74	P11SQ000EG	389	PRA6H16	348
MCS101	89	P130000EG	389	PRF2	347
MCS10124	54	PAR0050HD	45	PRF3	347
MCS1014Z	79	PAR0075HD	45	PRF6	347
MCS10158	54	PAR0100HD	45	PRS2	348
MCS1016Z	79	PAR0125HD	45	PRS3	348
MCS101912	54	PAR0150HD	45	PRS6	348
MCS101AF14	75	PAR0200HD	45	PSA10CH13	345
MCS101BC	55	PAR0250HD	45	PSA16AH18	345
MCS101BC200	55	PAR0300HD	45	PSB24A	346

Index

Part No.	Page	Part No.	Page	Part No.	Page
PSB30A	346	RIGD0400EG	336	SC2G	52
PSB36A	346	RIGD0400S4	336	SC4A	52
PSB42A	346	RIGD0600S4	336	SC4B	52
PSB48A	346	RLC	196	SC4C	52
PSB60A	346	RMX	89	SC4D	52
PSF10C	344	RMX24	56	SC4E	52
PSF10D	344	RMX4Z34	80	SC4F	52
PSF16C	344	RMX58	56	SC4G	52
PSF16D	344	RMX6Z34	80	SC8A	52
PSF6C	344	RMX912	56	SC8B	52
PT16	333	RMXAB	71	SC8C	52
PT16FP	333	RMXAF14	76	SC8D	52
PT16LN	333	RMXAO	90	SC8E	52
PT16SPCR	334	RMXATS	316	SC8F	52
PTF10	362	RMXBC	56	SC8G	52
PTF10	362	RMXDH2	72	SCH12	82
PTF10P	363	RMXSF	71	SCH12B	82
PTF16	362	RMXVF14	75	SCH16	82
PTF16	362	ROL10000EG	391	SCH16B	82
PTF16P	363	ROL11000EG	392	SCH20	82
PTF1C	363	RPS50AHGP	100	SCH20B	82
PTF2C	363	RPS50H4EG	360	SCH24B	82
PTF6	362	RPS50H4HD	360	SCH32B	82
PTF6	362	RPS50H6EG	360	SCH40B	82
PTF6P	363	RPS50H6HD	360	SCH48B	82
PTFP	364	RPSE1H	361	SCH56B	82
RA0037HD	44	RPSE1H24	360	SCH64B	82
RA0050HD	44	RPSE1H57	360	SCH6B	82
RA0075HD	44	RPSE2H46	360	SCH72B	82
RA0100HD	44	RPSE4H46	360	SCH8	82
RA0125HD	44	RS06	111	SCH8B	82
RA0150HD	44	RS08	111	SCMKC	272
RA0200HD	44	RS10	111	SCSOL1A	52
RA0250HD	44	RS12	111	SFCLT	313
RA0300HD	44	RS14	111	SFCLTCF	313
RA0350HD	44	RS16	111	SFCLTCFS	313
RA0400HD	44	RS18	111	SFCLTE	313
RAWL3758	160	S102438BP50	327	SFCLTS	313
RBS16	184	S31199P100	154	SGB16A	200
RBS24	184	S3575BP100	154	SGB24A	200
RET16B50	248	S3575BP50	154	SGFIX0380100EG	203
RET21B50	248	S3575DP100	154	SK125I	83
RET32B50	248	SAA1400EG	393	SK12ALA	83
RET48B25	248	SAD1400EG	393	SK165I	83
RET64B25	248	SBC037	104	SK16ALA	83
RGC	269	SBT18	91	SK205I	83
RIGD0050EG	336	SBT1824	58	SK20ALA	83
RIGD0050S4	336	SBT1824SM	57	SK245I	83
RIGD0075EG	336	SBT184Z34	80	SK24ALA	83
RIGD0075S4	336	SBT1858	58	SK325I	83
RIGD0100EG	336	SBT1858SM	57	SK32ALA	83
RIGD0100S4	336	SBT186Z34	80	SK405I	83
RIGD0125EG	336	SBT18912	58	SK485I	83
RIGD0125S4	336	SBT18912SM	57	SK565I	83
RIGD0150EG	336	SBT18BC	57	SK645I	83
RIGD0150S4	336	SBT18BC200	58	SK85I	83
RIGD0200EG	336	SBT18TDH	66	SK8ALA	83
RIGD0200S4	336	SC2A	52	SL1214	308
RIGD0250EG	336	SC2B	52	SL1518	308
RIGD0250S4	336	SC2C	52	SLAFAB3	308
RIGD0300EG	336	SC2D	52	SLC15L1000SP	306
RIGD0300S4	336	SC2E	52	SLC15L50MSP	306
RIGD0350EG	336	SC2F	52	SLC2L1000SP	306

Index

Part No.	Page	Part No.	Page	Part No.	Page
SLC3L1000SP	306	SLK15L500PACK	304	SLK2Y300L5	296
SLD15L10S	302	SLK15L50MPACK	304	SLK2Y300L7	296
SLD15L2S	302	SLK15L5AB	286	SLK2Y500L3	296
SLD15L5S	302	SLK15L5DH	288	SLK2YH500L2	295
SLD15QT250	304	SLK15L5LP	291	SLK2YH500L2R2	295
SLD15Y200	303	SLK15L5LPR2	291	SLK2YH500L3	295
SLD15Y300	303	SLK15L5R2	290	SLK2YH500L3R2	295
SLD15Y500	303	SLK15L5SE250	292	SLK2YH500L7	295
SLD15Y500R2	303	SLK15L5SF	287	SLK3C200	305
SLD15Y800	303	SLK15L5T	294	SLK3C50	305
SLD15Y800R2	303	SLK15L5WA6	293	SLK3L1	290
SLD2Y300	303	SLK15L7	290	SLK3L10	290
SLD2Y300L050H	303	SLK15L7LP	291	SLK3L10AB	286
SLD2Y500	303	SLK15L7T	294	SLK3L10LP	291
SLD2YH500	302	SLK15L7WA6	293	SLK3L10SE375	292
SLD2YH800	302	SLK15Y300L3	296	SLK3L10WA6	293
SLD3YH500	302	SLK15Y300L3R2	296	SLK3L1AB	286
SLD3YH800	302	SLK15Y300L5	296	SLK3L1LP	291
SLEB250	307	SLK15Y500L3	296	SLK3L1SE375	292
SLEB375	307	SLK15Y500L3R2	296	SLK3L1WA6	293
SLEBWS	307	SLK2C200	305	SLK3L2	290
SLICK250	374	SLK2C50	305	SLK3L2AB	286
SLICK375	374	SLK2L1	290	SLK3L2LP	291
SLICK500	374	SLK2L10	290	SLK3L2SE375	292
SLJR200	306	SLK2L100PACK	304	SLK3L2WA6	293
SLK15L1	290	SLK2L10LP	291	SLK3L3	290
SLK15L10	290	SLK2L10R2	290	SLK3L3AB	286
SLK15L10LP	291	SLK2L10WA6	293	SLK3L3LP	291
SLK15L10T	294	SLK2L11LP	291	SLK3L3R2	290
SLK15L10WA6	293	SLK2L1WA6	293	SLK3L3SE375	292
SLK15L1AB	286	SLK2L2	290	SLK3L3WA6	293
SLK15L1DH	288	SLK2L2AB	286	SLK3L5	290
SLK15L1LP	291	SLK2L2LP	291	SLK3L5AB	286
SLK15L1LPR2	291	SLK2L2R2	290	SLK3L5LP	291
SLK15L1SF	287	SLK2L2SE250	292	SLK3L5R2	290
SLK15L1T	294	SLK2L2SF	287	SLK3L5SE375	292
SLK15L1TR2	294	SLK2L2WA6	293	SLK3L5WA6	293
SLK15L1WA6	293	SLK2L3	290	SLK3L7	290
SLK15L2	290	SLK2L34H24	289	SLK3L7AB	286
SLK15L2AB	286	SLK2L34H58	289	SLK3L7LP	291
SLK15L2DH	288	SLK2L3AB	286	SLK3L7WA6	293
SLK15L2LP	291	SLK2L3DH	288	SLLC250	307
SLK15L2LPR2	291	SLK2L3LP	291	SLS2C50	305
SLK15L2R2	290	SLK2L3R2	290	SLS2L1	298
SLK15L2SE250	292	SLK2L3SE250	292	SLS2L10	298
SLK15L2SF	287	SLK2L3SF	287	SLS2L2	298
SLK15L2T	294	SLK2L3WA6	293	SLS2L2SE250	299
SLK15L2TR2	294	SLK2L5	290	SLS2L3	298
SLK15L2WA6	293	SLK2L5AB	286	SLS2L3DH	297
SLK15L3	290	SLK2L5DH	288	SLS2L3SE250	299
SLK15L34H24	289	SLK2L5LP	291	SLS2L3WA6	300
SLK15L34H58	289	SLK2L5R2	290	SLS2L5	298
SLK15L3AB	286	SLK2L5SE250	292	SLS2L5DH	297
SLK15L3DH	288	SLK2L5SF	287	SLS2L5SE250	299
SLK15L3LP	291	SLK2L5WA6	293	SLS2L5WA6	300
SLK15L3LPR2	291	SLK2L7	290	SLS2L7	298
SLK15L3R2	290	SLK2L7DH	288	SLS2L7DH	297
SLK15L3SE250	292	SLK2L7LP	291	SLS2L7WA6	300
SLK15L3SF	287	SLK2L7WA6	293	SLS3C50	305
SLK15L3T	294	SLK2Y300L10	296	SLS3L1	298
SLK15L3TR2	294	SLK2Y300L2	296	SLS3L10	298
SLK15L3WA6	293	SLK2Y300L3	296	SLS3L2	298
SLK15L5	290	SLK2Y300L3R2	296	SLS3L3	298

Index

Part No.	Page	Part No.	Page	Part No.	Page
SLS3L5	298	TSNT0025EG	377	USC076EG	337
SLS3L7	298	TSNT0025EG	377	USC080EG	337
SLWC	306	TSNT0037EG	377	USC086EG	337
SMS8	202	TSNT0037EG	377	USC086HD	338
SN25	283	TSNT0050EG	377	USC093EG	337
SN37	283	TSNT0050EG	377	USC101EG	337
SN50	283	TSR1220	366	USC101HD	338
SNSW37	284	TSR122025	366	USC107EG	337
SNSW50	284	TSR122038RL	281	USC113EG	337
SPRA0025EG	376	TSR1220N	367	USC113HD	338
SPRA0025EG	376	TSR1220R	368	USC121EG	337
SPRA0025EG	377	TSR1220SLS3	301	USC129EG	338
SPRA0037EG	376	TSRBS1625	185	USC135EG	338
SPRA0037EG	376	U10A0000HD	392	USC143EG	338
SPRA0037EG	376	U24A0000EG	390	USC143HD	338
SPRA0050EG	376	UPCJ	244	USC152EG	338
SPRA0050EG	376	USC006EG	337	USC159EG	338
SPRA0062EG	376	USC010EG	337	USC168EG	338
SPRA0062EG	376	USC013EG	337	USC168HD	338
SPRC0025EG	377	USC016EG	337	USC178EG	338
STCB6	387	USC016HD	338	USC191EG	338
STS	372	USC017EG	337	USC200EG	338
STS2346	185	USC017HD	338	USC208EG	338
SWFF0037EG	150	USC020EG	337	USC218EG	338
SWFF0050EG	150	USC020HD	338	USC218HD	338
SWMF0037EG	151	USC021EG	337	USC228EG	338
SWMF0050EG	151	USC021HD	338	USC254EG	338
TBSBA4	179	USC022EG	337	USC277EG	338
TDH	129	USC025EG	337	USC277HD	338
TDHP2	130	USC025HD	338	USC311EG	338
TDHP2PR10	130	USC026EG	337	USC324EG	338
TDHT4	129	USC026HD	338	USC324HD	338
TDHT6	129	USC028EG	337	USC400EG	338
TEB23	186	USC031EG	337	UTS150	100
TEB4	186	USC031HD	338	UTS15038RL	279
TEB6XT	184	USC033EG	337	UTS200	100
TEBS1624	202	USC033HD	338	UTS20038RL	279
TGE	329	USC036EG	337	UTS300	100
TPC112	341	USC040EG	337	UTS30038RL	279
TPC238	341	USC040HD	338	VAFT	117
TRC062	341	USC042EG	337	VAFTR	117
TRC075	341	USC042HD	338	VF14	116
TRC087	341	USC046EG	337	VF144TI	124
TRC100	341	USC046HD	338	VF146A	123
TRC112	341	USC048EG	337	VF146T	124
TRC125	341	USC048HD	338	VF146TI	124
TRC137	341	USC053EG	337	VF14708	124
TRC150	341	USC054EG	337	W170000EG	385
TRC162	341	USC054HD	338	W190000EG	384
TRC200	341	USC058EG	337	W200000EG	385
TRC212	341	USC058HD	338	WBS37RL	278
TSGB16	200	USC060EG	337	WC812	88
TSGB1624	200	USC060HD	338	WMX3	90
TSGB1624S	199	USC063EG	337	WMX6	90
TSGB24	200	USC068EG	337	WMX6SF	69
TSGLDR1	201	USC073EG	337	ZGA512	390
TSGLDR1TC	201	USC073HD	338		

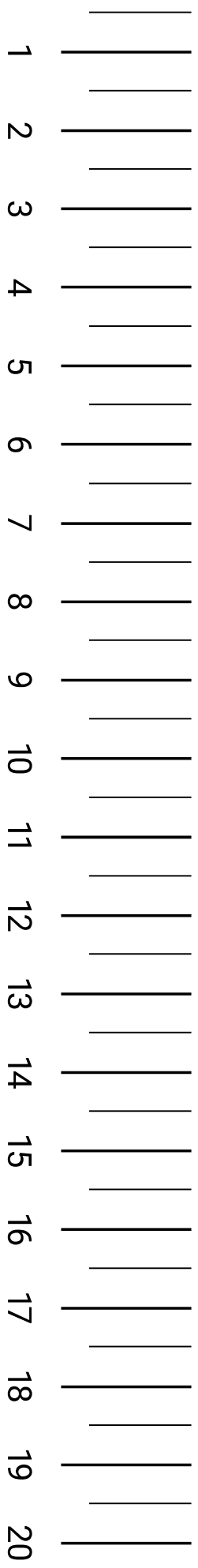

Our powerful portfolio of brands:

CADDY ERICO HOFFMAN RAYCHEM SCHROFF TRACER



nVent.com/CADDY

©2018 nVent. All nVent marks and logos are owned or licensed by nVent Services GmbH or its affiliates. All other trademarks are the property of their respective owners. nVent reserves the right to change specifications without notice. CADDY-CAT-CFC-Electrical-USEN-1812