

Subject: IP-25-F1 and IP-25-F2 Polymer Insulator (see table for thread information)  
 25 kV ANSI C29.5 Class 55-5 Tie Top Insulator  
 Material: Proprietary High Density Polyethylene

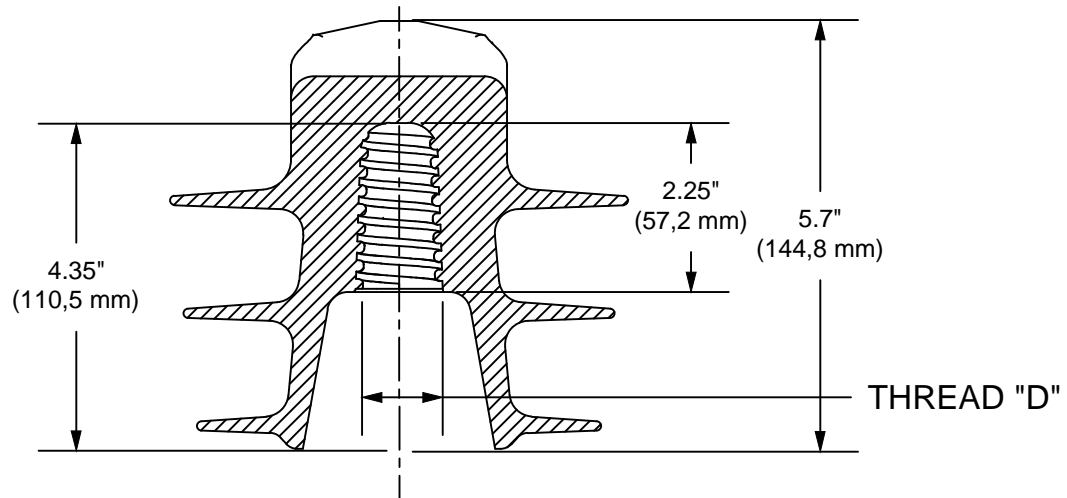
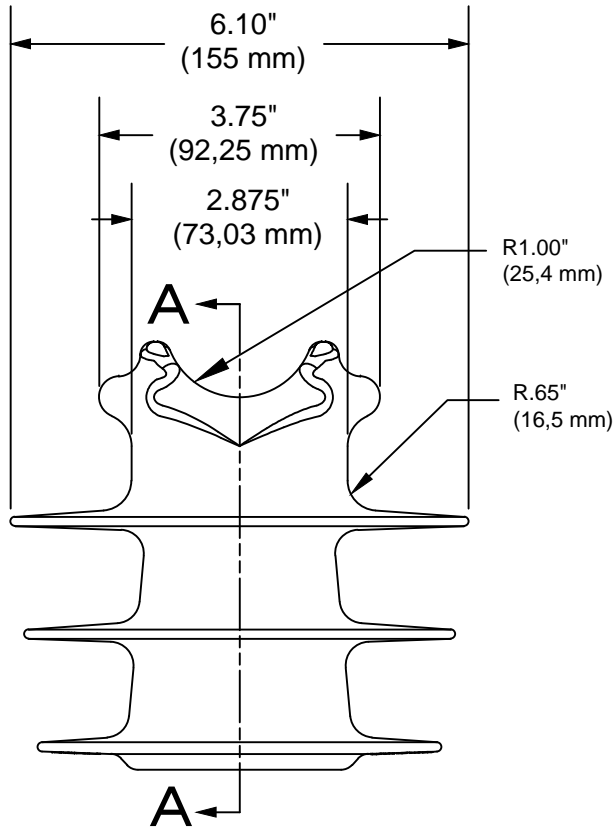
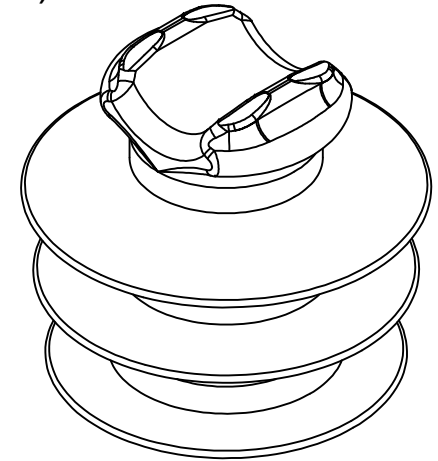

**SECTION A-A**

\*ALL DIMENSIONS ARE NOMINAL

ALL DIMENSIONS ARE APPROXIMATE AND MAY VARY PER FACTORY TOLERANCES, CONTACT PLP FOR MORE INFORMATION.

CATALOG No.	PART No.	THREAD "D"	APPROX WEIGHT
IP-25-F1	600064977101	1" (25.4mm)	1.90 lbs
IP-25-F2	600064977301	1-3/8" (35mm)	1.80 lbs



**PREFORMED**  
**LINE PRODUCTS**  
 660 BETA DRIVE MAYFIELD, OHIO 44143  
 PH: (440)-461-5200 R&E FAX: (440)-473-9103  
 www.prefomed.com

**CONFIDENTIAL**

The data and information contained in this document are proprietary to PREFORMED Line Products (PLP). Such data and information are provided solely for use with PLP's products and shall not be disclosed, duplicated, or otherwise used without the express written approval of PLP.  
 PLP MAINTAINS THE RIGHT TO CHANGE DRAWING SPECIFICATIONS AT ANY TIME. PLEASE CONTACT PLP TO VERIFY CURRENT VERSION.

**TITLE**

25KV ANSI STYLE TIE TOP  
 POLYMER INSULATOR

DWG BY:	APR BY:	DATE:	SCALE	FILE NAME
MNB	MRB	4/12/2017	NTS	IP-25-FX