

Transmitter - OPEN-CLOSE-STOP



Part Number: GIDFX5.S

Description

OPEN-CLOSE-STOP dual-frequency cycling transmitter

Features

Rolling Code
315 & 390 MHz

Specifications

CR2032 Battery

Agency Approvals

FCC Certified



Assembly Information

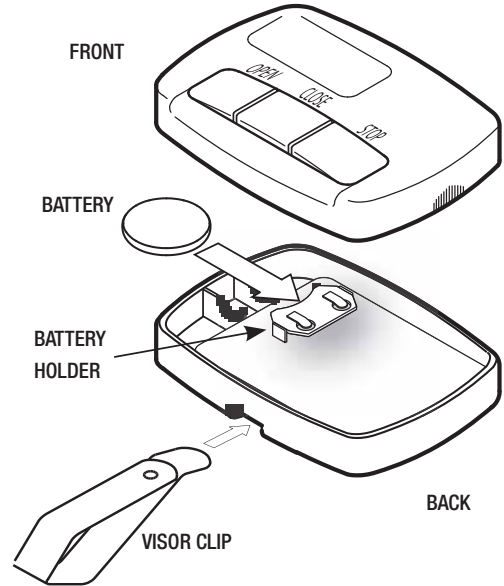

Technical Drawings

