

● **Packing list**

No.	Accessories	Quantity
1	Main body	1
2	Fixed buckle	1
3	Self drilling screws	6
4	Metal oxide varistor	1
5	Positioning label	1

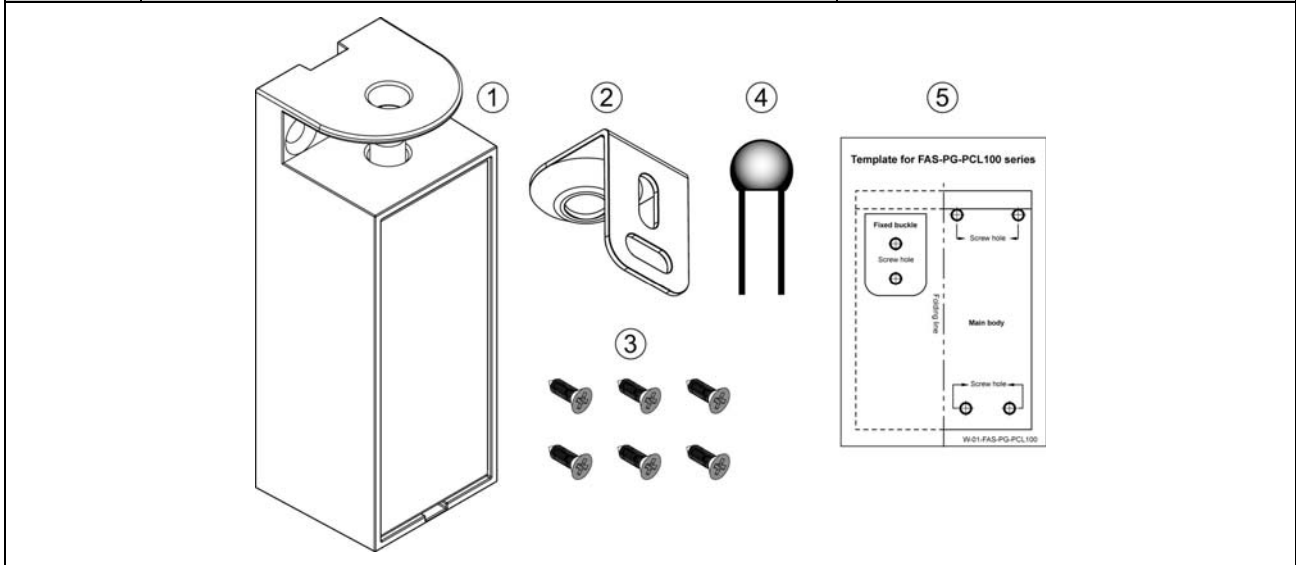

● **Specification**

Dimensions	82 (L) x 30 (W) x 28 (H) mm 3.2(L) x 1.2 (W) x 1.1(H) inch	
Voltage/Current	12VDC/250mA, 24VDC/125mA	
Holding force	400Kgs / 880Lbs	
Gross weight	180g±5%	
Material	Lock body: Aluminum alloy Plate cover: stainless steel Fixed buckle: stainless steel	

● **Applications**

For drawer, cabinet, mailbox.

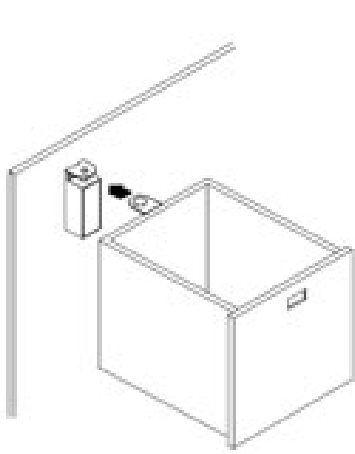

A. Drawer

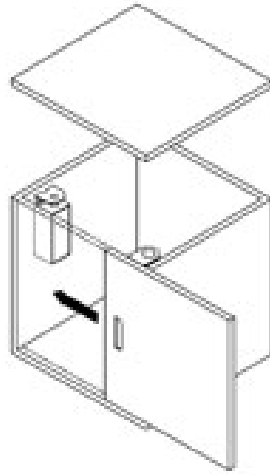

B. Cabinet(Sliding door type)

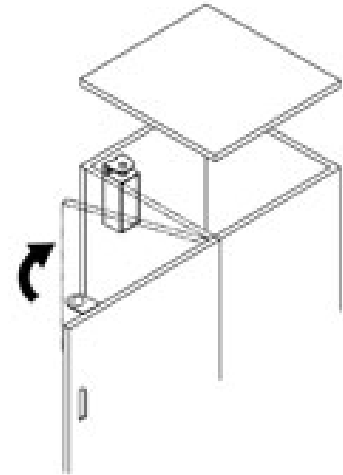

C. Cabinet(Pulling door type)

● **Electric wiring diagram**

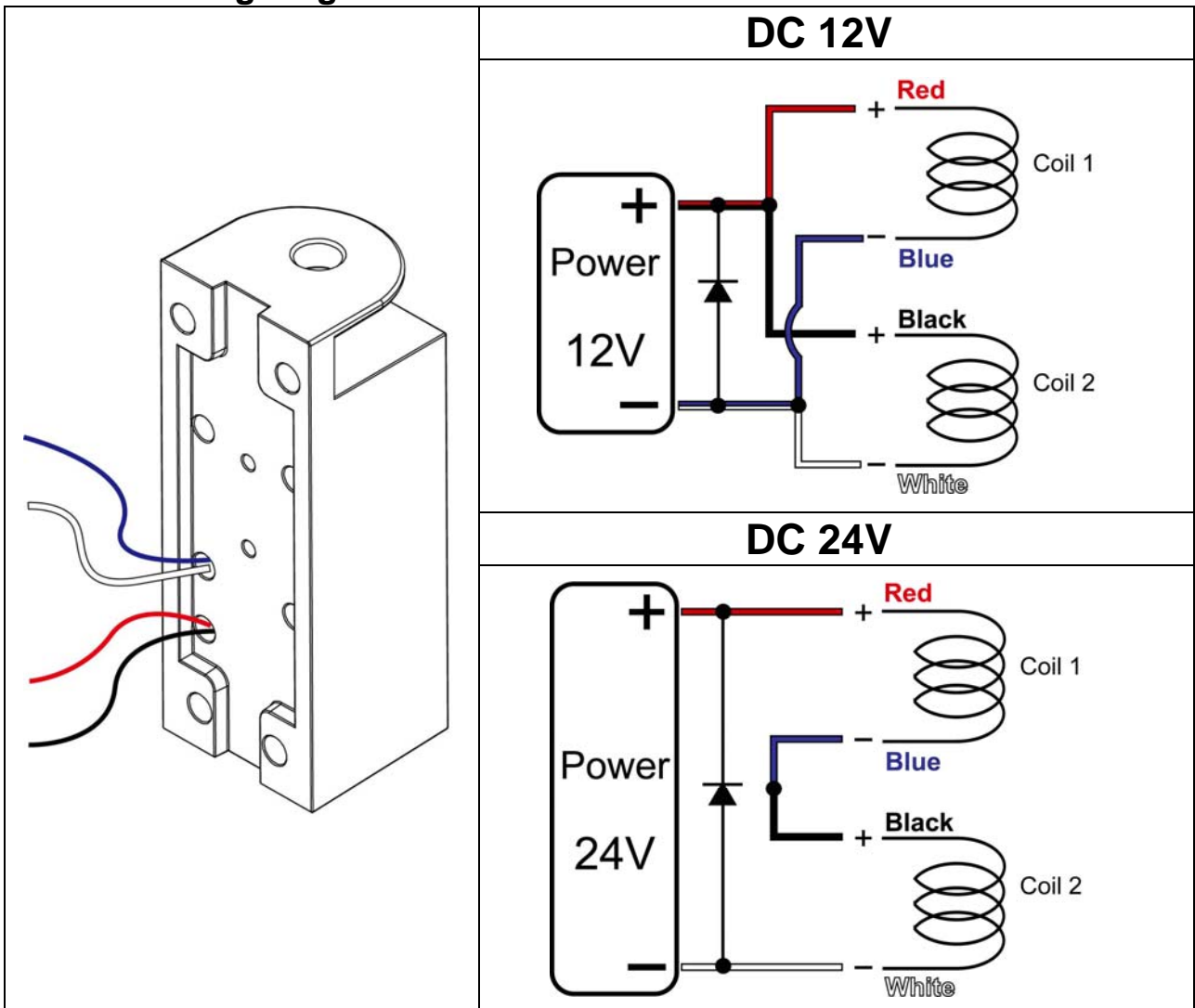

● **How to install**



Note: FAS-PG-PCL100 series, only proposed for vertical installation.

Default: fail-secured operation

Step 1 → Switch cabinet lock to desired operation. (fail-secured / fail-safe)

1. Removing holding screws and reversing solenoid direction

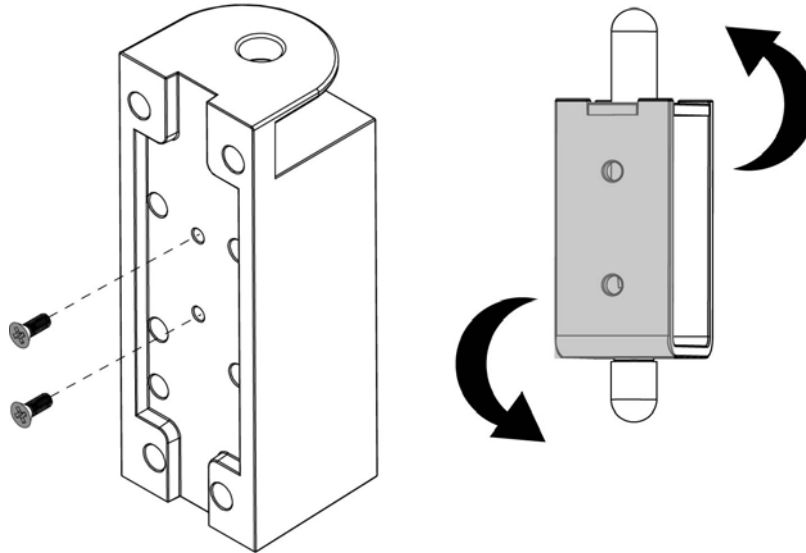

Proper position the solenoid direction to
fail-secured mode

Proper position the solenoid direction to
fail-safe mode

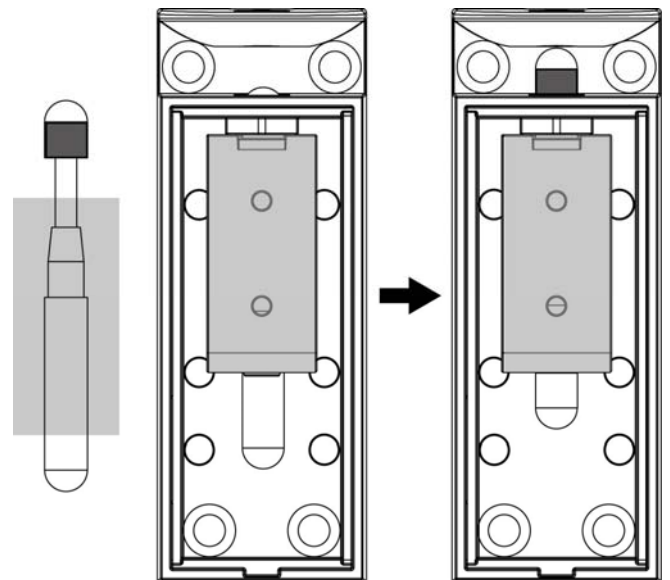
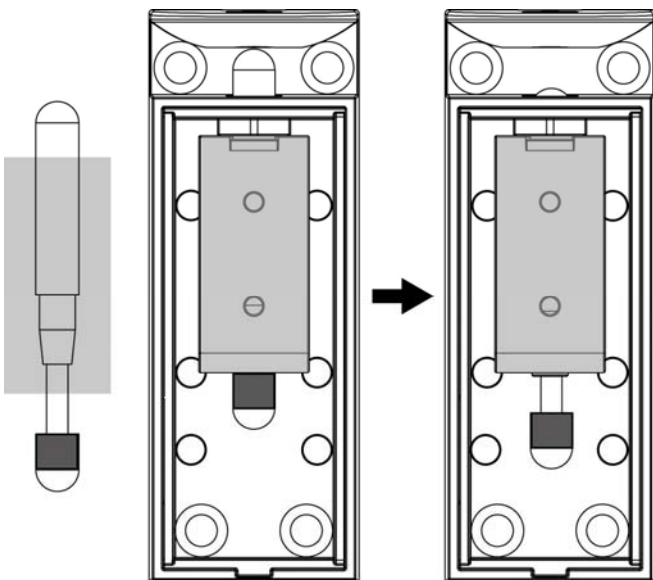

2. Fix the holding screws.

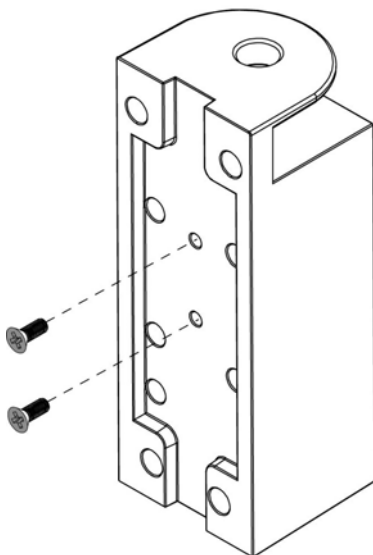

Step 2 → Positioning the panel

1. Stick the positioning label and lining the center line with the cabinet and cabinet door before making any cuts or drill.

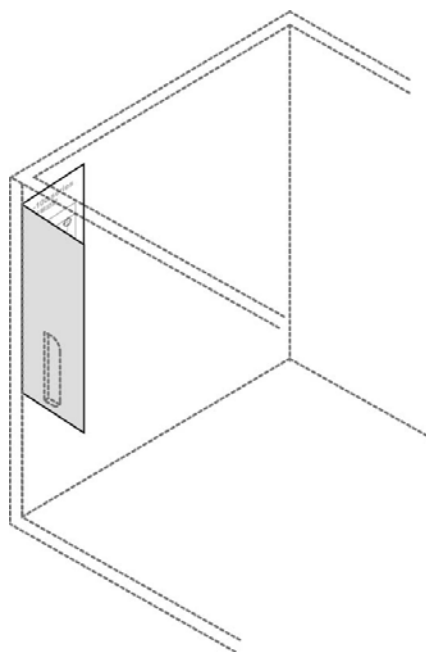
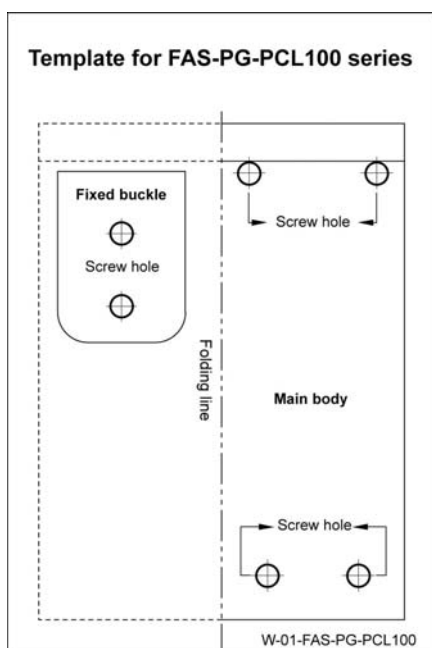

Step 3 → Mounting the cabinet lock and tighten all the 4 screws.

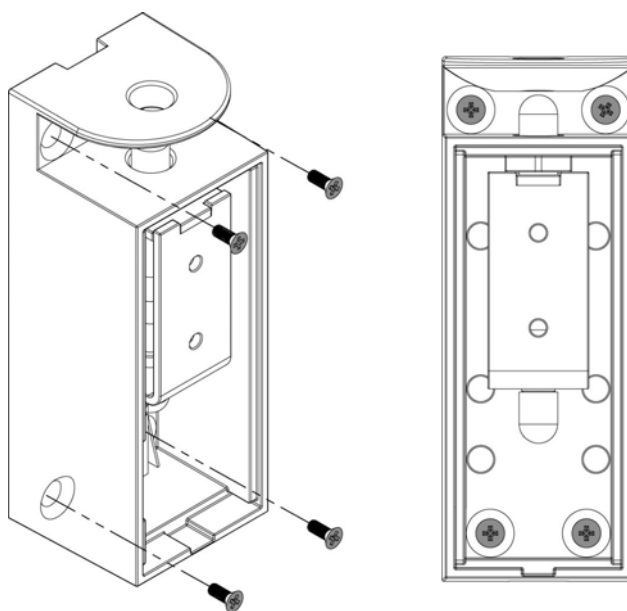

Step 4 → Combining the plate cover to complete the installation.

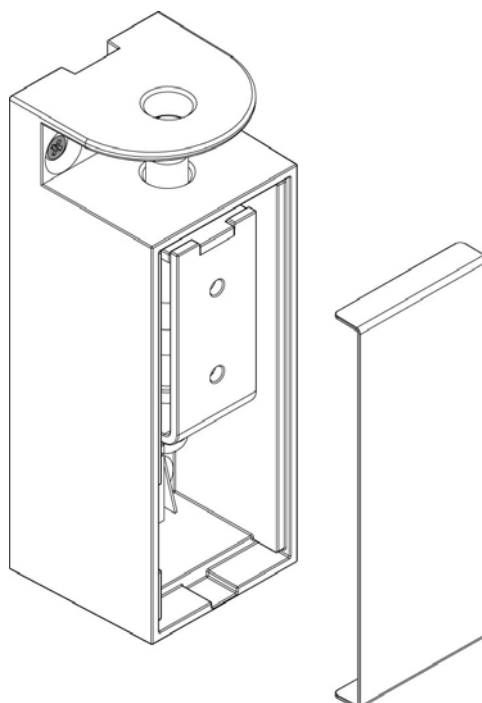

Step 5 → Aiming the screw hole and locking fixed buckle by positioning label.

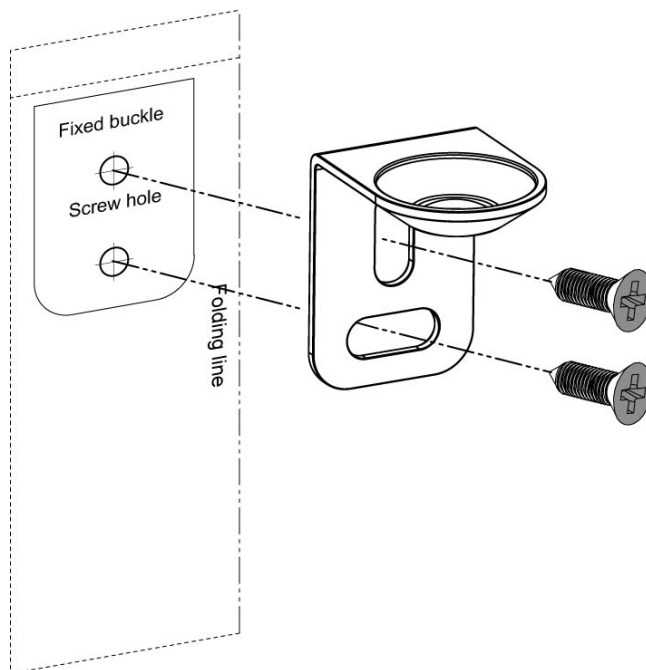

Specifications subject to change without notice for further modification.