



ALL Security Equipment

FAS-HUL1200LSDM Magnetic Lock Manual

www.AllSecurityEquipment.com

Phone: +1 (305) 437 9757 Email: hello@allsecurityequipment.com Address: 6929 NW 52nd St, Miami, FL 33166 USA

Magnetic Lock 1200 lbs.

Specification

Model	Size(mm)	Voltage	Current	Holding Force	Lock Signal	Door Signal	Time	Door
Single door magnetic lock	260Lx54.7Wx29.6H	DC12V(Default); DC24V(Order)	12V/500mA±10%; 24V/250mA±10%	350kg(800Lbs)	NO	NO	No	Single Door
Single door magnetic lock with signal	260Lx54.7Wx29.6H	DC12V(Default); DC24V(Order)	12V/500mA±10%; 24V/250mA±10%	350kg(800Lbs)	NO/NC/COM	NO	No	Single Door
Single door magnetic lock with time delay	260Lx54.7Wx29.6H	DC12V(Default); DC24V(Order)	12V/500mA±10%; 24V/250mA±10%	350kg(800Lbs)	NO/NC/COM	NO	0/3/6/9sec.	Single Door
Single door magnetic lock with bond sensor	260Lx54.7Wx29.6H	DC12V(Default); DC24V(Order)	12V/500mA±10%; 24V/250mA±10%	350kg(800Lbs)	NO/NC/COM	NO/NC/COM	No	Single Door
Double door magnetic lock	520Lx54.7Wx29.6H	DC12V(Default); DC24V(Order)	12V/500mA±10%x2; 24V/250mA±10%x2	350kgx2(800Lbsx2)	NO	NO	No	Double Door
Double door magnetic lock with signal	520Lx54.7Wx29.6H	DC12V(Default); DC24V(Order)	12V/500mA±10%x2; 24V/250mA±10%x2	350kgx2(800Lbsx2)	NO/NC/COM	NO	No	Double Door
Double door magnetic lock with time delay	520Lx54.7Wx29.6H	DC12V(Default); DC24V(Order)	12V/500mA±10%x2; 24V/250mA±10%x2	350kgx2(800Lbsx2)	NO/NC/COM	NO	0/3/6/9sec.	Double Door
Double door magnetic lock with bond sensor	520Lx54.7Wx29.6H	DC12V(Default); DC24V(Order)	12V/500mA±10%x2; 24V/250mA±10%x2	350kgx2(800Lbsx2)	NO/NC/COM	NO/NC/COM	No	Double Door

Diagram(unit:mm)

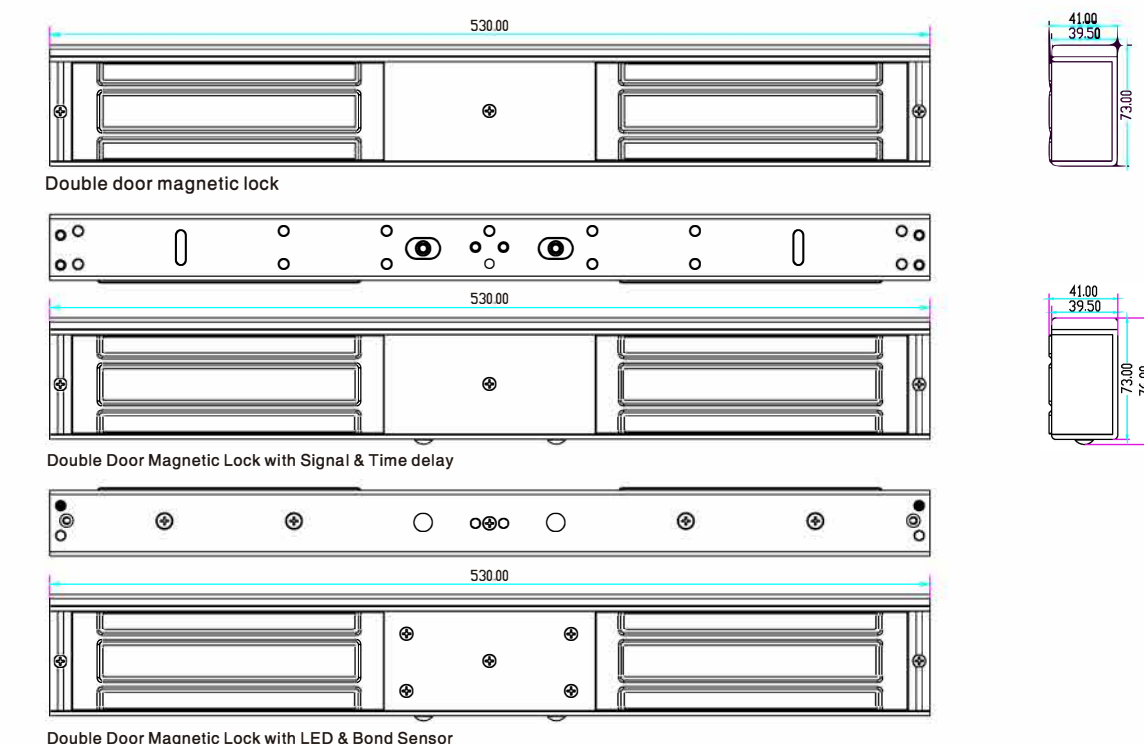
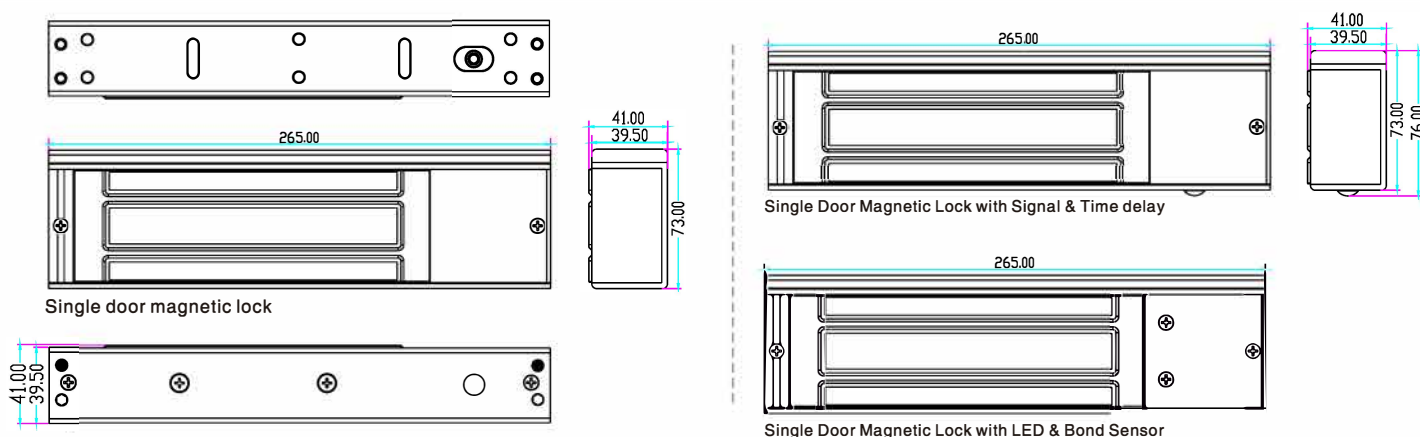

Installation

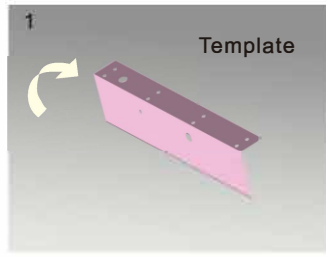
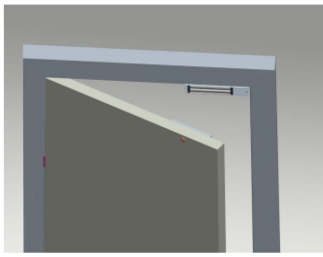

1 Fold the plate to 90° .

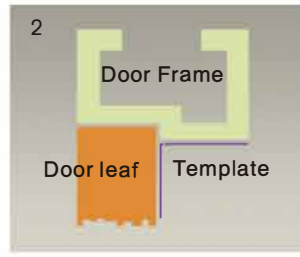

2 Close the door first, then place the upper side of template on door frame, while adjust the left side next to the door leaf.

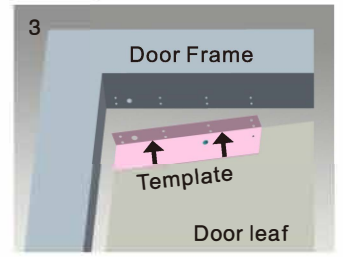

3 Mark screw positions of armature plate and magnetic lock on door leaf and door frame respectively.

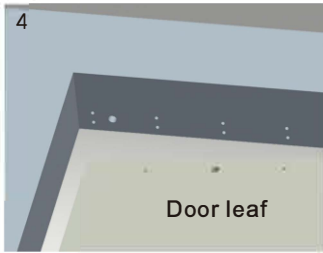

4 Drill holes based on the marked positions.

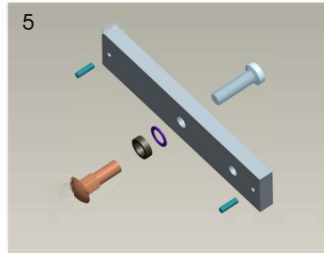

5 Make a combination based on the picture.

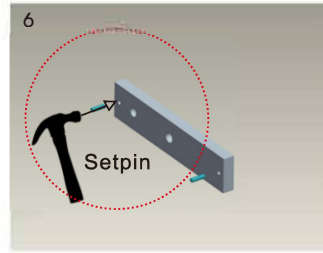

6 Strike the pin into the armature plate slightly (to avoid movement).

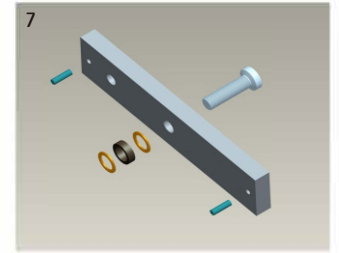

7 Make a combination based on the picture (add washer accordingly). The rubbering must be added.

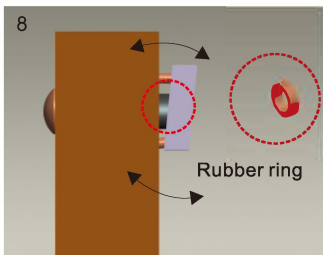

8 Place the rubber ring between armature plate and door leaf.

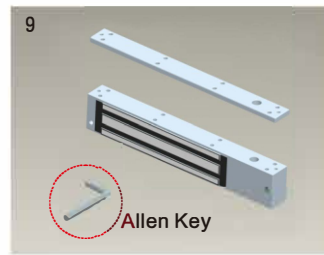

9 Use Allen key to remove the mounting plate from lock body.

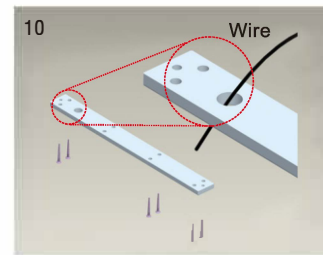

10 Fix the mounting plate on the door frame according to the holes drilled earlier.

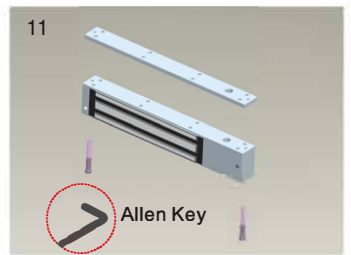

11 Use Allen key to screw the lock body on the mounting plate.

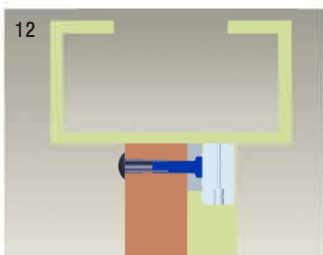

12 Close the door to test holding force. The angle between armature plate and magnetic lock can be adjusted by adding or reducing washers.

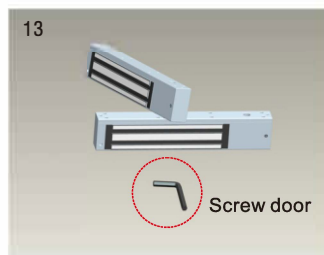

13 After all the appropriate procedures, the holding force can be maximized. Finally, fix the tamper screw.

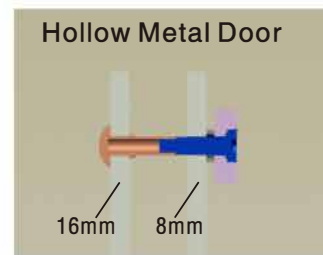

Hollow Metal Door
Drill a hole
Inside: Diameter is 8mm
Outside: Diameter is 16mm

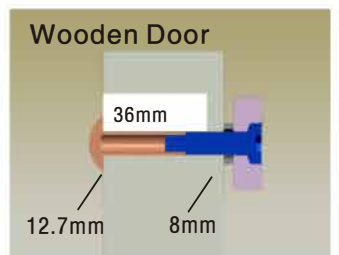

Wooden Door
Drill a hole
Inside: Diameter is 8mm
Outside: Diameter is 12.7mm

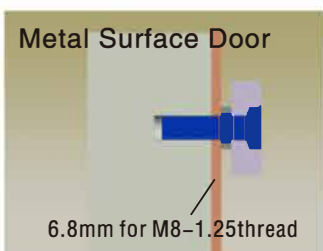

Metal Surface Door
Inside: Drill a hole diameter is 8mm folding the plastic straight pin

Notice:

Thickness of Door Leaf:

350LBS: 44mm 600LBS: 50mm 800LBS: 48mm 1200LBS: 46mm

- A. The screw of armature plate should not be fixed too tight. Proper elasticity should be guaranteed for the rubber ring so that the armature plate can adjust itself to the appropriate position.
- B. Check the jumper's position before connecting. Figure out it represents 12VDC or 24VDC.

Bracket Installation

Different brackets are available according to different types of doors. For example, narrow door, frameless glass door and inward opening door.

L Bracket

When the door frame thickness is less than 42mm, L bracket is needed.

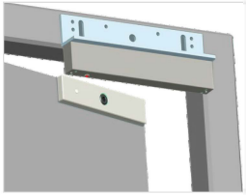

Single Door Magnetic Lock Bracket

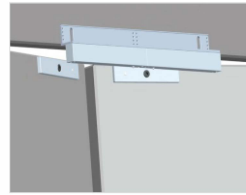

Double Door Magnetic Lock Bracket

LC Bracket

LC Bracket one-piece design, wires are mortised, no damage on wires

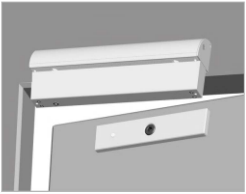

Single Door Magnetic Lock Bracket



Double Door Magnetic Lock Bracket

ZL Bracket

If install a bracket on inward opening door, ZL bracket is needed

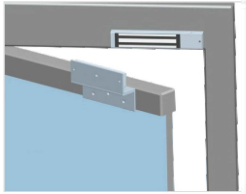

Single Door Magnetic Lock Bracket

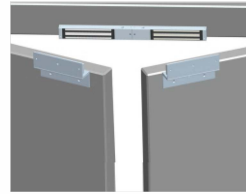

Double Door Magnetic Lock Bracket

ZLC Bracket

Hidden-line Design of bracket for single door magnetic lock, one-piece design, durable, easy installation

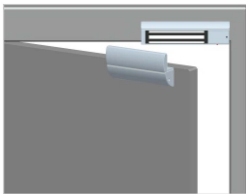

Single Door Magnetic Lock Bracket

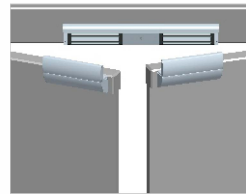

Double Door Magnetic Lock Bracket

GZ Bracket

One-piece design, durable & professional design, easy installation, suitable for 10-15mm frameless glass door.

Attention: No GZ bracket for 500kgs series available currently.

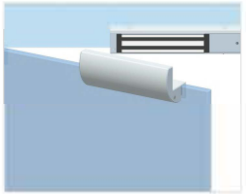

Single Door Magnetic Lock Bracket

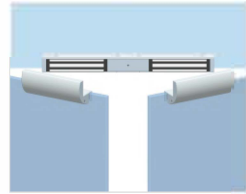

Double Door Magnetic Lock Bracket

U Bracket

If door leaf is glass, need U bracket to be used with lock (suitable for 10-12mm glass door)

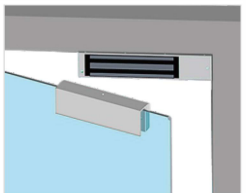

Single Door Magnetic Lock Bracket

Installation of Armature Plate

If door leaf is too thick, need to choose I bracket

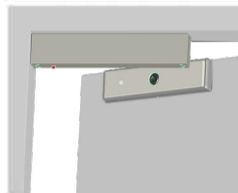

Double Door Magnetic Lock Bracket

Circuit Board Diagram

A. 12VDC Input:
 Connect the positive(+)lead from a 12VDC power source to V +.
 Connect the ground(-)lead from a 12VDC power source to V -.
 Check jumper for 12 VDC operation.

B. 24VDC Input:
 Connect the positive(+)lead from a 24VDC power source to V +.
 Connect the ground(-)lead from a 24VDC power source to V -.
 Check jumper for 24 VDC operation.

Wiring Instruction of Single Door Magnetic Lock

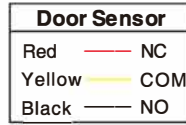
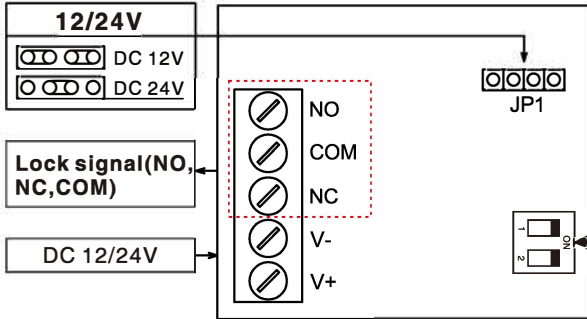

Model with DS will come with one more set of signal for door sensor and lock status(NO/NC/COM contact)

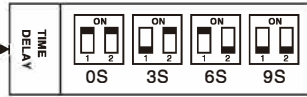

Model with T will come with this function

Standard magnetic lock No signal output

Wiring Instruction of Double Door Magnetic Lock

Connection: green wire or white plug, except the models without LED indicator and signal output; only when it detects that double doors have been locked, there will be normal signal output.

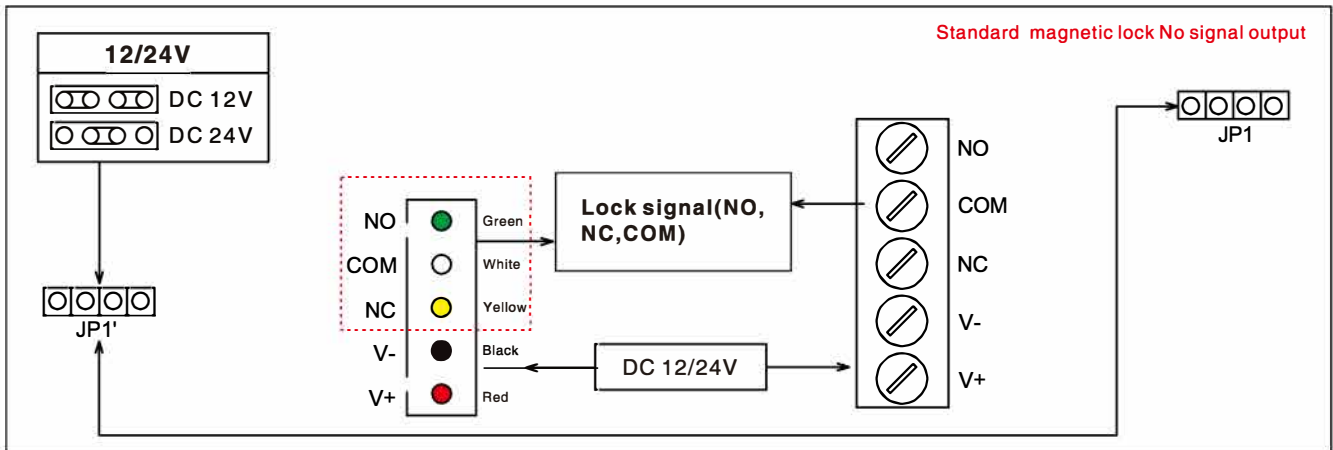

Standard magnetic lock No signal output

Wire Connection

