



ALL Security Equipment

**3-Button Remote with Visor Clip
FAS-RM893**

www.AllSecurityEquipment.com

Phone: +1 (305) 437 9757 Email: hello@allsecurityequipment.com Address: 6929 NW 52nd St, Miami, FL 33166 USA

Package Content



1 x Door Remote



1 x Visor Clip

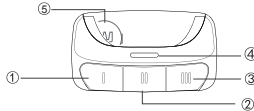

- ① Button 1
- ② Button 2
- ③ Button 3
- ④ Status LED
- ⑤ Battery CR2032

— 1 —

Programming Remote controls

This remote can be used as a replacement remote for LiftMaster 1993-Current, Genie Intellicode 1995-Current, Linear Mega-code 1997-Current, Wayne Dalton 372.5MHz 199-Current.

For use with gate operators ,commercial door operators,or other products that are 315MHZ or 390MHZ and have a Learn button.

— 2 —

Programming Remote controls

1.Press and hold the first two buttons at the same time until remote's LED flashes quickly then turns off, then within 3 second press and release the remote control button you wish to use the number of times that corresponds with the garage door opener type. The LED will flash quickly within 3 seconds to confirm the frequency chosen



of Presses Garage door opener Type

- 1..... LiftMaster® Yellow Button 2011-Current
- 2..... LiftMaster® Purple Button 2005-Current
- 3..... LiftMaster® Red+Orange Button 1997-2005
- 4..... LiftMaster® Green Button 1993-1996
- 5..... Genie® Intellicode Universal 1995-Current
- 6..... Linear® Mega-code 1997-Current
- 7..... Wayne Dalton® 372.5MHz 1999-Current

For example : If you want to program the third button remote to the Genie® compatible mode, you would have to hold the first two buttons until the LED flashes and then within 3 second press the third button 5 times.

— 3 —

2.Press and release the Learn button on the opener you are trying to program. The learn LED should turn on for 30 seconds.

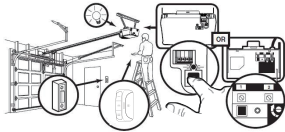

3.Press the remote control button programmed in step 1 until the opener's learn LED light flashes or two clicks are heard.

4.To test the successful pairing, press the programmed button on the remote. The opener should activate.

— 4 —

You can now use your remote to control your opener. If the opener does not function, try pairing again. If it still does not function please call us at 1 (800) 730-8382 or email us at hello@allsecurityequipment.com

NOTE: Access Master, Do-It, Gatheron, LiftMaster, Link Control, Master Mechanic, Raynor, Sears Craftman, Steel Craft, True Value are all compatible with Chamberlain technology. Please refer to the relevant learn button.

— 5 —

TROUBLESHOOTING

PROBLEM	SOLUTION
The system does not receive the transmitter signal. The transmitter LED will not light.	Ensure clear plastic battery insulator has been removed, OR Replace the transmitter battery
The operating range is reduced.	Replace the transmitter battery.
Transmitter kicks other out of memory.	Erase the memory completely on receiver (through learn button). Re-learn all transmitters in.

— 6 —