

size: 210x142.5mm

ATTENTION! Your Rico home appliance has been manufactured with utmost care and under strict quality control. If, for any reason, you are not satisfied, please contact your local dealer or the Rico Customer Relations Department for immediate action on your query / problem at :

Customer Relations Department

Rico Appliances Pvt. Ltd.

8th Floor, Sapphire Bldg, S.V. Road, Khar (w)
Mumbai, Maharashtra, India- 400 052.

Tel.: (91-22) 2410 2926,

Fax: (91-22) 2410 2927,

E-mail: service@rico.in

Web: www.ricoappliances.com

Please ensure that the Warranty Card is filled in by the Dealer at the time of purchase. Detach the card below and mail it within 7 days of the purchase to Rico.

POST CARD

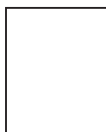

Rico Appliances Pvt. Ltd.

8th Floor, Sapphire Bldg, S.V. Road, Khar (w)
Mumbai, Maharashtra,
India- 400 052

Rico ¹INDIA'S
BEST & FOREMOST®
HOME APPLIANCES

RECHARGEABLE LED EMERGENCY LIGHT EL1506



INSTRUCTION MANUAL WITH WARRANTY CARD

POWERFUL • EFFICIENT • LONG LASTING

Dear Customer,

Thank you for selecting Rico.

You have just bought yourself one of the finest product help in the form of Rico Emergency Light

Your Rico Emergency Light has been manufactured for you under the most stringent quality control procedures.

You are assured of the best quality, performance and after sales service. If, however, for any reason, you feel something is lacking, we are always there at your service.

A list of Rico service centres is also enclosed herewith. If you require any further assistance, please do not hesitate to contact us, for immediate action on your query/ problem, at :

Customer Relations Department

Rico Appliances Pvt. Ltd.

8th Floor, Sapphire Bldg, S.V. Road, Khar (w)

Mumbai, Maharashtra, India- 400 052.

Tel.: (91-22) 2410 2926,

Fax: (91-22) 2410 2927,

E-mail: service@rico.in

Web: www.ricoappliances.com

Thank you once again for buying Rico.

C. Thakur

Chairman,

Rico APPLIANCES PVT. LTD.

CONTENTS

Checklist / Description	1
General operating precautions	2
How to operate the unit	2
Technical Specifications	2
Maintenance	3
How to charge	3
Warranty procedure and service procedure	3-4

Rico[®]

**HOME APPLIANCES
WARRANTY CARD**

Rico Product : Rechargeable LED Emergency light EL1506

Serial No. : _____ **Date of Purchase :** _____

Dealer's Name & Address : _____

Customer Name: _____

Address: _____

City: _____ **Pin Code:** _____ **State/Country:** _____

E-mail: _____

Tel./Mobile : _____

(Please make sure your Dealer completes this card at the time of purchase)

6 Months Warranty

Please Fill this post card, cut along the dotted line , and mail to Rico
Within 7 days of purchase.

CHECKLIST / DESCRIPTION:

- ① HOOK
- ② HANDLE
- ③ TRANSPARENT COVER
- ④ LED LIGHT
- ⑤ ON/OFF SWITCH
- ⑥ BOTTOM
- ⑦ DC SOCKET
- ⑧ CHARGE INDICATOR
- ⑨ ADAPTOR

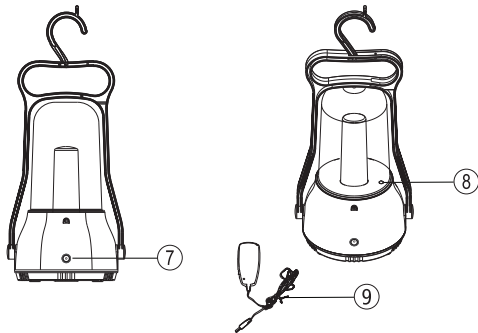
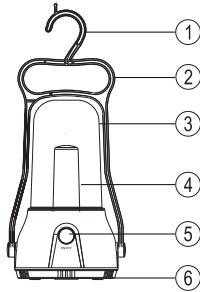

GENERAL OPERATING PRECAUTIONS

1. Charge the unit before the first use. For instructions please read the section below "How to charge"
2. Make sure the emergency light is connected to a three pin, 5 amp -230 volts ac socket only.
3. Please ensure to recharge the emergency light when the light goes dim.
4. Periodically charge the unit at least 24 hours when not in use for over one month, otherwise, the battery will be over- exhausted and cannot be recharged.
5. Turn off the switch when the lantern is not in use.
6. The efficiency may decrease if lantern is used or charged when temperature is below (0°C) zero degrees centigrade or above forty degree centigrade (40°C).
7. Please keep away from water or rain.

HOW TO OPERATE THE UNIT

Press the switch one time & the lamp will come on.
Press the switch again & the lamp will go off

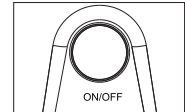

TECHNICAL SPECIFICATIONS

1. Battery: 6 Volts, 4.5 AH lead- acid rechargeable maintenance free battery.
2. 24 Led Lights
3. Charging time: 20-24 hours
4. Duration time: 8 hours

MAINTENANCE

1. Use a cotton swab with a little cleaning alcohol to clean the lantern body.
2. Never use strong or volatile chemicals to clean the lantern; otherwise the plastic parts will be damaged and may become opaque.
3. To avoid damages of lamp, please do not use any other battery other than the one supplied by the manufacturer.
4. To avoid electric shock, please do not open the unit.
5. To avoid danger, please do not change any part of the circuit or any part of the wiring.

HOW TO CHARGE

1. Connect charging adaptor to 5amp-230 volts as socket, green light will appear on the charging adaptor.
2. Connect another end of the adaptor wire having DC pin into DC socket of rechargeable emergency light.
3. The green light on charging adaptor will turn into red light indicates charging and at the same time the charge indicator on rechargeable emergency light will glow.
4. Charging adaptor is automatic therefore, once the charging is complete the same red light turns into green light.
5. Normal Charging time is 20-24 hours, the battery may become slightly warm during charging. It is a normal phenomenon.

HOME APPLIANCES WARRANTY CARD WARRANTY CONDITIONS & SERVICE PROCEDURE

Please preserve this warranty card and the cash memo and ensure that it is duly stamped (with the date stamped) and signed by the dealer. A warranty card or cash memo which is not stamped and signed by the dealer will be treated as invalid.

Kindly ensure you post the half portion to Rico Head office or update your details on our website www.ricoappliances.com.

Conditions of the Warranty:-

Your Rico product is warranted against manufacturing defects for 6 months from the date of purchase. The product is warranted against manufacturing defects only. This product is designed for domestic use only.

This warranty does not apply to

- Normal Wear and tear of parts or surface coating
- Faults which may be due to wrong usage, faulty handling, damage in transit, usage of spurious parts, neglect or accident are not covered by this warranty

- Damages resulting from accidents, mishandling or negligence on the part of the customer and fluctuation in supply voltage.
- Surface Coating, body aesthetics, plastic parts, neon lamps, bakelite parts, rubber/nylon parts, push buttons & bulb.
- Damages resulting due to usage of power supply other than specified 220/230 Volts, AC, 50 Hz. eg: inverters generators etc.
- For humming noise generated due to usage of electronic fan regulators of any make.

Should your Rico product become un-operational during the warranty period, Kindly contact your nearest authorized Rico Dealer / Service Centre. (List is available on www.ricoappliances.com)

Subject to the above - The defective part will be repaired / replaced free of charge for labour or materials, at our discretion & option, provide that:

- The unit is returned at your cost to our Authorized Service Centre along with the stamped and signed Cash Memo and Warranty Card.
- The unit is installed, used and maintained strictly in accordance with the instructions provided.
- The unit is not opened or tampered with by anyone except our Authorized Service Centre or technician.

CONSEQUENTIAL DAMAGE

Liability for consequential loss or damages is neither accepted nor is it implied. The warranty extended herein is in lieu of all implied conditions and warranties under the law and is confined to the repair or replacement of defective parts and does not cover any consequential or resulting liability, damage or loss. The warranty in no case shall extend to payment of any monetary consideration whatsoever or the replacement or return of the products as whole, liability for consequential loss or damage is neither accepted nor is implied.

SERVICE AND REPAIRS

Please get the product repaired only from our authorised service centre.

This warranty is confined to the repair or replacement of defective parts. Any expenses incurred on collecting and returning the product to the customer and/or on the service personnel who will visit the customer, such as to and fro conveyance, incidentals etc., shall be borne by the customer.

Please note that this warranty is issued subject to the jurisdiction of the competent courts in Mumbai INDIA only.

To avoid unnecessary repairs, please study the instruction manual carefully before operation.

Rico®

(To be retained by the purchaser)

Important : Before mailing the Warranty Card, please read all the terms and conditions of the warranty.

Rico Product : Rechargeable LED Emergency light EL1506

Serial No. : _____ **Date of Purchase :** _____

Dealer's Name & Address :

(This portion is to be mailed to Rico)
You can also register Warranty Card online at www.ricoappliances.com