



FRONTIER METAL

573-569-4800

H O R S E S T A L L S

A R C A D I A N

H O R S E S T A L L S

STALL DOORS

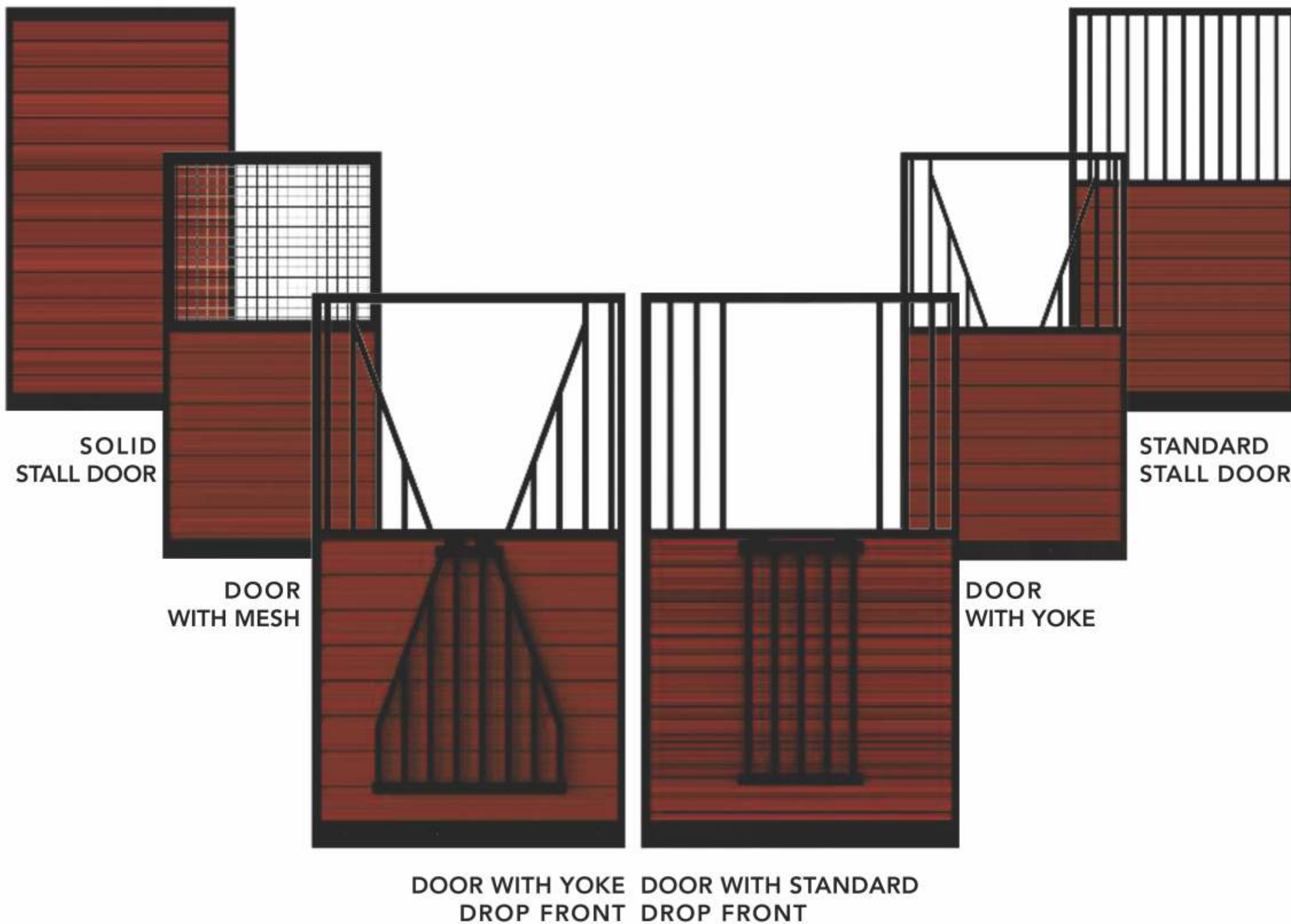

FEATURES

- Stall Door options include: standard grill, drop front, yoke front, solid and mesh
- All 36 MWI stock colors available in stalls with normal lead time
- Powder-coat finish has a slight river-texture to help hide dirt & imperfections to aid in longevity
- Color-matched latch options and track packages available
- Horse stall systems fabricated from 14-gauge galvanized substrate
- Available standard with a 1 inch O.D. galvanized substrate for maximum protection
- Welds concealed for rust prevention
- All doors come standard with combination toe kick/bottom guide to allow for hidden stay roller

GRILL

Choose the perfect grill for your horse!

14 GAUGE GRILLS:

One piece grills up to 144" long are available for stall fronts and partition walls. Grillwork is all galvanneal substrate for maximum protection. All welds are concealed to prevent rust. Fronts are available with standard grills, feed openings or swing out feed door options.

SIZES:

GRILL 4" O.C.: 24x36, 48x36, 60x36, 72x36, 84x36, 96x36, 120x36, 144x36

GRILL 4 O.C. WITH 12X12 FEED OPG.: 24x36, 48x36, 60x36, 72x36, 84x36, 96x36

GRILL 4" O.C. WITH SWING-OUT FEED DOOR: 48x36, 60x36, 72x36, 84x36, 96x36

WINDOW GRILL - ACTUAL SIZE: 24x48, 36x36, 36x48, 48x36, 48x48, 36x24, 48x24, 24x36



SWING OUT
FEED DOOR

GRILL WITH
12X12 FEED
OPENING



WINDOW
GRILL

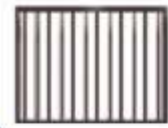

STANDARD
GRILL



Experience
the MWI difference.

OPTIONS





STALL, GATE & DOOR LATCH

Available in all powder
coat colors

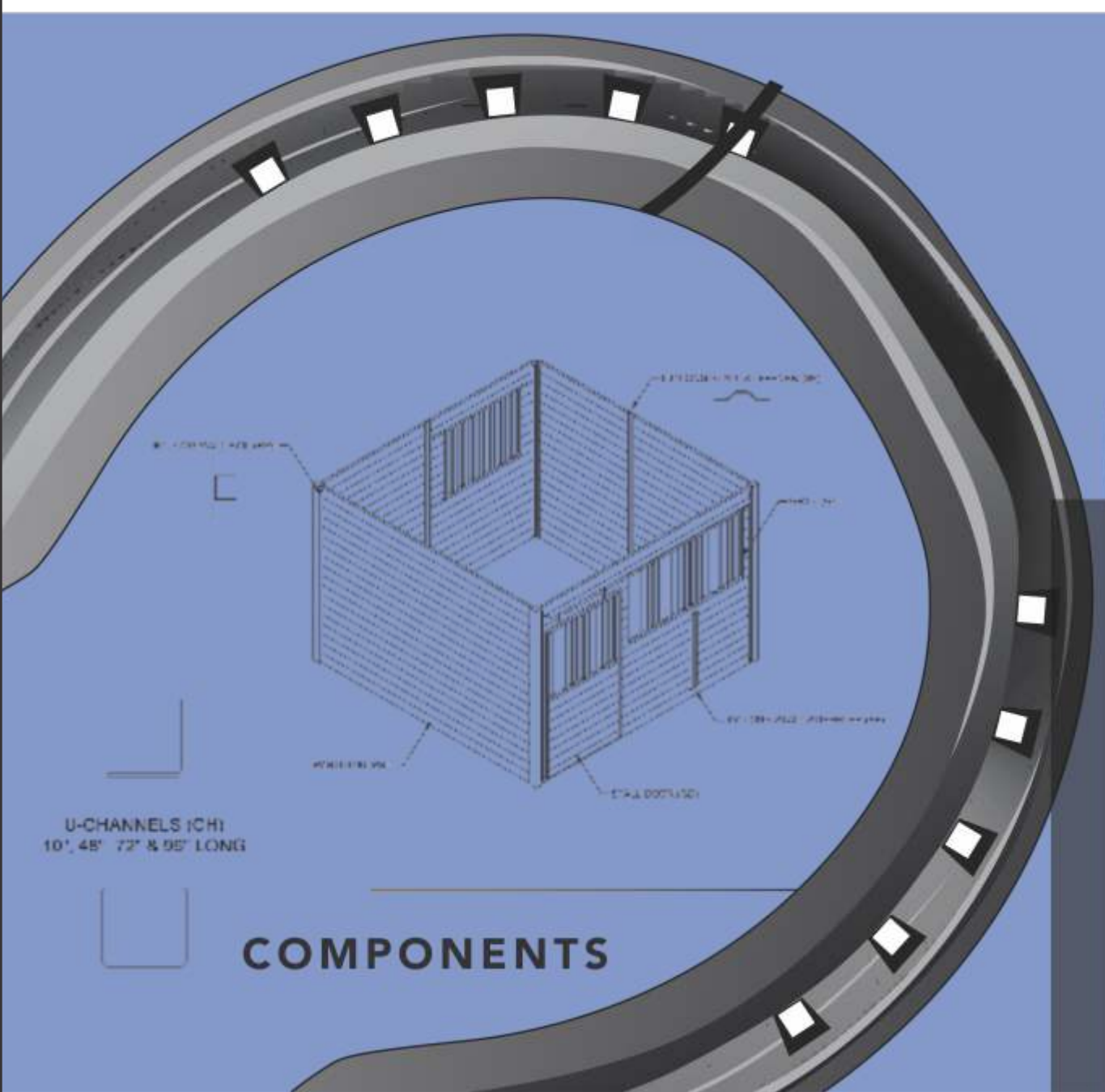

8' Color Matched Track

PACKAGE



TRACK PACKAGE:



Includes Track (A*) (avail-
able in face or top mount),
End Caps (B*), Hidden Bot-
tom Guide (C*), Keepers
(D*) & Trolleys (E).

*Color matched to stalls

THE **BIG**
PICTURE
& SPECIFICS

HORSE LOVERS

