

# ASSEMBLE Top Seat, Vertical and Cover FREEDOM FRAME

## a) PRE-ASSEMBLING VERTICALS

Put Resin Upper Joint as shown in the Figure, tighten up #12 Sheet Metal Screws.

## b) INSTALLING VERTICALS

Push in bottom end of vertical to lower joint as shown.  
Make sure two tabs stay in slot vertical Resin joint cover top rail.

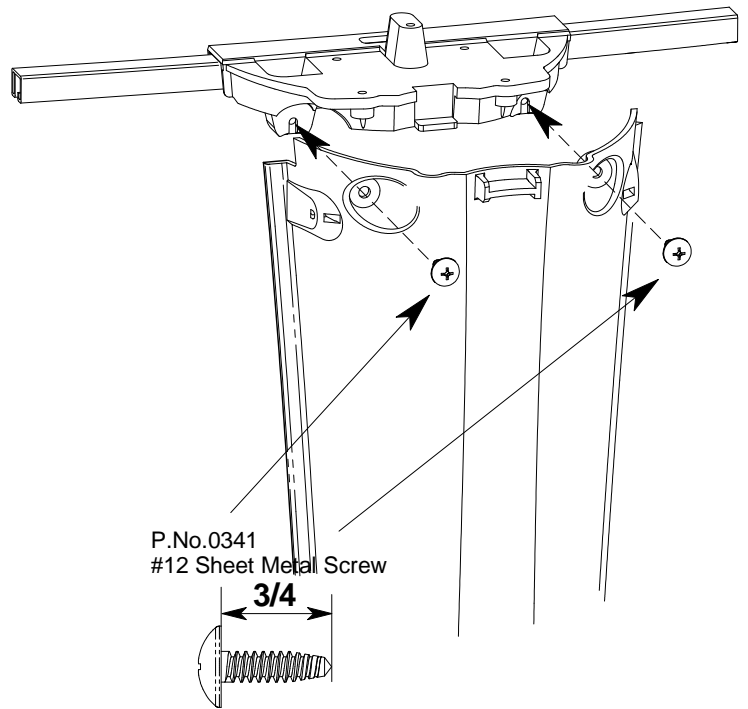
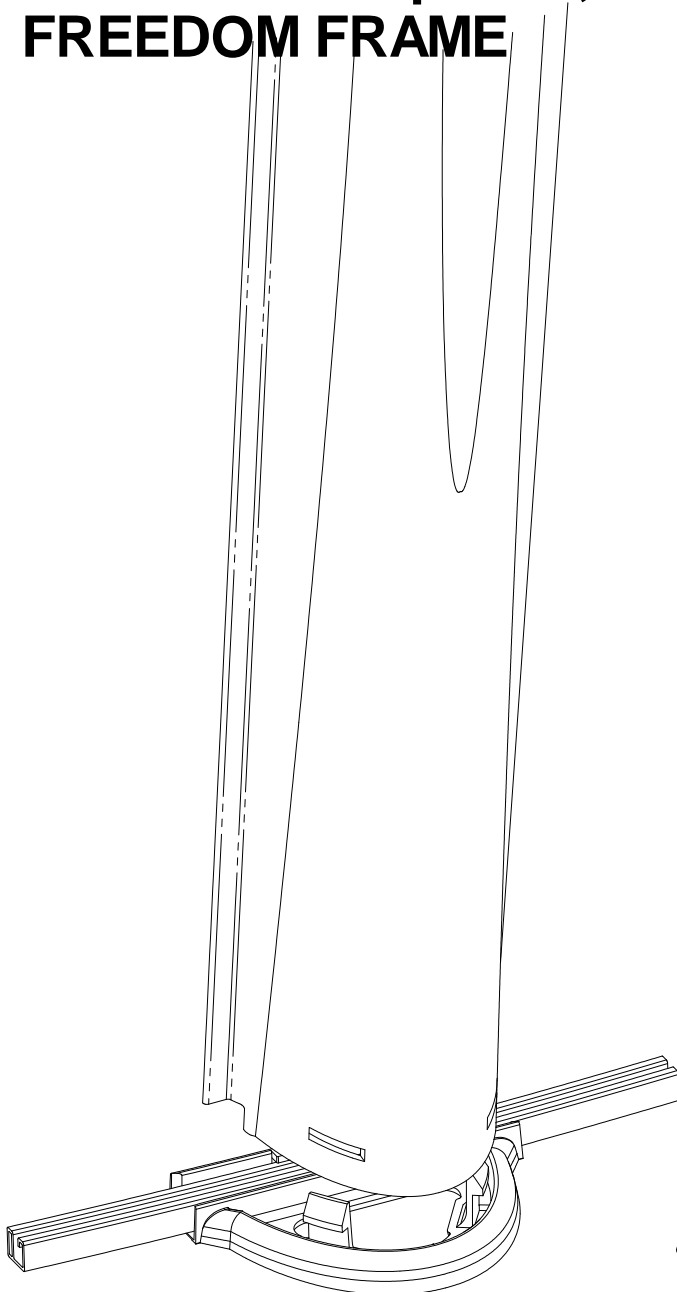

P.No.0341  
#12 Sheet Metal Screw

3/4

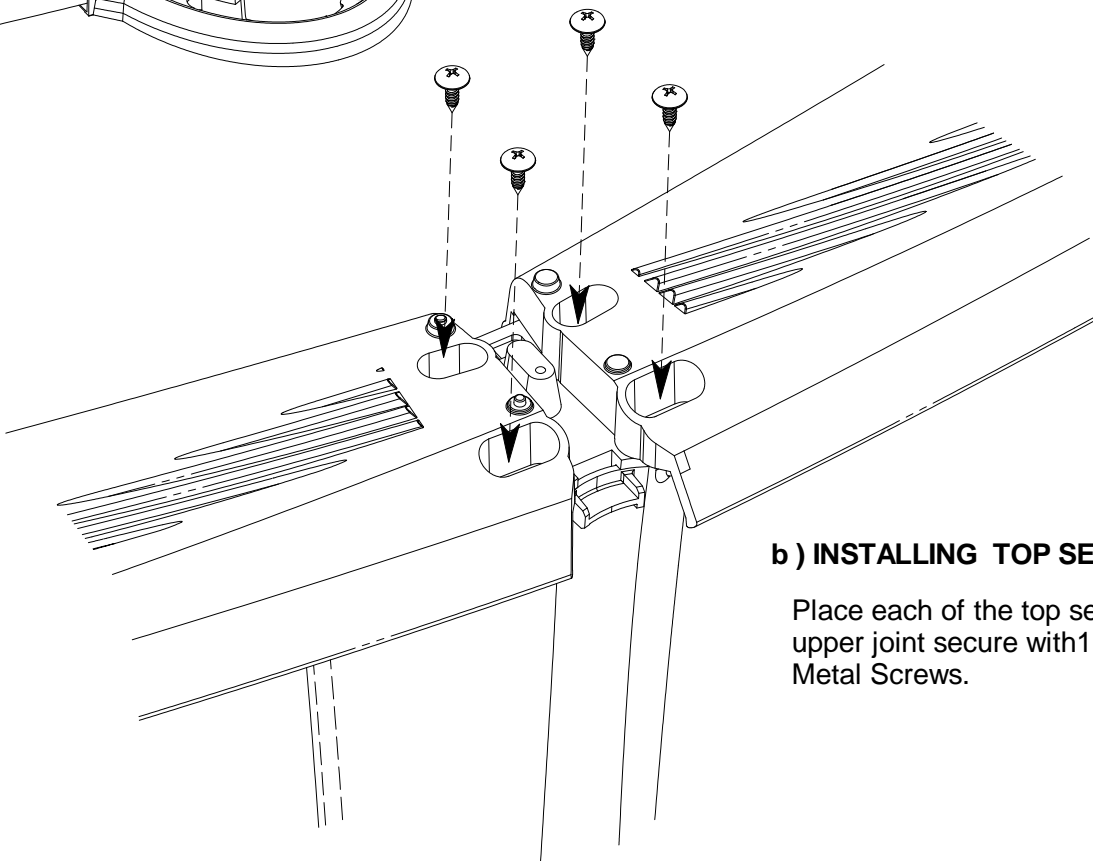

## b) INSTALLING TOP SEATS

Place each of the top seat over the upper joint secure with 1 #12 Sheet Metal Screws.

P.No.0341  
#12 Sheet Metal Screw

### c ) INSTALLING SEAT COVERS

Put smaller cover to top of top seat.

Secure with #12 Sheet Metal Screw.

Put lager cover slide into inside cover, secure with two #12 Sheet Metal Screw.

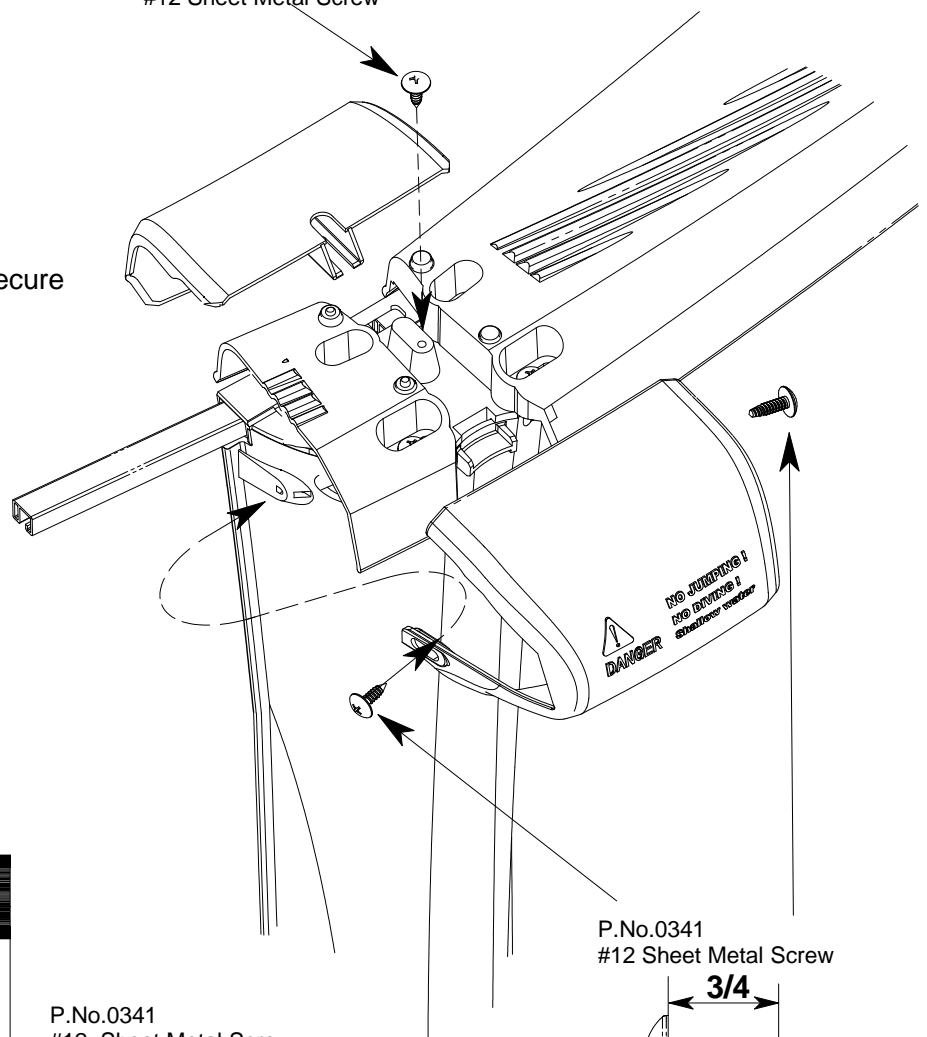

P.No.0341  
#12 Sheet Metal Screw

3/4

P.No.0341  
#12 Sheet Metal Screw



### FOR OVAL POOL ONLY

**Installing oval cover.**

Put oval cover to the top of top seat secure with two #12 Sheet Metal Screw.

