

ESRW-19F-HC ENHANCED REACH-IN FREEZER, SOLID 1-DOOR

Model # ESRW-19F-HC

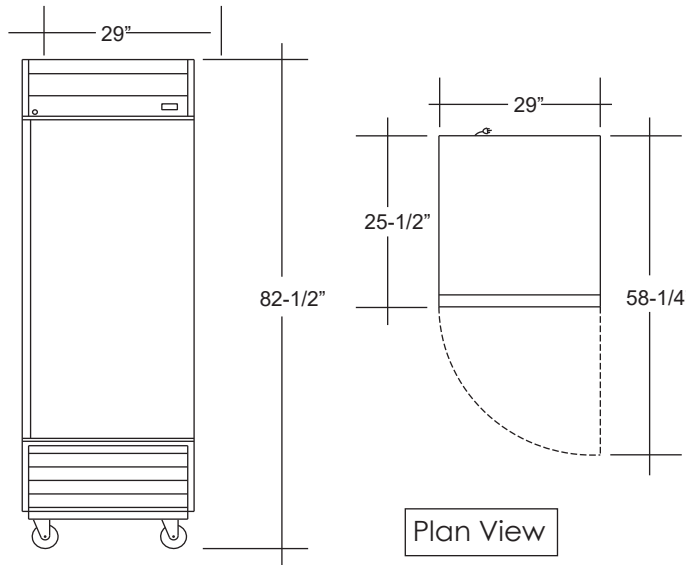

Item # ESRW-19F-HC Qty: _____
 Project: _____
 Date: _____
 Approval: _____



Technical Data

Width	29 Inches
Height	82 1/2 Inches
Depth	25 1/2 Inches
Temperature	-8 F- 0 F Degrees
Cabinet Capacity	19 cu.ft.
Casters	Heavy-duty w/brakes
Exterior Sides	Stainless Steel w/ aluminum back
Amps	4.3 Amps
HP	1/4+
Installation Board	Removable
Interior	Bright white aluminum
Door Type	Solid
Hinge Location	Right
Weight	356 lbs
Shelves	3 Shelve
Plug Type	NEMA 5-15P
Refrigerant Type	Hydrocarbon R-290
Voltage	115/60/1
Type	Freezer

Specifications subject to change without notice*

Features

- **Stainless steel door** and exterior sides, aluminum back. Bright aluminum interior.
- **Refrigeration system** keep food at safe temperatures.
- **Pre-installed heavy duty casters with brakes.**
- **Self -Closing door** with 90 degree stay-open feature. Locks and Keys included.
- **Shelves:** Adjustable heavy-duty PVC coated.
- **Electronic control system** makes it easy to adjust temperature set point and defrost frequency.
- **Removable installation board** makes it easy to access condenser coil for cleaning and service.
- **These units use HYDRO-CARBON R290 refrigerant,** which is environmentally friendly and more efficient than R134a/R404a refrigerant.

Certifications



Warranty

5 Year Compressor
 2 Year Parts and Labor

WARNING: This product can expose you to chemicals including lead, which are known to the State of California to cause cancer, birth defects, or other reproductive harm. For more information, go to www.p65warnings.ca.gov.

Email: customerservice@enhancedequipment.com

© 2022 ENHANCED EQUIPMENT

ENHANCED REFRIGERATION

2610 E. Woodward Ave.
 Fresno, CA 93721

Phone:
 (720) 309-1902

