



www.layzeeliving.co.uk

*Timber Products, Ponds & Accessories
Assembly Instructions*

Contents

Introduction	3
Tools Required	3
Natural Timber Characteristics	4
Storage & Delivery Recommendations	5
Safety Precautions	5

Square Ponds & Rectangular Ponds	7
-------------------------------------	---

Octagonal Ponds & Stretched Octagonal Ponds	15
--	----

Filtration Box	29
----------------	----

Filtration Planks	41
-------------------	----

Introduction

Congratulations on your new purchase! We hope it provides you with many years of happiness in the garden.

This product has been treated with ACQ, which is child friendly and warrantied against rot and insect attack (10 year warranty on 44mm wood and 5 year warranty on 27mm wood).

Please remember timber is a natural product and can be prone to expanding, shrinking and natural defects. Please see page 4 for more information.

After receiving your timber product we advise that you unpack and assemble it at the earliest opportunity.

Wood is a living material and once cut the appearance of cracks, slight movements or changes in colour are normal and the planks (except in extreme circumstances) do not need replacing. The planks will have been recently treated and may be delivered to you still moist. In the event of a rapid change in temperature these planks can dry very quickly and lose 1mm or 2mm of height. This might give the impression that they are lifting up however they are actually shrinking.

This product is heavy and some components may require two persons to lift.

At every point of manufacturing this product, care has been taken to provide quality and satisfaction to our customers. If any part of this kit is missing or damaged you must contact us before proceeding with assembly of this product.

Tools Required

- Cordless screwdriver with a No 2 pozidrive bit
- 3mm drill bit to suit wood/plastic
- Saw to cut plastic linerlock
- Knocking block (supplied if more than standard height)
- Tape measure
- Sharp scissors
- Hammer
- Pencil
- Square
- Safety goggles



Natural Timber Characteristics

Whilst we try to ensure that our timber products reach you in perfect condition, we have to remember we are dealing with a natural material and there are many characteristics which can arise.

These are completely normal and have no detrimental effect on the product. We also manufacture our products so that most natural defects are inside the product where you will not see them. Or the plank may be reversible, so it can be used either way around.



Shake appears like a series of splits. With a timber section of this size you will always encounter some degree of this (usually on one side). This does not affect the strength of the product and you will find the shake opens in continued warm weather and then closes up when the weather is wet and cooler or there is a lot of moisture in the air.



Pith is similar to the above defect and quite often found along side each other. Most of this is typically machined to be on the inside of the product.



Knots are typically found in timber as shown. These are not generally an issue and can actually be beneficial relieving stress points in timber. In many peoples opinion these add character to the products.

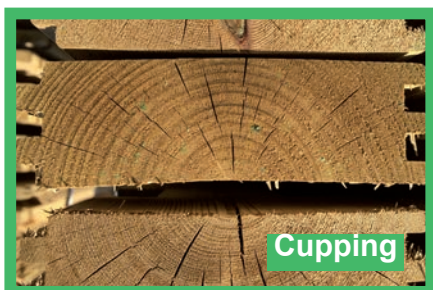

Cupping is mainly caused by the treatment of the timber. Where timber is kiln dried and then pressure treated it can cause cupping. Although we do limit this, the best way for you to counteract is, as you build the walls of your product, have one plank with the growth rings facing one way and the next with the rings facing the opposite way (counter cupping). This is only possible on square or rectangular products as the planks are reversible. On octagonal products if you have a problematic plank try it in another wall position to see where it will fit best.



Recommendations for Storage and Delivery

Please take time to read these instructions prior to installing your product. This will help you understand the product and prevent mistakes being made.

In the pre-assembly period the wood is sensitive to variations in temperature and humidity. It is therefore necessary that you take the following precautions immediately after delivery.

Wood is a living material and once cut the appearance of cracks, slight movements or changes in colour are normal and the planks (except in extreme circumstances) do not need replacing.

- Do not store the wood in direct sunlight or under a black cover as this will cause distortion which will make installation extremely difficult.
- Assemble the structure as soon as possible after receipt.
- Assemble the structure in one go, preferably in the morning while the temperature is cool.
- The planks will have been recently treated and may be delivered to you still moist. In case of a rapid change in temperature these planks can dry very rapidly and lose 1 or 2mm of height. This might give you the impression that they are lifting up while they are actually shrinking. Whilst in cooler wet conditions the wood may expand back to its original size. This is completely normal.
- If the product must be stored then use a cool well ventilated place, sheltered from sun and rain.
- Components that are damaged, cracked or distorted due to bad storage and/or handling on site are not covered by warranty.

Kit Contents

As you unpack your product make sure that you have all parts required and that their condition is satisfactory.

Contact your dealer if you believe parts are missing or damaged.

Safety Precautions

Use safety goggles during installation to reduce risk of eye injury.
Gloves should be worn to protect fingers.

At every point of manufacturing this product, care has been taken to provide quality and satisfaction to our customers. If any part of this kit is missing or damaged then you must contact our support team on **0800 043 0880** before proceeding with assembly of this product.



RISK OF DROWNING

Never leave children unattended around the pond when completed or at any stage of construction.

Total or Partial in-ground installation

These timber products can be installed above ground, partially in or fully in ground. However, if you do have your product fully or partially in ground you will need to ensure that there is adequate drainage so that the timbers are not to be permanently submerged in water. Use an adequate amount of pea beach around the structure if possible, with a run off to a soak away or similar, so that water cannot build up around the structure and rot the timbers. If an adequate amount of drainage in the form of pea shingle or similar has not been used, this may affect the warranty.

This product has been treated with ACQ which is child play friendly and is warranted against rot and insect attack (10 years on 44mm wood and 5 years on 27mm wood).

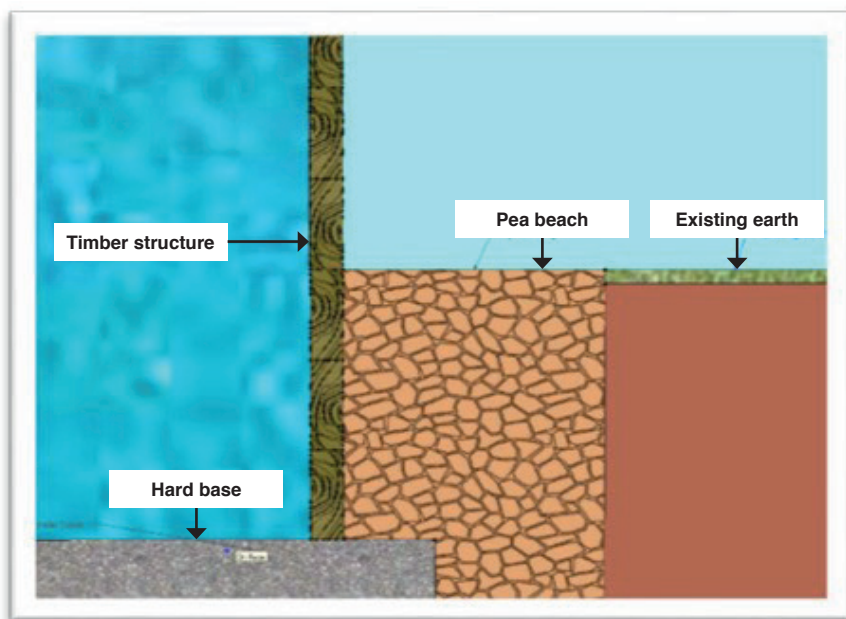

However, if this product is being installed completely or partially below ground level, you will need to install adequate drainage around the product. We recommend 300- 450mm width of pea shingle, all the way around the product. Never use a plastic membrane around the outside of product as this will accelerate any deterioration of a timber product.

The timbers are treated for ground contact only and are not to be submerged permanently

in water. Please also note that any modification to a wooden structure including drilling or cutting of a wall plank will void the warranty on any plank which is affected. As a precaution if you do require to modify a plank, we suggest that you treat the cut area with a good quality timber preservative if below ground level. Ensure any treatment does not come into contact with the liner.

Square Ponds and Rectangular Ponds Assembly Instructions



1



- Note the four different profiles used for building the structure walls. These will be a single tongue and groove profile for 27mm products.

2

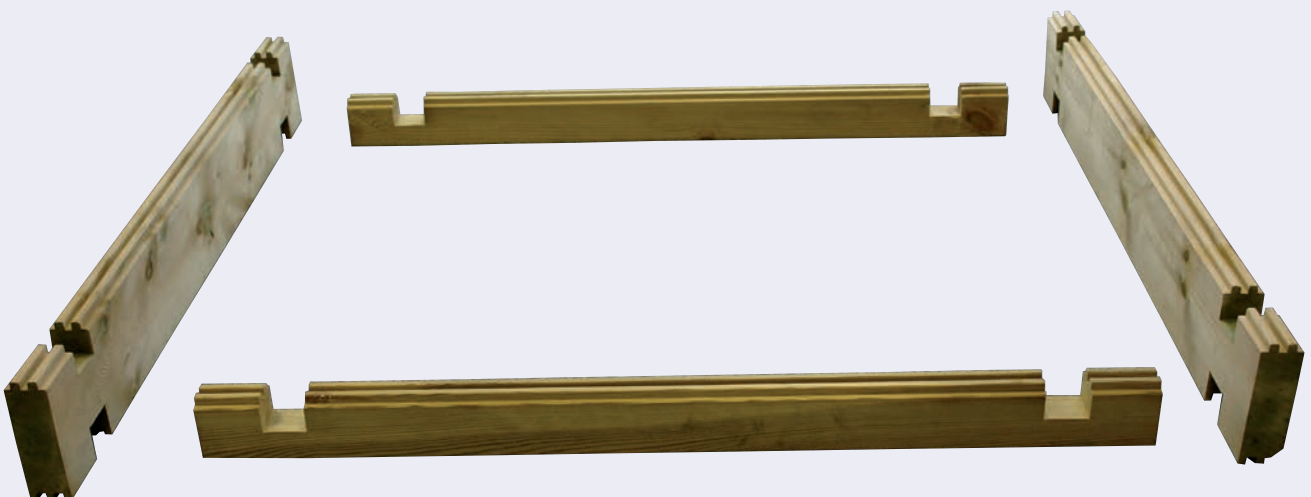

- Lay out the “bottom half planks” (a narrow timber with a flat bottom and tongues on top).

3



- Then using “standard planks” (a wide timber with tongues and grooves) interlock the timbers using the cut out notches.
- You should now have the correct shape and base of your walls set out.

4



- Add the next layer of “standard planks” as demonstrated above. Make sure each plank locates at both ends in a level manner. Failure to do this can result in damage to the plank ends.
- Ensure the tongues and grooves are located properly before using the knocking block and mallet to secure in place.

5



- Build up the walls using all your standard planks.
- The second to last planks used are the top full planks (two grooves on the bottom and a flat top).

6



- Finally you can add the top half planks.
- Once all the wall sections are in place tap the walls down so that everything interlocks together properly. Use the knocking block to hit with the mallet so you do not damage the product.

7

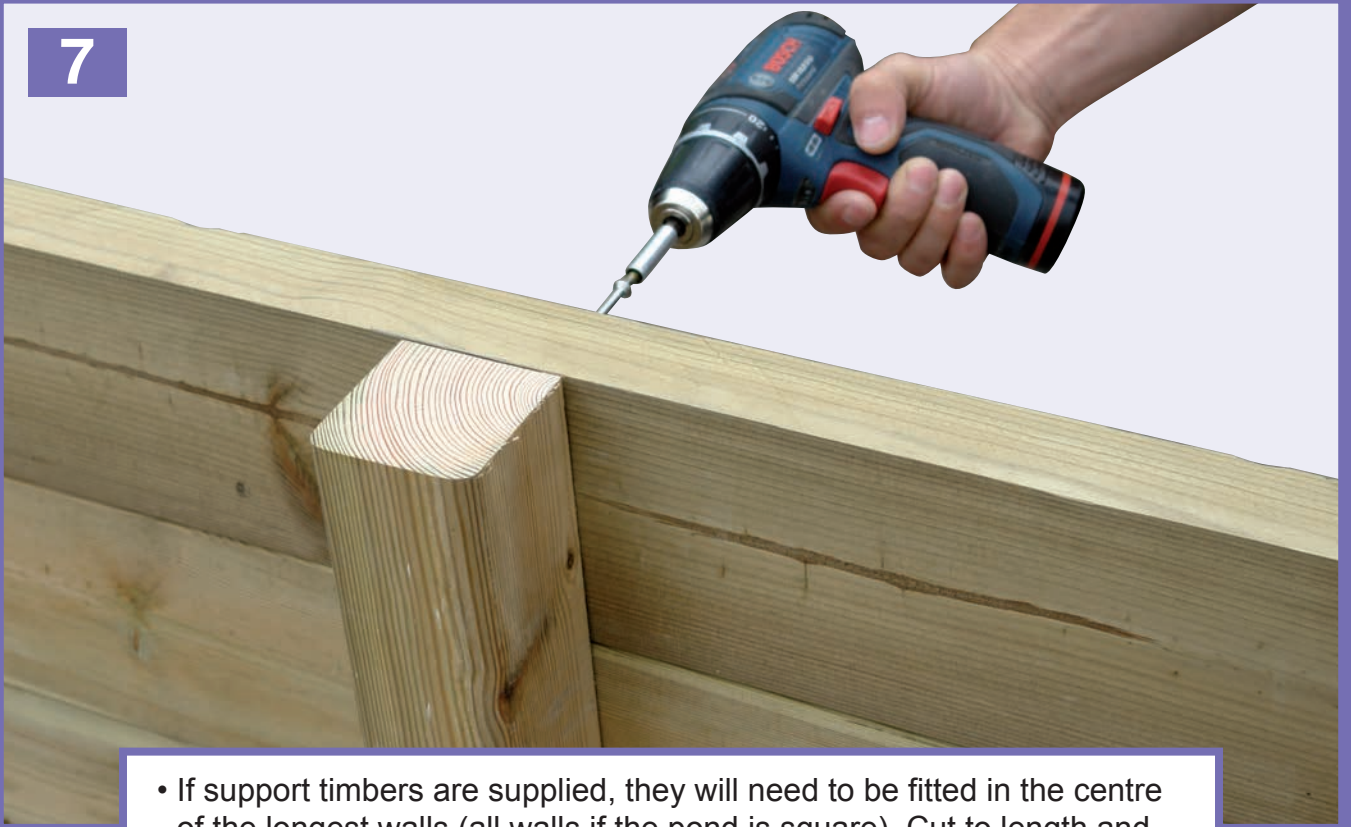

- If support timbers are supplied, they will need to be fitted in the centre of the longest walls (all walls if the pond is square). Cut to length and fix in place using the stainless steel screws provided.

8



- Carefully mark the pond linerlock to suit the inner dimensions of your pond and cut to length.

9



- Drill 3mm holes in the linerlock. Space the holes no more than 300mm apart.

10

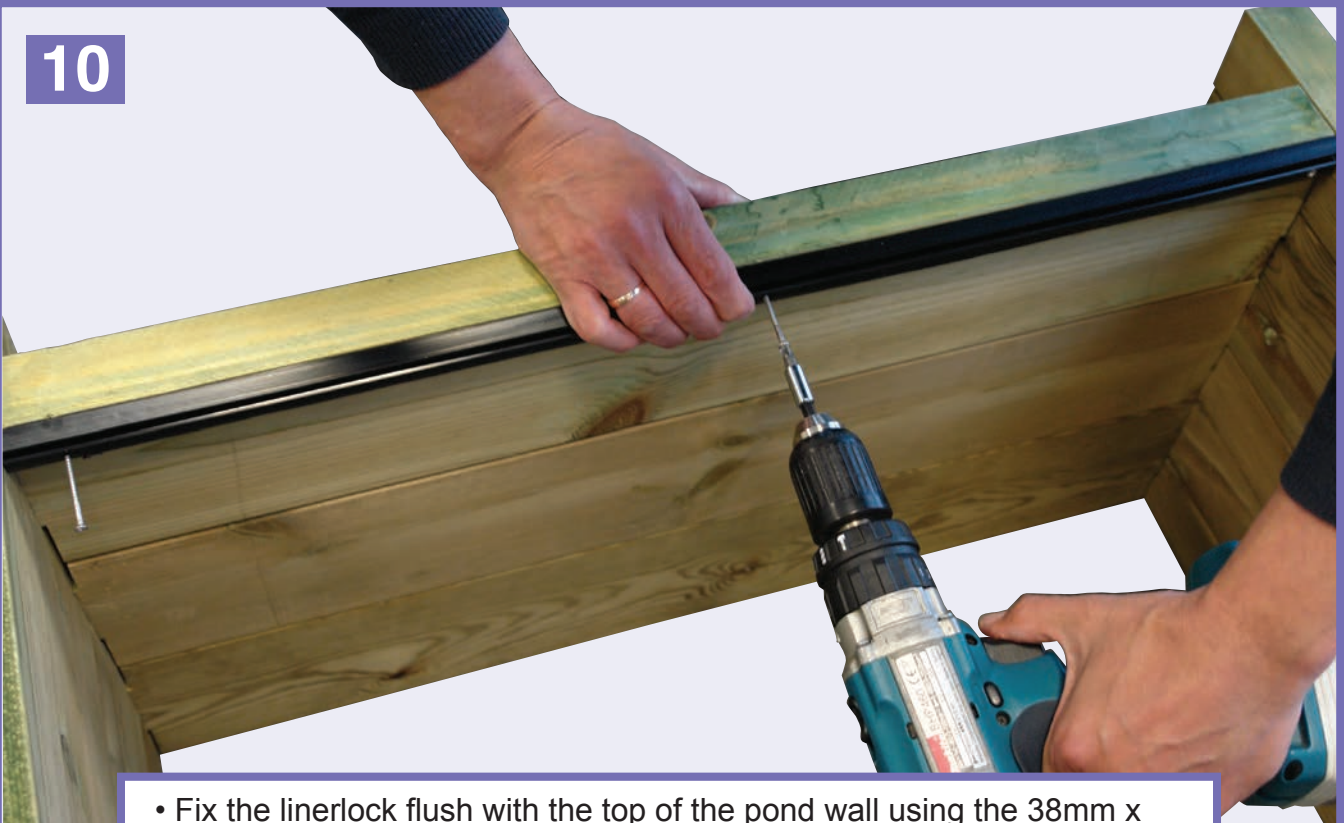

- Fix the linerlock flush with the top of the pond wall using the 38mm x 3.5mm stainless steel screws provided.

11

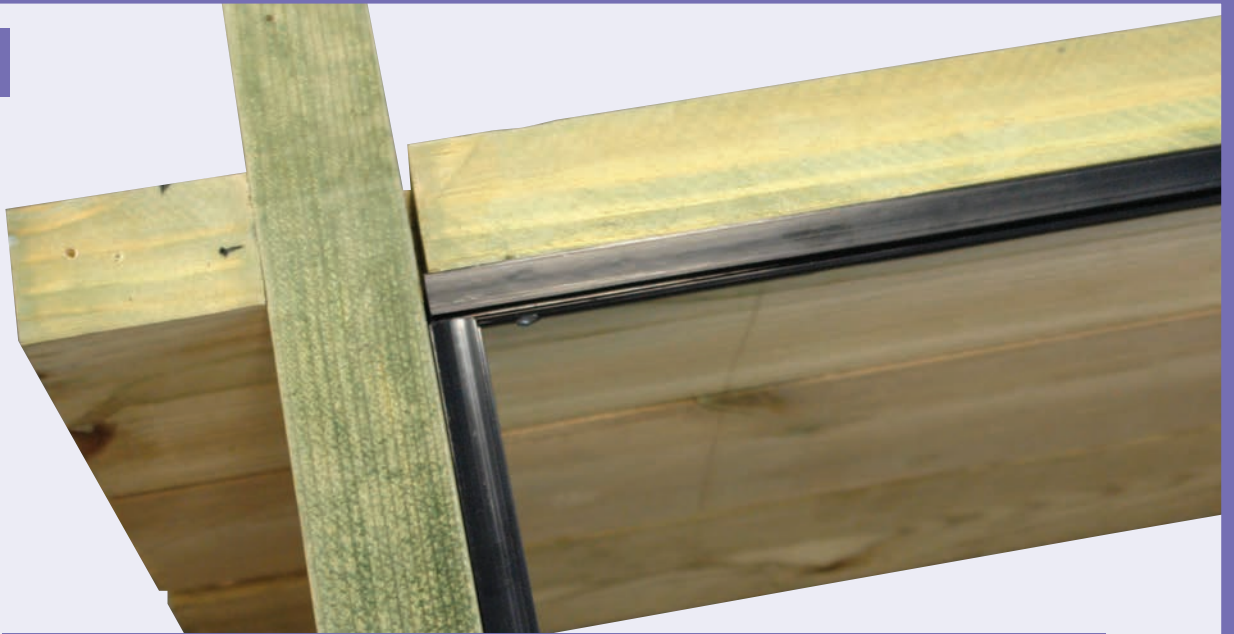

- The pond linerlock should look like this when fitted.
- Ensure the groove in the linerlock lines up where it joins.
- Before fitting the liner, ensure all vegetation and any sharp objects like stones etc are removed. We advise using an old piece of carpet or a layer of sand to cover the ground before installing the liner.

12

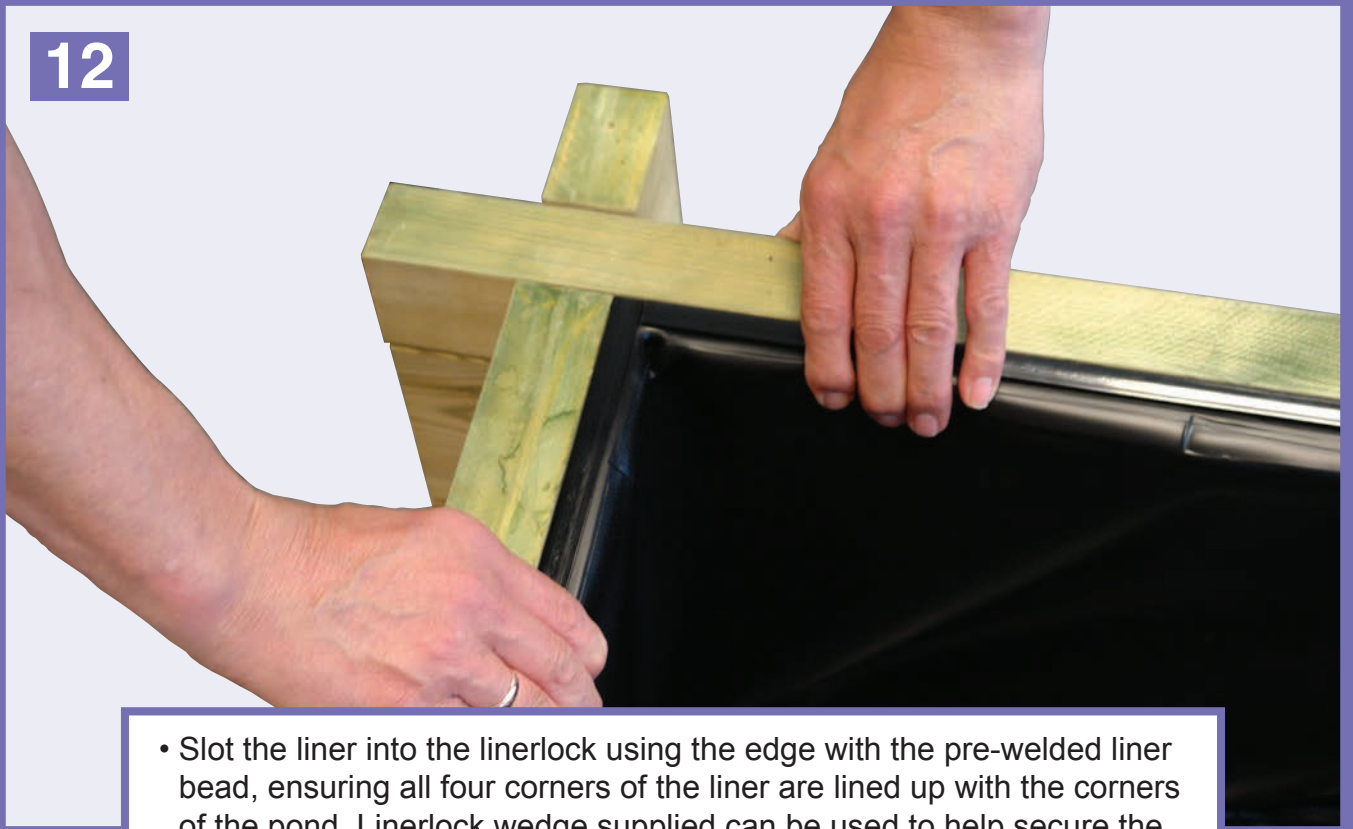

- Slot the liner into the linerlock using the edge with the pre-welded liner bead, ensuring all four corners of the liner are lined up with the corners of the pond. Linerlock wedge supplied can be used to help secure the liner once fitted.

13

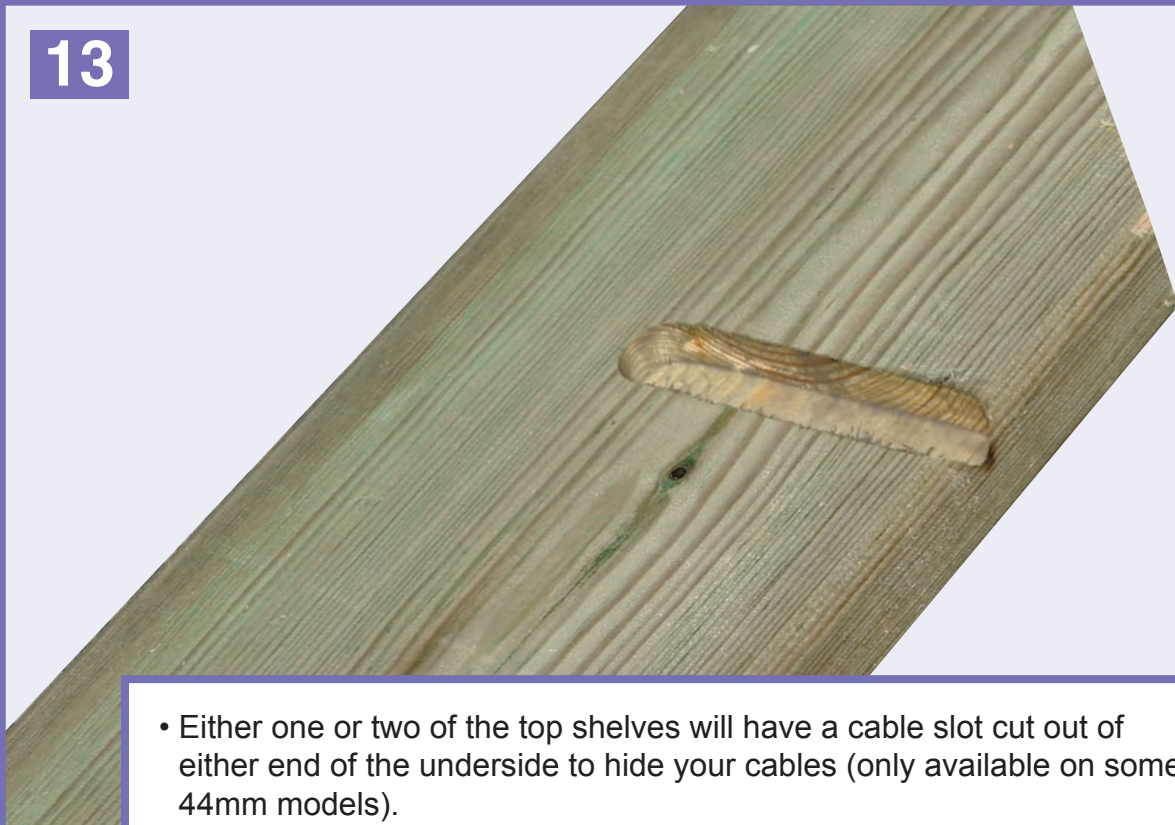

- Either one or two of the top shelves will have a cable slot cut out of either end of the underside to hide your cables (only available on some 44mm models).
- Ensure you disconnect any electrical items to prevent risk of electric shock.

14

Fixing Points
at centre of wall

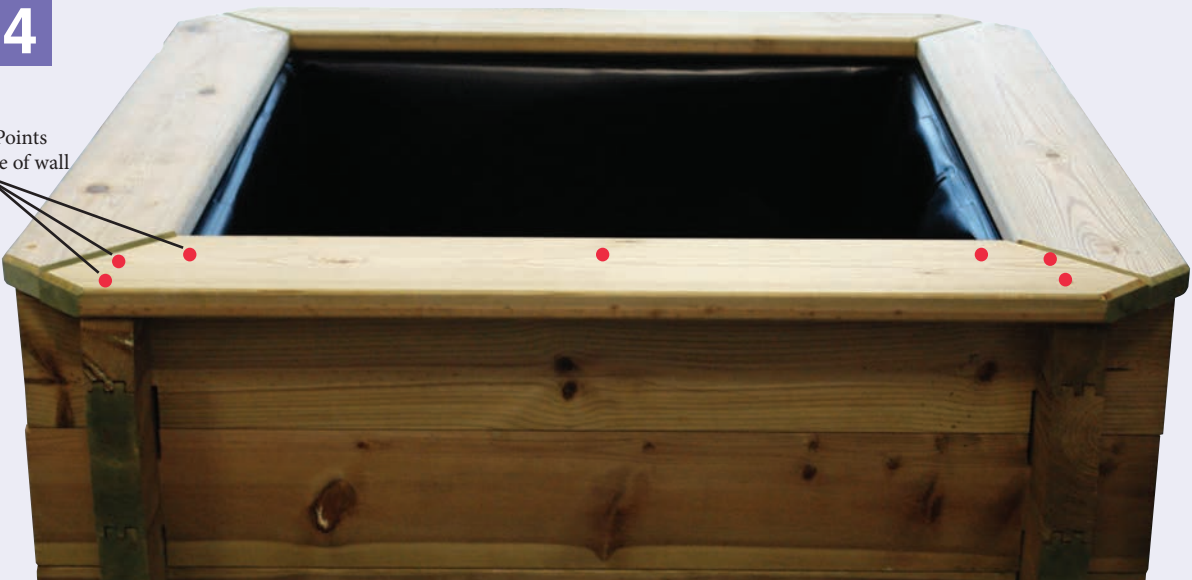

- There are pre-marked screw positions on some models, care is needed to avoid damaging any electrical cables.
- Take your time to position the top shelving evenly.
- Carefully fix in place using the 50mm screws provided, being careful not to pierce the liner. Use all the fixings provided making sure you fix into the corners of the top shelving as shown.

Octagonal & Stretched Octagonal Ponds Assembly Instructions



Preparation of the Base

OPTION I: Subsoil Base

- Although the recommended base is concrete (see Option II below) you may choose to construct your pool on undisturbed ground. You must satisfy yourself that your site conditions are suitable. If your site is wet and prone to ground water or flooding then use a concrete base.
- Never construct your pool on made up ground, always dig down to undisturbed soil.
- Clear an area at least the size of the pond.
- Ensure that the cleared area is flat, level and smooth and that all vegetation has been removed.
- Ensure that all stones, sharp objects and roots are removed. Failure to prepare the ground may result in a damaged liner. Any damage caused to the liner (other than manufacturing defect) is excluded from any warranty.



Prepare the ground

OPTION II: Concrete Base

- The recommended minimum base is a 100mm (4") thick concrete pad. Using a steel reinforcing grid in the concrete will greatly increase its strength and is recommended. Every site is different so give due consideration to increasing this specification if you have unstable ground or any other concerns. If in doubt seek the advice of a Ground Working Contractor or a Civil Engineer.
- Never construct your pond on made up ground, always dig down to undisturbed subsoil.
- The minimum size concrete base needs to be approximately 300mm larger than the outside dimension of the pond walls.
- Ensure that your finished concrete is absolutely level over the whole pond area. If your base is not level the water level will show this after filling.
- Ensure that your finished concrete is completely flat over the whole pond area.
- Ensure that your finished concrete is absolutely smooth. Rough concrete can damage the pond liner.
- Allow your concrete to cure before assembling your pool.

1



- Note the four different profiles used for building the structure walls (these will be a single tongue and groove for 27mm products).

2



- Find the 4 bottom half planks that have a flat under side and two tongues facing upwards. Place these flat side down.
- Now use 4 standard planks to form the first layer of the pond walls. The 45 degree interlocking slot at each plank end forms the shape of your pond. Check the pond is square by measuring the diagonals.

3

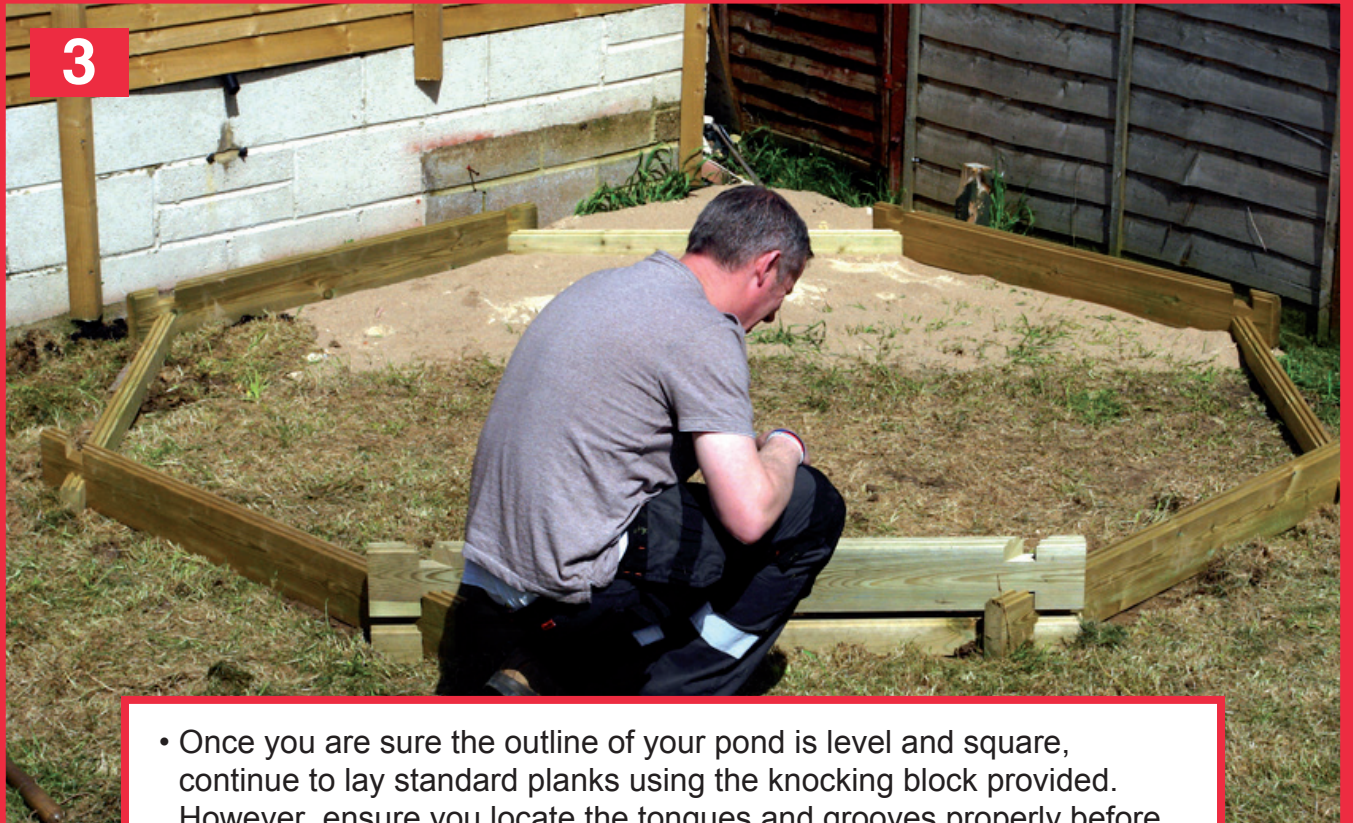

- Once you are sure the outline of your pond is level and square, continue to lay standard planks using the knocking block provided. However, ensure you locate the tongues and grooves properly before knocking the plank fully in.

4



- It is easier to place your planks in the middle of the pond, working your way around the walls one layer at a time. Ensure you locate the planks properly using the knocking block.
- Work around the pond, 4 planks at a time.

5



- If you struggle to locate a plank properly try swapping it with another one and move the problematic plank to another location where it may be a better fit.
- Ensure all planks are located properly.

6



- The second to last planks to fit on the walls are the top full planks (see picture on page 17). There are 4 of these.

7



- The last planks to fit are the four top half planks. Avoid hitting half planks over the notched area with your mallet/hammer as these are the weakest points.

8

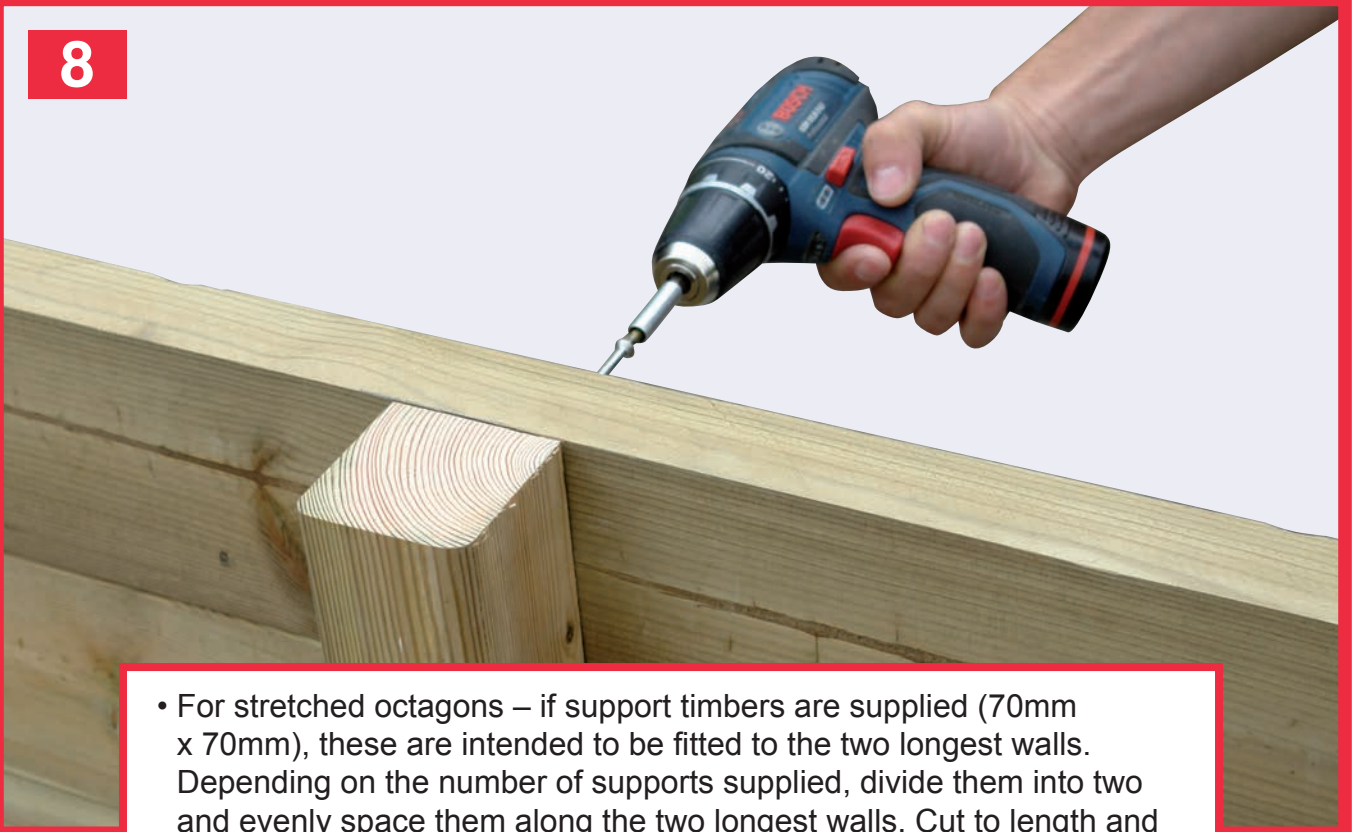

- For stretched octagons – if support timbers are supplied (70mm x 70mm), these are intended to be fitted to the two longest walls. Depending on the number of supports supplied, divide them into two and evenly space them along the two longest walls. Cut to length and fix in place using the stainless steel screws provided.

9

27mm Thickness Models Only



Top view of Shelving Support in place

At this stage you need to fit 8x top shelving supports. You may need to trim these to fit using a hand saw.

If your pond is smaller than 6ft octagonal, you will not need shelving supports.



Fitting the Shelving Support

Fit from inside of pond using Stainless Steel Screws provided. 5x 70mm approx.

10



- If you are installing the stretched 12'x 8' model and it is sitting directly on a concrete plinth then use these brackets (two on each side) to pin the bottom of the long walls. (Use fixings provided.) This limits any bowing. If it is going to be partially or fully submerged there is no need to use these.

11



- You can mitre the Linerlock at each corner of the pool, but this is not essential as it will not be seen once the liner is installed. You can cut a straight edge and butt the two pieces of Linerlock together. The important factor is that the groove in the linerlock is in line when joined.

12



- Use a 3mm drill bit to pre-drill the Linerlock at approximately every 300mm. This makes fitting the Linerlock easier.

13



- Fix in place using the stainless steel screws provided (38mm x 3.5mm). Ensure the Linerlock is flush around the top of the pond and that the slots on the front of the Linerlock line up with each other where they join.

14

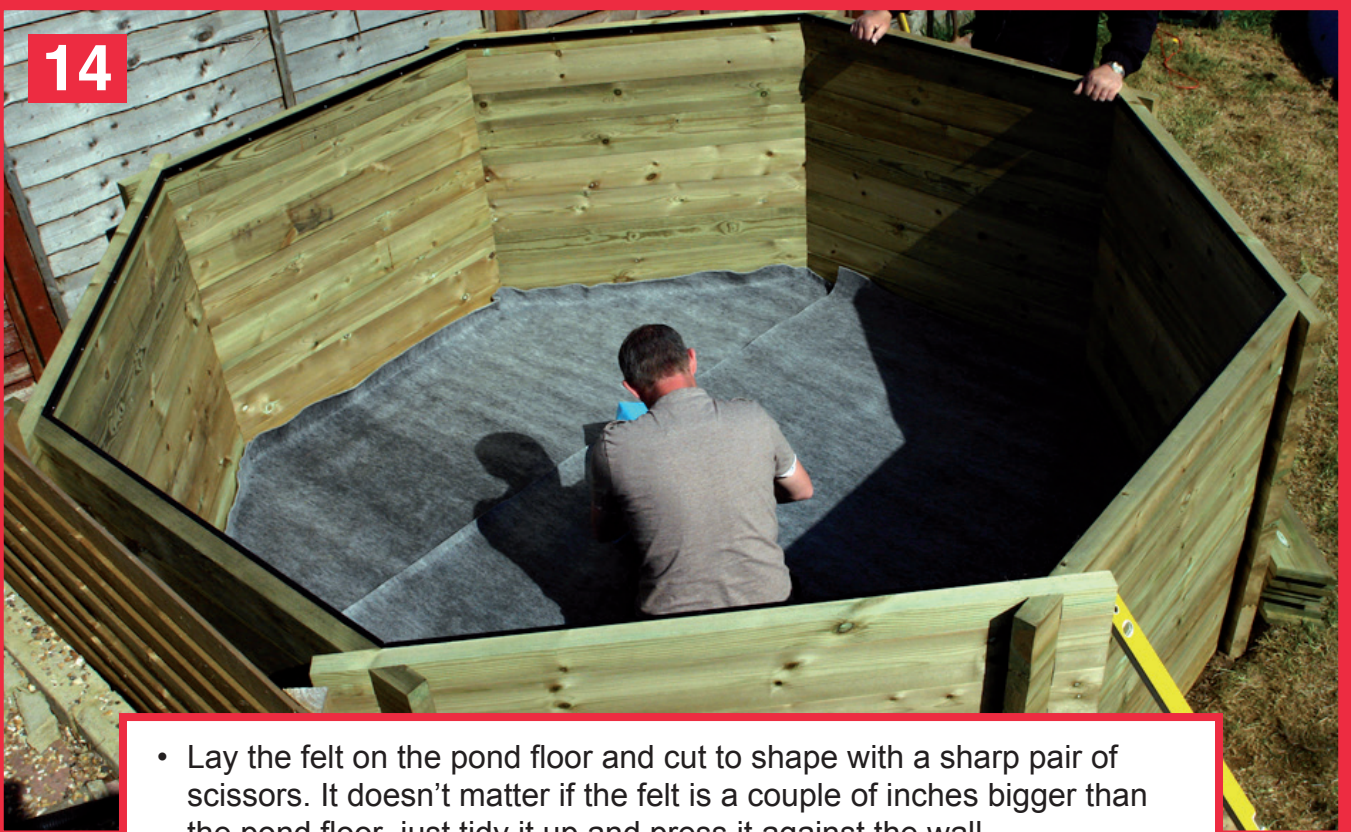

- Lay the felt on the pond floor and cut to shape with a sharp pair of scissors. It doesn't matter if the felt is a couple of inches bigger than the pond floor, just tidy it up and press it against the wall.
- Remove your shoes for the next stage.

15



- Tip: hang the liner on a warm day as the material becomes more flexible and takes less time for any creases to come out.
- Unwrap the liner in the pool on top of the felt, start in a corner of the pond, making sure the corner of the liner and pond line up.
- Start inserting the linerbead edge of the liner into the liner lock.

16

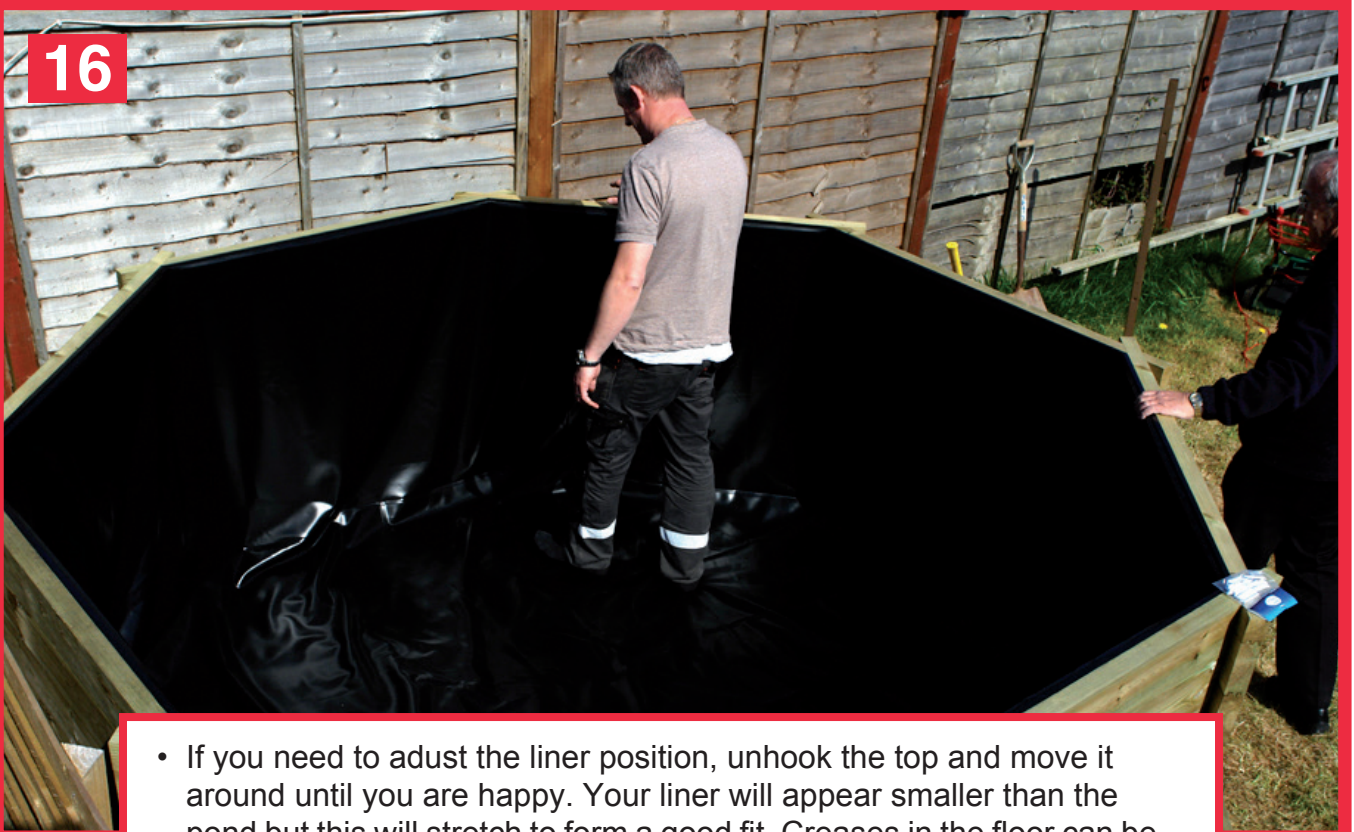

- If you need to adjust the liner position, unhook the top and move it around until you are happy. Your liner will appear smaller than the pond but this will stretch to form a good fit. Creases in the floor can be smoothed out with your feet from the centre to the outside walls.

17



- To secure your liner use the length of black Linerlock wedge supplied.
- Work your way around the pond pushing in the linerlock with your thumbs to secure the liner in place. (Image shows two small white sections of Linerlock wedge for demonstration purposes.)

18



- Take your time to locate the top shelving around the pond. Make sure you have an even overhang over the Linerlock and the outside of the walls.

19

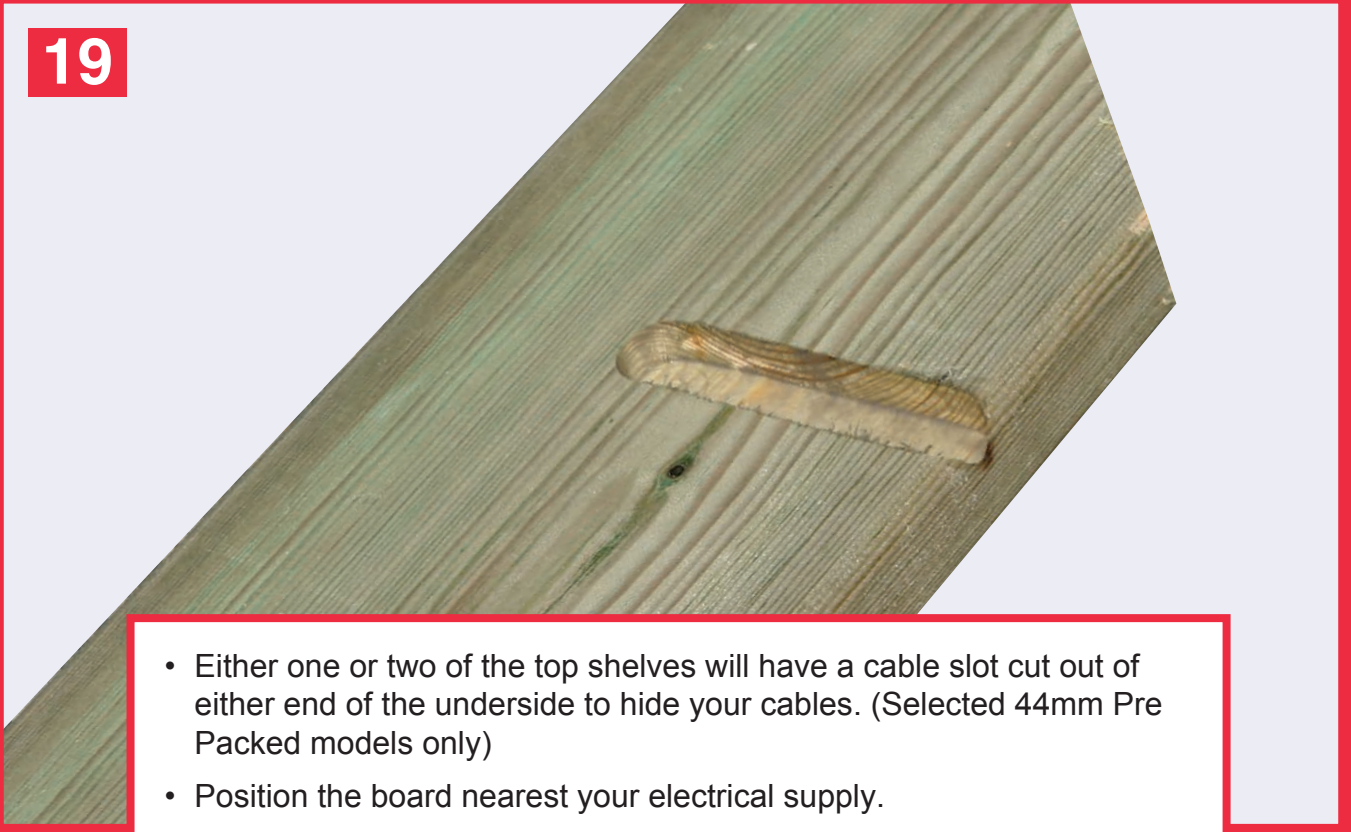

- Either one or two of the top shelves will have a cable slot cut out of either end of the underside to hide your cables. (Selected 44mm Pre Packed models only)
- Position the board nearest your electrical supply.



- At this point ensure you disconnect any electrical items to prevent risk of electric shock.

20

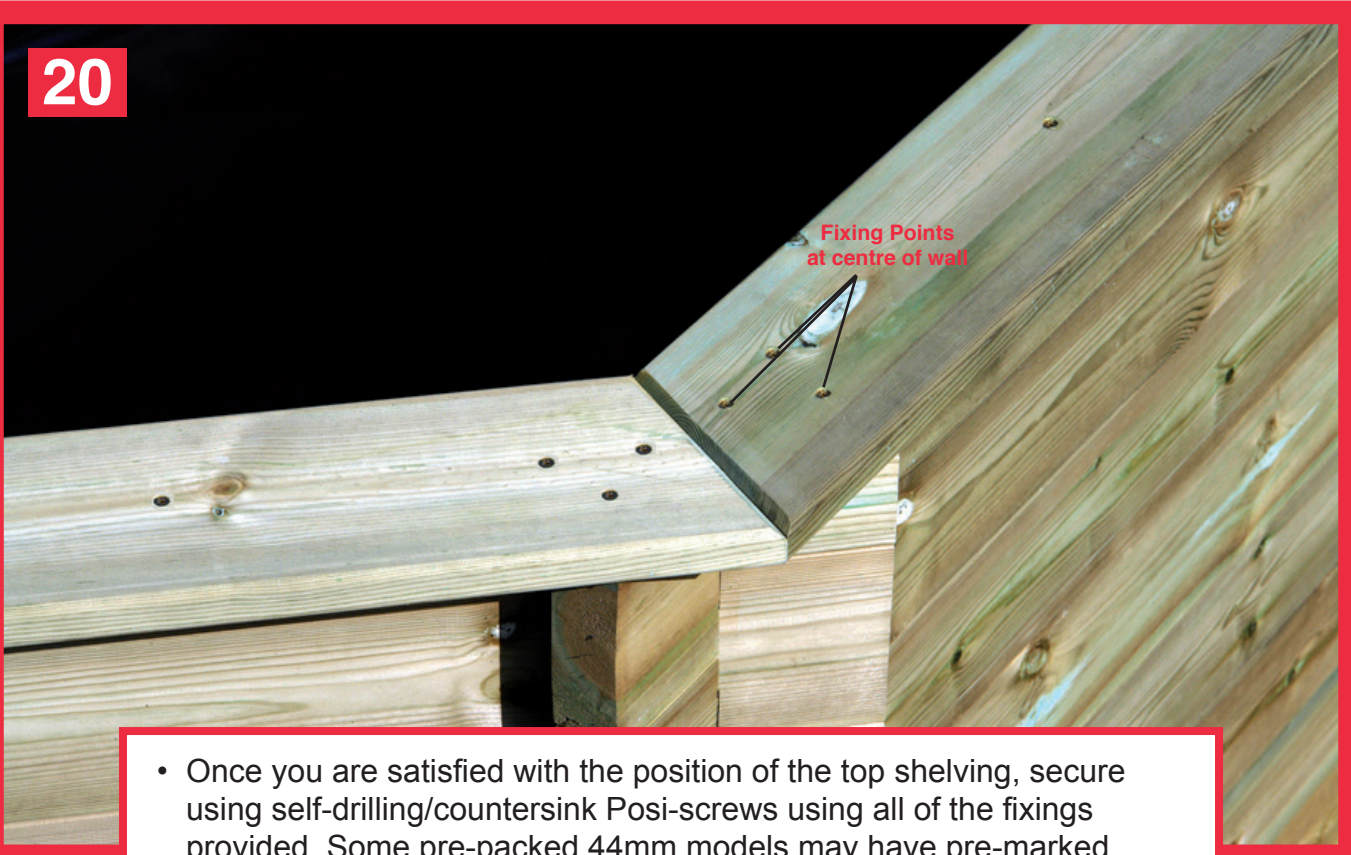

- Once you are satisfied with the position of the top shelving, secure using self-drilling/countersink Posi-screws using all of the fixings provided. Some pre-packed 44mm models may have pre-marked positions.

21

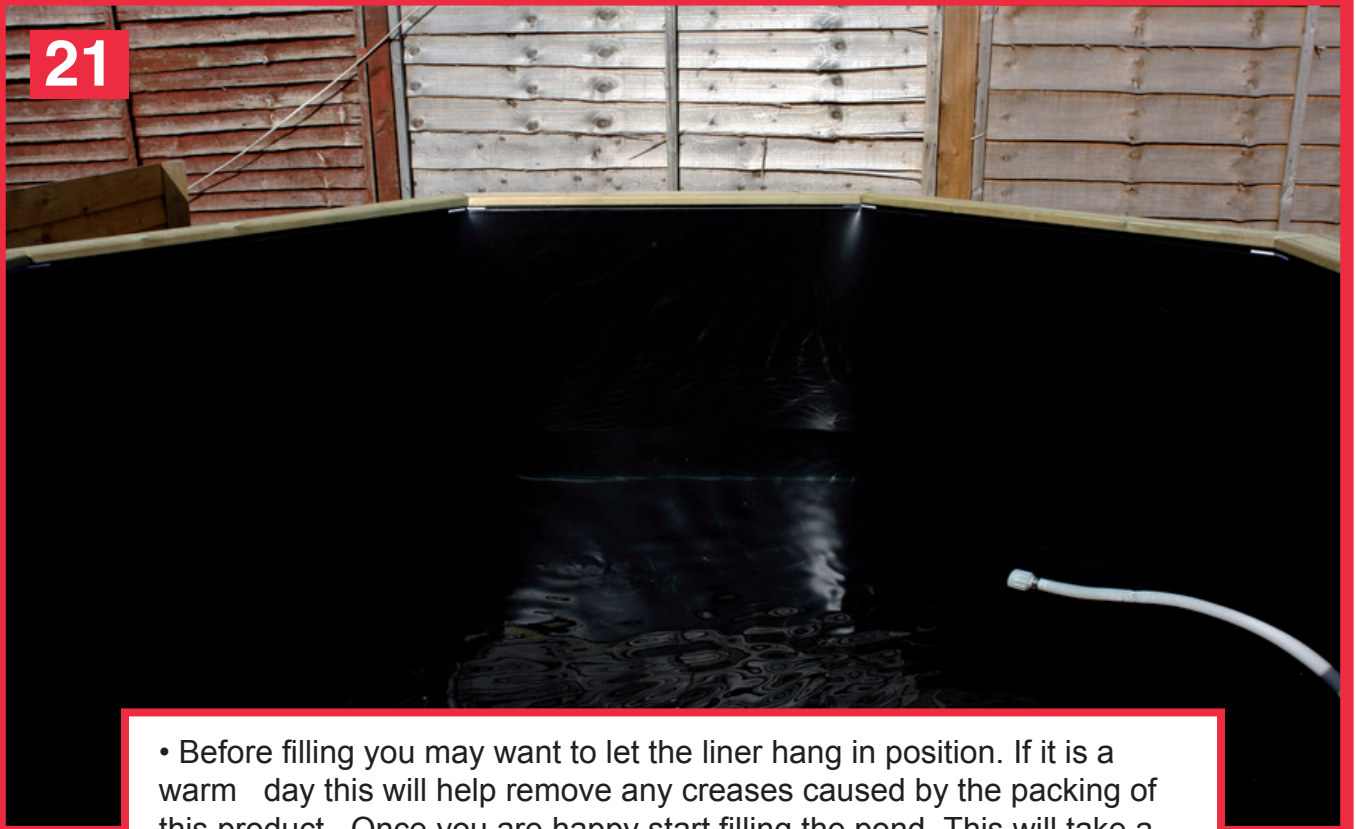

- Before filling you may want to let the liner hang in position. If it is a warm day this will help remove any creases caused by the packing of this product. Once you are happy start filling the pond. This will take a while.

22



- Please ensure you have adequate filtration for keeping koi or your chosen fish. It is also important that all the chlorine within tap water has dispersed before introducing any livestock. Please speak to your aquatics supplier should you be unsure.

GTCF100 Filter Box Assembly Instructions



1

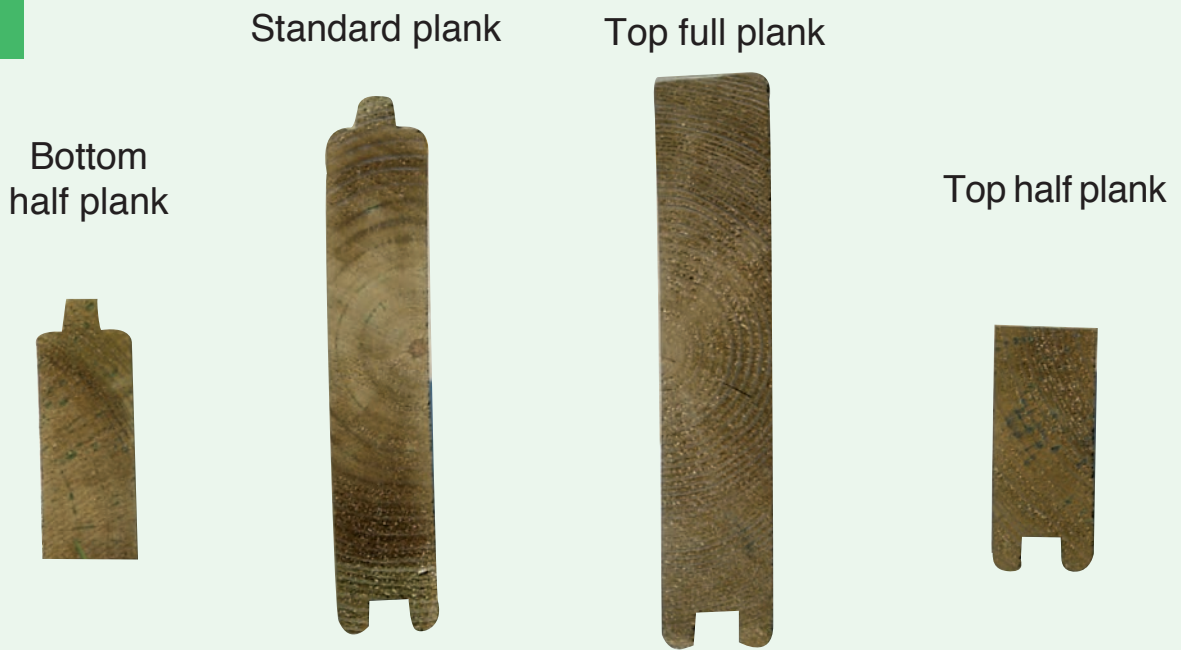

- Note the four different profiles used for building the structure walls.

2



- First step to building the filter box is to lay down the front bottom half plank, then interlock two sidewalls with standard planks.

3



- Continue to build up the walls using the front planks with two notches and the sidewall planks with one notch.

4



5



6



- Continue adding to the walls until you get to this stage.

7



- At this stage add the two short front wall planks to create an aperture for the front part of the hinged lid.

8



- The final sidewall planks used are top full planks.

9



- Finally add the two small front half planks on either side of the aperture to complete the wall height.
- Ensure your planks are firmly tapped down.

10



- At the pond end of the filter box, fix your 44mm x 20mm batten to each side wall. Screwing into the 20mm edge of the batten. 3 screws on each batten (top, middle and bottom).

11

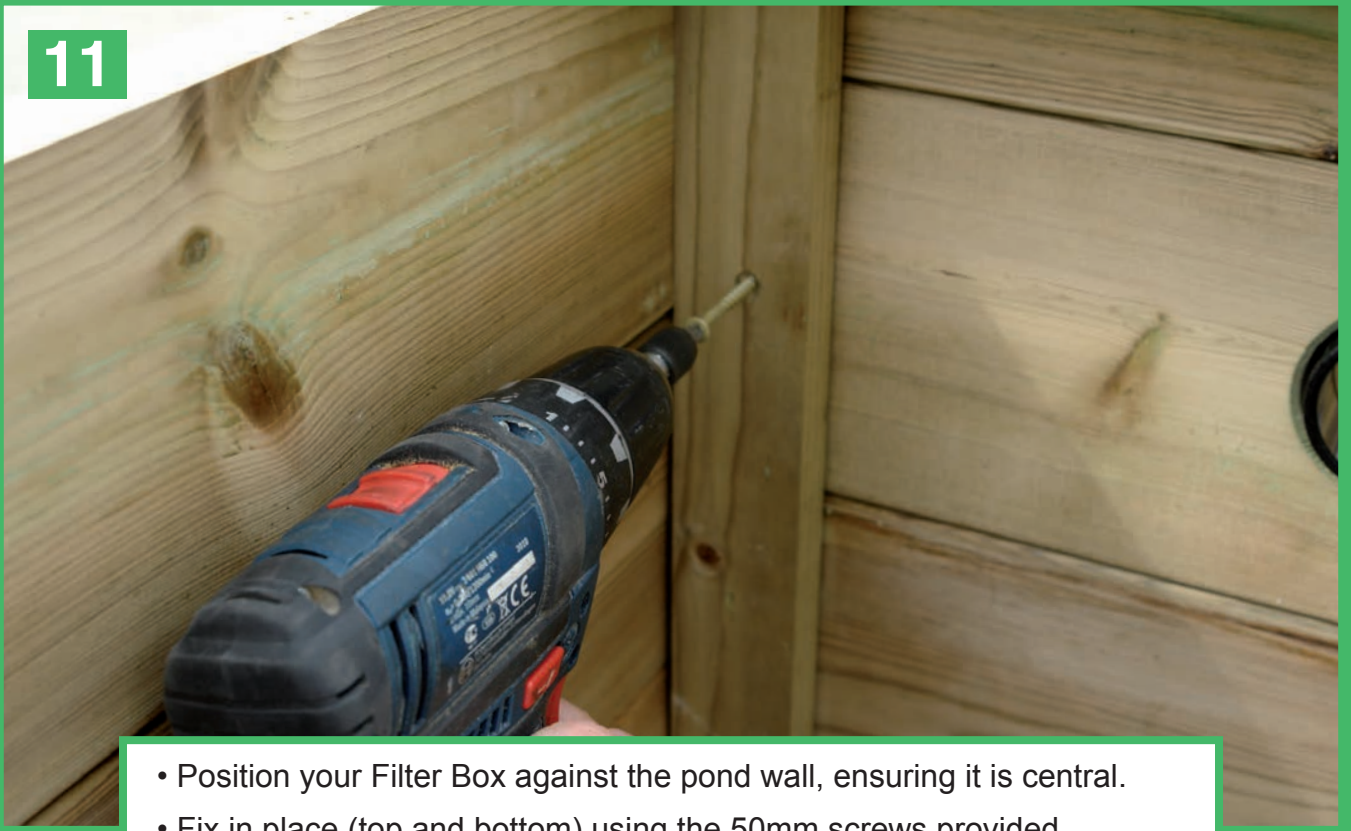

- Position your Filter Box against the pond wall, ensuring it is central.
- Fix in place (top and bottom) using the 50mm screws provided.
- Ensure the head of the screw goes no further than flush with the batten to prevent damage to your pond liner.

12



- This is a narrow lid fixing plank. Butt it up to the top shelving of your pond and fix in place centrally.

12b



- This is a full width plank if you wish to use this plank it will need to be cut to shape to suit the top shelving of your octagonal/square pond. You can either use a handsaw or a jigsaw.

12c

6ft Octagonal
model only

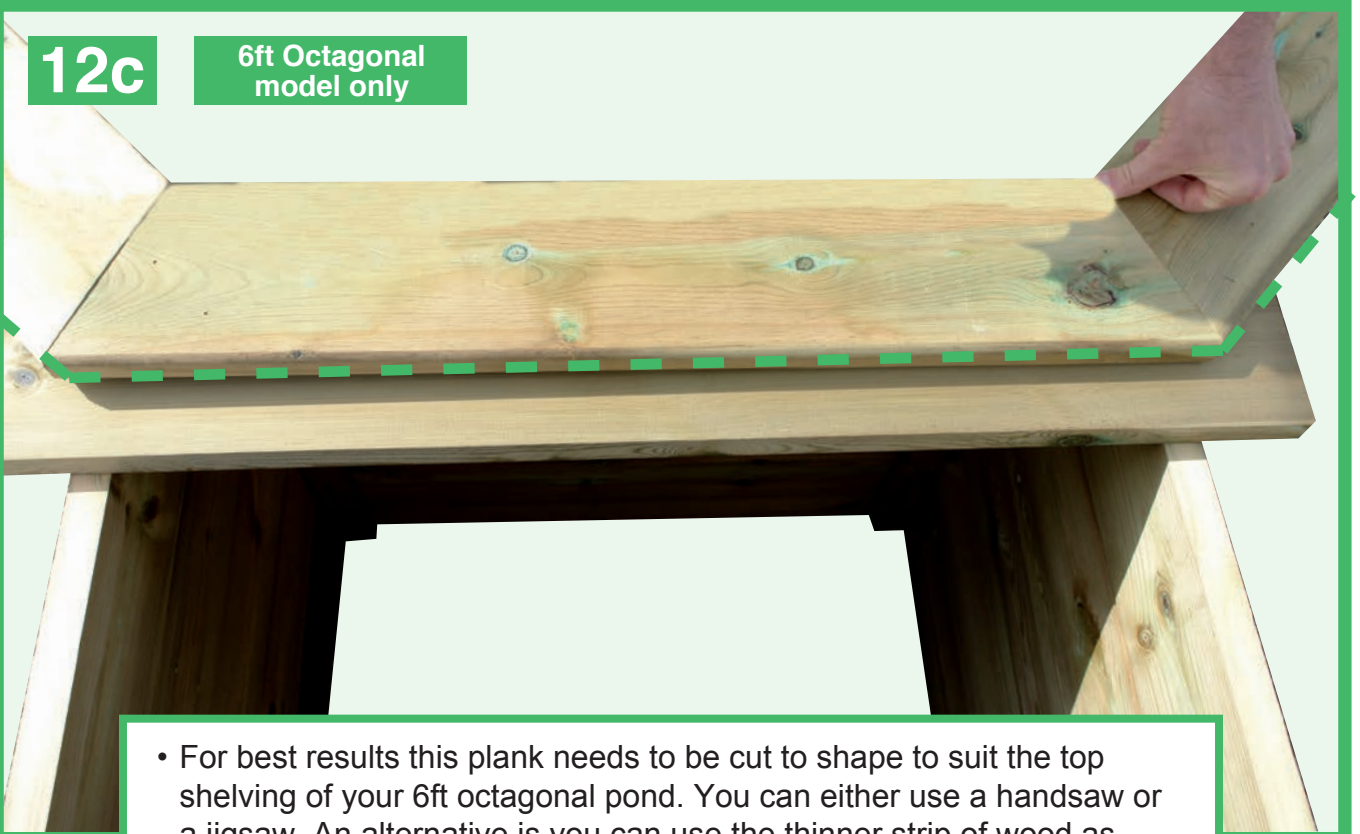

- For best results this plank needs to be cut to shape to suit the top shelving of your 6ft octagonal pond. You can either use a handsaw or a jigsaw. An alternative is you can use the thinner strip of wood as used for the square ponds (fig 12).

13



- Attach the three part lid system using hinges and 20mm screws provided.

14



- Position the two-part front door/lid section in to place (two-piece section fits together with batten).

15

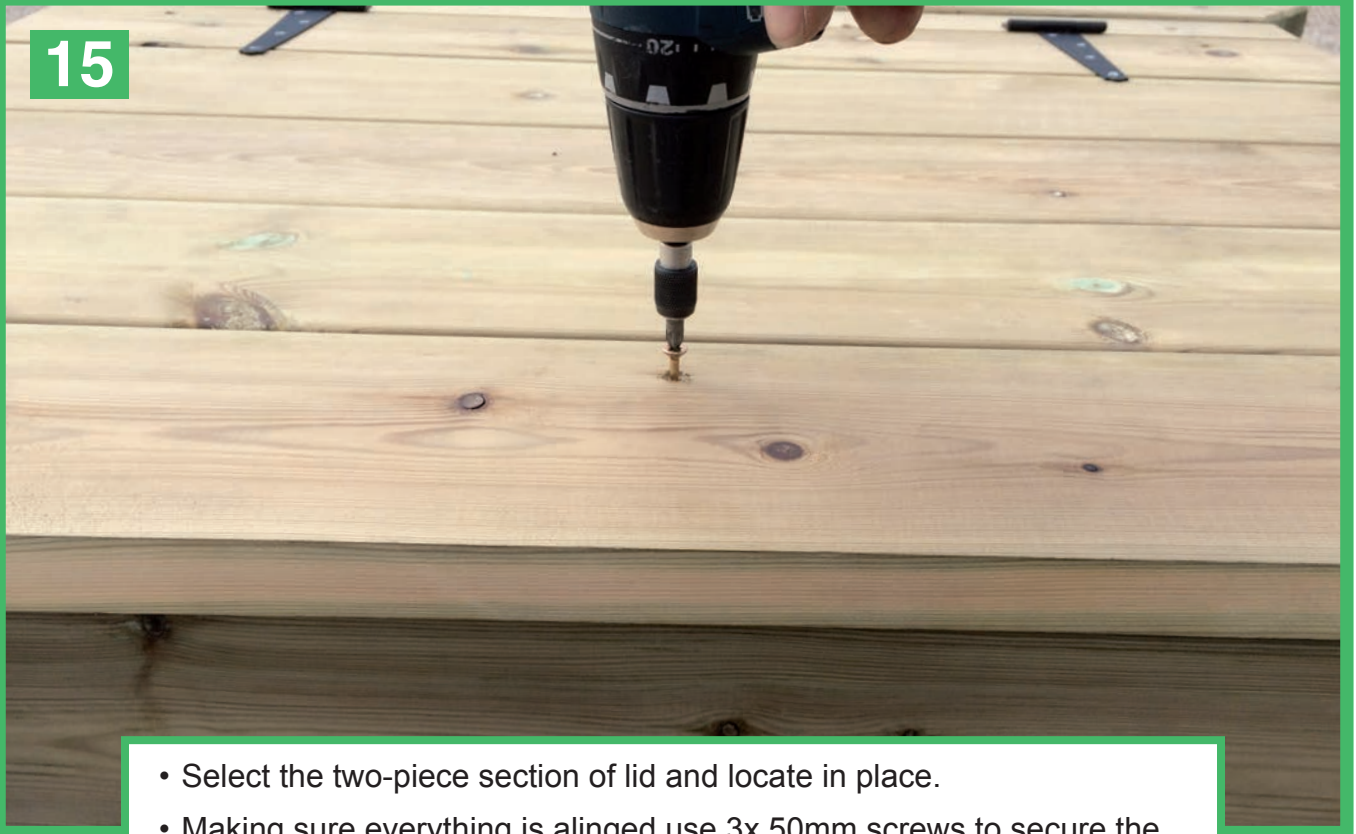

- Select the two-piece section of lid and locate in place.
- Making sure everything is aligned use 3x 50mm screws to secure the front lid to the front door.

16



- Secure front door/lid in place using hinges and 20mm screws provided. Make sure the bottom screw fixed into the front door goes into solid wood and not through the groove at the bottom of the door.

17

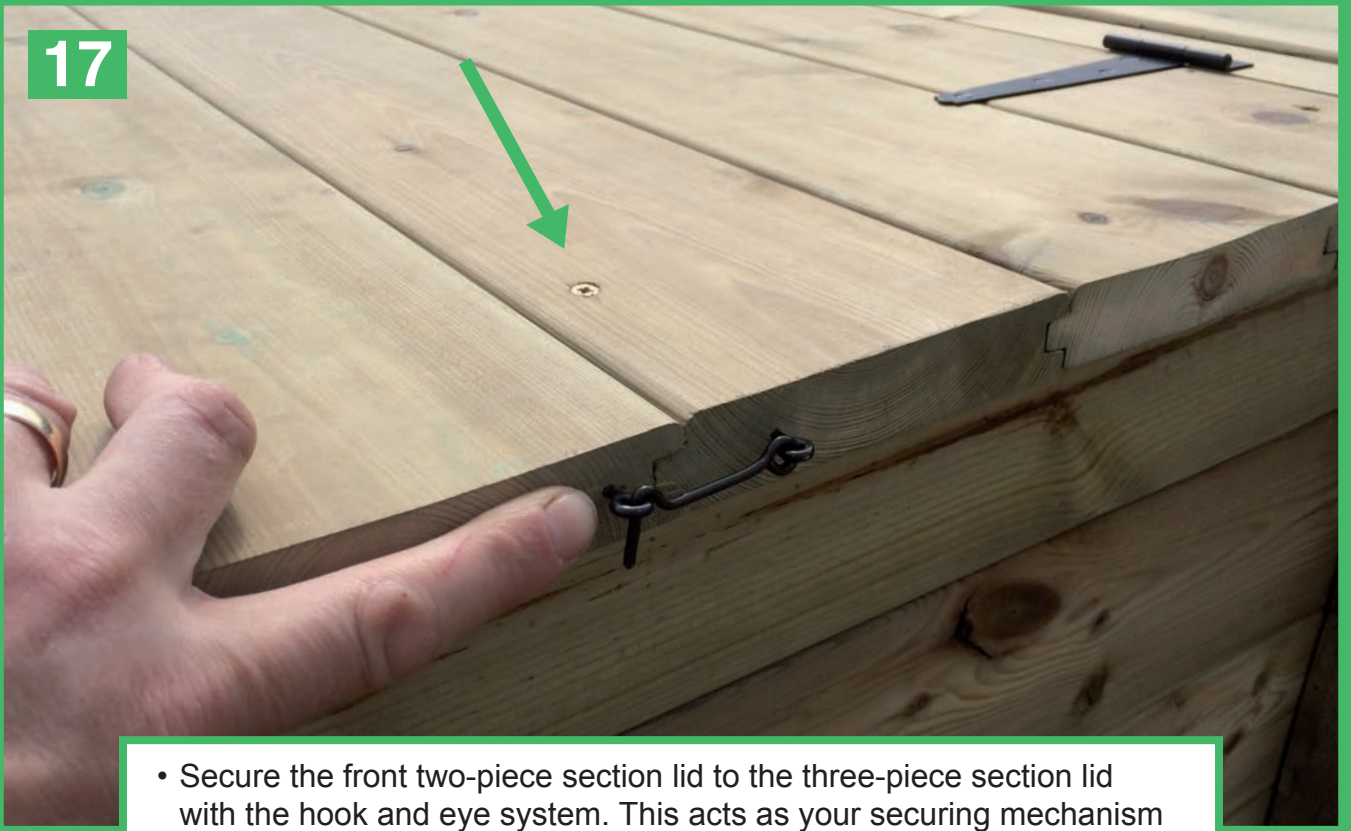

- Secure the front two-piece section lid to the three-piece section lid with the hook and eye system. This acts as your securing mechanism when the front flip lid is closed.
- Also note optional fixing point with 50mm screw if the rear lid section will have minimal use.

18



- Image shows front flip in action for quick access.
- To open, undo securing hooks and use both hands at each end of flip lid to pull open.

20



- Image shows front flip and lid in action for maximum access.

Filtration Board/Pack Assembly Instructions

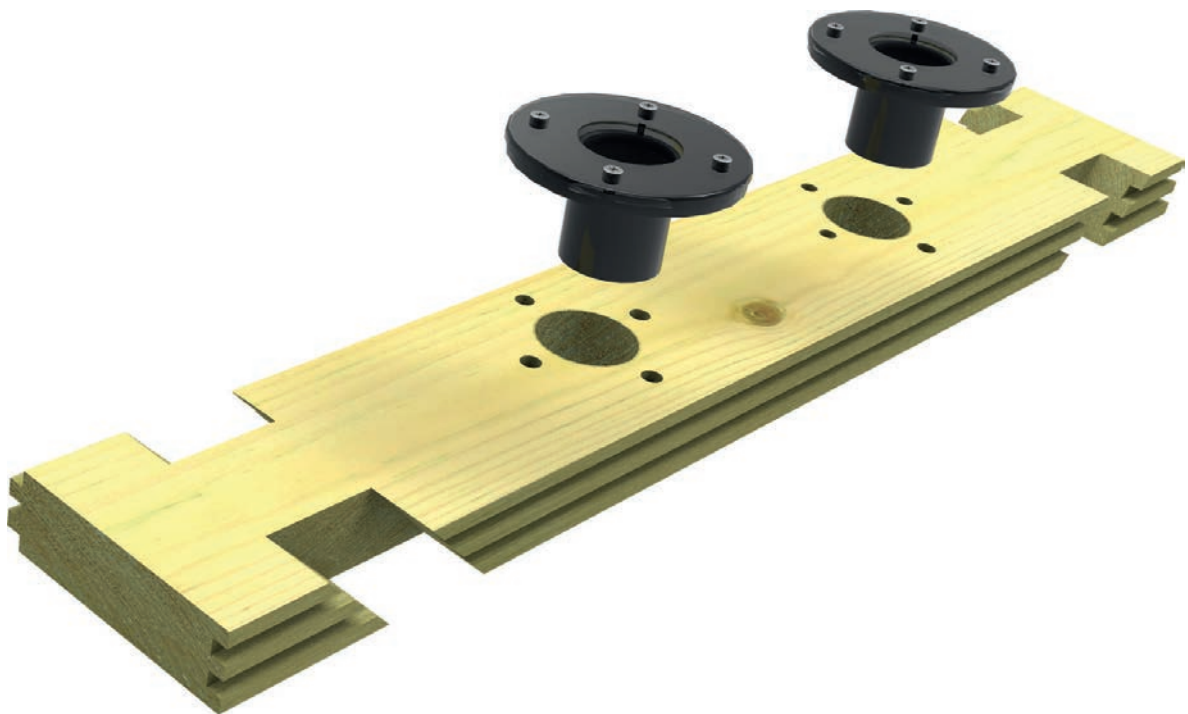

Please Note: The two parts shown are sold separately and not included our pack. They can be purchased from any local gardening store.

1



- The filtration plank can replace any of the standard planks of the structure, however we recommend that you follow the guidelines of your filtration equipment.

2



- You will need to fit the filtration back fitting before you can progress with the liner installation. Make sure you remove the frontplate before commencing.

3

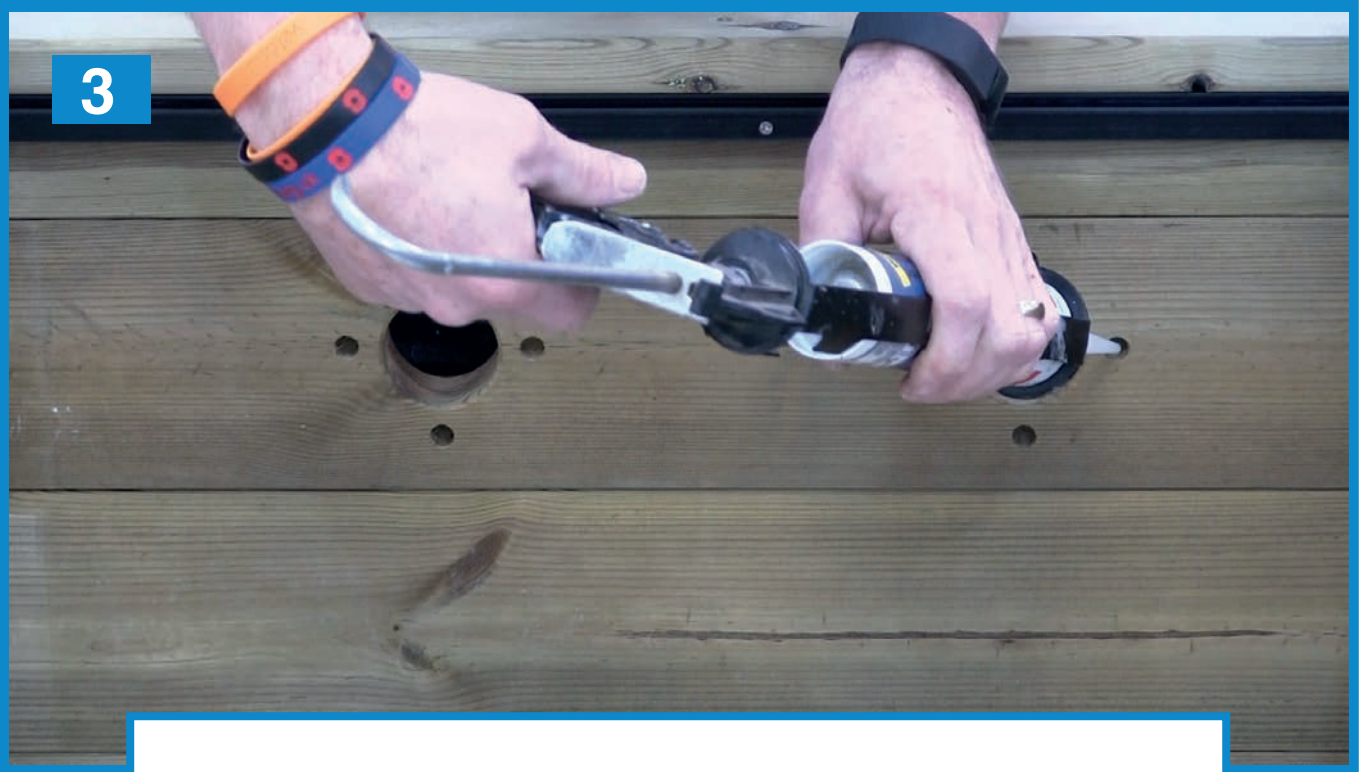

- The filtration fittings needs to be fixed into place using a fish friendly silicone.

4

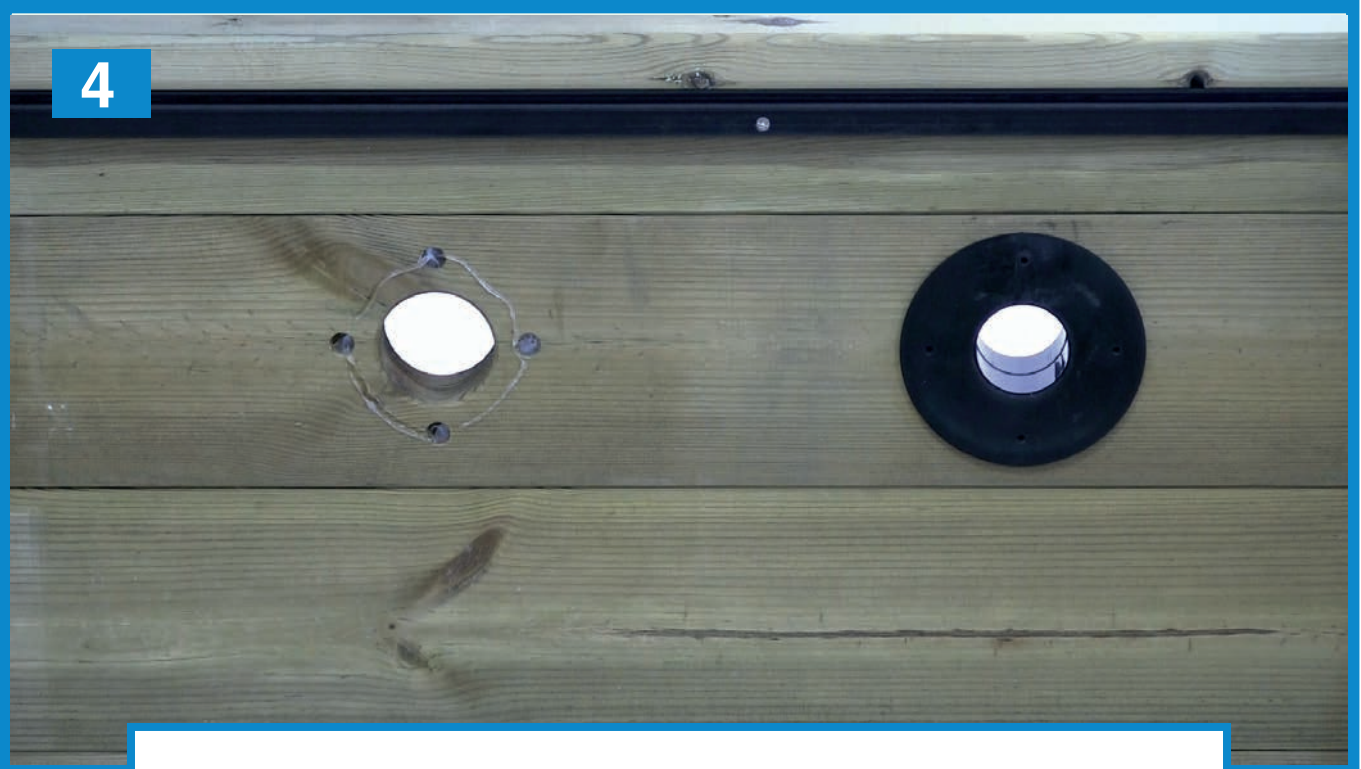

- Repeat the process for any additional fittings.

5



- Secure fittings in place with fish friendly silicone on the outside of the pond and allow to cure.

6



- Insert screws in top and bottom positions. Do not tighten the screw too much, just a couple of turns and leave the crosshairs of the screw pointing North, South, East, West.

7

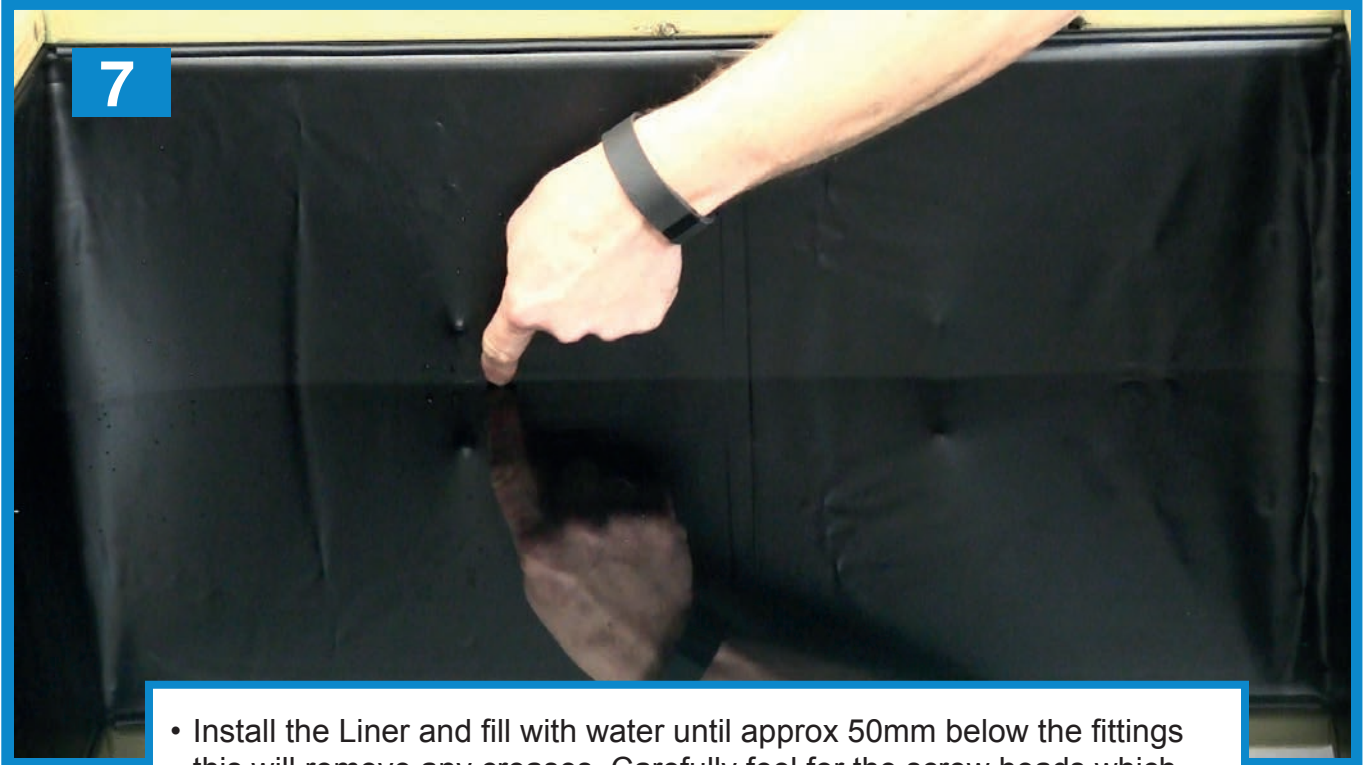

- Install the Liner and fill with water until approx 50mm below the fittings this will remove any creases. Carefully feel for the screw heads which are behind the liner.

8



- With extreme caution cut the crosshairs of the screw with a sharp knife and push screw through the insertion hole made.

9

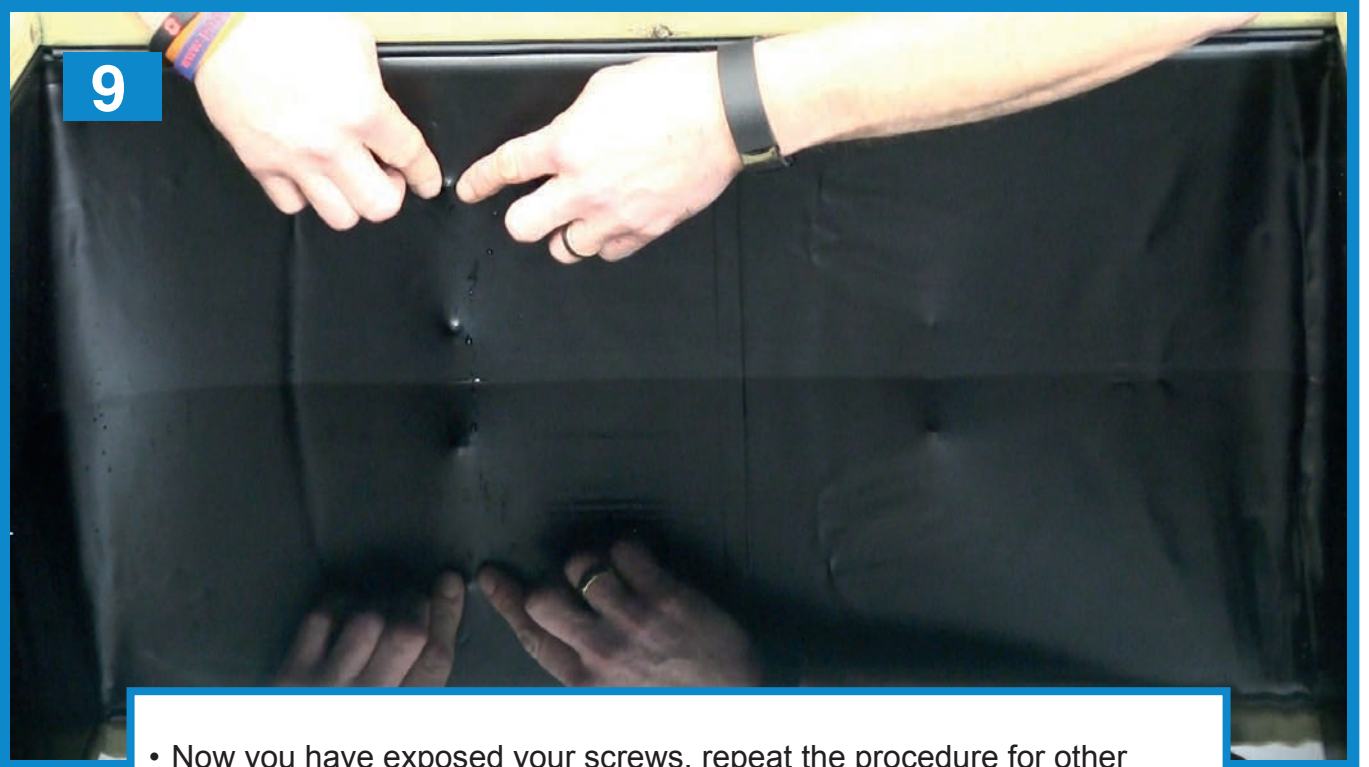

- Now you have exposed your screws, repeat the procedure for other fittings.

10

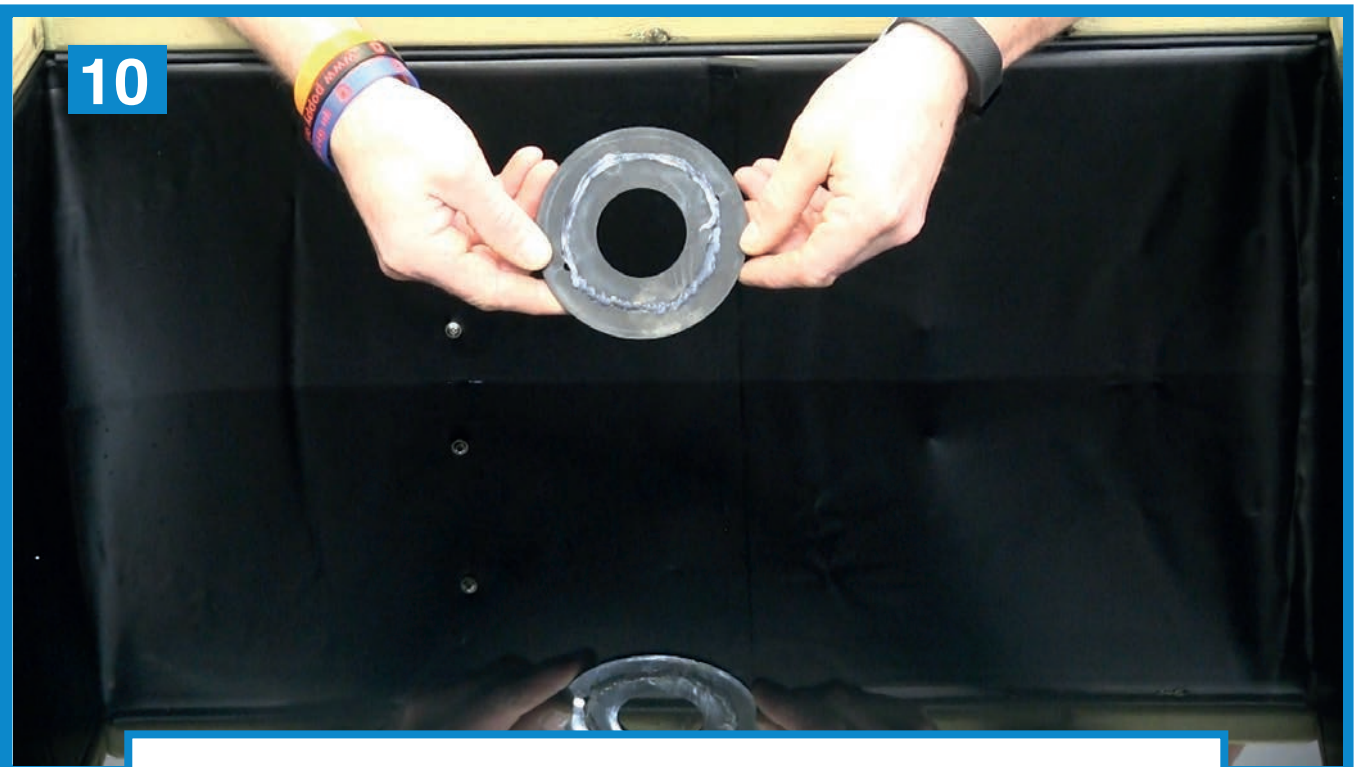

- Before attaching the faceplate add fish friendly silicone to the back.

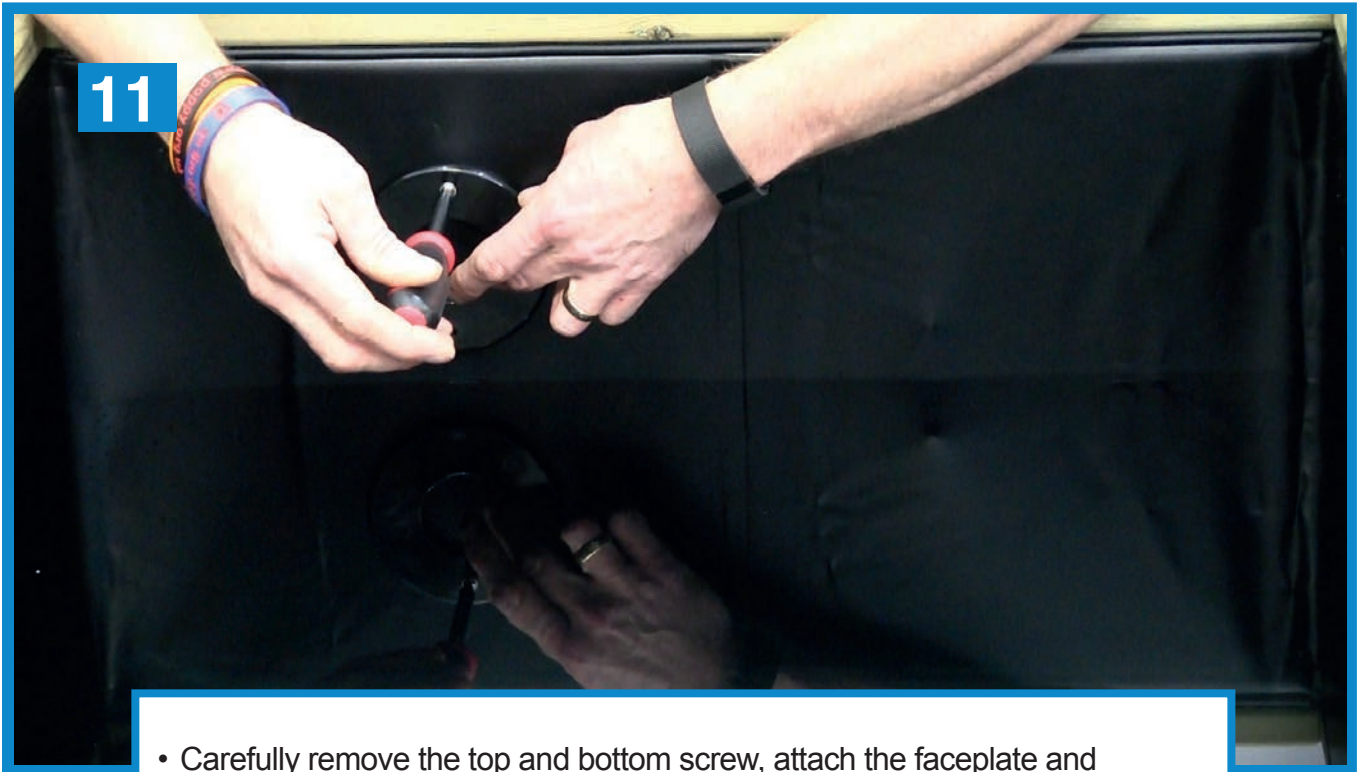

- Carefully remove the top and bottom screw, attach the faceplate and reinsert screws. Do not fully tighten.

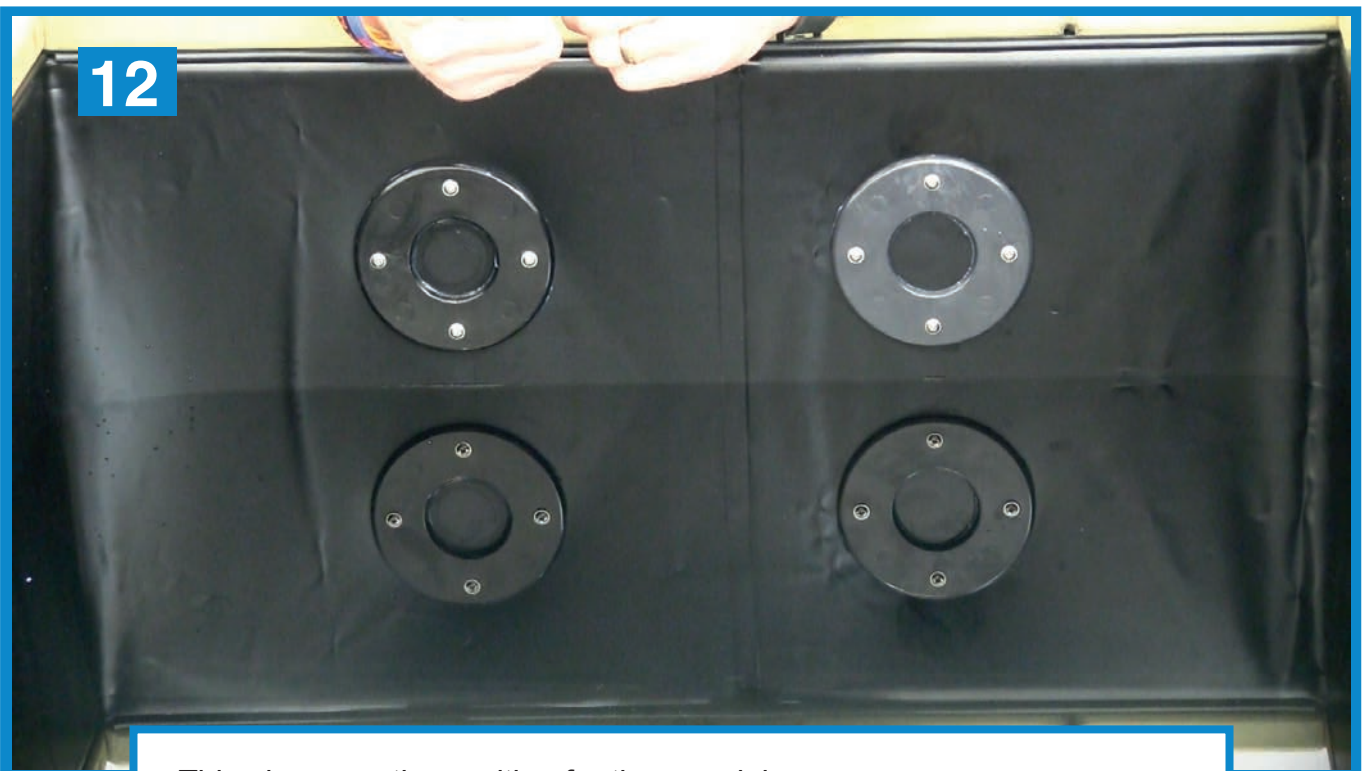

- This gives you the position for the remaining screws. Insert these and slowly tighten all four screws to achieve an even pressure when they are fully tightened.

13

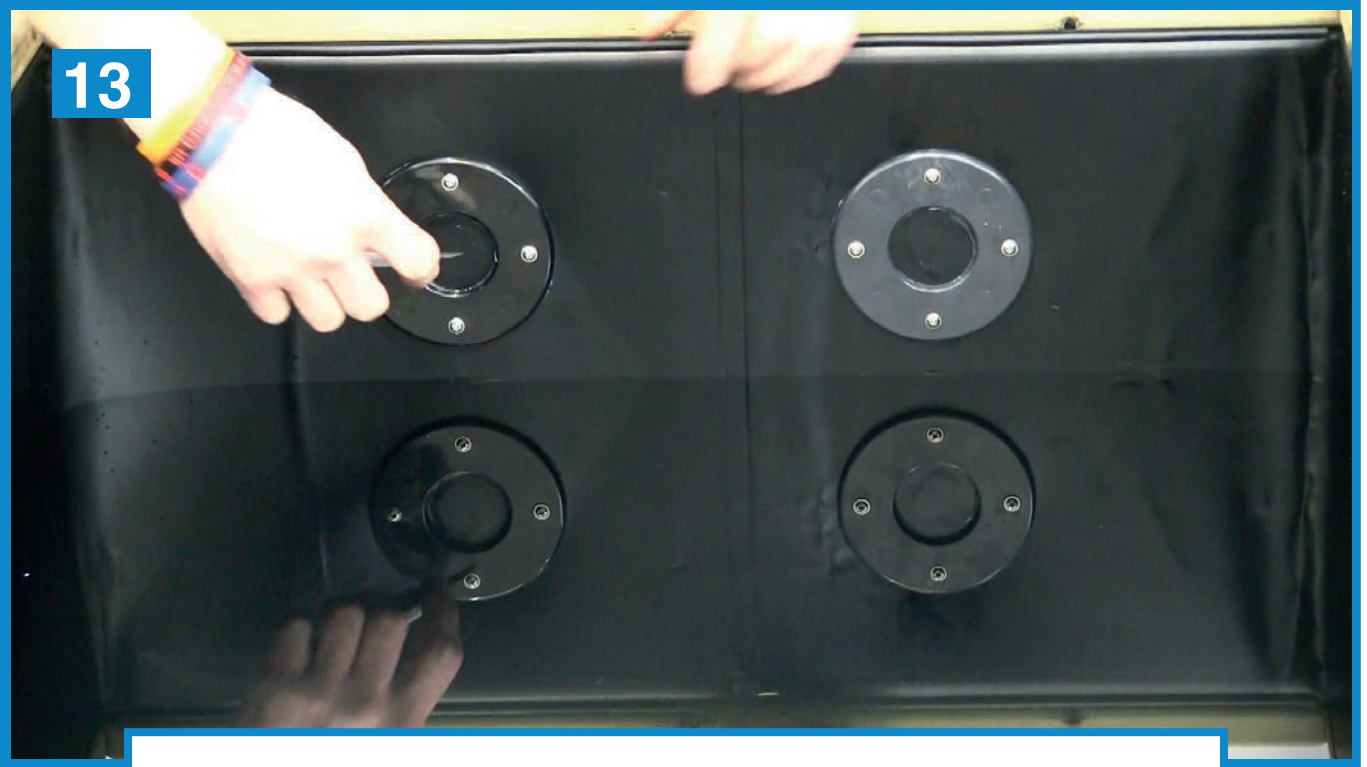

- Using a sharp knife very carefully cut around the inner hole of the fitting.

14

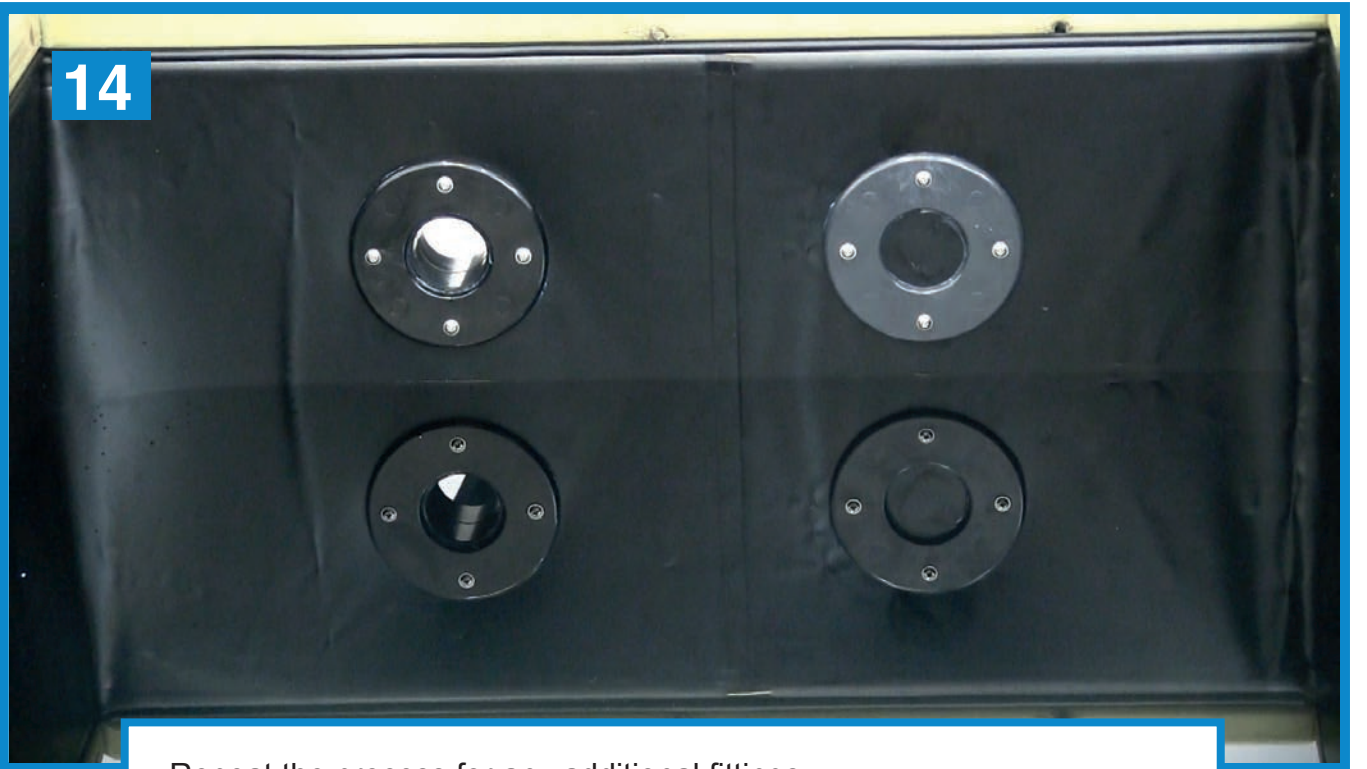

- Repeat the process for any additional fittings.

15

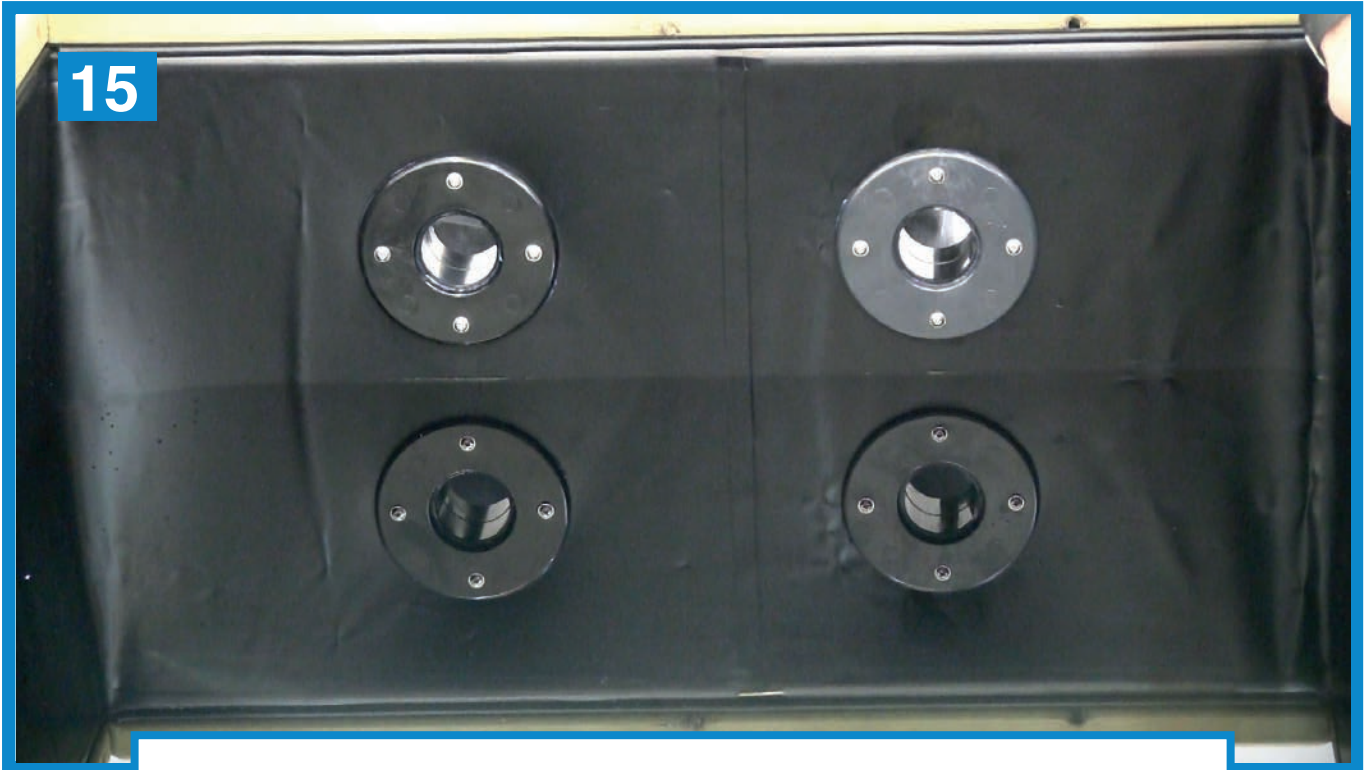

- Once you have got to this stage your pond is now ready to accept our filtration.

16

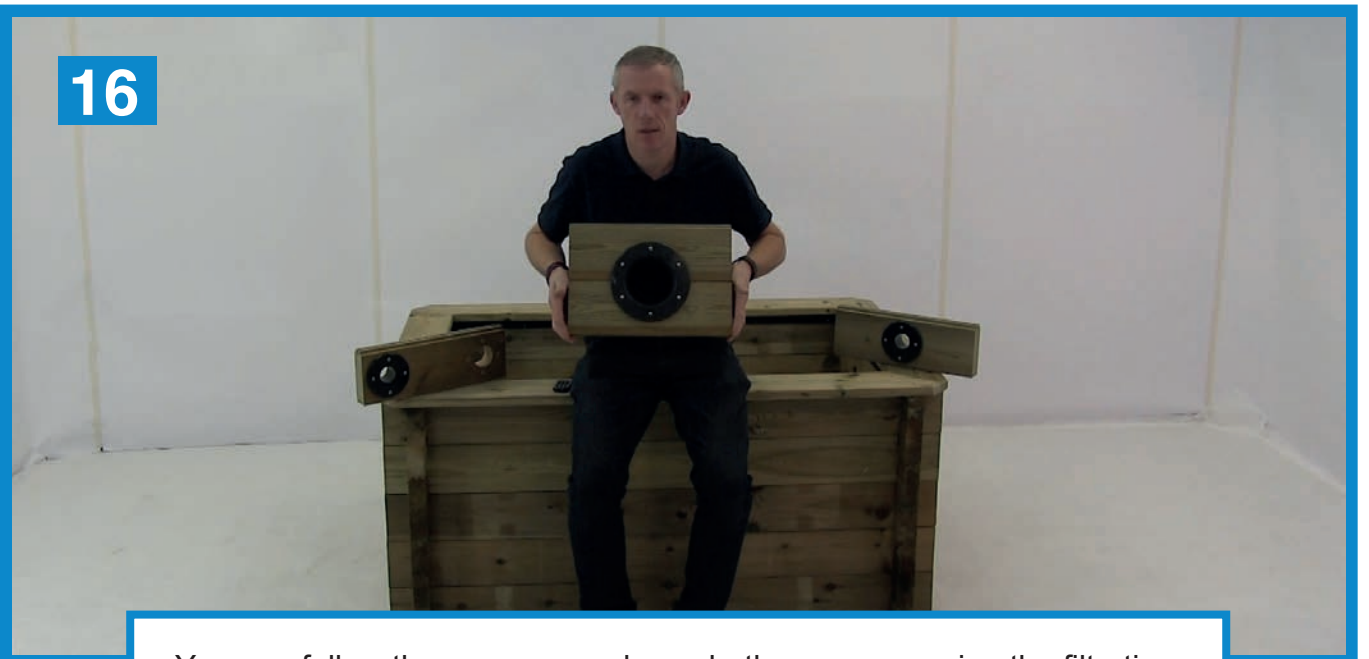

- You can follow the same procedure whether you are using the filtration plank or filtration pack.

Please Note: The large filtration hole must be fitted a minimum of two planks above the base of the pond to ensure the liner creases are removed first.

Warranty

Wooden Ponds

Layzee Ltd gives an extended 10-year parts only warranty on 44mm and an extended 5-year parts only warranty on 27mm wall structure planks only, against wood rot and insect infestation attack.

- Timber structure walls 10 years on 44mm OR 5 years on 27mm warranty
- Liner 10 years on the welds on 44mm OR 5 years on the welds on 27mm warranty
- Top Shelving 1 year warranty

Terms and conditions on the wall structure planks and liners:

Original Proof of Purchase must be supplied, along with details of any valid warranty issues with photographic evidence.

All warranties must have been registered at www.layzeeliving.co.uk (to extend to 5 or 10 years as above) within 60 days of purchase date.

This warranty is between Layzee Ltd and the original purchaser and is non-transferable.

The product must be installed in accordance with the installation manual.

Layzee Ltd will not be held responsible for removal or reinstatement of any components or accept any responsibility for any consequential loss.

Any modifications carried out to our products will void any warranty or claim.

Any warranty is on a pro rata basis over time e.g. For a 10-year warranty, a problem at 36 months the warranty will cover 70% of the cost of replacement parts on any valid claim. For a 5-year warranty at 36 months the warranty will cover 40% of the cost of replacement parts on any valid claim. See warranty examples below:

5 Years - 27mm Wooden Ponds

1st Year = 100%

Between 12-24 Month = 80% - 60%

Between 24-36 Months = 60% - 40%

Between 36-48 Months = 40% - 20%

Between 48 - 60 Months = 20% - 0%

10 Years - 44mm Wooden Ponds

1st Year = 100%

Between 13-24 Months = 90% - 80%

Between 25-36 Months = 80% - 70%

Between 37-48 Months = 70% - 60%

Between 49 - 60 Months = 60% - 5%

Between 61 - 72 Months = 50% - 40%

Between 73-84 Months = 40% - 30%

Between 85-96 Months = 30% - 20%

Between 97-108 Months = 20% - 10%

Between 109 - 120 Months = 10% - 0%

Wooden products use natural materials, any movement or discolouration can be expected. The Garden Timber Company accept no liability for any such occurrence.

Care must be taken to avoid any damage to the product, which may void any warranty.

Any product must remain in its original installation location.

At the installation, where a valid warranty issue may occur, access for inspection must be made available with permission to take any required samples of the product for independent testing.

Our timber products must not be submersed in water. Adequate drainage for our timber products must be in place, to avoid constant wet conditions for the timber. In the form of a shingle soak away or submersible pump if necessary. If our product is partially or fully submerged inground, then adequate pea shingle should be installed, including a drain off, completely protecting the product from ground water. Failure to protect the timber from such issues will void any warranty.

This warranty covers the timber wall planks from wood rot and insect attack only. This applies only to the infected planks, providing they are returned to our Factory at the consumers cost and risk, any replacements will be arranged in accordance to this warranty and returned to the site of the original delivery.

Any warranty will be void if it is deemed that there has been a failure of regular upkeep of your pond.

If it is deemed that a pond has been left partially or completely empty the liner warranty will be classed as void.

The pond should maintain 80% water level minimum at all times.

Liner warranty will only cover manufacturing defect of the weld, and does not cover any mechanical damage which may arise. i.e. user error cuts, rip etc.

Exclusions include

- Any of our products used outside of the UK are not covered by our extended warranty.
- "Act of god" e.g. fire, flood, lightning.
- Any other accessories that come with our products like plastic sand pit cover or play sand are only warranted to be free from material or manufacturing defects at time of purchase only.
- Any damage caused by livestock animals or persons.
- We accept no liability for any livestock, damage to property or persons due to manufacturing defects.
- Any loss or damage from general wear and tear.
- Failure to comply with local regulations or laws on our products, whether for domestic or commercial use.
- We shall not be liable for and any consequential loss caused to our products by third party products or services.
- These terms and conditions will be construed in accordance with English law, any disputes relating to the terms and conditions shall be subject to the courts of England.

Inspiration

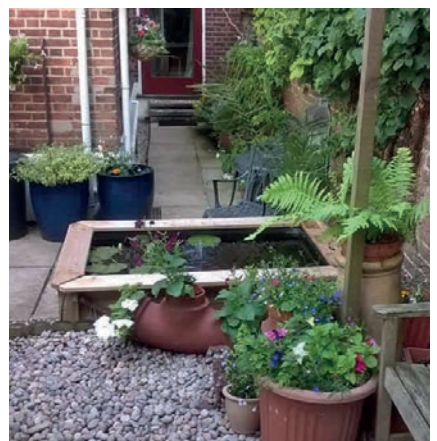
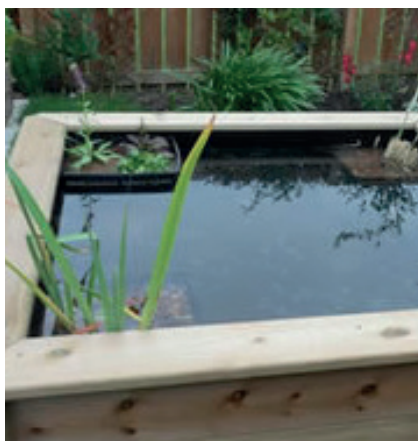
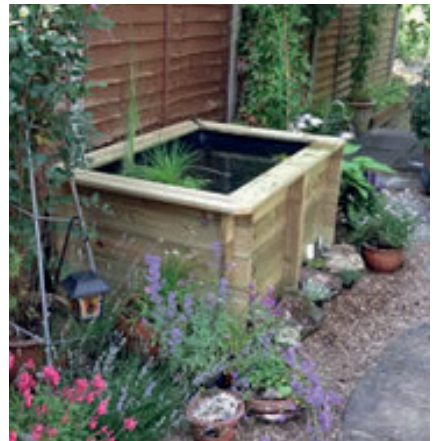
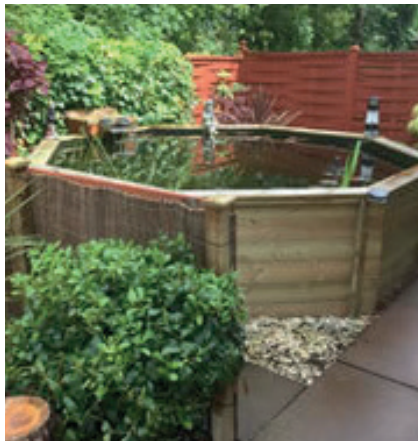
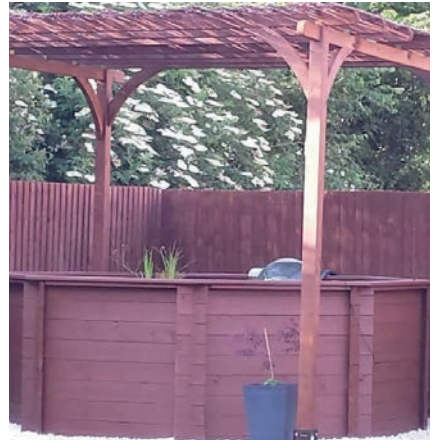
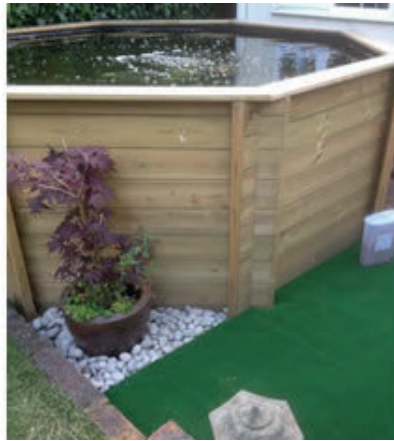



Layzee Living

www.layzeeliving.co.uk

Tel: 0207 867 3959



GTCPONDINST 07/19 v8