

HERSCHEL FLORIDA 2000 Watts Free standing Infrared Patio Heater

INSTALLATION & OPERATING INSTRUCTIONS



TECHNICAL INFORMATION:

Rated Power:	2000W @ 220-240V
Heating Element:	Long life warm glow carbon filament heating lamp
Dimensions:	Ø 50 x 25 x 207.5 cm
Mounting position:	Standing
Warm-up time:	5 - 10 seconds
Peak wavelength:	2 - 5µm
Weight:	10.5kg
Warranty:	2 Years (excludes lamp)
Protection:	IP44

ELECTRICAL EQUIPMENT:



Waste electrical products should not be disposed of with household waste. Please recycle where facilities exist.

IMPORTANT NOTICE TO PURCHASER:

Before using the product, you should determine its suitability for its intended use. HERSCHEL INFRARED LTD expressly disclaims implied warranties and conditions of merchantability and fitness for a particular purpose. In no case shall HERSCHEL INFRARED LTD be liable under any legal theory, including but not limited to contract or strict liability, for any direct, indirect special, incidental or consequential damages resulting from product use.

IMPORTANT SAFETY PRECAUTIONS

READ THESE INSTRUCTIONS CAREFULLY AND RETAIN FOR FUTURE REFERENCE.

Failure to observe these instructions will invalidate the warranty. No liability can be accepted for any damage caused by non-compliance with these instructions or through improper use or mishandling.

This unit may be a source of possible shock.

Do not disassemble. No user-serviceable parts inside.

Source of possible ignition.

WARNING

TO REDUCE THE RISK OF FIRE, ELECTRIC SHOCK OR INJURY:

1. Remove the unit from its packaging and check it to ensure it is in good condition before installing and operating.
2. **DO NOT** let children play with plastic bags or other parts of the packaging.
3. **CAUTION:** Risk of Electric shock
 - a. This appliance must be disconnected from its power source during installation or servicing.
 - b. **DO NOT** use this heater in the immediate surroundings of a bath, shower or swimming pool or hot tub where it could fall into a container full of water.
 - c. Switches and other controls must not be within reach of a person in a bath, pool, hot tub or shower.
 - d. **DO NOT** touch this heater or its controls with wet hands.
 - e. **DO NOT** allow power cables to become immersed in water or other liquid.
 - f. **DO NOT** open or try to repair the heater yourself. Servicing should be performed by qualified personnel only.
4. In order to avoid overheating and potential fire hazard, **DO NOT** cover the heater under any circumstances. If the heater should become accidentally covered during operation, turn it off immediately and clear out any foreign objects that have covered the heater or become lodged in the grill.
5. The unit must be installed with a minimum clearance of 300mm (12") clearance at the top and sides of the heater.
6. **DO NOT** touch the heater when in use. Parts of the heater may exceed 200°C / 392°F during operation. Contact with the heater during operation may cause severe burns. Do not touch the heater during or for 10 minutes after operation.
7. **DO NOT** use the heater if the power cord is damaged. This must be replaced by Herschel, its service agent or similarly qualified persons.
8. **DO NOT** use the heater to ignite materials. **DO NOT** operate in locations containing gasoline, flammable liquids or other volatile substances.
9. **DO NOT** install this heater near, or pointing towards flammable objects within 1 metre or where curtains, towels or other flammable items can be blown onto the heater.
10. This heater must only be used for the heating of people outdoors or indoors in an unenclosed space. The FLORIDA is not to be used by children or persons with reduced physical, sensory or mental capabilities, or lack of experience or knowledge, regardless of whether they have been given instruction or are under supervision. Children should be kept away and should not be left unsupervised around the unit.
11. All operators shall only switch on/off the appliance provided that it has been placed or installed in its intended normal operating position and they have been given supervision or instruction concerning use of the appliance in a safe way and understand the hazards involved. Children shall not plug in, switch on or regulate the appliance or perform user maintenance including cleaning.
12. **DO NOT** leave the heater operating unattended.
13. **IMPORTANT:** Ensure supply voltage does not exceed 245 Volts.

SAVE THESE INSTRUCTIONS.

WATER INGRESS PROTECTION:

Herschel FLORIDA is rated to a standard IP44. Suitable for outdoor use. If possible store the heater indoors over the winter.

ELECTRICAL INFORMATION:

The FLORIDA is supplied with a plug enabling it to be positioned where you require. Any fixed wiring installation must only be carried out by competent persons or a qualified electrician according to national regulations and the electrical supply should be protected by connecting to a current protection device suitable for the electrical rating of the unit in accordance with Table 1 and providing disconnection in both poles. All fixed wiring must have sufficient capacity to carry the current required by the heater. The unit must be earthed.

Any extension lead used must have sufficient capacity to carry the current required by the heater. All plugs, sockets and switches intended for use outdoors must have an appropriate water ingress protection. Always disconnect the heater from the power when not in use.

Table 1. Electrical Specification

Model	FLORIDA 2000
Voltage	220 – 240V
Rated Power	2000 Watts
Current	9 amps
Frequency	50 Hz
Cable Colour	Brown, Blue, Yellow/Green

Colour coding used in the supplied mains cable:

BROWN wire is to be connected to LIVE ('L'), the BLUE wire to NEUTRAL ('N') and the GREEN/YELLOW wire to EARTH ('E').

Be careful to ensure that the cable does not become a trip hazard.

POSITIONING:

The Herschel FLORIDA is a middlewave infrared heater suitable for use in cold indoor or semi-sheltered outdoor areas. When used outdoors or other areas with air movement/wind, the directional Infrared spread may reduce by 1/3 to 1/2 from published figures.

The sides and ends of the heater must always be at least 300mm (12") away from the nearest wall, ceiling or other structure. The unit has a tip over protection which will turn the heater off if tilted beyond a 45 degree angle. If possible, bolt the base to the floor to avoid the risk of the heater being accidentally knocked over.

CAUTION:

- Ensure mains power is OFF and the unit is cool before handling.
- Heater must not be located immediately above or below a socket outlet. Electrical connections must be made outside of the footprint of the unit to avoid heat build-up in the connection.
- The identification mark and model reference should be visible after installation.
- The fixed wiring insulation coming into contact with parts with a temperature rise of greater than 50°C must be protected, for example, by sleeving having an appropriate temperature rating.
- Ensure that wires are properly secured and cannot be pulled by small children.

ASSEMBLY:

Step 1. Fit the base

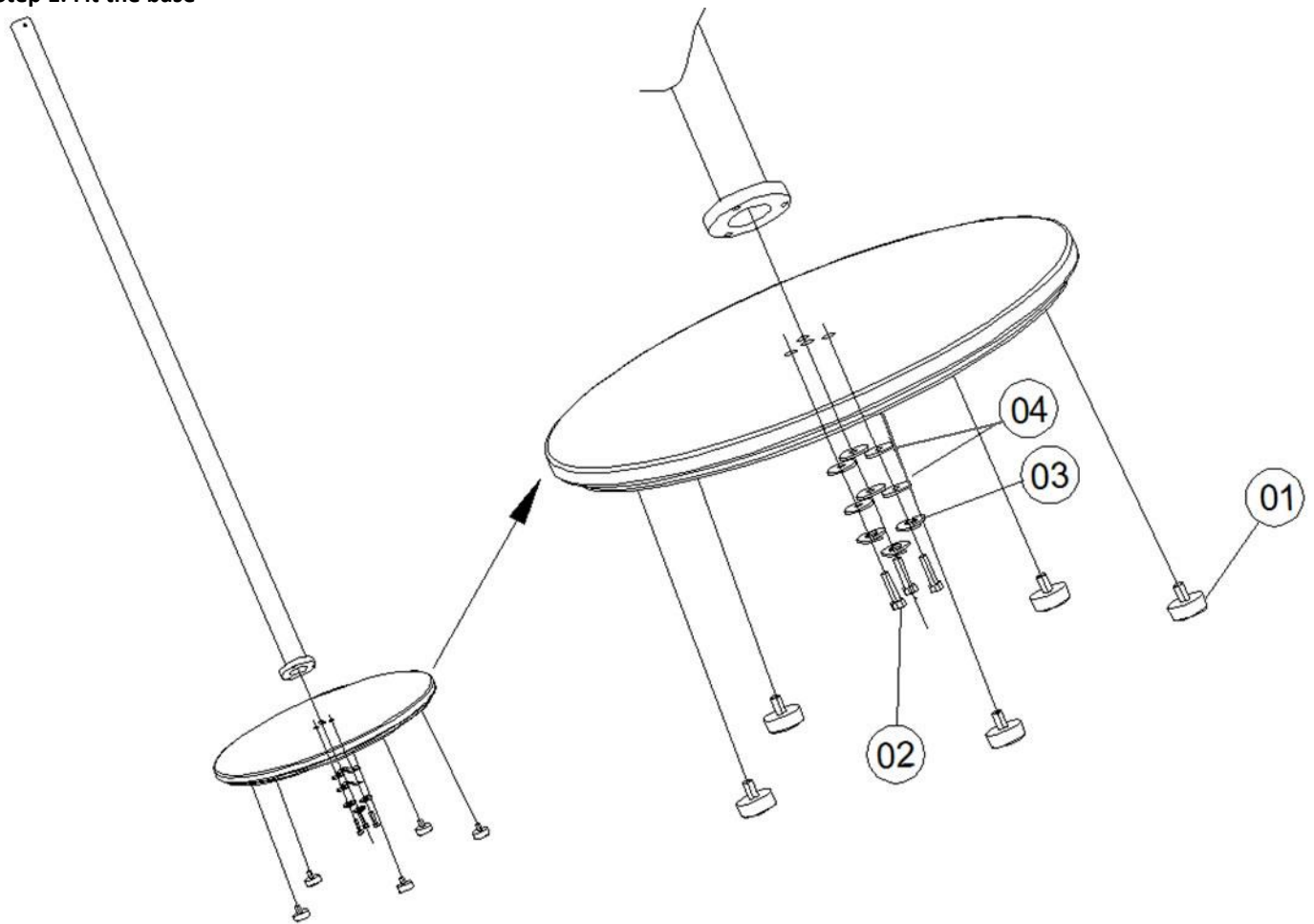

Parts supplied:

01	Rubber foot pieces	X5
02	Hex-headed bolt	X3
03	Spring washer	X3
04	Area washer	X6

Step 2. Fit the lamp & cable

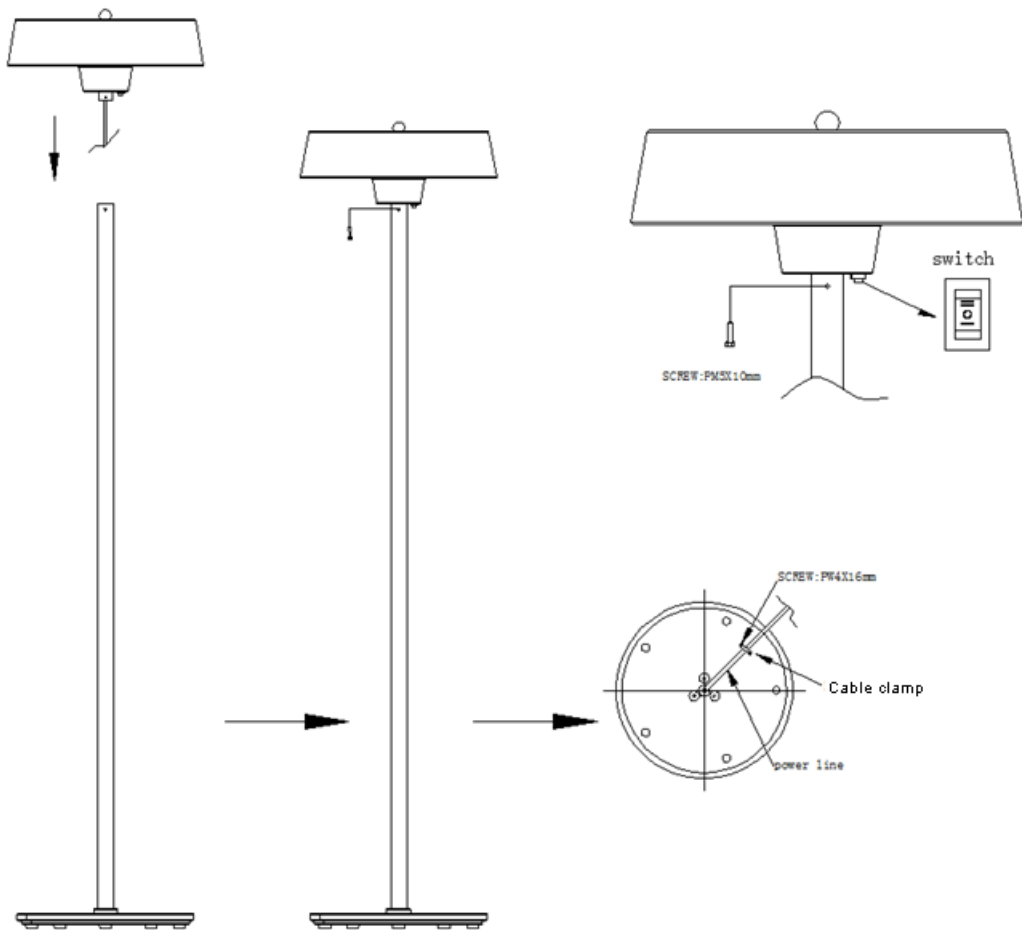

Step 3. Connect the plugged mains lead to the heater cable using the connector supplied

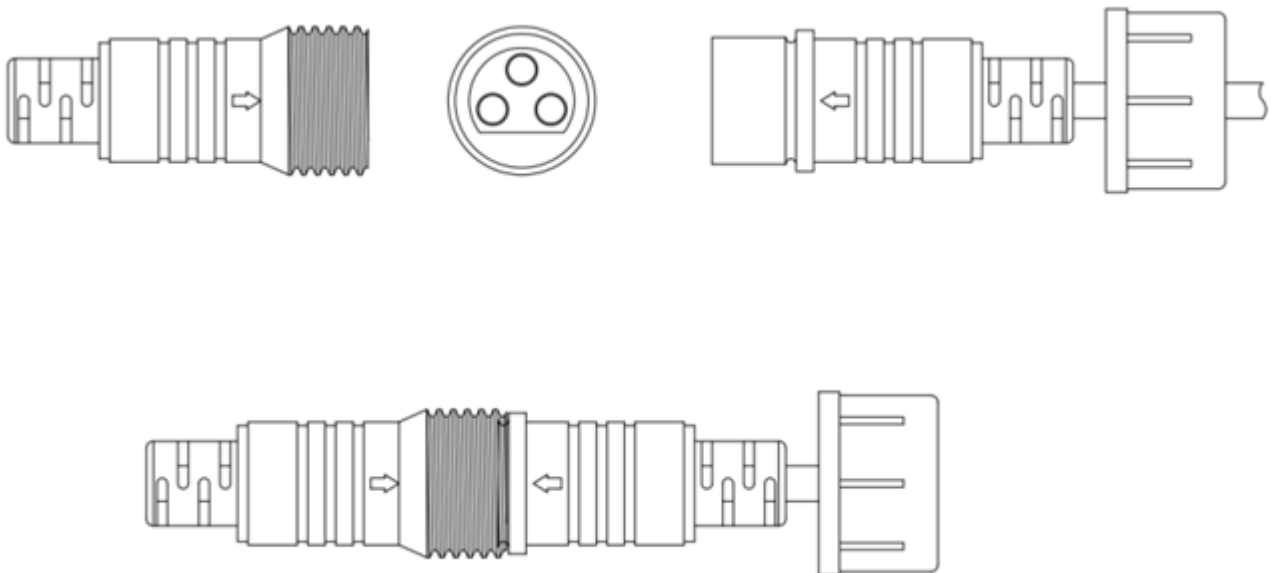

Attach the mains cable using the supplied connector and cable clamp. The connector is specially shaped so it only fits correctly one way. Screw both halves of the connector firmly together.

INITIAL USE:

Plug in the heater.

The power switch on the underside of the FLORIDA has 3 positions:

- Position O (Off)
- Position I (50% power)
- Position II (100% power).

Position I. Switches the heater to 50% power.

Position II. Switches the heater to 100% power.

There may be odour or vapour from the heater on initial use or if it has not been used for an extended period. This is normal.

EXTENDED USE:

Over time the grill may discolour due to high temperatures, airborne contaminants and fingerprints.

Discolouration will not affect the performance or safety of the heater and is not a condition for warranty replacement.

USER MAINTENANCE:

Avoid touching the front grill on the front of the heater and be sure to wipe off fingerprints from these parts.

Avoid touching a cold lamp with your fingers. Always wipe off finger marks if you accidentally touch the lamp. Residue from fingerprints can cause hot spots on the lamp surface and shorten the life of the lamp.

The heater may be wiped-down with a soft damp cloth. Do not use abrasive detergents to clean the unit. **DO NOT** use alcohol, petrol, abrasive cleaners, furniture polish or rough brushes to clean the FLORIDA. This will cause deterioration to the surface of the heater.

Changing the lamp should only be carried out by suitably qualified personnel.

Storage: Store the heater in a cool, dry location when not in use to prevent dust and dirt build up. Use packaging carton to store.

DISPOSAL:

This heater is an electrical product and must not be disposed of in household waste. A high percentage of the heater can be recycled. Please treat as electrical waste and recycle in accordance with local regulations.

WARRANTY:



Register your product here:

<https://www.herschel-infrared.com/customer-service/warranty-registration/>

The Herschel FLORIDA is guaranteed against failure due to faulty materials or workmanship for two years from date of purchase excluding the lamp. In the unlikely event of failure of the unit within this time, the unit must be returned to the supplier for repair or replacement. The guarantee is invalid if the correct installation instructions as given in this leaflet have not been adhered to. Refer to Herschel Infrared Ltd's warranty policy for full details. See <https://www.herschel-infrared.com>. Note your serial number for future reference: