

Dignity Lifts - Bidet Lift WL1

Owner's Manual / Installation Guide Version 1.0

www.DignityLifts.com

Ph: 1-248-602-0932

Model: WL1-2.0



The WL1 toilet lift includes a lifting mechanism, a bidet with adjustable temperature, spray location, and pressure. It also features a blow dryer, a nightlight, and a warmed seat.

Table of Contents

1. Packaging and components
2. Handlebar installation
3. Remote control holster mounting
4. Remove your toilet seat
5. Adjust the supporting feet
6. Attach the lift to the toilet
7. Plumb the bidet
8. How to use the bidet control knob
9. How to use the remote for more features
10. Cleaning and maintenance
11. Notes and precautions
12. Technical specifications
13. Troubleshooting
14. Warranty information

1. Packaging and components

Open the package, check that all parts are present.

If any parts are missing or damaged, please contact Dignity Lifts at DignityLifts.com or 248-602-0932.

The package contains:

Toilet lift body with attached bidet

Right handlebar (has the lift switch)

Left handlebar (has the red emergency call button)

2 Armrests

Remote control and remote control holster

Water inlet hose

Water supply tee joint

Handlebar tool kit (with 4 screws for fixing the handlebars and an Allen wrench)

Installation manual (this booklet)

2 Handlebar installation

- Connect the electrical connectors first. The handlebar with the lift switch is positioned on the toilet user's right-hand side, the other handrail is on the left.
- Connect the handrail to the post on the lift base.
- Use the screws and allen wrench to secure the handlebars in place.

3 Remote control holster mounting

- Your remote control has a holster so that you can keep the controller near your toilet.
- Use double-sided tape to attach the holster to a nearby surface. Be sure to position the holster with the open side facing upward and give yourself enough room to slide the controller into and out of the holster.
- Place the remote control in the holster.

4. Remove your old toilet seat.

- To install your dignity lift, you will need to remove your old toilet seat.
- Not all seats are the same, but many require a large flathead screwdriver and a pair of pliers. Typically, you will remove two nuts from beneath the toilet. There is usually one on each side. Once removed, the seat usually lifts right off.
- Clean all surfaces.

5 Adjust the support feet

The goal is to adjust the height of the lift so the seat stops just above the rim of your toilet. Your Dignity Lift does not need to rest on your toilet, it rests on its own four feet for extra stability.

- When the device leaves the factory, all 4 supporting feet have been adjusted to the lowest height. This usually means the feet need to be adjusted.
- Using a tape-measure, measure the height of the rim of the toilet.
- Adjust the feet of the lift so that the metal cross-bar at the rear of the toilet lift is $\frac{1}{4}$ " inch higher than the rim of the toilet. If you cannot adjust your lift low enough, you can remove all four feet and rest the lift on its chassis, this is usually necessary for 14" toilets.
- Adjust all feet equally so that your Dignity Lift sits level and is stable. Test the lift's stability by trying to wobble it.
- If your lift has a wobble, readjust the feet that are wobbling, usually lowering one of the feet fixes this.
- The lift should not contact your toilet when it is lowered to the lowest position, check for clearance.
- Not all floors are level, this is especially true around toilets. After the lift is fully installed, check again and eliminate any wobbles.

⚠ *Warning: Not providing optimum stability can result in a loss of balance. Please be certain the lift is steady when installed.

6 Attaching your lift to the toilet

Your lift is capable of supporting the weight of its user alone. It only attaches to the toilet so that the lift doesn't get out of position. To position the lift to the toilet we use expanding rubber pins, you will install them in these steps. This part can be a bit tricky.

- Plug your lift into the wall.
- Raise your lift.
- Remove the plastic cover over the "rear support". The rear support is the cross-bar that connects the two sides of the lift. The white cover for the rear support can be slid upward to remove it. We recommend sliding one end first, then the other.
- You can now remove the commode pan and commode rack that came with your lift. You may need them later if you need to use the lift as a bedside commode, so store them safely.
- Install the two toilet brackets to the bottom of the rear support. This can be a little tricky. The bolt for the bracket needs to be installed down into the slot so that the bracket attaches to the bottom of the rear support. It is difficult to install. We suggest using the allen wrench to help guide the bolt down into the slot. We apologize it isn't easier.
- Do not tighten the bracket yet. Leave it loose so that you can install the bolts into the holes on your toilet later.
- Place the rubber, expanding pins into the two holes on your toilet. Place the bolt for the pins through the other end of the bracket.
- Tighten the bolts near the pins first, this should expand the pins so they are snug in their hole.
- Finally, tighten the bolt that attaches the brackets to the rear support. Check to make sure the lift cannot move out of position. If large movement is still possible, check all connections to make sure they are tight.
- Different toilets will require different methods to expand the pins in the holes, but as long as the pin is snug in the hole, you will be fine.
- Replace the cover over the rear support.

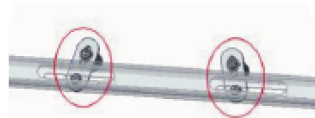
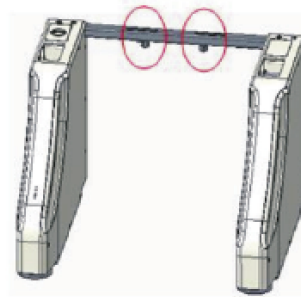
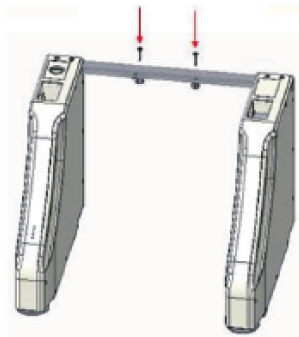
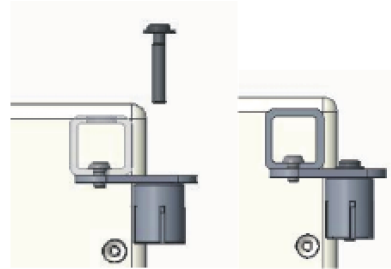

Shown above, clockwise from top-left:
The toilet brackets and expansion bolts.
A cut-away of the rear support with the bracket bolt installed.
The location for the brackets on the rear cross member
An example of how the brackets install.
Another view showing that the bracket bolts go into the slot.
An illustration of the expansion bolts and how they go through the bracket.
Arrows showing the installation of the expansion bolts from above. (this is done when you install the lift on the toilet).

7 Plumbing The Bidet

The Bidet attaches to the water supply line that your toilet uses. Three parts are included to make this possible. A “Tee”, a water inlet hose, and the bidet lift. Installing this takes a moderate level of plumbing skill.

- First, turn off the water to your toilet. You should be able to do this at the shutoff valve located on the wall, behind your toilet.
- Flush your toilet and drain the toilet tank.
- Locate the supply line that goes from your shutoff valve to the underside of your toilet. Remove the toilet supply line at the toilet end.
- Attach the “tee” joint where that water supply line was removed and attach the supply line to the tee.
- Install the water inlet hose from the tee to the bidet.
- Tighten all connections.
- Turn on the water supply and check for leaks and drips.

WARNING: Be sure the lift/bidet is plugged into a GFI Outlet. Test the outlet by pressing the test and reset buttons.

8 How To Use The Bidet Control Knob

The control knob allows everyone fast access to the most needed hygiene features. It is easy to access and easy to use. Other, more advanced features and adjustments are available through the remote control.

Note: the bidet will only work if a person is sitting on the seat. There is a sensor to prevent the bidet from spraying all over your bathroom when you are not seated.

The Easy To Use Bidet Control Knob Has Four Features

1. Turn the knob clockwise to activate a wash for women.
2. Turn the knob counter-clockwise to activate a general cleansing.
3. Hold the knob down (press the knob) for 3 seconds to activate the blow dryer.
4. Push the knob down (press the knob) for 1 second to stop.

8.1 How to use the lifting button

- The lifting control switch of the device is located at the front end of the handlebar.
- Control the lifting and lowering of the seat by pressing the switch.
- One side of the switch makes the lift go upward, the other side lowers the lift.
- The lift only moves when the switch is pressed, it will stop as soon as the switch is released.

8.2 How to use the alarm button

- The alarm button will alert anyone who can hear it that there is trouble. It makes a very loud sound.
- When installing the lift, demonstrate the sound to anyone you live with. Let them know that if they hear this sound, you need help.
- To turn on the alarm, push the button.

9 Instructions for using the remote control

Stop Switch

Tap the "Stop" button to stop all bidet functions.

Power Button

Push the "Power" button to power off the bidet. Even if the bidet is powered off, the lift and alarm will still work.

Rear Wash

Tap the "Rear" button to enter the rear wash function. During the rear washing process, press this button again to switch between having the nozzle in a fixed position and having the nozzle in a moving position. Press the "Stop" button to terminate the rear washing, or press the "Dryer" button to terminate the rear washing and directly enter the drying process.

Front Wash

Tap the "Front" button to enter the feminine wash function. During the feminine washing process, press this key again to switch between having the nozzle in a fixed position and having the nozzle in a moving position. Press the "Stop" button to terminate the feminine wash, or press the "Dryer" button to terminate the washing and directly enter the drying process.

Dryer

Tap the "Dryer" button to enter the drying function. After each rear wash, front wash, kid wash, and massage, the drying function will automatically start. During the drying process, press the stop button to terminate the drying, or press any wash function button to terminate the drying and enter that wash Function.

Nozzle Cleaning

Push this button to activate a nozzle cleaning function. This will extend the nozzle so you can clean it. This improves the hygiene of your lift. We suggest doing this if you feel like the cleanup has been messy.

Pressure/Dry adjustment

While the bidet is washing, lightly press the "+" or "-" key to adjust the nozzle water pressure.

While the blow dryer is running, lightly press the "+" or "-" button to adjust the drying air temperature.

Warm water adjustment

Tap the "Water Temp" button to set the nozzle water temperature to switch between "Unheated / Low Heat / Medium Heat / High Heat".

Warm seat adjustment

Tap the "Seat Temp" button to set the seat temperature to switch between "Unheated / Low Heat / Medium Heat / High Heat".

Suggestion: The seat changes temperature slowly, so changing the setting won't make quick changes in temperature. If you change the setting you might not notice any difference until you sit down the next time.

Wind Temp

Touch this button to adjust the blow-dry temperature.

Night Light

This button activates/deactivates the night light.

Power Save

This button allows the bidet to use less electricity, but will result in the water spray being colder initially.

Deodorizer

This button will turn on a very small fan that filters the area near the toilet bowl.

10 Cleaning and maintenance

10.1 Cleaning your bidet lift

Pull out the power plug first, and then clean the equipment with a mild, non-abrasive cleaner. If multiple people use the equipment, it is recommended to disinfect the equipment after each use; The equipment has a waterproof rating of IPX4, so you can use spray cleaners but you cannot immerse the entire lift in water.

10.2 Cleaning the nozzle

Press the "Nozzle Clean" key on the remote. The nozzle will automatically extend for manual cleaning. You can use an old toothbrush to remove dirt or clogged impurities in the nozzle hole.

11 Notes and Precautions

- This product is only suitable for AC 120V / 60Hz power supply.
- Your electrical outlet should be permanently installed inside your bathroom, at least 8 inches above from the ground, and be a GFI outlet.
- Do not install this or any electrical device in a place where it will become wet.
- The power cord should not be squeezed or pinched.
- If using an extension cord to reach the outlet, be sure the junction is at least 8 inches above the floor.
- Do not use wet objects to touch the plug/socket.
- Do not use liquid to flush the socket
- Insert the plug completely into the socket to avoid electric shock and poor contact.
- The ambient temperature of this product should not be lower than 35°F and not higher than 120°F, otherwise the product will be damaged due to freezing of water or too high temperature.
- Try not to splash urine and feces on the nozzle, which will easily lead to the growth of bacteria on the nozzle which can cause skin inflammation.
- Any disassembly/repair of this product should be done by authorized agents or professional personnel.
- The water inlet hose must not be bent/twisted to ensure that the waterway is unblocked. Otherwise, the performance of this product will decrease.
- Because of the delicate skin of children, when using this product, other personnel should help them adjust the temperature of the seat ring of this product and the temperature of the water outlet to avoid burning their skin.
- Do not splash the toilet lift.
- This product can only be used for the purposes specified in this manual.
- Unplug the lift before cleaning, use regular bathroom cleaners from a spray bottle and a soft cloth or paper towel.

12 Technical Specifications

Item Specification

Rated Voltage and frequency AV120V 60Hz

Seat lifting machine power 130W

waterproof level IPX4

Use ambient temperature 35-120°F

Water supply temperature 35-120°F

Water supply pressure 0.07 - 0.7MPa

Hot water temperature 90-104°F

Hot water heating power 1250W

Heating seat surface temperature 97-108°F

Seat heating power 50W

Warm air temperature 100-120°F

Heating power of seat heater 250W

load capacity 300 lbs.

Power cord length 5 feet

Product dimensions: Length: 20 $\frac{3}{4}$ ", width: 23 $\frac{7}{8}$ ", height: 27 $\frac{3}{8}$ "

Width between handles: 18"

Minimum height of top of seat ring: 15 $\frac{1}{4}$ "

12 Troubleshooting

Problem	Cause	Fix
Nothing happens, no lights, no movement, no power on the lift or bidet	The device is not connected to power.	Plug in the device, if it is plugged in, check the outlet to make sure there is power to it. Check the GFI to see if it needs to be reset.
The bidet will not work	The seat is not lowered to its lowest position.	Lower the seat until it cannot lower any longer.
The bidet will not work.	There is no one sitting on the seat.	Sit down on the seat so that the sensor understands you are seated. The bidet will not spray if no one is seated.
The water is too cold	Temperature may not yet be set or it may be set too cold.	Set the water temperature using the remote control.
Electric cord keeps tripping a breaker	Short circuit	Unplug the lift and try the circuit with another device. If the circuit is working properly, contact Dignity Lifts tech support.
Water comes out of the bidet even when it is turned off.	Water pressure is too high.	Tighten the water supply valve slightly to reduce pressure.
The nozzle does not spray powerfully enough even on the most powerful setting.	Water pressure is too low.	Open the water supply valve more.
The nozzle does not spray powerfully enough.	Pressure setting is too low.	Use the remote control to increase the pressure setting.
The nozzle spray is too powerful.	Pressure setting is too high.	Use the remote control to decrease the pressure setting.
The nozzle does not spray powerfully enough.	The filter is clogged	Try cleaning the filter.
The blow dryer is too cold or too hot.	The air temperature setting is not what you prefer.	Use the remote control and increase the temperature of the air.
The seat is not warm enough / too hot.	The seat temperature needs to be adjusted	Use the remote control and adjust the seat temperature.

13.Warranty

Warranty Registration

If you purchased your lift directly from Dignity Lifts / DignityLifts.com, your warranty registration is done. We have your information on file including your purchase date.

Purchased your lift elsewhere? Register by email:

Email: DignityLifts@PriveCo.com Include:

Your name:

Address:

Phone:

Include proof of purchase that indicates where and when you purchased the lift.

You must register your warranty within 90 days of your purchase.

Warranty:

The Dignity Lifts Warranty covers 3 years of parts and 90 days of parts and service. Details of the warranty are as follows.

- During the first 90 days of your ownership, Dignity Lifts will work with you and if necessary and possible a local appliance repair person to keep your Dignity Lift working properly. This warranty does not include installation of your lift, it covers only the lift itself and its operation.
 - Your first point of contact for warranty repairs will be to call us or email us. Our team will handle your case. We will help diagnose the problem and fix it.
 - Dignity Lifts can typically be serviced by an appliance repair technician. We can help see if there is one that services your area (rural customers might not qualify for this). We will send instructions and replacement parts to you or the technician.
- After 90 days and within 3 years of your purchase we will provide replacement parts free of charge. This does not include wear items such as batteries, grips and handles, but it does include the linkages, structure, actuators, and electrical components of your lift. If you require warranty parts, please contact us via telephone or email.

Dignity Lifts - Bidet Lift - WL1-2.0

Product model: DIGNITY-WL1

Executive standard: QS2018TLAVA

Company Name: Dignity Lifts

Company Address: 352 Oliver Dr., Troy MI 48084

Company website: www.DignityLifts.com

Customer Service Hotline: 248-602-0932