

Suction Cup Window Thermometer / Hygrometer Model No.: WS 7025

Instruction Manual

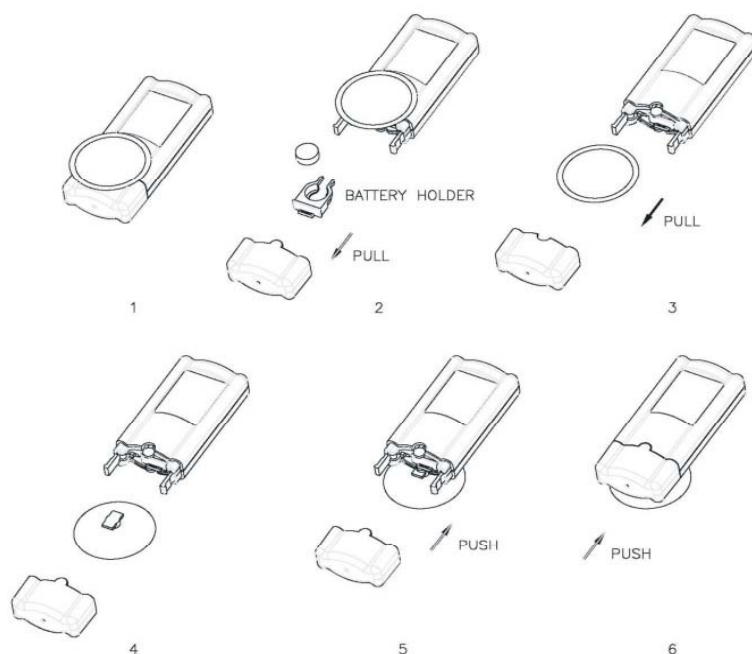

Battery Installation and C/F selection

(See above illustrations 1~2)

- Pull the bottom housing and battery holder away from the top housing.
- Insert the battery according to the polarity markings.
- Slide the selector switch to either Fahrenheit or Celsius.
- Re-attach the top and bottom housings.

Convert from Outdoor to Indoor Use (See above illustrations 3~6)

Your suction cup thermometer is assembled for outdoor use. If you want to attach the thermometer to the inside of the window, follow these steps:

- Pull the bottom housing away from the top housing.
- Pull the suction cup away from the top housing.
- Rotate the bottom housing and suction cup 180 degrees.
- Push the suction cup into place.
- Re-attach the top and bottom housings.

Install the Thermometer

The thermometer can be mounted to a window, mirror, or any clean and smooth, non-porous surface. Suction cups will not hold on wood or plaster.

- Clean surface of any oils or other foreign matter.
- To attach the thermometer, press firmly the suction cup attaches to the housings, making sure the suction cup makes a tight bond with the mounting surface.

Do not use in direct rain and direct sunlight.

Specifications

- Temperature range : -4°F to 140°F (-20°C to 60°C)
- Temperature tolerance : +/- 1.8°F (+/-1.0°C)
- °C/°F selectable
- Hygrometer range : 20% to 95%
- Hygrometer tolerance: +/-5% at 30%to 90% ; +/-7% at 20% to 29% and 91% to 95%
- Uses (1) LR44 or AG13 button cell battery

CONSIDERATION OF DUTY ACCORDING TO THE BATTERY LAW

Old batteries don't belong to domestic waste because they could cause damages of health and environment. End-user committed by law to bring back needed batteries to distributors and other collecting points.

