

STEAMIST®

AudioSense "Invisible" Speaker Instructions

Model: TSS-IN

Installation Instructions

NOTE: To be used in conjunction with the AudioSense option (TSMU). See separate Pub# 206.

IMPORTANT: If the wall/ceiling material is too dense, the transducers will not work properly. For optimum performance, the thickness of tile should not be more than ½".

1. Select a suitable location to mount the TSS-IN transducers. Future access for service should be considered. Optimum speaker location is in the ceiling above the steam room where space above it is unoccupied, such as attic space. Speakers may also be installed onto walls with consideration that the space behind the wall is a closet or space where sound will not disturb occupied space. This will minimize the sound penetrating the adjacent rooms and provide future access. The speakers are intended to be installed behind the shower surface out of sight.
2. Speakers should be mounted on opposite sides of the room. Center between the joist/studs (See Figure 3).
3. Remove adhesive liner from speaker and attach it to the cement board between the joist/studs. Repeat for second speaker on opposite side of the room.
4. Route speaker wires to the TSMU Control Module. The positive speaker leg is red and the negative speaker leg is black.
5. Test speakers before closing walls.

NOTE: Transducers are designed to transfer energy to the surfaces they are mounted to and must be mounted to inside the wall cavity. As with all audible devices, sound may be present outside of the immediate steam room area.

Figure 1

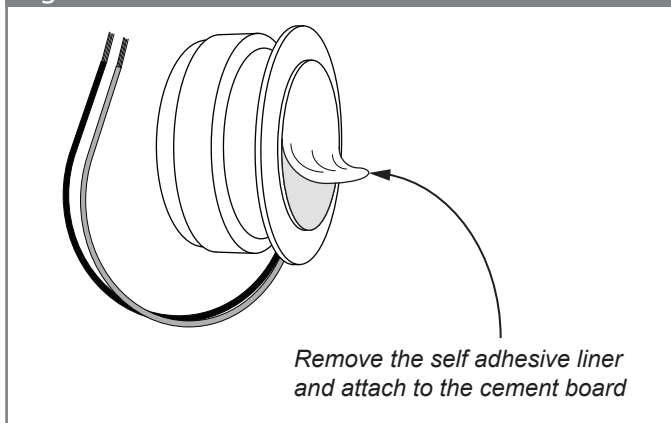

Figure 2

Do NOT mount directly to tile.

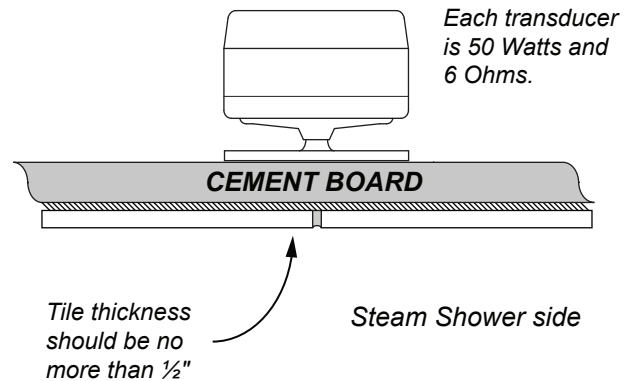

Figure 3

Right or Left channel shown. Separate the right and left channel to opposite ends of the ceiling or the room.

