



# **Model G6 Outdoor Sauna Room**

## **Installation Manual**

Note: Please read manual before installation



## 1. INSTALLATION REQUIREMENTS

The base or foundation for Sauna must be **leveled** and **stable**. Sauna must be at least 3 inches higher from the surrounding ground. All base beams must have a support under them.

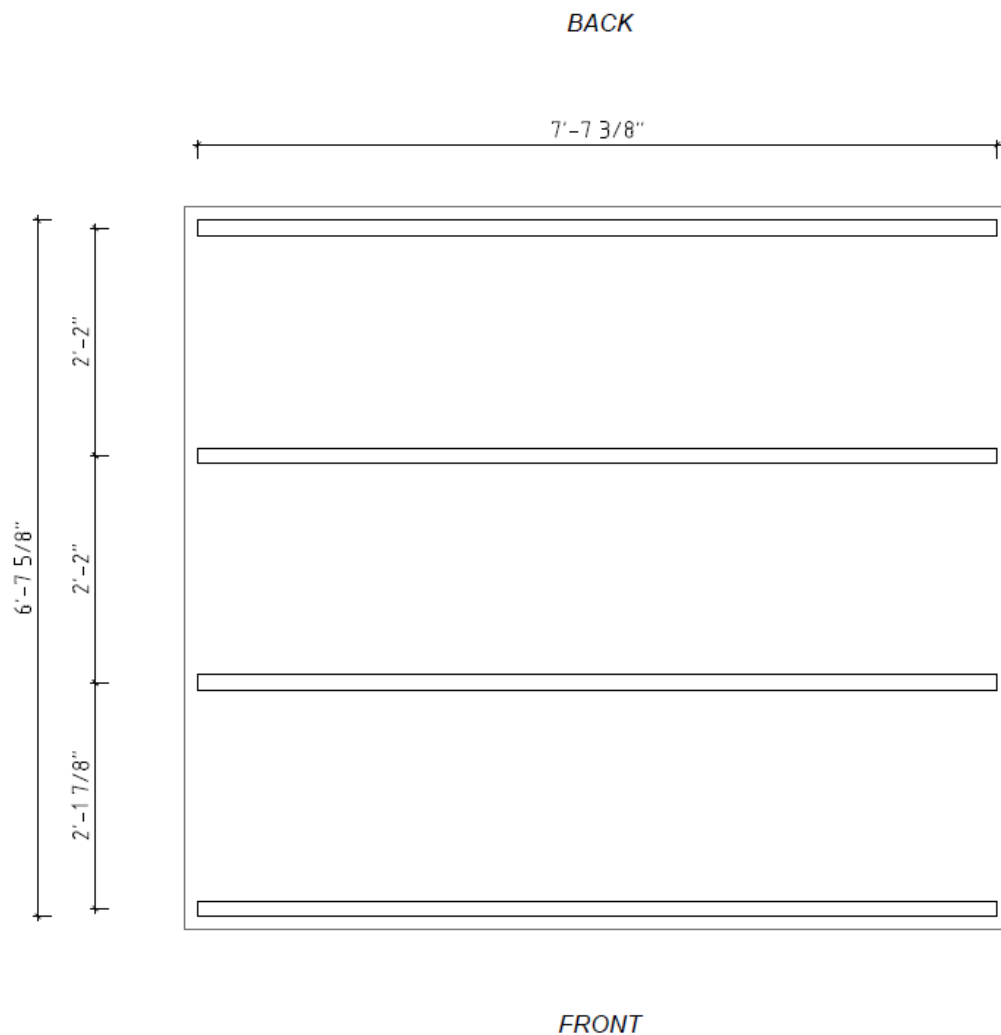

### **Recommendation:**

*We recommend placing Sauna on concrete blocks or strips that have a compressed gravel underneath. Using geotextile under the Sauna prevents the growth of grass and weed.*

*It is also possible to place the Sauna on terrace or pavement, but the Sauna should still be higher than the surface.*



## 2. TRANSPORT

Sauna can be lifted from **above**:

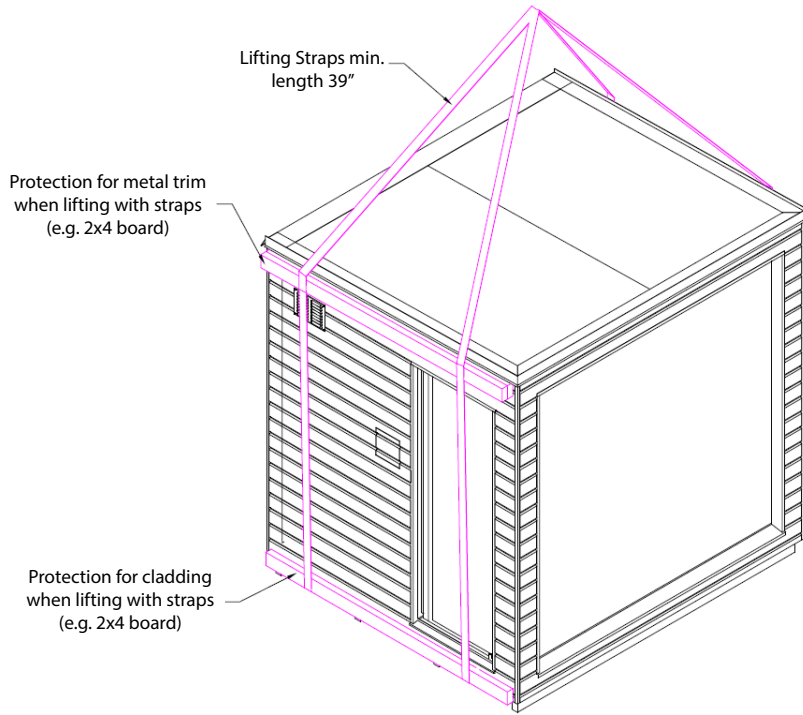

Sauna can be lifted from **below**:

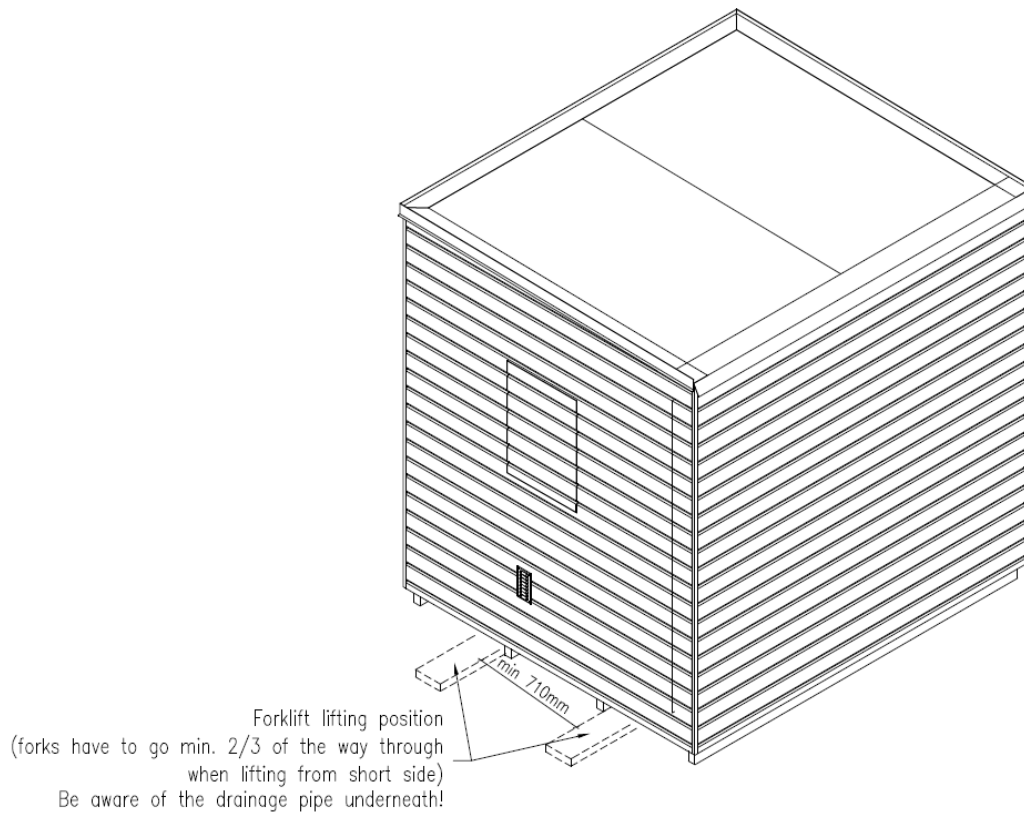



### 3. FINAL ASSEMBLY

Final assembly shall be organized **by the client**.

Final assembly includes installing of the:

- Decorative base boards
- Heater (+ control unit)
- Rainwater system
- Main Electrical Cables

Sauna door must be adjusted after the final installation.

#### 3.1 Final Assembly Instructions

**3.1.1 Base boards** are for decorative purposes and easy to install. **Rainwater system** must be installed when sauna is exposed to rainwater.

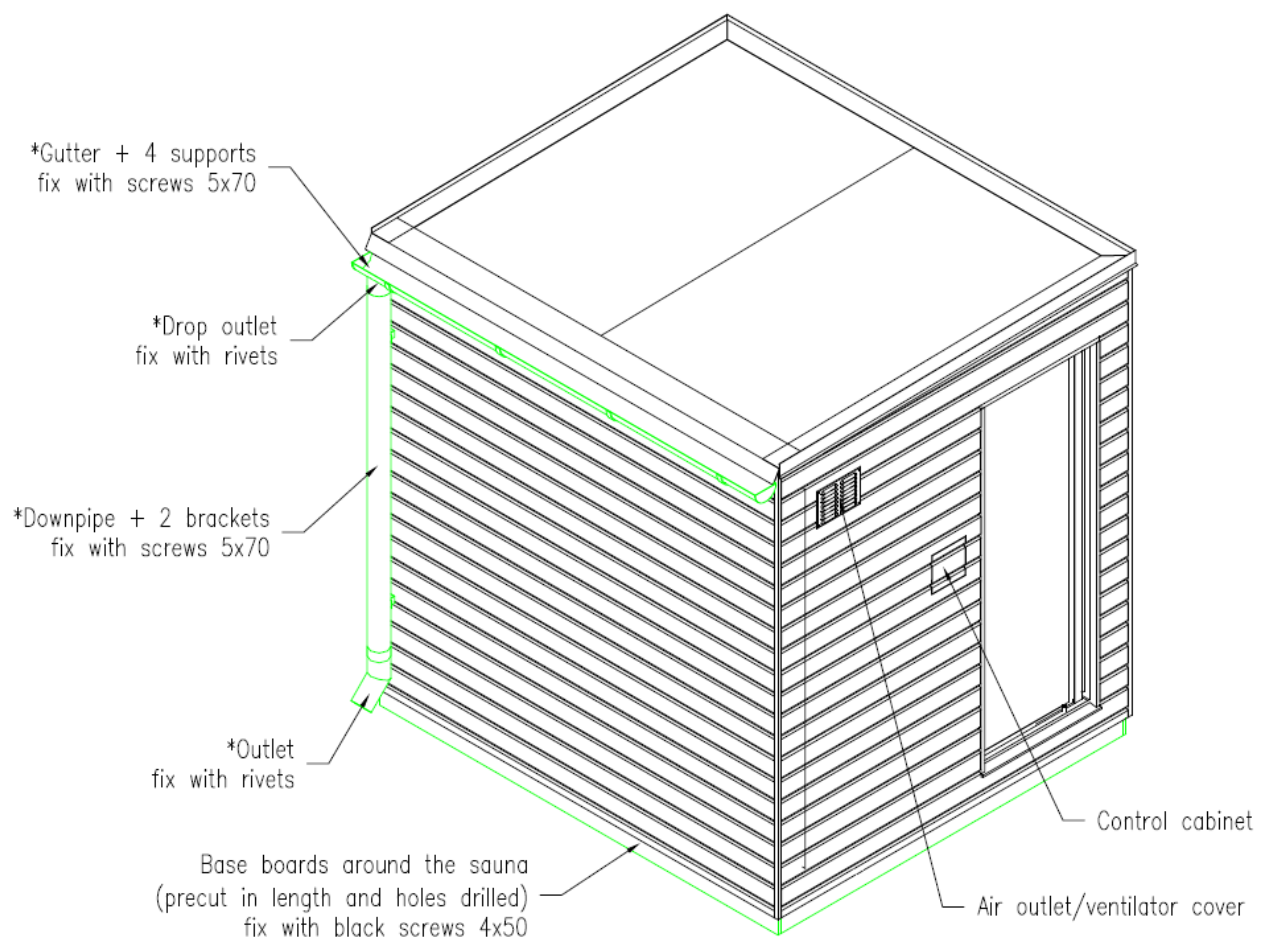



#### **4. MAINTENANCE**

Maintenance of the outdoor cladding should be done once a year.

If sauna is used twice a week, then interior cladding, sauna bench and floor grid should be oiled once a year.

#### **5. IMPORTANT SAFETY REQUIREMENTS**

Sauna door must be closed during heating to avoid over-heating!



Technical Support  
(224) 253-5909