

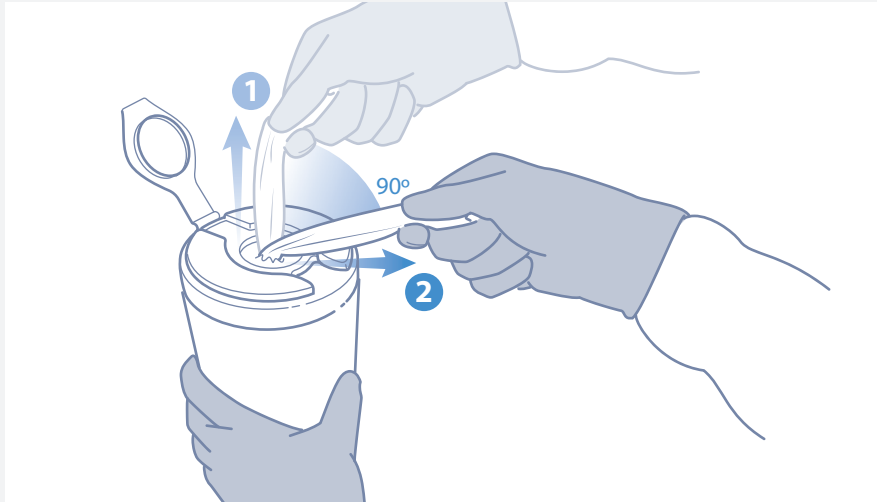

If gross debris is present on the surface:

1. Pull out CaviWipes1 towellette, tearing at a 90° angle.



2. Use CaviWipes1 towelette(s) to completely pre-clean surface of all gross debris. Once surface is clean, dispose of used towelette in accordance with Federal, State, and local regulations for infectious materials disposal.

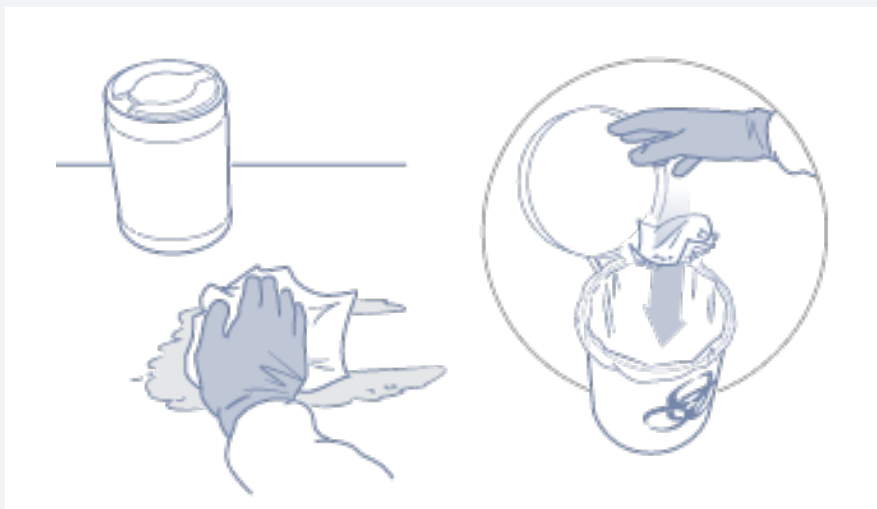

Disinfect after Cleaning

4. Pull out additional CaviWipes1 towelette.

5. Disinfect pre-cleaned surface with towelette. Leave surface wet for 1 minute. Dispose of used towelette.

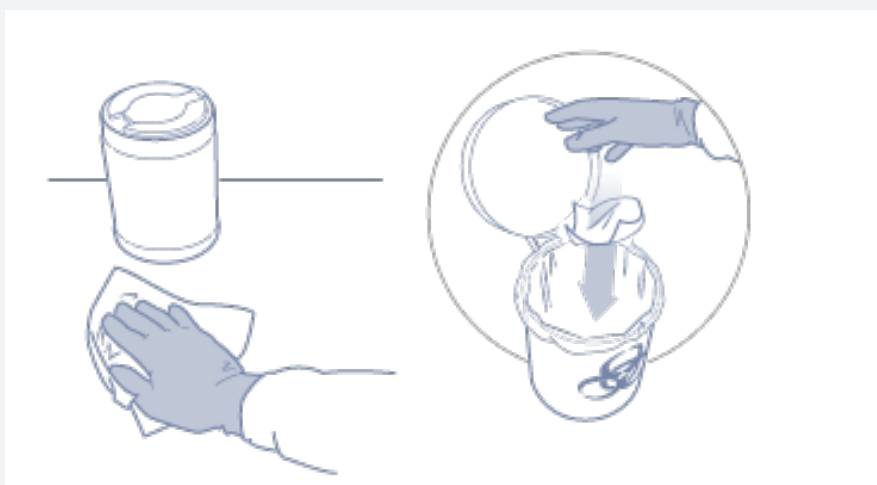

If NO gross debris is present on the surface:

1. Pull out CaviWipes1 towellette, tearing at a 90° angle.



2. Disinfect surface with towelette. Leave surface wet for 1 minute. Dispose of used towelette in accordance with Federal, State, and local regulations for infectious materials disposal.

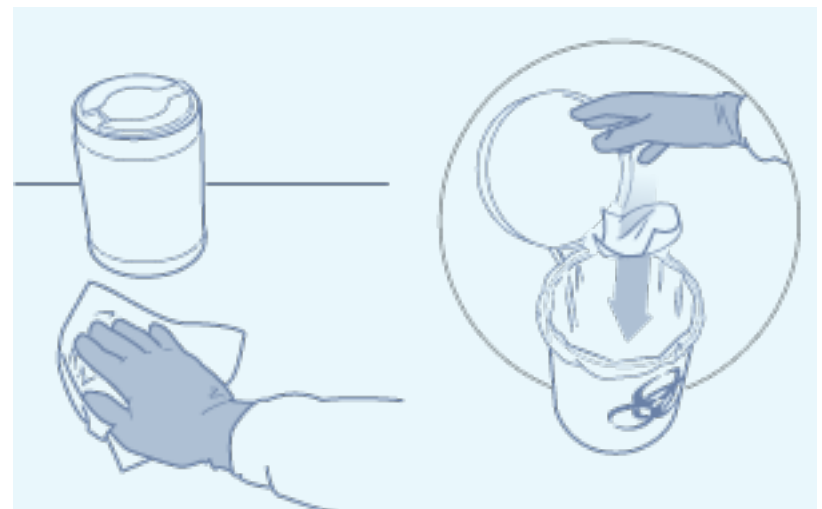

Ordering Information

Part No.	Description
CAVIWIPE01	CaviWipes1 (6" x 6.75"), 160 count

