

## PASSAGE SET

## COMPONENTS

- | HANDLE SET
- | 1A-SSS

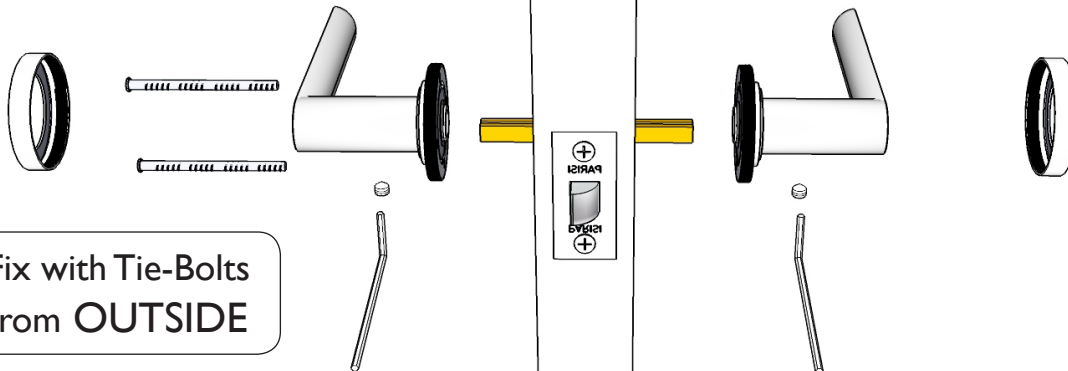

Fix with Tie-Bolts  
from OUTSIDE

## PRIVACY SET

## COMPONENTS

- | PRIVACY
- | HANDLE SET
- | 6002-SSS

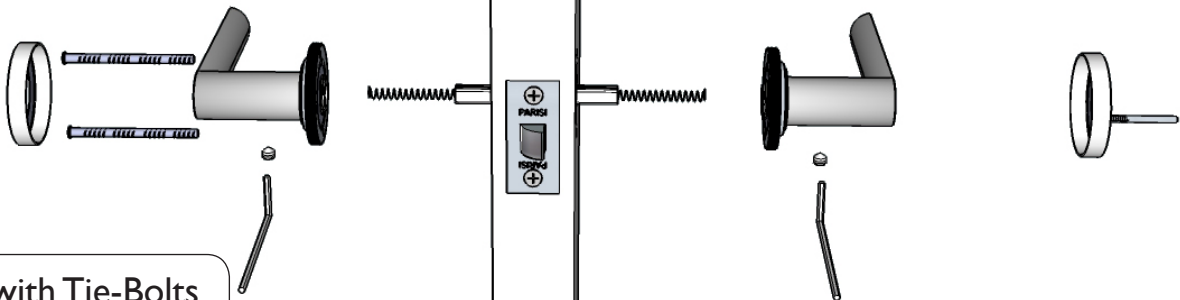

Fix with Tie-Bolts  
from OUTSIDE

## ENTRANCE SET

## COMPONENTS

- | HANDLE SET
- | 2200-SC
- (Backset to specify)
- | F4 cylinder
- 2 9489-Y Escutcheons

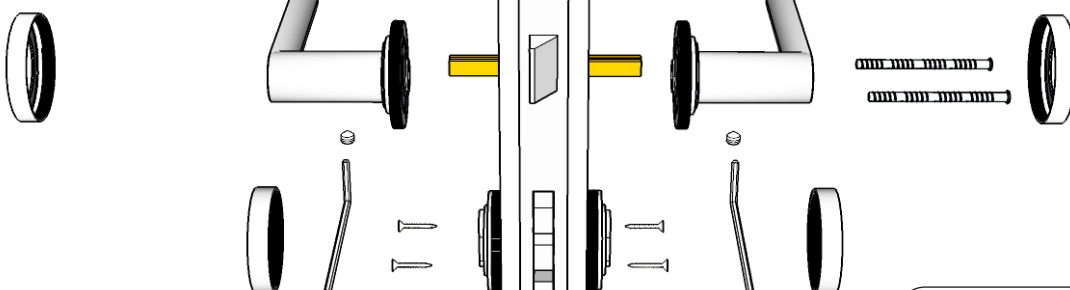

Fix with Tie-Bolts  
from INSIDE

## CUT-OFF SCREW

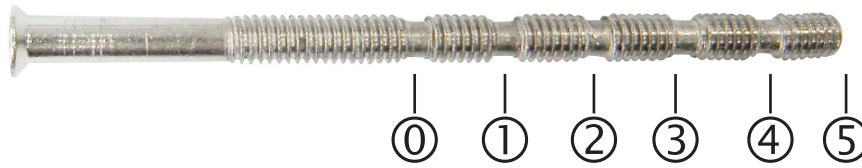

Sections	DOOR THICKNESS	SPINDLE	COMMON USE
2	28~32	STD 120mm	INTERNAL DOOR
3	36~41	STD 120mm	EXTERNAL DOOR
4	42~47	STD 120mm	
5	50~54	STD 120mm	

120m spindle supplied is suitable for door thickness 28mm ~ 70mm.

For thicker doors please order optional longer spindle at extra cost.

N.B. It is recommended that the cut-off screw be cut to right door thickness, before installation.

All fixing screw holes are fully threaded. Use a cordless to thread the cut-off screw all the way through one side. The smooth screw-head end will then spin freely on one side allowing for threading onto the opposite rose. Recommended that the cut-off screws be installed on out-side of door. EXCEPT for entry doors.

This is to facilitate removal of handles in case of emergency.

Cut along dotted line.

**IMPORTANT NOTE:**  
Door must be drilled in sequence.  
1) Two holes diameter 4mm  
(Use the 1A or 1B as required,  
there is no need to do both.)  
2) One hole diameter 20mm  
3) One hole diameter 22mm

**NOTE:**  
All dimensions are nominal.

### INSTALLATION TEMPLATE FOR PASSAGE SET

60 mm Backset

1A 1B 1B 1A

2

Mark Door at recommended  
965mm from floor or at  
desired height.

FOLD HERE AGAINST  
EDGE OF DOOR

35 mm  
40 mm  
45 mm

3

MARK FOR 22 mm  
HOLE at centre of  
Door Thickness

Cut along dotted line.

**IMPORTANT NOTE:**  
Door must be drilled in sequence.  
1) Two holes diameter 4mm  
2) One hole diameter 12mm  
3) One hole diameter 20mm  
4) One hole diameter 25mm

**NOTE:**  
All dimensions are nominal.

### INSTALLATION TEMPLATE FOR PRIVACY SET

60 mm Backset

1 1

3 2

Mark Door at recommended  
965mm from floor or at  
desired height.

FOLD HERE AGAINST  
EDGE OF DOOR

35 mm  
40 mm  
45 mm

4

MARK FOR 25mm  
HOLE at centre of  
Door Thickness