

Instructions for using

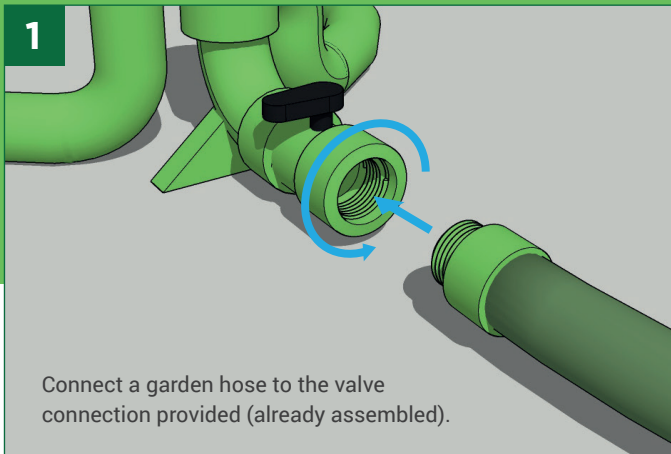

**TREE
HUGGER**
SPRINKLERS



Connect a garden hose to the valve connection provided (already assembled).

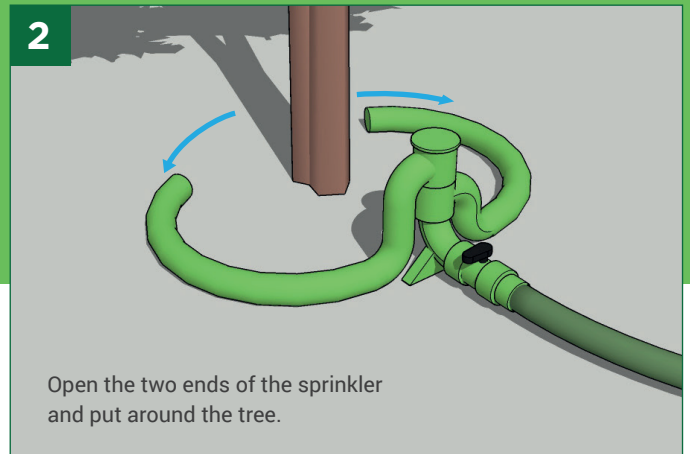

Open the two ends of the sprinkler and put around the tree.

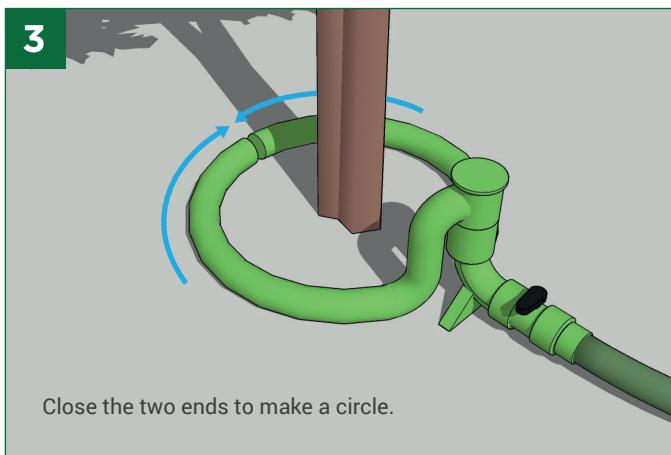

Close the two ends to make a circle.

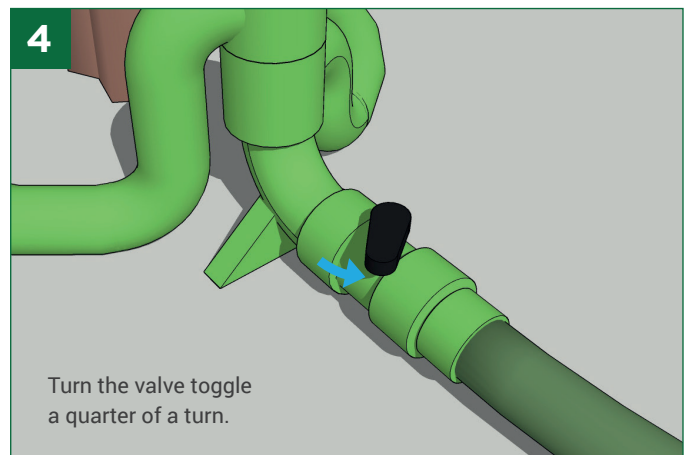

Turn the valve toggle a quarter of a turn.

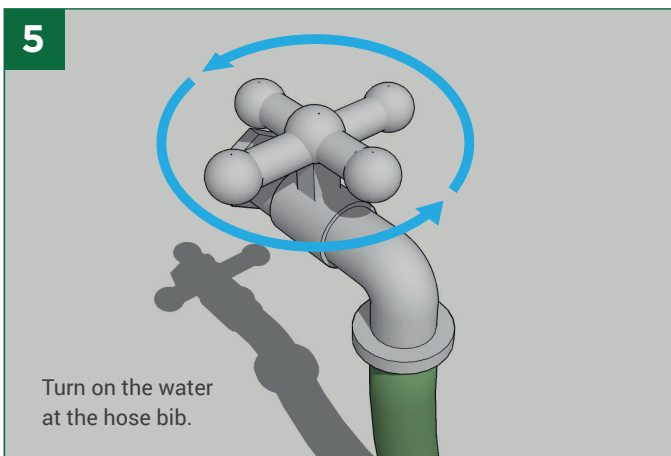

Turn on the water at the hose bib.

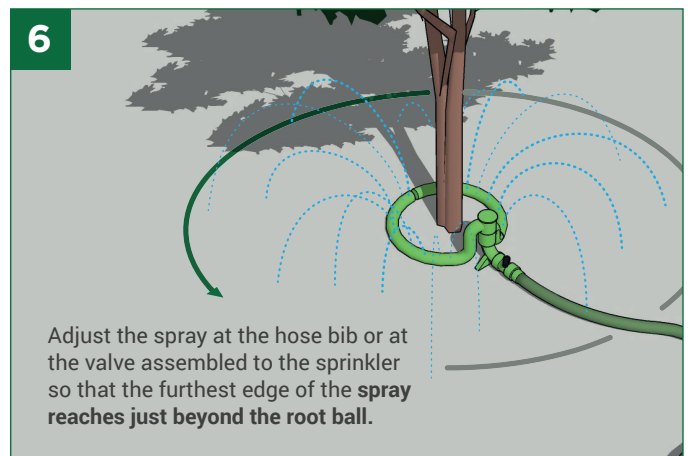

Adjust the spray at the hose bib or at the valve assembled to the sprinkler so that the furthest edge of the **SPRAY** reaches just beyond the root ball.

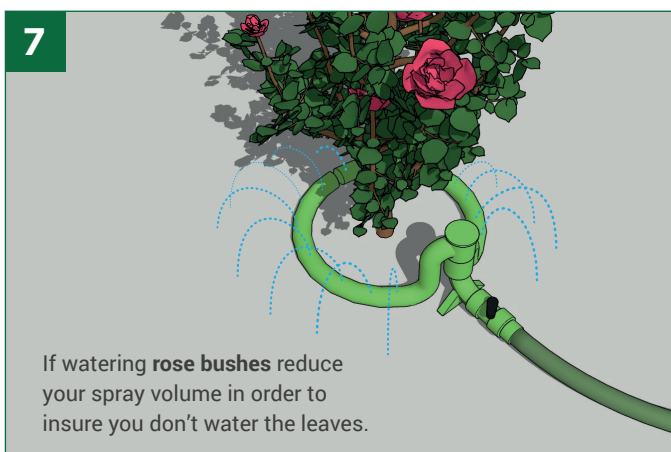

If watering **rose bushes** reduce your spray volume in order to insure you don't water the leaves.

The Instructions for using a Tree Hugger Sprinkler are the same for all **three sizes**.



(17 cm)



(28 cm)



(38 cm)

treehuggersprinklers.com