



As a precaution, gloves and eye protection should be worn when handling drug substances and using test units. Do not puncture any part of unit. Do not remove probe once a capsule is broken. In the unlikely event of a spill, rinse affected area thoroughly with water. Keep out of reach of children. All results are presumptive. If necessary, further testing by a competent drug testing lab can provide additional identification.

Test Preparation	1	Remove the Smart-Tip [™] probe from test unit.	2		Sample suspected substance.			
			Powder	Tablet	<p>Touch the Smart-Tip[™] probe to the sample.</p>	<p>Firmly press Smart-Tip[™] probe on the tablet while scrubbing in a circular motion until the tip is completely covered with substance.</p>		
Test Preparation	3	Lock Smart-Tip [™] probe into test unit. Press firmly.	STOP Do not continue unless probe is locked below the Flex Pins and cannot be removed from the test unit.	Identification	4	With thumb and forefinger, squeeze chamber 1 until capsule breaks.	5	Gently shake test unit for 2-3 seconds.

Results



The appearance of a yellow color within one minute indicates the presence of a Cathinone, or an analogue such as **Mephedrone**, Buphedrone, Methylcathinone, or N,N-Dimethylcathinone.



If no yellow color develops with one minute, the above listed drugs are **not** present.



Proceed to Dilution (steps 6-9), regardless of whether or not a color appeared.



Dilution

6

With thumb and forefinger, squeeze chamber 2 until capsule breaks.

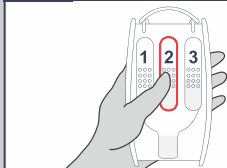

7

Gently shake test unit for 2-3 seconds.



Wait 5 minutes.
The test window will warm up.
This is normal.

Dilution

8

With thumb and forefinger, squeeze chamber 3 until capsule breaks.

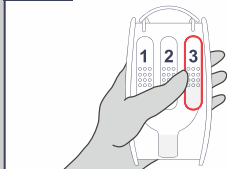

9

Gently shake test unit for 2-3 seconds.



The test window will warm up.
This is normal.



Disposal

After Dilution, the test kit is safe to dispose of in the trash.

NET 07-21

IMPORTANT INFORMATION

1. IDenta Touch&Know[™] Discreet Drug Test Kits are used to determine the presence of certain drugs in substances such as powders, crystals, granules, flakes, pills, tablets, or liquids.
2. All results are **presumptive**. If necessary, further testing by a competent drug testing lab can provide additional verification.
3. A color change indicates a positive result for the listed drugs **only if it occurs within the first minute**.

If there is **NO** color change within the time indicated, the listed drugs are **NOT** present in the tested sample. After a minute, the sampler and the liquid may begin changing color as a normal part of the testing process and this color change does **NOT** indicate a positive result.