



R6-72V 24AH

Official site: www.nanrobot.com

Contact & Support email : [support @ nanrobot.com](mailto:support@nanrobot.com)

USER MANUAL
E L C T R I C S C O O T E R

THIS MANUAL CONTAINS IMPORTANT INFORMATION TO HELP YOU USE YOUR PRODUCT MORE SAFELY.

Using This Manual

This manual contains detailed information about the product and its equipment, as well as information on operation, maintenance and other tips useful to all users. Please read carefully and be familiar with the electric scooter before use to ensure safe use and prevent accidents.

This manual contains many warnings and precautions for safe operation and the consequences of problems that may occur if proper setup, operation and maintenance are not performed. Please read all the information in this manual carefully, and if you have any questions, please contact NANROBOT immediately. This manual and any other documents accompanying the electric scooter should be kept in a safe place for future reference, but all contents of this manual are subject to change without notice.

 **NOTE:** This manual is not intended to be an exhaustive reference for service, maintenance and/or repair. Consult for service and technical support, you can find out more about our products or find dealers through www.nanrobot.com. If you lack assembly experience, we recommend that you seek assembly services from your local electric scooter shop or dealer. Proper assembly and safe riding are essential.

Content

Safety Warnings	01
Scooter Overview	03
Product Specification	04
Assembly	06
General Operation	08
Dashboard	09
Function Description	10
Battery Overview	13
Warranty Guarantee	14
Customer Support	15
Maintenance and FAQ	16

Safety Instructions

Safety Guidelines and Restrictions



*Even if that is within the warranty period, you may be liable for any accident caused by any of the following causes.

1 Do not ride your scooter in the heavy rain or wet environment, otherwise the battery may be damaged.

2 It is forbidden to jump, fall and other stunt jumps, which will have a great impact on the product and easily cause malfunctions and accidents.

3 Please be careful with it. Serious injury may result if body parts such as fingers or hair are caught in rotating or folding parts of the product.

4 Do not brake suddenly while driving. This could cause it to fall over.

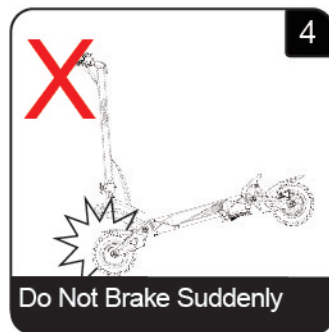
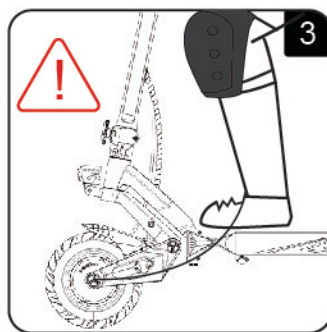

Safety Instructions

Safety Guidelines and Restrictions



Caution

*Even if that is within the warranty period, you may be liable for any accident caused by any of the following causes.

- 5** Do not open or tune the electric parts (battery, controller or motor system).
- 6** This product is intended for one adult only, so children, infants, or two people are prohibited from boarding.
- 7** Slow down at downhill. When reducing the speed, to prevent brake overheat, use the brakes properly to reduce the heat on the disk with proper brake use.
- 8** Mountain roads with slopes exceeding the specifications may cause the product to malfunction.

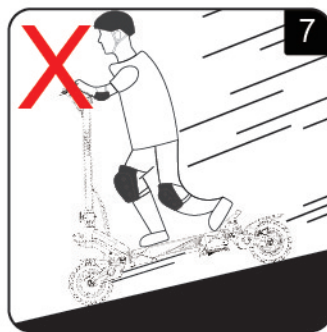
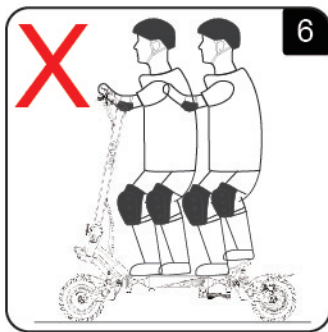

Scooter Overview



Product Size

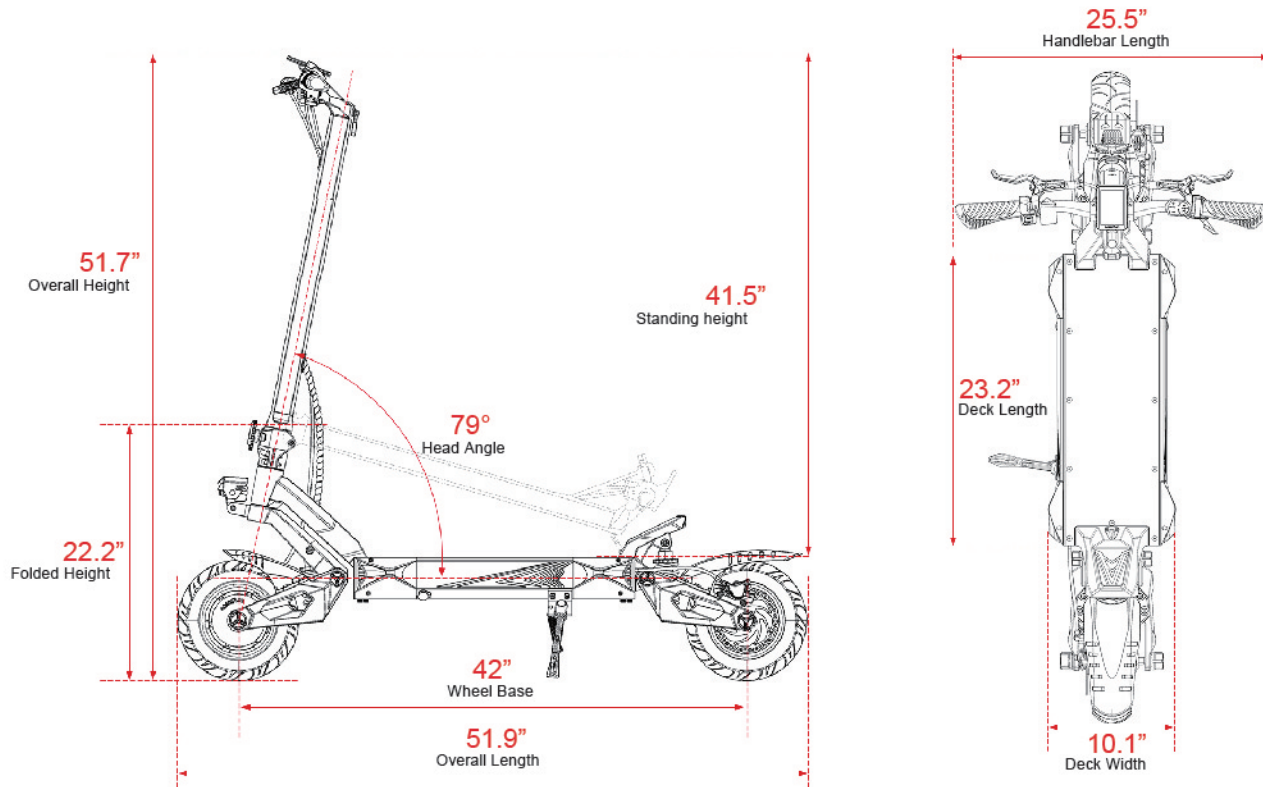

Specification

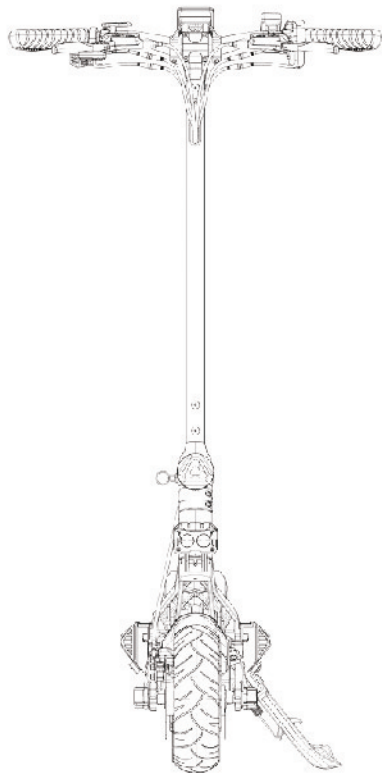

BATTERY	72V 24AH
MOTOR	Front 1500W + Rear 1500W
MAX SPEED	45 MPH
MAX RANGE	70 Miles (depends on riding condition)
N.W/G.W	39.5 KGS / 46.5 KGS
LOAD CAPACITY	150KG
BRAKES	Dual Hydraulic Brake
SUSPENSION	Front and Rear
GEAR	3
FOLDABLE	Yes
CHARGING TIME	12h (single charger)
MATERIAL	Aluminum Alloy
PNEUMATIC TIRE	10 Inches
SCOOTER SIZE(CM)	132*70*128
FOLD SIZE(CM)	132*70*56
WATERPROOF RATING	IP54

Assembly Process

Unfolding

- 1** The first step is to unfold your electric scooter. To do this, make sure the hooks are not caught on the rear foot board. If it is, push the rod down and remove it from the rear footboard.
- 2** Unfold the steering bar by pulling it to a vertical position. Ensure you do so until the Steering Bar is completely vertical.
- 3** Make sure the steering bar is secured by turning the safety lock to the right until it is tight.
- 4** Lastly, make sure the safety button of the folding mechanism is clipped to the steering bar. This safety mechanism prevents the latch from unlocking due to vibration or shock.



Install handlebars

1 The first step is to remove 4 screws in order to install the handlebar of the electric scooter.

2 Put on the handle of the electric scooter, then align the mounting module with the four screw holes, and press the module.

3 Press and hold the installation module, and screw the four screw holes to the right respectively, don't tighten it, just hang it.

4 Finally, tighten the screws on the four screw holes to the right to ensure that the handle is installed securely.

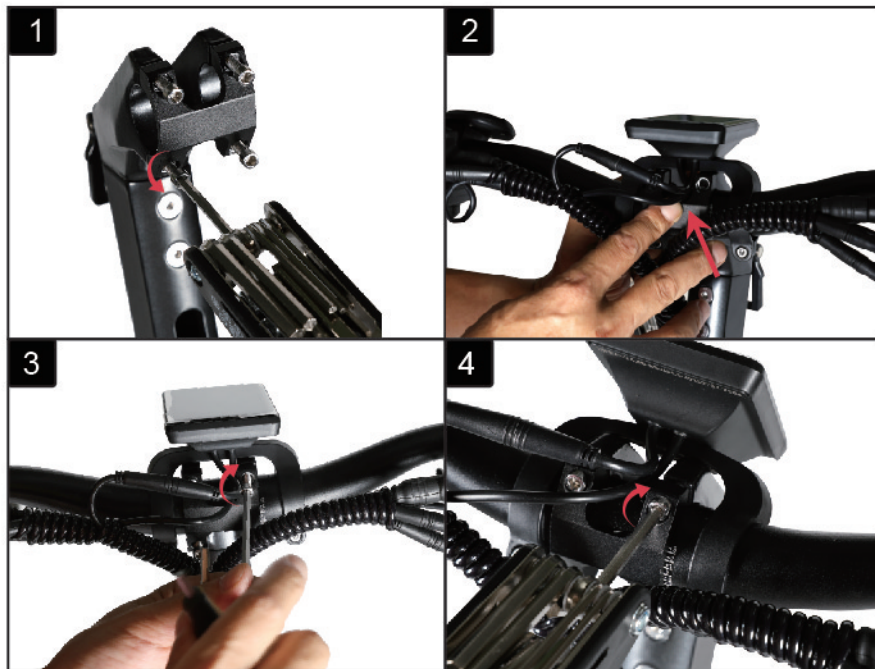

General Operation

Power Switch

- 1 Place NANROBOT card at the designated location on the dashboard and the scooter will be successfully unlocked.





- 2 Press and hold the power button for 3 seconds to turn on the LCD display. You will then see the meter turn on on the screen.



* Do not hang the NANROBOT card close to the NFC recognition area during the riding.

Dashboard



- **Speed Indicator:** AVG SPEED, MAX SPEED, RT SPEED
- **Speed Mode:** It is displayed as Km/h or MPH
- **Battery Indicator:** It provides stable battery reminders through an optimization algorithm. Power is unaffected by motor start and stop fluctuations. If the system supports battery communication, it can display accurate battery percentage.
- **Brake Indicator:** When brake, the icon  shows up on the screen.
- **Assist Level:**When the power is on, it will show PAS 1, the top speed is 20Km/h; Press the "+" button, it will show PAS 2, the top speed is 45Km/h; Press the "+" button again, it will show PAS 3, the top speed is 70Km/h.
- When an error is detected, an icon  will be displayed on the screen.
- **Mileage Mode:** "TRIP", "ODO", "TIME".
- **Mileage Display:** Displays mileage information or time information.
- **Error Code:** 01: Phase wire fault on the motor. 02: Hall sensor fault. 04: Throttle abnormal. 05: under-voltage protection. 06: controller fault. 07: communication fault. 08: over-temperature protection. 30:Communication fault.

Function Description

Button description as follows:



- Press and hold POWER button to turn on or turn off the display. The display will automatically shut down when there is no operation& ride for 5 minutes (X could be 0-9).
- In the manual shift mode, short press + or - button to switch the assist level and change the assist ratio. The top assist level is 3. The default value is 1st when the display is turned on, and 1 is the neutral assist.

*Turn on the default dual-drive mode, the instrument displays PAS 1, press and hold the "+" button for 3 seconds to switch between single-drive mode or dual-drive mode.

- When powered on, short-press POWER to switch the mileage display mode. And the following information is displayed cyclically: riding time (Time) → accumulated mileage (ODO) → power information (Pow) → single mileage (Trip).
- Press the M button to switch the speed display mode, and the following information is displayed cyclically: real-time speed (RT SPEED) → average speed (AVG SPEED) → maximum speed (MAX SPEED).

* If there is no key operation for 5 seconds, the system will automatically return to the real-time speed display state.

- To zero the data out, including AVG Speed, MAX Speed, Trip, and Time, hold the PLUS and MINUS buttons for a few seconds.

* These temporary data will not be erased when the display or the scooter is powered off.

- Press the M button twice within 0.3S, it will enter the menu. Press the M button twice again to exit (the time interval must be within 0.3S).
- In the power-on state, the USB charger is turned on by default. Charging parameters: DC 5V 500mA.

P-Setting Instruction

Accessing Settings

- Press the M button twice within 0.3S, it will enter the menu. Press M button twice again to exit .
- Press the M button to select the desired adjustment item, and the item starts flashing. Click the plus button and minus button to adjust the parameters, press the M button once to save the setting, double click M to exit the menu.
- **P1:** Backlight Brightness: Press + or - button to select brightness levels. It has five options from 1 to 5.
- **P2:** Auto power off time: Press + or - button to adjust auto off time.1 ~ 9 minutes represents the automatic shutdown time. Or you can click OFF to cancel the auto off function.
- **P3:** Universal / Imperial: Press + or - button to switch km / h or MPH. 0 stands for universal system and 1 stands for imperial system.
- **P4:** Manual / Automatic Switching: Press + or - button to select manual / automatic switching. 0 means manual, 1 means automatic.

* In the parameter setting state, if no key operation is performed for 30 seconds, the system will automatically exit. In the riding state (the speed indication is not 0), it cannot enter the setting interface. If you start cycling in the setting interface (the speed indicator is not 0), it will automatically exit the setting.

Battery Overview

- The charger getting warm during use is normal. If your charger doesn't get warm during use, it does not mean that it's not working properly. In the event of a short circuit, your battery will automatically stop output to protect itself.
- Do not charge the scooter immediately after a long-distance ride. Please wait at least 30 minutes. Plug the charger into an AC outlet first, then connect the other end to your scooter's charging port.
- As a safety recommendation, do not leave the scooter charging for more than 12 hours.
- Ensure the room temperature is between 15 and 30 °C for ultimate.

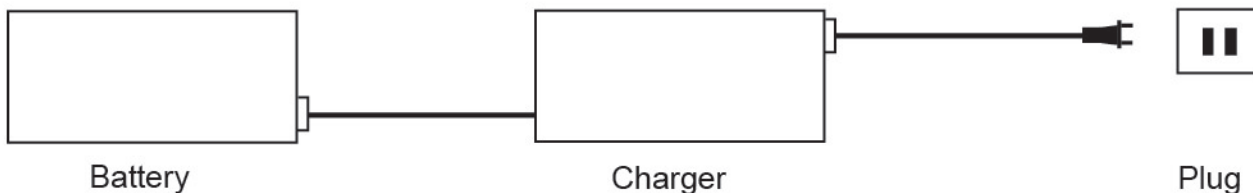

Battery Capacity:

72V

24AH

Limited Warranty Exclusions

This Limited Warranty describes the service available to you in the event your product requires warranty service and you may have additional protections under your local laws. This Limited Warranty does not cover and excludes damage to your product or any component thereof caused by:

1. Abuse, misuse, recklessness, negligence, or commercial use.
2. Improper charging, storage, maintenance, or operation of the product not in compliance with instructions or limitations as provided in the user materials.
3. Use of the product not in compliance with applicable laws and regulations.
4. Use of the product by persons with inadequate experience.
5. Accident, collision, riding at unsafe speed on paved roads, riding at unsafe speed on unpaved roads, riding over obstacles, amateur racing, professional racing, use in backcountry sports, fire damage, water damage, chemical damage, use of the product outside of the product's working temperature range, high-pressure water spray, earthquake, dropping, loading with excessive weights.
6. Modifications to mechanical parts, modification of electronic parts, or modifications to software embedded in the product.
7. Service, repair, and maintenance by unauthorized providers.
8. Cosmetic damages.
9. Use of the product with third party product, component, or accessory.
10. Use of the product with overdue wear and tear parts.
11. Man-made damage due to personal reasons.

In no event NANROBOT parties' total and aggregate liability for all claims under any and all applicable law or theory, jointly or severally, arising out of or related to the purchase of the product, breach of contract, tort (including negligence) or otherwise exceeds the duty to repair or replace any defective product, further subject to NANROBOT's sole and exclusive discretion. In no event shall be NANROBOT parties be liable to any person for consequential, indirect, incidental, special, exemplary, punitive or enhanced damaged arising out of, or relating to, and/or in connection with the purchase of the product.

Customer Support

- Scooters manufactured by NANROBOT are pre-assembled, though some of the parts may require assembly by our customers. To help ensure the safety of your scooter and driving, please check and test everything before using your scooter. If your inspection finds an issue with the scooter, please contact your seller. You can also contact your seller if you need assistance with any of the assembly.
- To avoid damage during transport, we have safely packed all of the electric scooter components in foam and cardboard. If something is damaged upon arrival, please take photos or videos of the damaged parts. And promptly contact the seller, who will provide you with a solution.
- If your scooter is damaged due to an accident or misuse, you can buy replacement parts at nanrobot.com, the distributor or seller you made your purchase from, or you can send the scooter to be repaired. The buyer bears all repair costs. If there are other after-sale problems or questions, please send an e-mail to us at support@nanrobot.com.

Maintenance and FAQ

- The screws should be regularly maintained, inspected, and tightened. Especially the screws on the folding mechanism, brake system, and motors (axle nuts).
- Tighten the folding mechanism screws, handlebar, front & rear shock absorbers, and front & rear wheel axle nuts.
- Brakes: if you notice rust or excessive wear on your brakes, which will occur with regular use over time, you should replace your brake pads and rotors.
- Motor: Check the motor wires regularly. All exposed wires should be wrapped with electrical tape.
- Tires: Do not inflate the tires beyond the recommended air pressure range. The tires slide easily in wet conditions. Avoid rain, snow, icy road, wet dirt road, water, and low visibility. Replace the tires on your scooter as soon as the wear pattern becomes apparent. This will prolong the use time of the scooter.
- Battery & Overheat protection: The controller and the battery have temperature sensors, the scooter stops working when it is overheated. Please wait about 0.5-2 hours for the scooter to cool down or continue riding in eco/1st gear after 5-10 minutes.



www.nanrobot.com