

HEAD OFFICE



1 Genting Link

#02-04, Perfect One

Singapore 349518



(+65) 6748 2277



(+65) 6744 0033



sales@hakko.com.sg



@hakkoproducts

How to shape D and examples

This shape is capable of any soldering by placing the tip end in 2 ways: line and face. Therefore it requires soldering skill such as **Shape B**. The followings introduce four works by placing the tip end in Face. Please try the tip shape D if in trouble such as bridging, faulty fillet formation, insufficient wetting, etc.

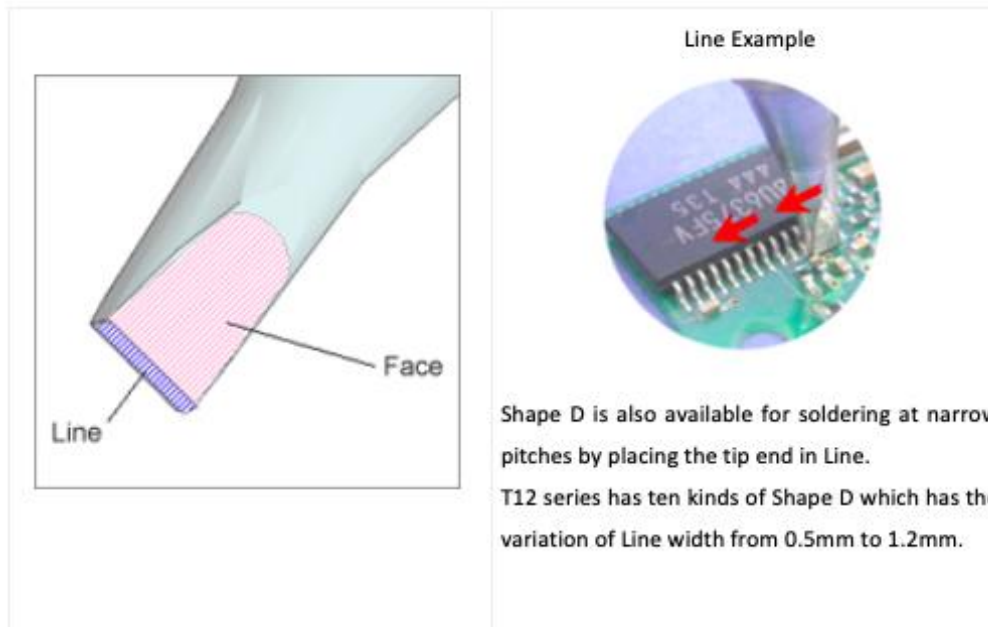

Shape D is also available for soldering at narrow pitches by placing the tip end in Line.

T12 series has ten kinds of Shape D which has the variation of Line width from 0.5mm to 1.2mm.

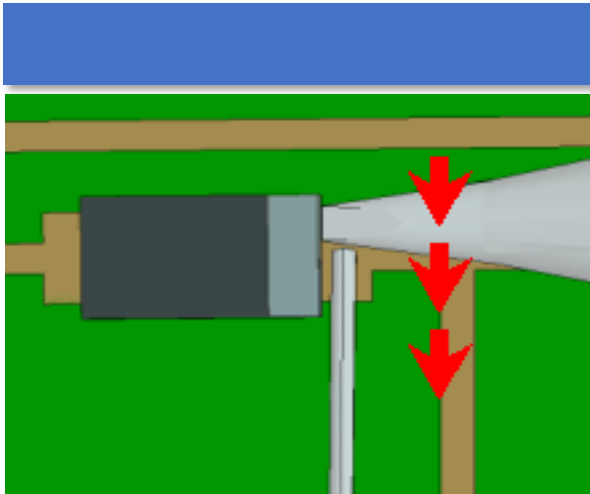

Put the tip end to the land and drag the tip slowly while feeding solder.

Note: Some IC is specified by manufacturer not to be touched electrode by tip end.

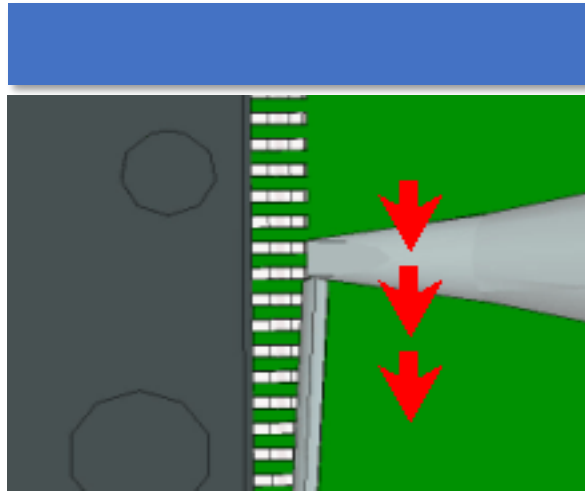

Put the tip end to the leads and drag it slowly.

Note: Apply flux to leads and land pads before soldering. It prevents the troubles such as solder bridge.

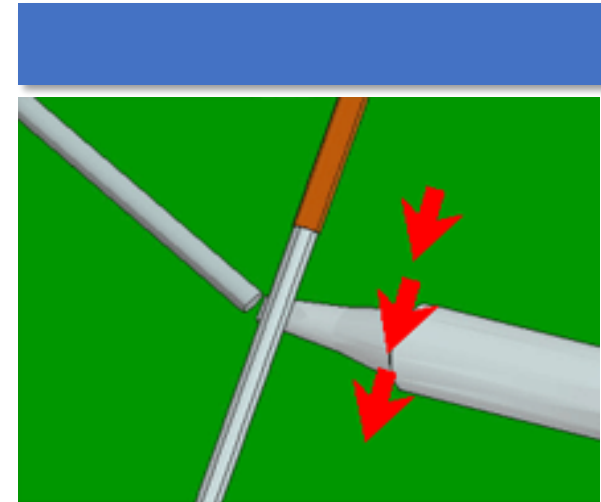

Put the cut surface to the lead and drag the tip slowly while feeding solder.

Point Soldering

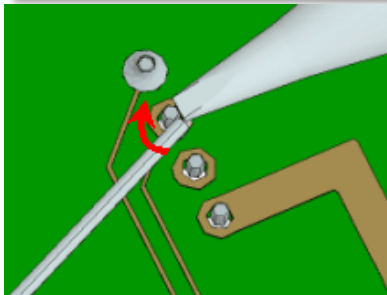

Put the tip end to the land pad and PTH at one time to heat them.

Feed solder to form smooth fillet on the land pad.

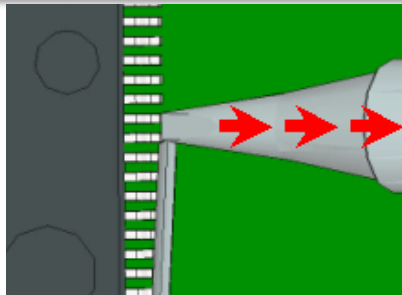

Put the tip end to the leads and drag it slowly.

Soldering Cup Terminals

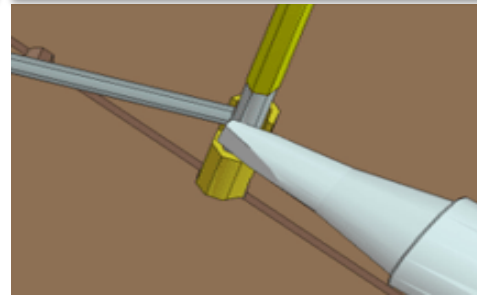

Put the cut surface to the lead and terminal at one time to heat them. Feed solder to form smooth fillets. **Note:** Get rid of gold plating of terminal and pre-tin lead wire. It makes solder spread over the terminal easily and prevents soldering defect.

Melting and Removing Coil

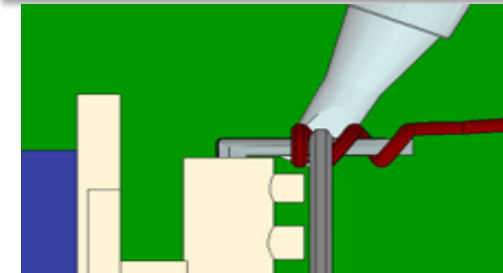

Put the cut surface to the coil and terminal at one time to heat them. Feed solder.