

INSTALLATION INSTRUCTIONS: 2017 HARLEY-DAVIDSON TRI-GLIDE MID PIPE ADAPTER KIT PART# 16784/46784

Please follow the instructions below, check the kit for missing or damaged parts and if you need any assistance please contact our technical support line (562) 921-7461.

HARDWARE

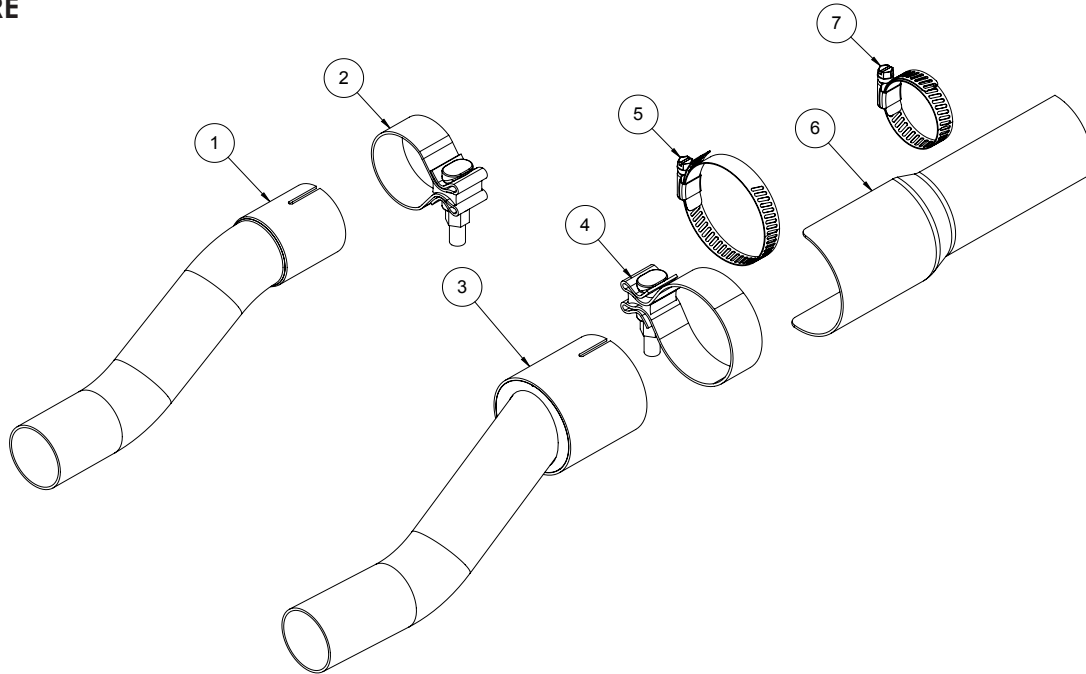

PARTS LIST

PART NO.	Description	Qty.				
1	D488RC	1	4	A337HW	2.625" Dia. Torca Band Clamp	1
2	A335HW	1	5	A276HW	1.81"-2.75" Hose Clamp #36	1
3	D444RC	1	6	D444HC/HP	Heat Shield Assembly	1
			7	A270HW	.81"-1.75" Hose Clamp #20	1

TOOLS REQUIRED

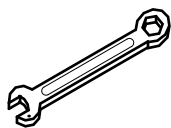

1/2" & 9/16" Wrenches

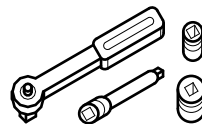

3/8" Drive Ratchet w/
extensions

9/16" Sockets

VANCE AND HINES INSTALLATION

1. Refer to owners manual for proper bike hoisting positions and techniques.
2. Prior to Power Duals Head Pipe installation, remove rear right side heat shield and slide the adapter pipe part #D4444RC and the A337HW Torca clamp over the end of the header (right side). Leave loose for adjustments. Note: D444RC Adapter pipe cannot be installed with Power duals installed on bike.
3. Refer to Power Duals Instructions and continue Power Duals installation.
4. With Power Duals installed, slide Adapter pipe part #D488RC and remaining Torca clamp on to end of the header (left side).
5. Position the torca clamps towards the inside of the bike with the nut facing down for access. (Figure 1)
6. Orient the adapter pipes with offset down and loosely tighten clamps.
7. Install muffler onto end of adapter pipes. Make sure clamps are oriented with the nut facing outwards from bike center and with the nut facing down. (Figure 2)
8. Thread the stock 5/16" bolts through the stock hanger into the muffler body. Check for proper reveal of the muffler from rear body trim (Figure 3). Tighten bolts.
9. Check for proper clearances. Maintain at least 3/8" from the rear sub frame and Adapter pipe and 1/2" from the differential housing. (Figures 4 & 5) NOTE Adjust Adapter pipe orientation if necessary to gain adequate clearance.
10. Tighten all 4 clamps.
11. Install heat shield part #D444HC (chrome) D544HP (black) onto right side header, using the #36 and #20 hose clamps. Note: Screw heads should be accessible when the system is installed on motorcycle for adjustment purposes.
12. Align heat shield and tighten hose clamps.
13. After installation and before starting the motorcycle, completely clean pipes and mufflers with cleaning solvent (chrome) or warm soapy water (black) and a clean soft cloth that will not leave residue. NOTE: Any residue, oil, or fingerprints will stain the finish when the metal heats up.

EXHAUST CARE

1. When installing a new set of chrome pipes, make sure your hands are clean and free of oil. After installation, thoroughly clean pipes with a soft cloth and cleaning solvent that will leave no residue before starting the motorcycle.
2. Avoid long periods of idling as this can cause discoloration.
3. Intake leaks can cause the engine to run lean and overheat, this could lead to discoloration.
4. Make sure there are no exhaust leaks at the junction of the exhaust pipes and cylinder head. We recommend replacing gaskets if they are worn.

EXHAUST CARE (BLACK)

1. When installing a new set of black pipes, make sure your hands are clean and free of oil. After installation, thoroughly clean pipes with warm soapy water and a soft cloth. Dry with a clean towel to remove any residue before starting the motorcycle. Do NOT use anything abrasive to clean the pipes.
2. Avoid long periods of idling as this can cause discoloration.
3. Intake leaks can cause the engine to run lean and overheat, this could lead to discoloration.
4. Make sure there are no exhaust leaks at the junction of the exhaust pipes and cylinder head. We recommend replacing gaskets if they are worn.

FIGURE 1



FIGURE 2



FIGURE 3



FIGURE 4



FIGURE 5

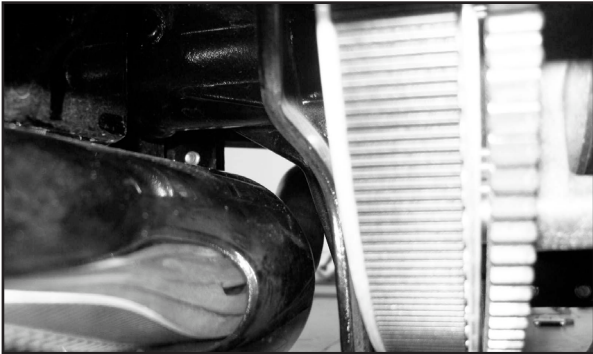

Emissions Notice:

In California, in order to meet Air Resources Board emissions requirements, certain aftermarket part applications have been identified as replacements, and others have received ARB Executive Orders. All other emissions related aftermarket parts are for competition use only. A list of replacement parts and EO parts, and corresponding fitment is provided at vanceandhines.com/california.

Warranty:

All Vance & Hines products are warranted against defects in material and workmanship for a period of 90 days. This warranty does not cover discoloration or rust. This warranty shall be limited to the repair or replacement of the product, which may be proven defective under normal use. Vance & Hines will not warranty any system that has been abused, misused, improperly installed or modified.

Dealers or distributors are not authorized to make dispositions binding upon Vance & Hines. Vance & Hines will not be responsible for any labor charges incurred in removing or replacing any system under warranty. A return authorization number and a copy of the original purchase invoice must accompany all returns. Parts returned without a return authorization may be refused.

13861 ROSECRANS AVENUE / SANTA FE SPRINGS, CA 90670
SALES: (562) 921-5388
TECHNICAL: (562) 926-5291
FAX: (562) 802-0110

vanceandhines
.com