



RADIO ADAPTER

WARNING!

Improper fitting or misuse will reduce effectiveness of earplugs and could result in hearing loss or injury.

Test thoroughly in progressively louder environments.

Wear hearing protection at all times that you are exposed to loud noise.

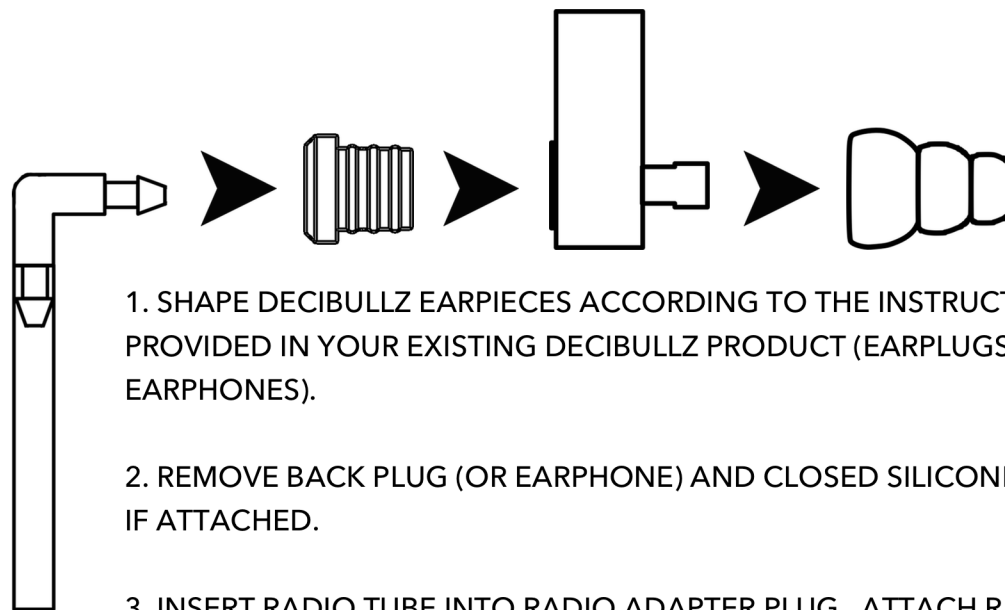

1. SHAPE DECIBULLZ EARPIECES ACCORDING TO THE INSTRUCTIONS PROVIDED IN YOUR EXISTING DECIBULLZ PRODUCT (EARPLUGS OR EARPHONES).

2. REMOVE BACK PLUG (OR EARPHONE) AND CLOSED SILICONE EARTIPS IF ATTACHED.

3. INSERT RADIO TUBE INTO RADIO ADAPTER PLUG. ATTACH RADIO ADAPTER PLUG AND CORRECT SIZE OPEN TRIPLE FLANGE CANAL TIP TO CUSTOM MOLD.