

Padova

PLEPDV5926

PLEPDV5926

59" L x 25⁵/₈" W x 21⁷/₈" H



Material	Eco-Lapistone™
Color/Finish	White Satin
Slope of Backrest	100°
Water Depth	14 ³ / ₄ "
Capacity	81.9G
Weight	165.5lbs (75.1kg)
Shipping Weight	249lbs (112.9kg)

 Made in Italy

Freestanding solid-surface Eco-Lapistone™ bathtub
Streamlined, high-profile one-piece design
Includes polished chrome waste
Slot overflow

What is Eco-Lapistone™?

Eco-Lapistone™ is made with plant-based material in place of fossil resins. It is 30% lighter than original Lapistone™ and 100% recyclable and restorable. With a luxurious velvety texture and consistent color throughout, the non-porous composition makes these tubs exceptionally strong as well as naturally hygienic and stain-resistant. The superior high-heat retention properties of Eco-Lapistone™ reduce water usage, and its production and delivery utilize less energy, further minimizing its carbon footprint.

Padova

PLEPDV5926

PLEPDV5926

59" L x 25⁵/₈" W x 21⁷/₈" H

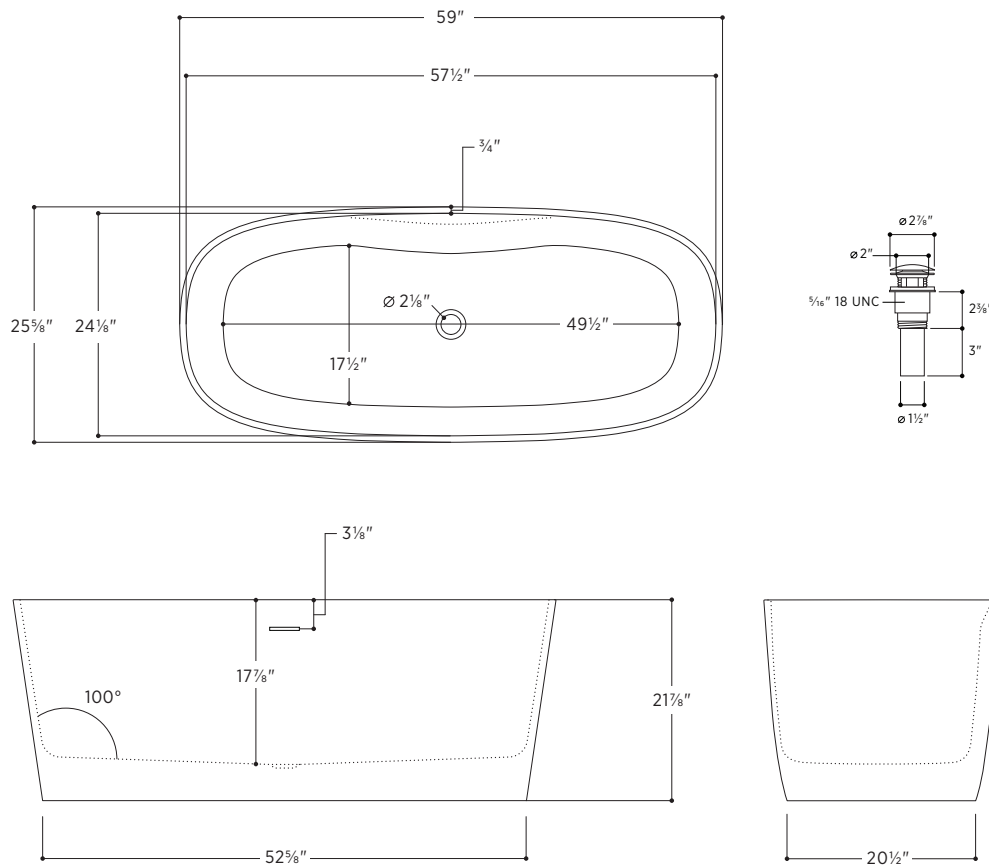

All measurements are approximate and for comparison only. Please note that these dimensions and specifications are subject to change without notice.

Install this product according to the installation guide. Floor support under bath must provide for a minimum of 995lbs (451kg). Installation may vary. Our products must be installed by certified professionals only and according to our installation guide, as well as federal, provincial/state and local building codes and regulations.

Codes/Standards Applicable:

Meets or exceeds ANSI/ASME standard Z124.1.2
and CAN/CSA B 45 requirements

IAPMO/UPC/cUPC

5 Year Warranty for Residential Use

