

This solution is only one example.

The starting position may be a mirror reflection of what you see here (exactly the opposite), but it can still be solved in the same way.

① Place the three internal pieces as shown in image.

*Once arranged like this, put the puzzle down on a flat surface.

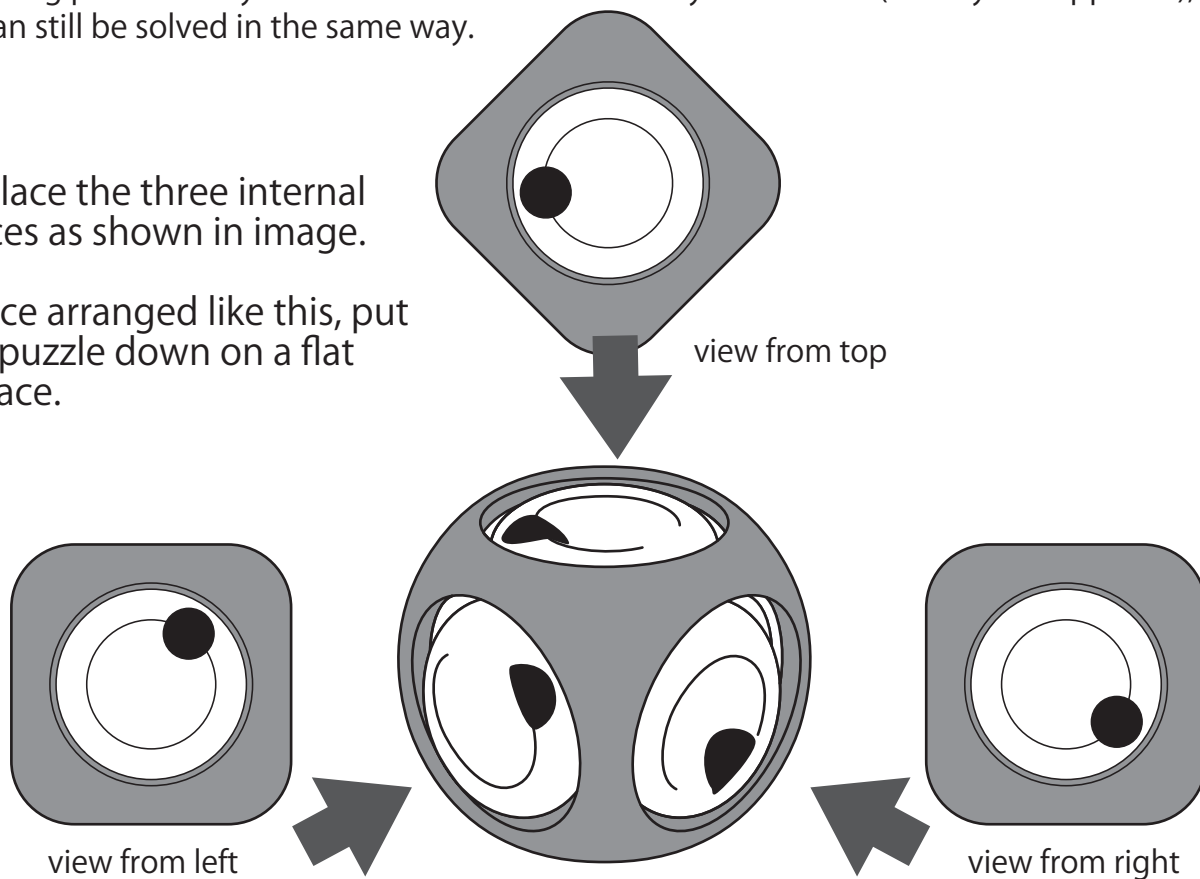

② Pick the puzzle up from the state in ①.
While doing so, move the pieces as shown below.

*The figure shows the face as seen from the right.

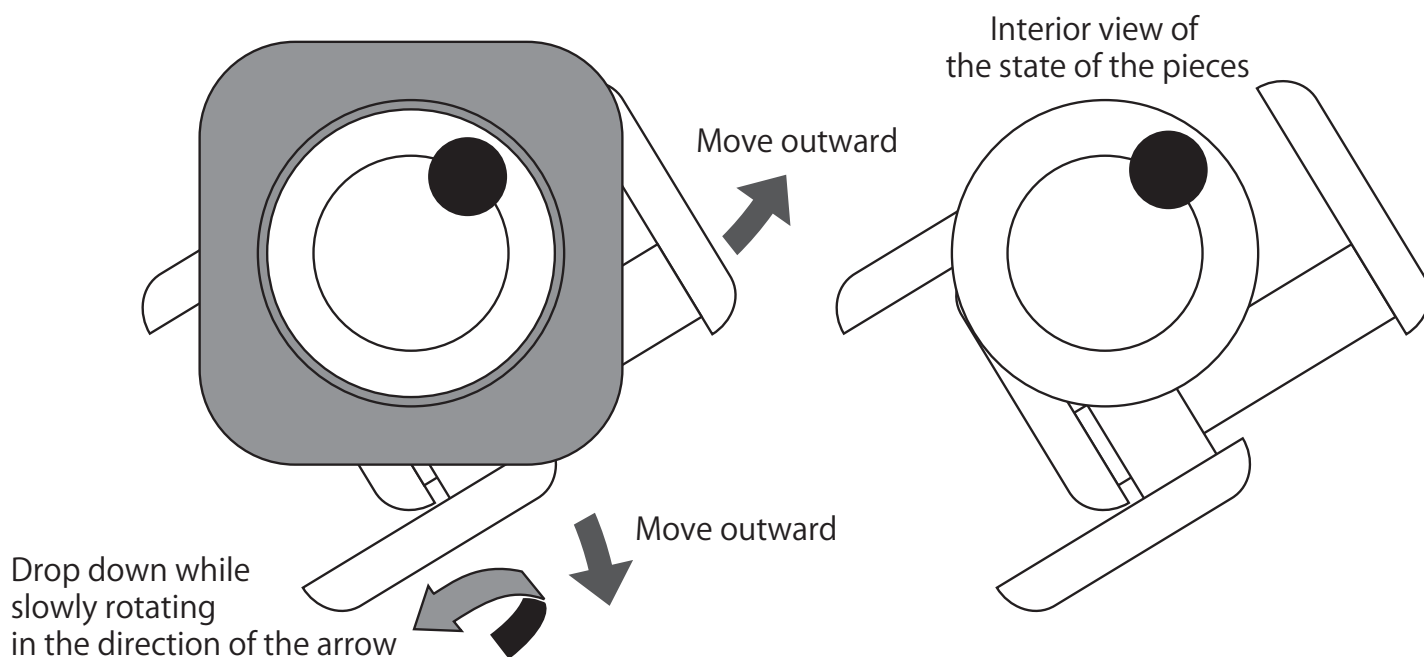

③ Move the pieces further from the state in ②.

*Here piece A will slip through B and drop free.

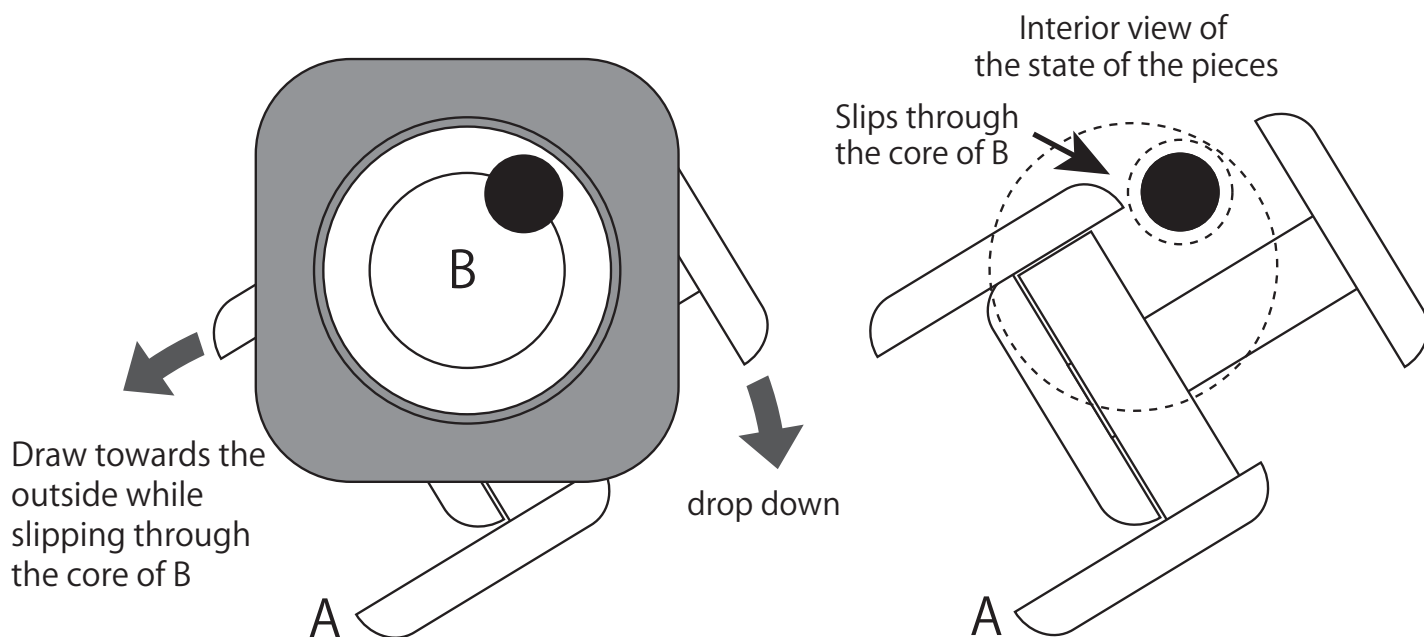

④ Extract the interior pieces.

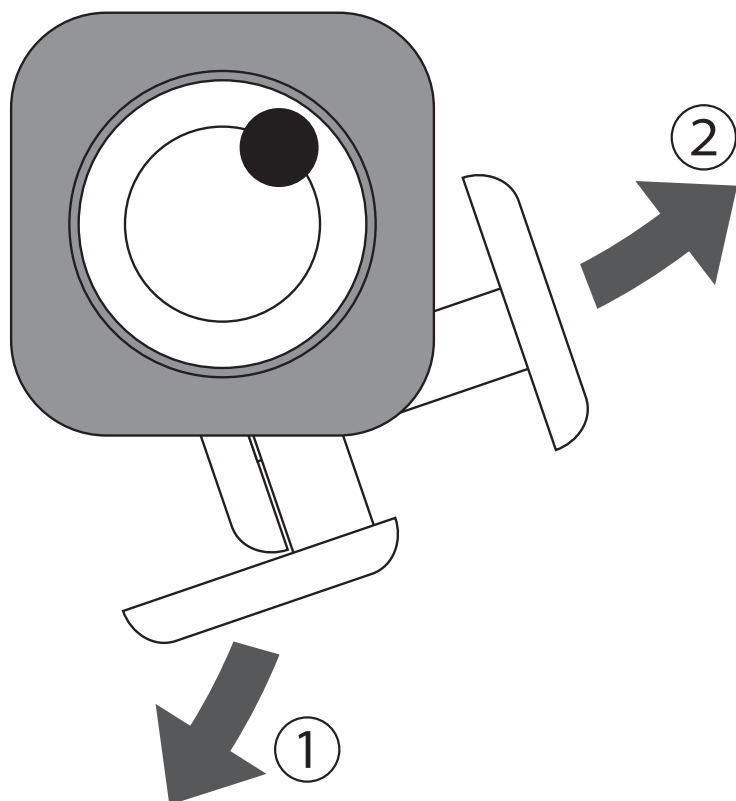

Reverse this procedure
to put the pieces back together.