

**Qty. Description**

1 **DDE 6-10**



Note! Product picture may differ from actual product

Product No.: [98147413](#)

Type key:

DDE 6-10 PR-PVC/T/C-X-31U2U2IG

The SMART Digital DDE is a compact positive displacement, diaphragm dosing pump with variable-speed drive (stepper motor) and intelligent control electronics with minimum energy consumption.

The SMART Digital Dosing series operates at full stroke length to ensure optimum accuracy, priming and suction, even for degassing liquids.

The duration of each discharge stroke varies according to the capacity set, resulting in optimum smooth and continuous discharge flow.

The click-stop mounting plate allows installation in three different positions without using any additional accessories. The dosing flow can be adjusted by means of an adjustment knob on a logarithmical scale from 0.1-100%.

The dosing head is composed of:

- Long lifetime and universal chemical resistant Full-PTFE diaphragm.
- Double ball valves for highest dosing accuracy.
- Deaeration valve for easy start-up.

Operation modes:

- Manual dosing from 0.1 to 100%.
- Pulse control (divisor function included).

Other features:

- 100 % key (max. capacity), e.g. for deaeration.
- Operation mode switch key between manual and pulse.
- Status LEDs for pulse and manual.
- Mechanical lock to protect the pump against unauthorised access.

Signal- Inputs/outputs:

- Input for pulse, external stop.
- Input for empty tank signal.
- 2 potential free output relays for max. 30 V AC/DC (configurable, alarm, low level, full stroke signal and pulse)

Controls:

Control variant:	PR
Level control:	YES
Pulse control:	YES
Ext. Stop input:	YES
Output relays:	YES

Liquid:

Pumped liquid:	Water
Liquid temperature range:	-10 .. 45 °C
Selected liquid temperature:	20 °C
Density:	998.2 kg/m <sup>3</sup>

Qty.	Description
	<p><b>Technical:</b></p> <p>Type key: DDE 6-10 PR-PVC/T/C-X-31U2U2IG</p> <p>Max. Flow: 6 l/h</p> <p>Min flow: 6.0 ml/h</p> <p>Turn-down ratio: 1:1000</p> <p>Approvals on nameplate: CE, CSA-US, NSF61, RCM</p> <p>Valve type: Standard</p> <p>Maximum viscosity at 100 %: 50 mPas</p> <p>Maximum viscosity in slow mode 50 %: N/A mPas</p> <p>Maximum viscosity in slow mode 25 %: N/A mPas</p> <p>Accuracy of repeatability: 5 %</p> <p><b>Materials:</b></p> <p>Dosing head: PVC (Polyvinyl chloride)</p> <p>Valve ball: Ceramic</p> <p>Gasket: PTFE</p> <p><b>Installation:</b></p> <p>Range of ambient temperature: 0 .. 45 °C</p> <p>Maximum operating pressure: 10 bar</p> <p>Installation set: NO</p> <p>Installation type: No installation set</p> <p>Pump inlet: 4/6, 6/9, 6/12, 9/12 mm</p> <p>Pump outlet: 4/6, 6/9, 6/12, 9/12 mm</p> <p>Max. Suction lift during operation: 6 m</p> <p>Max. Suction lift during priming: 2 m</p> <p><b>Electrical data:</b></p> <p>Maximum power input - P1: 19 W</p> <p>Mains frequency: 50 / 60 Hz</p> <p>Rated voltage: 1 x 100-240 V</p> <p>Enclosure class (IEC 34-5): IP65 / NEMA 4X</p> <p>Length of cable: 1.5 m</p> <p>Type of cable plug: Australia, New Zealand, Taiwan</p> <p>Inrush current: 25A at 230V for 2ms</p> <p><b>Others:</b></p> <p>Net weight: 2 kg</p> <p>Gross weight: 3 kg</p>



Company name:

Created by:

Phone:

Date:

27/05/2021

## 98147413 DDE 6-10

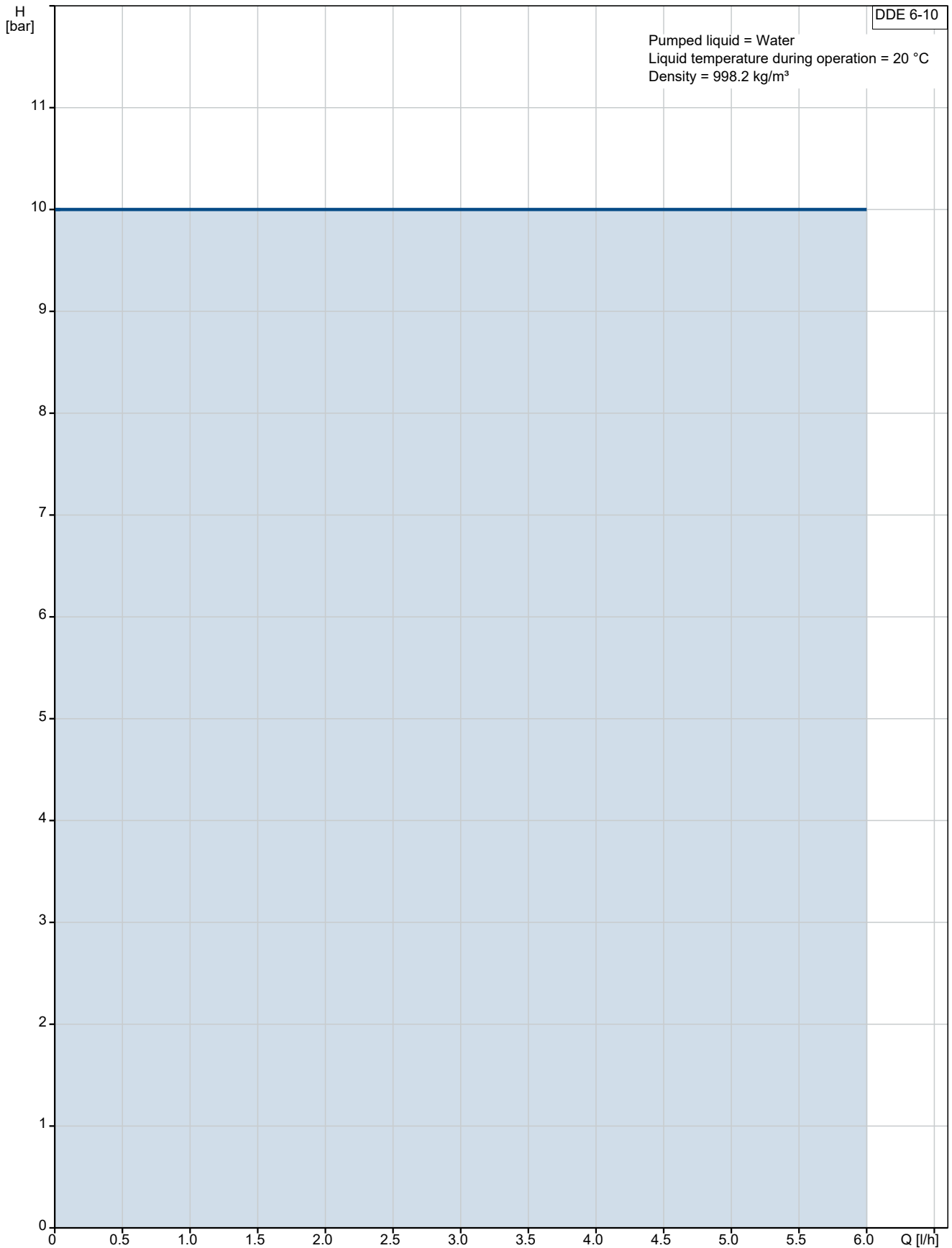

Description	Value
<b>General information:</b>	
Product name:	DDE 6-10
Product No:	98147413
EAN number:	5711490475104
Price:	
<b>Technical:</b>	
Type key:	DDE 6-10 PR-PVC/T/C-X-31U2U2IG
Max. Flow:	6 l/h
Min flow:	6.0 ml/h
Turn-down ratio:	1:1000
Approvals on nameplate:	CE,CSA-US,NSF61,RCM
Valve type:	Standard
Maximum viscosity at 100 %:	50 mPas
Maximum viscosity in slow mode 50 %:	N/A mPas
Maximum viscosity in slow mode 25 %:	N/A mPas
Accuracy of repeatability:	5 %
<b>Materials:</b>	
Dosing head:	PVC (Polyvinyl chloride)
Valve ball:	Ceramic
Gasket:	PTFE
<b>Installation:</b>	
Range of ambient temperature:	0 .. 45 °C
Maximum operating pressure:	10 bar
Installation set:	NO
Installation type:	No installation set
Pump inlet:	4/6, 6/9, 6/12, 9/12 mm
Pump outlet:	4/6, 6/9, 6/12, 9/12 mm
Max. Suction lift during operation:	6 m
Max. Suction lift during priming:	2 m
<b>Liquid:</b>	
Pumped liquid:	Water
Liquid temperature range:	-10 .. 45 °C
Selected liquid temperature:	20 °C
Density:	998.2 kg/m <sup>3</sup>
<b>Electrical data:</b>	
Maximum power input - P1:	19 W
Mains frequency:	50 / 60 Hz
Rated voltage:	1 x 100-240 V
Enclosure class (IEC 34-5):	IP65 / NEMA 4X
Length of cable:	1.5 m
Type of cable plug:	Australia, New Zealand, Taiwan
Inrush current:	25A at 230V for 2ms
<b>Controls:</b>	
Control variant:	PR
Level control:	YES
Pulse control:	YES
Ext. Stop input:	YES
Output relays:	YES
<b>Others:</b>	
Net weight:	2 kg
Gross weight:	3 kg

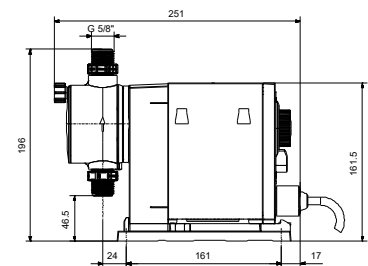
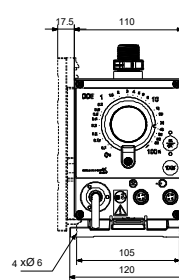
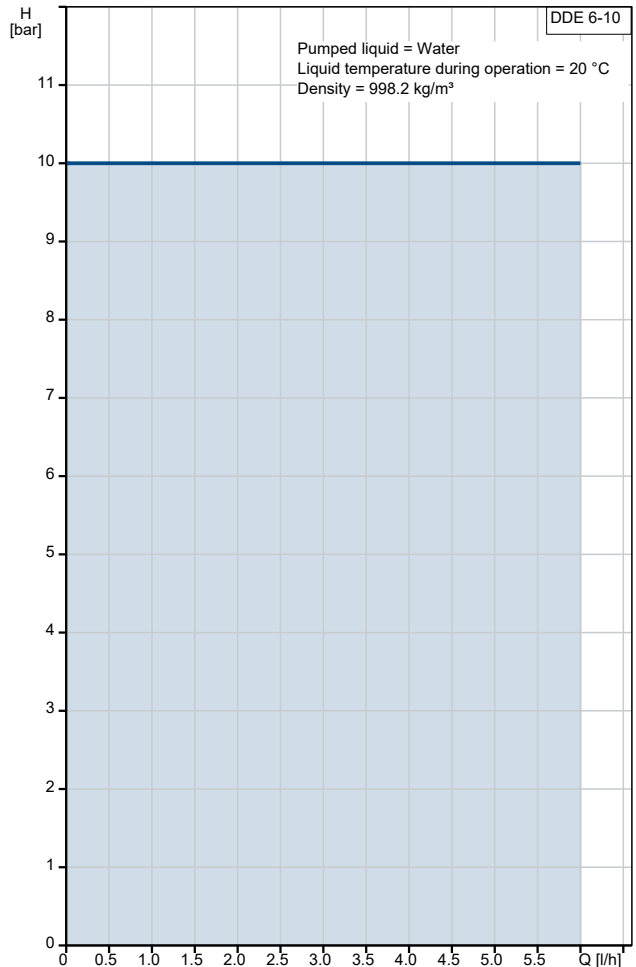

## 98147413 DDE 6-10

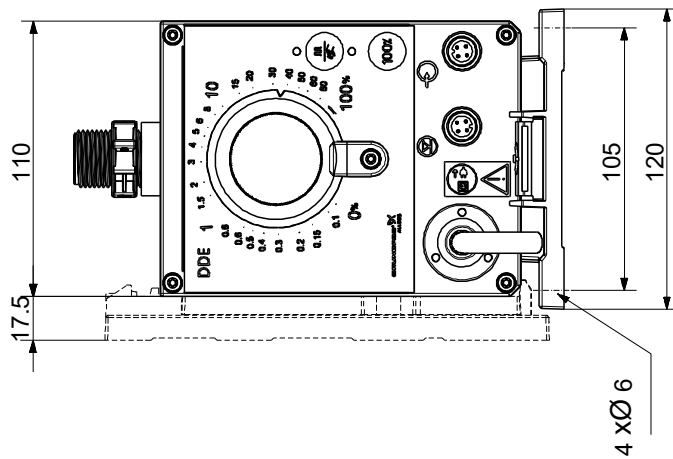
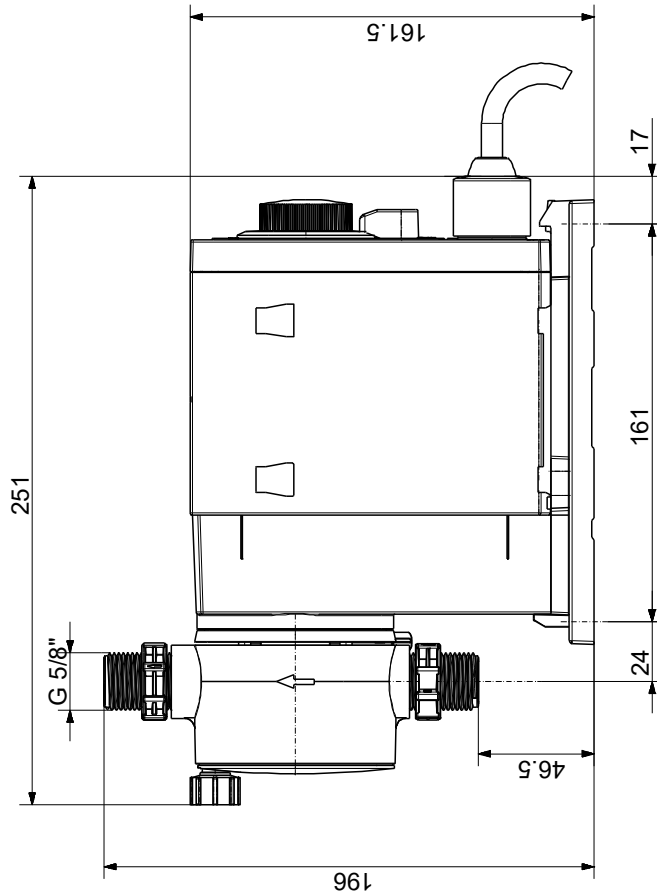

Note! All units are in [mm] unless others are stated.  
Disclaimer: This simplified dimensional drawing does not show all details.