

8" Mill Ordering Reference Catalog

Power Unit Selection

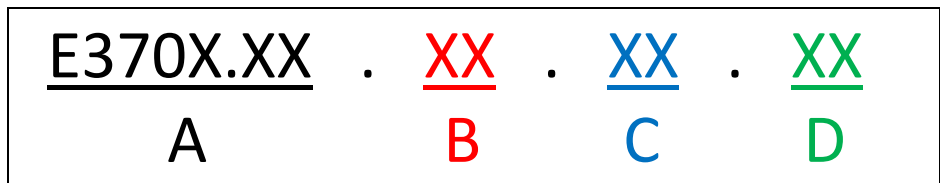
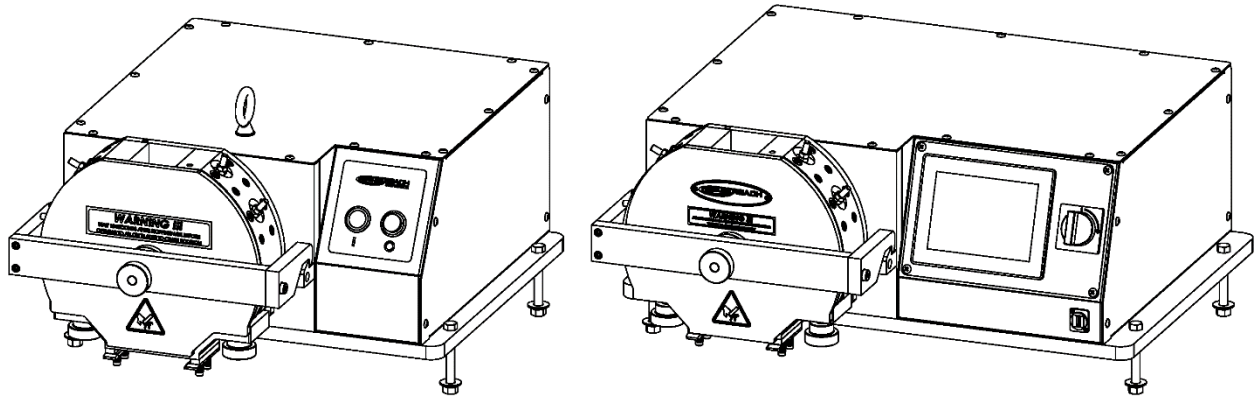

A

Single Speed 60Hz		Single Speed 50Hz					
E3700.00	1.5HP (1.1kW), 120v 1phase	E3700.25	1.5HP (1.1kW), 230V 1phase				
E3700.26	2HP (1.5kW), 230V 1phase	E3700.35	4HP (3.0kW), 230V 3phase				
E3700.36	5HP (3.7kW), 230V 3phase	E3700.45	4HP (3.0kW), 480V 3phase				
E3700.46	5HP (3.7kW), 480V 3phase						
<table style="width: 100%; border-collapse: collapse; margin: 0 auto;"> <thead> <tr> <th colspan="2" style="border-bottom: 1px solid black; text-align: left;">Variable Speed</th> </tr> </thead> <tbody> <tr> <td style="border-right: 1px solid black; padding: 5px;">E3703.26</td> <td style="padding: 5px;">3.8HP (2.8kW), 230V 60Hz 1phase</td> </tr> </tbody> </table>				Variable Speed		E3703.26	3.8HP (2.8kW), 230V 60Hz 1phase
Variable Speed							
E3703.26	3.8HP (2.8kW), 230V 60Hz 1phase						

- B “Blank” – Standard Setup, 6 stationary blades
HS – Speed 1,200 RPM, 6 stationary blades †
LS – Speed 790 RPM, 4 stationary blades, and widened blade gaps †
 † Single Speed units only

- C “Blank” – 4 blade, rotating cutter head
R6 – 6 blade, rotating cutter head option

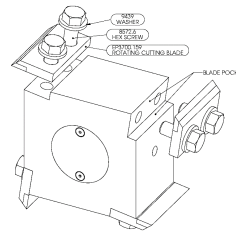

C: Standard 4 blade rotating cutter head with removable knives

- D “Blank” – carbon steel cutting chamber and powder coated panels
S – 300 series Stainless cutting chamber and powder coated panels
SC – cGMP, 316 series Stainless cutting chamber. 17-4 series Stainless Cutting Blades Powder coated panels.
SS – 316 stainless steel cutting chamber and panels. 300 series Stainless Cutting Blades

Packages/Kits

- E3700.CANNA.LS (Includes items below)
 - E3700.36.LS.S – Low Speed, 5HP (3.73kW), 230V 3phase 60hz
 - E3700.A.ST – Powder Coated Steel Stand
 - E3700.A.HP.HF.CANNA – 316 Stainless hopper
 - E3700.A.HVLT.CANNA – 316 Stainless tray
 - E3700.A.TK – Tool necessary to disassemble chamber.
 - E3700.A.KT4 – Standard blade gapping
 - E3700.A.CK – Brushes, scrappers and wash bottle
 - E3400.VC.30G – 30gal vacuum cyclone separator
 - E3400.A.AD8.S – Vacuum hose adapter for 8" Mills
 - E3700.A.S8 – 8 MM S/S 316 SIEVE
 - E3700.A.S12 – 12 MM S/S 316 SIEVE
-

- E3700.CANNA.HS (Includes items below)
 - E3700.36.HS.S – High Speed, 5HP (3.73kW), 230V 3phase 60hz
 - E3700.A.ST – Powder Coated Steel Stand
 - E3700.A.HP.HF.CANNA – 316 Stainless hopper
 - E3700.A.HVLT.CANNA – 316 Stainless tray
 - E3700.A.TK – Tool necessary to disassemble chamber.
 - E3700.A.KT4 – Standard blade gapping
 - E3700.A.CK – Brushes, scrappers and wash bottle
 - E3400.VC.30G – 30gal vacuum cyclone separator
 - E3400.A.AD8.S – Vacuum hose adapter for 8" Mills
 - E3700.A.S1 – 1 MM S/S 316 SIEVE
 - E3700.A.S2 – 2 MM S/S 316 SIEVE

Accessories and Options

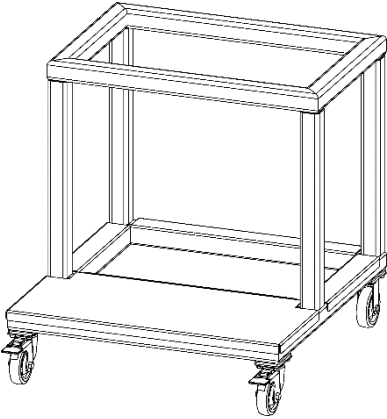

Mill Stand

E3700.00 and E3700.25 Stands

- E3700.A.ST – Powder Coated Steel Stand
- E3700.A.ST.S – 300 Series Stainless Stand
- E3700.A.ST.SS – 316 Stainless Stand

Variable Speed and High Voltage Power Unit Stands

- E3703.A.ST – Powder Coated Steel Stand
- E3703.A.ST.S – 300 Series Stainless Stand
- E3703.A.ST.SS – 316 Stainless Stand

Note: Variable speed 480V machines come with a matching stand.

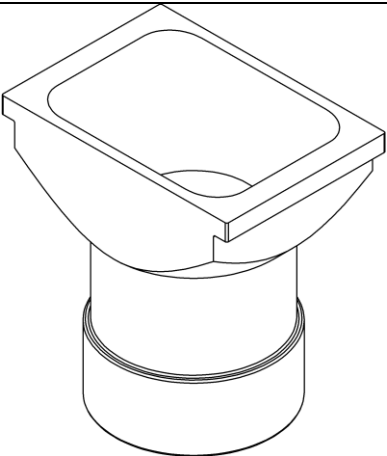

E3700.A.JH.SS

Jar Holder

- E3700.A.JH - Carbon Steel and Powder coated
- E3700.A.JH.S – 300 series Stainless Steel
- E3700.A.JH.SS – 316 series Stainless Steel

- 5818 – 16oz Glass Mason Jar
- 5818.5 – Mason Jar Lid

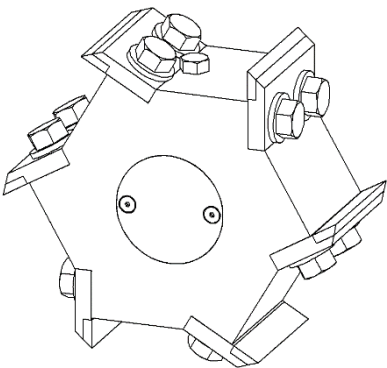

Rotating Cutter Head

E3700.A.RCH6 – 6 Blade, Rotating Cutter Head, Steel

Blades sold separately.

E3700.A.RB.6 – Set of 6 Rotating Cutter Blades, Steel

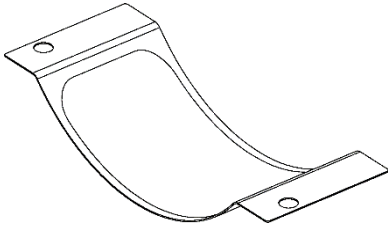

Sieves

- E3700.A.S200* - 0.2MM MESH SCREEN S/S 316 SIEVE
- E3700.A.S05 - 0.5 MM S/S 316 SIEVE
- E3700.A.S1 - 1 MM S/S 316 SIEVE
- E3700.A.S2 - 2 MM S/S 316 SIEVE
- E3700.A.S3 - 3 MM S/S 316 SIEVE
- E3700.A.S4 - 4 MM S/S 316 SIEVE
- E3700.A.S5 - 5 MM S/S 316 SIEVE
- E3700.A.S6 - 6 MM S/S 316 SIEVE
- E3700.A.S7 - 7 MM S/S 316 SIEVE
- E3700.A.S8 - 8 MM S/S 316 SIEVE
- E3700.A.S10 - 10 MM S/S 316 SIEVE
- E3700.A.S12 - 12 MM S/S 316 SIEVE

- E3700.A.M20* - 20 MESH S/S 316 SIEVE
- E3700.A.M30* - 30 MESH S/S 316 SIEVE
- E3700.A.M40* - 40 MESH S/S 316 SIEVE
- E3700.A.M60* - 60 MESH S/S 316 SIEVE
- E3700.A.S80* - 80 MESH SCREEN S/S 316 SIEVE
- E3700.A.S100* - 100 MESH SCREEN S/S 316 SIEVE

* The use of a Screen Shim Plate required

E3700.A.MSP - SCREEN SHIM PLATE

Hoppers and Loading Trays

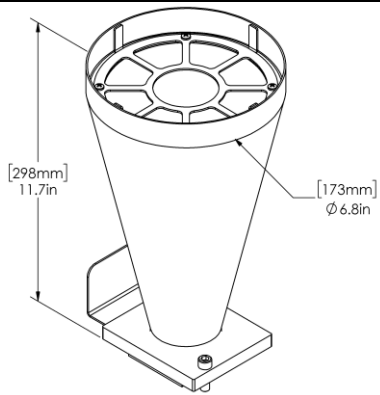

E3700.A.HP.S – 300 Series Stainless Round Top Hopper with removable safety guard, lid and hard maple wood plunger

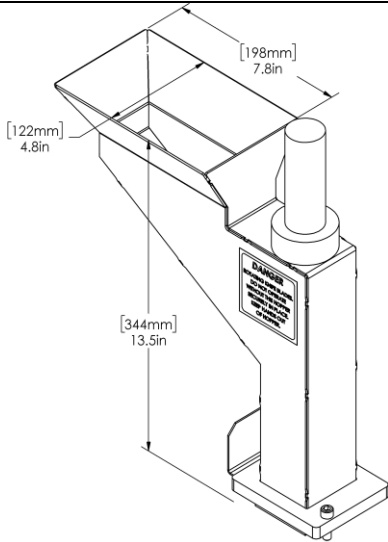

E3700.A.HP.HF.SS– 316 Stainless Hopper with large opening, high flow design and PTFE plunger.

E3700.A.HP.HF.SS hopper is specifically made to be use with the E3700.A.HVLT Loading Tray.

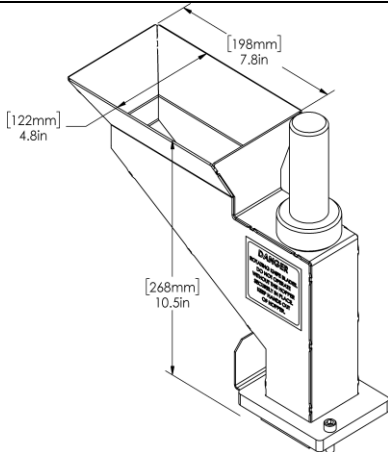

E3700.A.HP.HF.CANNA – 316 Stainless Hopper with large opening, high flow design and hard maple wood plunger.

E3700.A.HP.HF.CANNA hopper is specifically made to be use with the E3700.A.HVLT.CANNA Loading Tray.

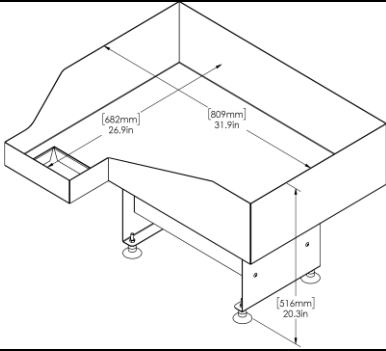

E3700.A.HVLT– 316 Stainless tall loading tray

Note: E3700.A.HP.HF necessary

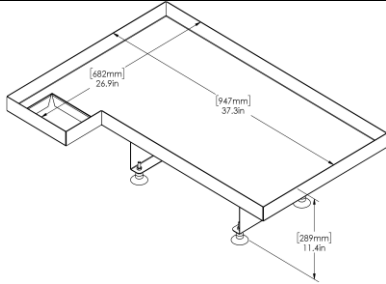

E3700.A.HVLT.CANNA – 316 Stainless short loading tray

Note: E3700.A.HP.HF.CANNA necessary

Tools

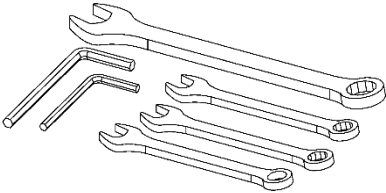

Tool Kit
E3700.A.TK – Tool necessary to disassemble chamber

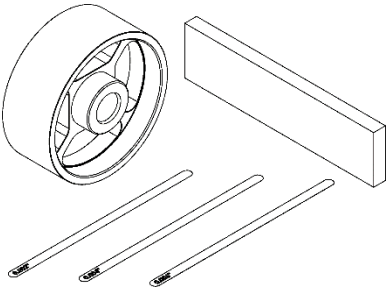

Knife Adjusting Tool
Used to properly gap mill knife blades
E3700.A.KT4 – Standard blade gapping
E3700.A.KT8 – Double blade gapping
E3700.A.KT12 – Triple blade gapping

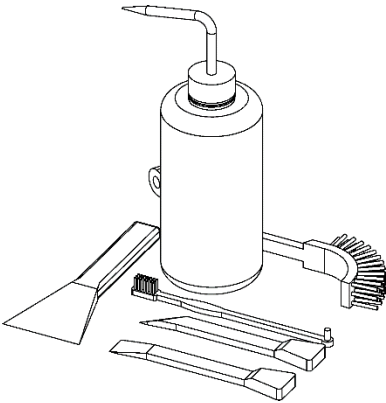

Cleaning Kit
E3700.A.CK – Brushes, scrapers and wash bottle

Vacuum Collection System

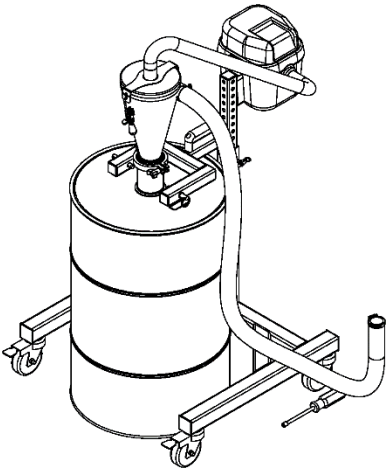

Vacuum Separator
300 series stainless drum and Vacuum Separator

E3400.VC.30G – 30gal vacuum cyclone separator
E3400.VC.50G – 50gal vacuum cyclone separator

Note: Adapter mill adapter sold separately.

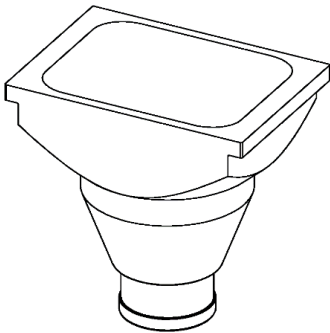

Vacuum Hose Adapter

E3400.A.AD8.S – 300 series stainless vacuum hose adapter for
8" Mills

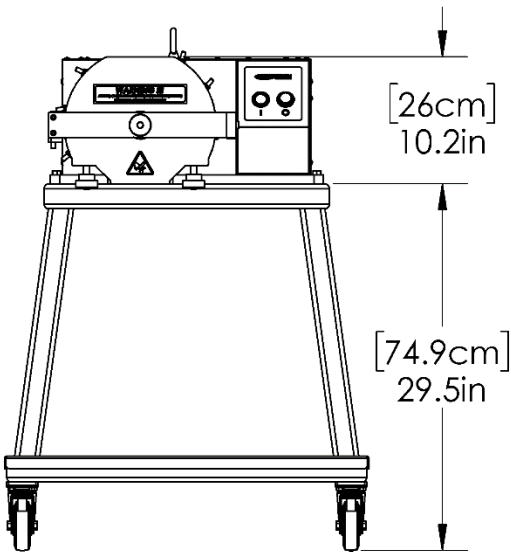
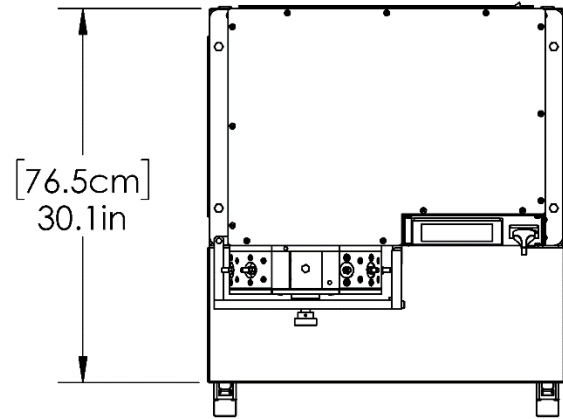
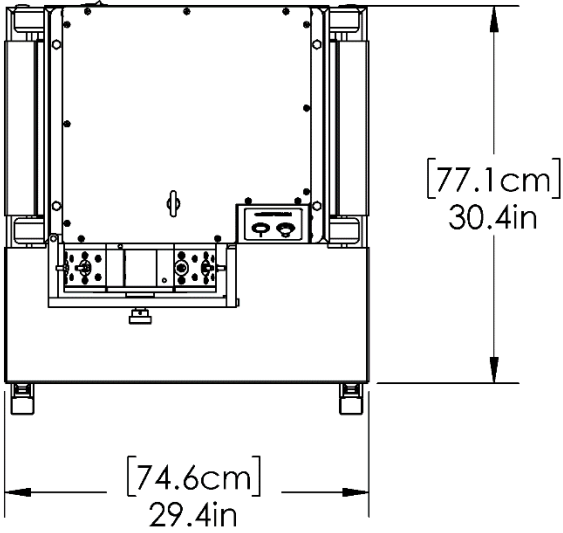

SINGLE SPEED

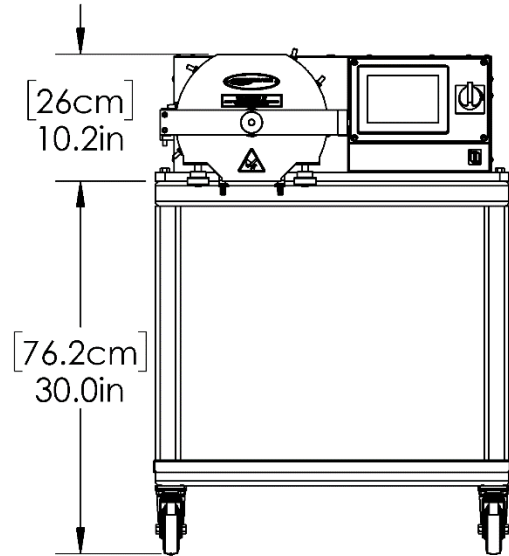

VARIABLE SPEED

