



5900 Schooner Drive – Belleville, MI 48111 – USA  
TEL (800) 422-2558 – FAX (734) 665-9099

[www.Eberbachlabtools.com](http://www.Eberbachlabtools.com)

**E9280.00 Glass Tubing Cutter**  
Hot Wire Type 115V, 50/60 Hz

**USE AND CARE FOR CATALOG NUMBER:**

- **E9280.00 Glass Tubing Cutter, Hot Wire Type  
115V, 50/60 Hz**

**INITIAL PREPARATION:**

1. Connect power cord to power inlet at rear of unit and plug into wall receptacle. 115Vac 50/60Hz.
2. Turn off toggle switch located on front panel of Power Unit.
3. Plug Hot Wire Unit Cord into left-hand receptacle of Power Unit.
4. At the point on the glass tube where the cut is to be made, score the tube with a triangular file making three (3) evenly spaced scores around the tube.
5. Adjust wire of Hot Wire Unit so that wire is tight around glass tube to be cut and so that “fingers” of Hot Wire Unit come close together. The apparatus cuts tubing up to 7-1/2” O.D.

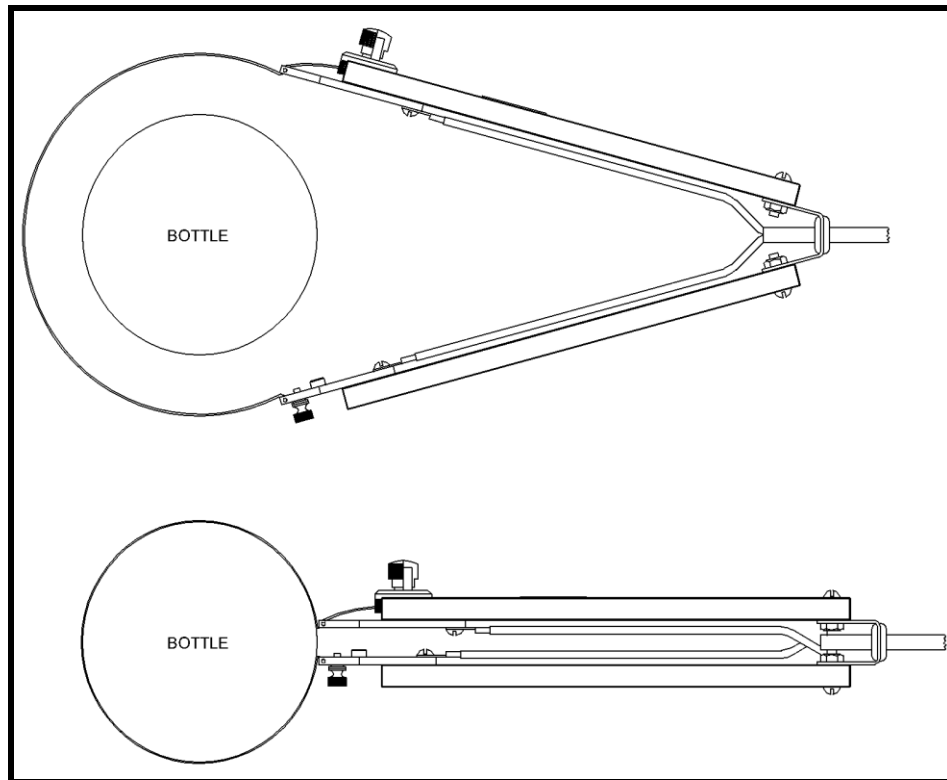

6. Turn on Power Unit Switch and rotate Control Knob clockwise until pointer on the ammeter reaches (6) Amps.

7. Soft Glass – Leave Power Unit Switch on until tube breaks.

Hard Glass – Leave Power Unit Switch on 30 seconds for each millimeter of wall thickness. Turn off switch and quench immediately with a tumbler full of water.

Note: Power carried in hot cutting wire is low voltage (24Vac). This low voltage source is isolated and insulated from power line. Because of these factors electrical shock hazard is eliminated.

Use of Foot Switch (E9280.A.FP) will free your hands when using the Hot Wire Unit. A receptacle is built into the Power Unit for connecting this accessory. When the Foot Switch is used, Power Unit Switch on Front Panel of unit must **remain in off position**.

**Hand Unit receptacle is fused with a 7A Time Delay Fuse.**

**Foot Switch receptacle is fused with a 2A Time Delay Fuse.**

Contact your supplier or ***Eberbach Corporation*** technical support with any inquiries concerning replacement parts and installation.

**WARNING!!!**

**SETTING CURRENT ABOVE 50% MAY CAUSE  
STANDARD WIRE TO BREAK**

E9280.A.PU Power Unit

PartNo	DESCRIPTION	QTY.
4843	BLACK PLASTIC HANDLE	1
5505.7	RUBBER FOOT	4
6007.5	A.C. METER, 10 AMP	1
6063.1	CABLE TIE MOUNT, HOLE DIA (.025 - .125")	2
6063.2	CABLE TIE	3
6113	FUSE, TIME DELAY 3A	2
6126.5	FUSE, 2AMP TIME DELAY	1
6130.3	7A FUSE TIME DELAY	1
6131.1	FUSE HOLDER	2
6220	CABLE TIE HOLDER WITH ADHESIVE BACKED	1
6276.3	VARIAC 115VAC 210VA	1
6276.7	TRANSFORMER, 175VA;	1
6278	AC INLET	1
6449.5	HAND UNIT SOCKET	1
6450.7	FOOT SWITCH SOCKET	1
6460.2	PILOT LIGHT, AMBER, DOMED	1
6520	TOGGLE SWITCH	1
6649	115V POWER CORD, TYPE B PLUG	1
7595	#6-32 X 1/4" S/S ROUND HD. MACHINE SCREW	4
7684	#8-32 X 1/2" ROUND HD. MACHINE SCREW	4
7954	#5-40 X 3/8" S/S FLAT HEAD MACHINE SCREW	2
8277	#8-32 X 3/8" S/S TRUST HD. SCREW	18
8582	#8-32 X 3/8" SOCKET HD. SCREW	4
9206	#6-32 NYLON LOCK NUT	4
9207	#5-40 NYLON-INSERT HEX LOCKNUT	2
9235	#8-32 S/S MACHINE SCREW NUT	4
EP9280.A.PU.006	RIGHT SIDE PANEL	1
EP9280.A.PU.008	LEFT SIDE PANEL	1
EP9280.A.PU.014	TOP PANEL	1

EP9280.A.PU.501A	BODY ASSEMBLY	1
EP9280.A.PU.650A	WIRE HARNESS	1
EP9280.A.PU.SS.010	FRONT PANEL	1

E9280.A.TC Hand Unit

<u>PartNo</u>	<u>DESCRIPTION</u>	<u>QTY.</u>
3553	#26 B&S GAGE CHROMEL WIRE	1
4791.5	KNOB, PLASTIC	1
5168	0.039" X 3/16" S/S SPRING PIN	2
5535.5	RUBBER GROMMET	1
6066	RETAINING CLIP	1
6215	RING TERMINAL	2
6257.5	PLUG	1
6655	CORD	5.6ft
7405.5	#6-32 X 1/4" 18-8SS BINDING HD. SCREW	2
7699	#8-32 X 5/8" S/S ROUND HD MACHINE SCREW	4
7999	#8-32 X 3/8" 18-8 FLAT HEAD MACHINE SCREW	1
8019	#8-32 X 7/8" S/S FLAT HD MACHINE SCREW	1
9020	#4-40 THUMB SCREW	1
235	#8-32 18-8 S/S MACHINE SCREW NUT	5
9463	#4 BRASS WASHER	1
EP9260.002	TOP FINGER	1
EP9260.004	BOTTOM FINGER	1
EP9260.006	SPRING HINGE	1
EP9260.014	TOP ARM	1
EP9260.016	BOTTOM ARM	1
EP9260.018	SPOOL	1
EP9260.024	INSULATOR	1



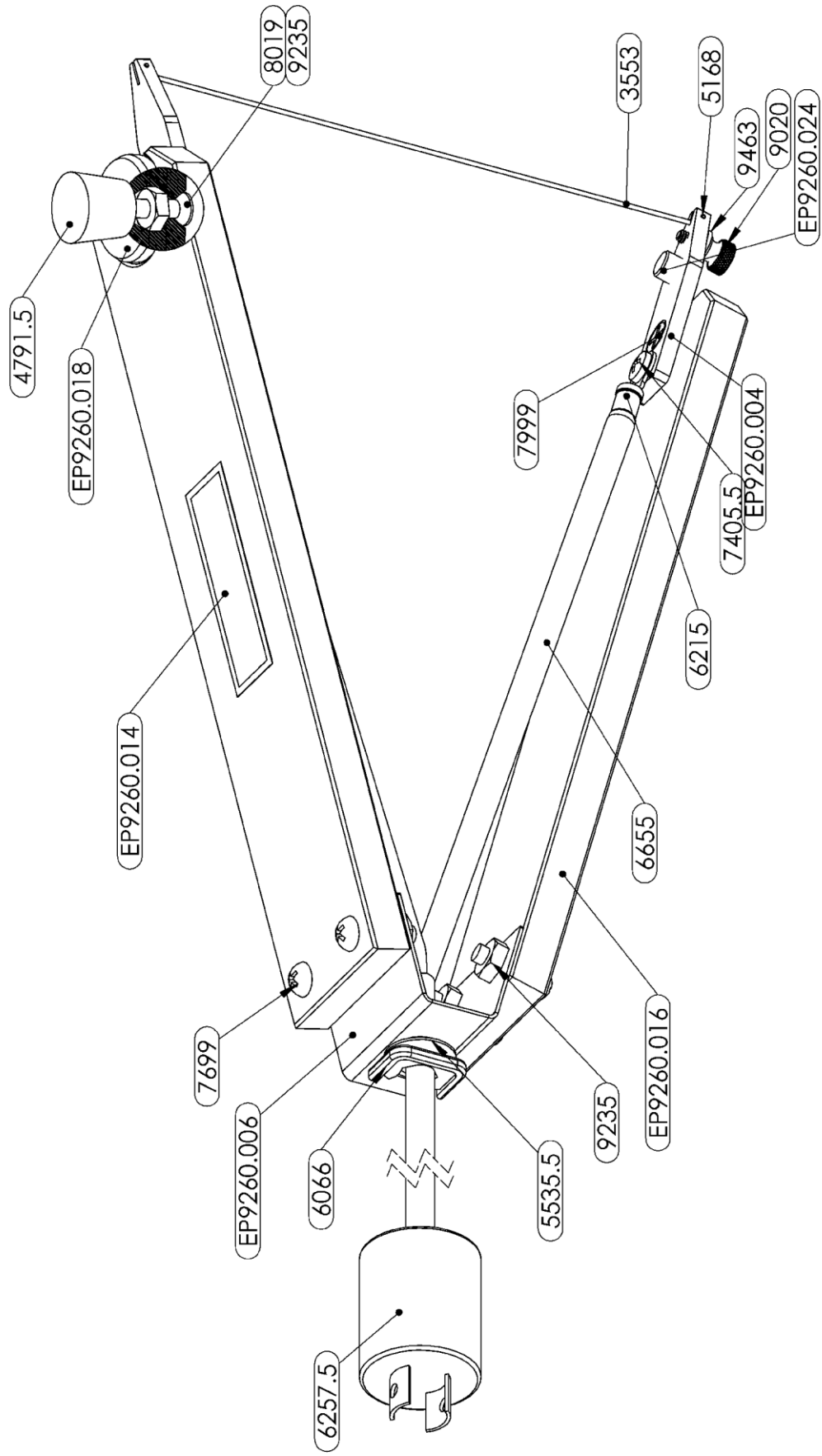

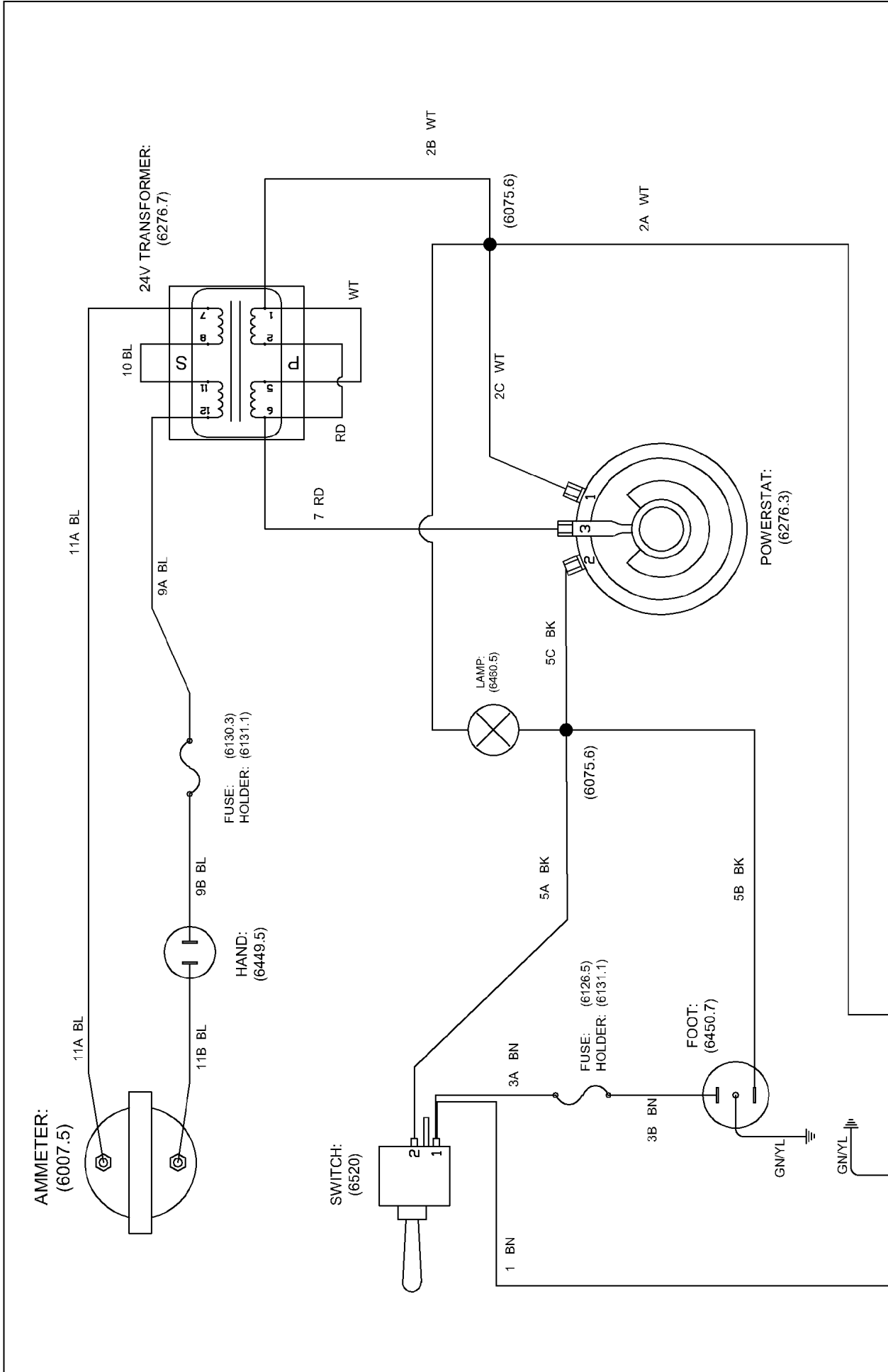

ASSEMBLY		PART NAME		ELECTRICAL DIAGRAM	
MATERIAL		SCALE		DEPT.	
FINISH		N/A		DRW.	
REVISED		1		FAB.	
REVISION		2/25/2019		ASM.	
DATE		2/25/2019		PART NO.	
JOB		E9280.A.PU.605A		E9280.A.PU.605A	

**EBERBACH CORPORATION USA**

NOTE: USE 6" CABLE WRAP (6193)